

NEW MEXICO OIL CONSERVATION COMMISSION
WELL LOCATION AND ACREAGE DEDICATION PLAT

FORM C-128
Revised 5/1/57

SEE INSTRUCTIONS FOR COMPLETING THIS FORM ON THE REVERSE SIDE

SECTION A

Operator Tom L. Ingram		Lease KIRKPATRICK		Well No. 3
Unit Letter E	Section 11	Township 8 SOUTH	Range 37 EAST	County ROOSEVELT
Actual Footage Location of Well: 1650 feet from the NORTH line and 990 feet from the WEST line				
Ground Level Elev. 4884	Producing Formation San Andres		Pool Bluttt-San Andres	Dedicated Acreage: 320 Acres

1. Is the Operator the only owner in the dedicated acreage outlined on the plat below? YES _____ NO X "Owner" means the person who has the right to drill into and to produce from any pool and to appropriate the production either for himself or for himself and another. (65-3-29 (e) NMSA 1935 Comp.)
2. If the answer to question one is "no," have the interests of all the owners been consolidated by communization agreement or otherwise? YES X NO ____ If answer is "yes," Type of Consolidation Operating Agreement
3. If the answer to question two is "no," list all the owners and their respective interests below.

Owner Tom L. Ingram	Land Description NW/4 Section 11-83-37E
Tenneco, Inc.	SW/4 Section 11-83-37E

SECTION B

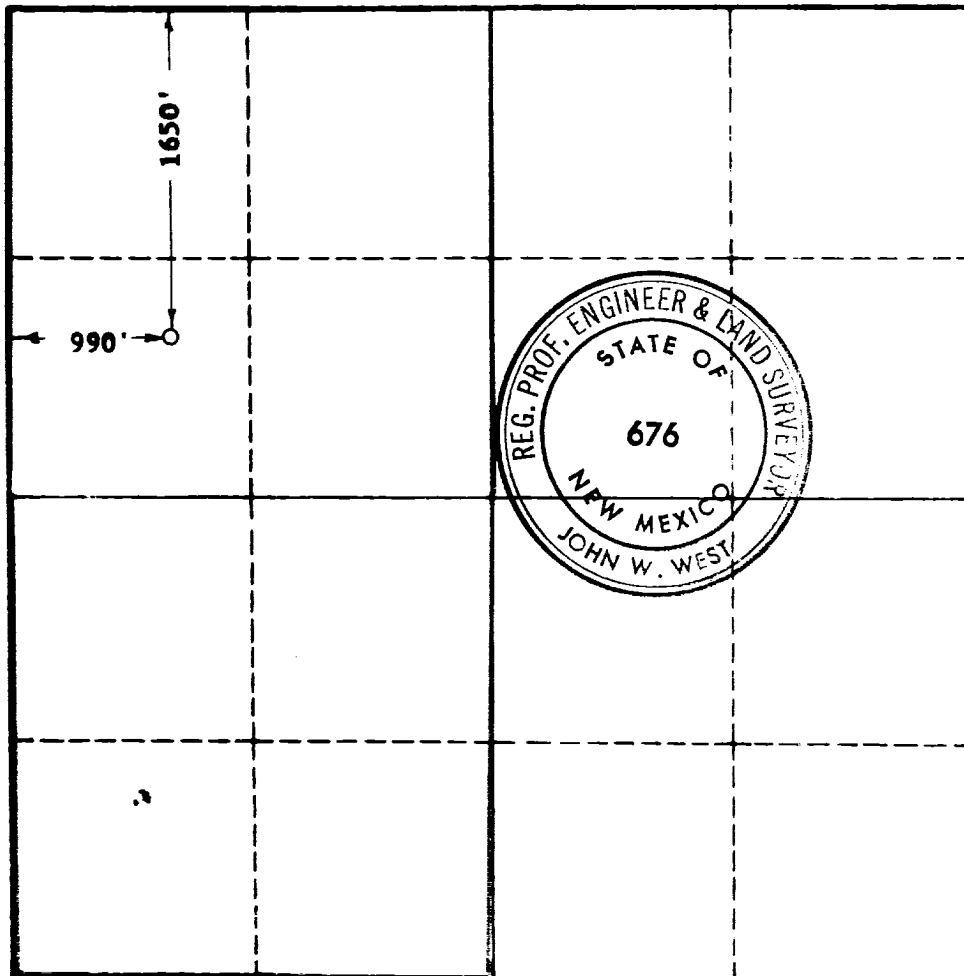

CERTIFICATION

I hereby certify that the information in SECTION A above is true and complete to the best of my knowledge and belief.

Name

Position

Partner

Company

Tom L. Ingram

Date

February 5, 1965

I hereby certify that the well location shown on the plat in SECTION B was plotted from field notes of actual surveys made by me or under my supervision, and that the same is true and correct to the best of my knowledge and belief.

Date Surveyed

JULY 22, 1964

Registered Professional Engineer and/or Land Surveyor, **JOHN W. WEST**

Certificate No.

N. M. - P. E. & L. S. NO. 676