

(SUBMIT IN TRIPLICATE)

UNITED STATES
DEPARTMENT OF THE INTERIOR
GEOLOGICAL SURVEY

Land Office Hobbs, New Mexico

Lease No. LC 062178

Unit

Federal "A" No. 2

SUNDRY NOTICES AND REPORTS ON WELLS

NOTICE OF INTENTION TO DRILL	X	SUBSEQUENT REPORT OF WATER SHUT-OFF	
NOTICE OF INTENTION TO CHANGE PLANS		SUBSEQUENT REPORT OF SHOOTING OR ACIDIZING	
NOTICE OF INTENTION TO TEST WATER SHUT-OFF		SUBSEQUENT REPORT OF ALTERING CASING	
NOTICE OF INTENTION TO RE-DRILL OR REPAIR WELL		SUBSEQUENT REPORT OF RE-DRILLING OR REPAIR	
NOTICE OF INTENTION TO SHOOT OR ACIDIZE		SUBSEQUENT REPORT OF ABANDONMENT	
NOTICE OF INTENTION TO PULL OR ALTER CASING		SUPPLEMENTARY WELL HISTORY	
NOTICE OF INTENTION TO ABANDON WELL			

(INDICATE ABOVE BY CHECK MARK NATURE OF REPORT, NOTICE, OR OTHER DATA)

January 9, 1963

Well No. 2 is located 1980 ft. from ~~NE~~
S line and 660 ft. from ~~W~~
E line of sec. 14SE $\frac{1}{4}$ 14 T-8-S R-34-E NMPM
($\frac{1}{4}$ Sec. and Sec. No.) (Twp.) (Range) (Meridian)Milnesand San Andres Roosevelt New Mexico
(Field) (County or Subdivision) (State or Territory)

The elevation of the derrick floor above sea level is 4275 ft.

DETAILS OF WORK

(State names of and expected depths to objective sands; show sizes, weights, and lengths of proposed casings; indicate mudding jobs, cementing points, and all other important proposed work)

Drill well with rotary tools to test the San Andres to 4700'.

Set 370' 8 5/8" 24# J surface casing and cement with 200 sx. (circulate)

Set 4700' 4 1/2" 10.5# J casing and cement with 200 sx.

Electric log will be run at TD

San Andres pay is expected at approximately 4520'

The casing will be perforated according to electric log.

The San Andres will be acidized and/or fraced as necessary for commercial production.

I understand that this plan of work must receive approval in writing by the Geological Survey before operations may be commenced.

Company Lario Oil & Gas Company

Address P. O. Box 155

Midland, Texas

By

D. A. Chase

Title Production Superintendent

NUMBER OF COPIES RECEIVED	
DISTRIBUTION	
SANTA FE	
FILE	
U.S.G.S.	
LAND OFFICE	
TRANSPORTER	OIL GAS
PRODUCTION OFFICE	
OPERATOR	

NEW MEXICO OIL CONSERVATION COMMISSION

WELL LOCATION AND ACREAGE DEDICATION PLAT

SEE INSTRUCTIONS FOR COMPLETING THIS FORM ON THE REVERSE SIDE

Federal Lease No. **LC 062175**

FORM C-128
Revised 5/1/57

SECTION A				
Operator Lario Oil & Gas Company		Lease Federal "A"		Well No. 2
Unit Letter I	Section 14	Township T-8-S	Range R-34-E	County Roosevelt
Actual Footage Location of Well: 1500 feet from the South line and 660 feet from the East line				
Ground Level Elev. 4265	Producing Formation San Andres	Pool Hilmar	Dedicated Acreage: 40 Acres	

1. Is the Operator the only owner in the dedicated acreage outlined on the plat below? YES _____ NO X. ("Owner" means the person who has the right to drill into and to produce from any pool and to appropriate the production either for himself or for himself and another. (65-3-29 (e) NMSA 1935 Comp.)
2. If the answer to question one is "no," have the interests of all the owners been consolidated by communitization agreement or otherwise? YES _____ NO X. If answer is "yes," Type of Consolidation _____
3. If the answer to question two is "no," list all the owners and their respective interests below:

Owner Lario Oil & Gas Company	Land Description 34 Section 14, T-8-S, R-34-E, Roosevelt County,
Murray Oil Company	
Texas, Inc.	New Mexico

SECTION B

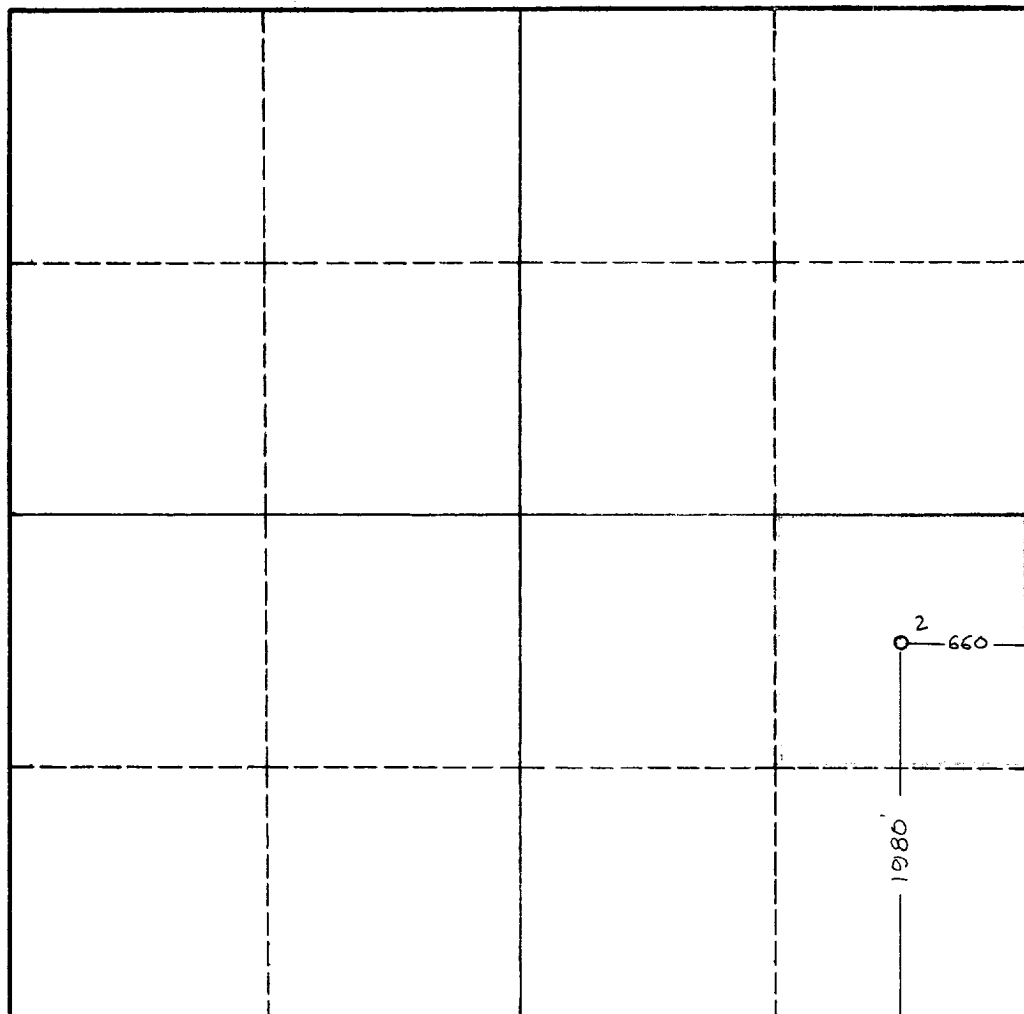

CERTIFICATION

I hereby certify that the information in SECTION A above is true and complete to the best of my knowledge and belief.

D. A. Chase
Name
Production Superintendent
Position
Lario Oil & Gas Company
Company
January 9, 1963
Date

I hereby certify that the well location shown on the plat in SECTION B was plotted from field notes of actual surveys made by me or under my supervision, and that the same is true and correct to the best of my knowledge and belief.

January 9, 1963
Date Surveyed
Registered Professional Engineer and/or Land Surveyor

20 Wallis
Certificate No.
1635

0 330 660 990 1320 1650 1980 2310 2640 2000 1500 1000 500 0

INSTRUCTIONS FOR COMPLETION OF FORM C-128

1. Operator shall furnish and certify to the information called for in Section A.
2. Operator shall outline the dedicated acreage for *both* oil and gas wells on the plat in Section B.
3. A registered professional engineer or land surveyor registered in the State of New Mexico or approved by the Commission shall show on the plat the location of the well and certify this information in the space provided.
4. All distances shown on the plat must be from the outer boundaries of the Section.
5. If additional space is needed for listing owners and their respective interests as required in question 3 of Section A, please use space below.