

UNITED STATES
DEPARTMENT OF THE INTERIOR
GEOLOGICAL SURVEY

APPLICATION FOR PERMIT TO DRILL, DEEPEN, OR PLUG BACK

1a. TYPE OF WORK

DRILL ☒

DEEPEN ☐

PLUG BACK ☐

b. TYPE OF WELL

OIL WELL ☒

GAS WELL ☐

OTHER

SINGLE ZONE ☒

MULTIPLE ZONE ☐

2. NAME OF OPERATOR

PAN AMERICAN PETROLEUM CORP.

3. ADDRESS OF OPERATOR

Box 68 HOBBS N.M. 88240

4. LOCATION OF WELL (Report location clearly and in accordance with any State requirements.)*

At surface

330' FNL X 990' FEL SEC. 29 (UNIT A, NE/4 NE/4)

At proposed prod. zone

14. DISTANCE IN MILES AND DIRECTION FROM NEAREST TOWN OR POST OFFICE*

Appx. 4 M. W. 3 M. So. 2 M. E. MILNESAND, N.M.

15. DISTANCE FROM PROPOSED*

LOCATION TO NEAREST

PROPERTY OR LEASE LINE, FT.

(Also to nearest drlg. line, if any)

18. DISTANCE FROM PROPOSED LOCATION*

TO NEAREST WELL, DRILLING, COMPLETED,

OR APPLIED FOR, ON THIS LEASE, FT.

21. ELEVATIONS (Show whether DF, RT, GR, etc.)

23.

PROPOSED CASING AND CEMENTING PROGRAM

SIZE OF HOLE	SIZE OF CASING	WEIGHT PER FOOT	SETTING DEPTH	QUANTITY OF CEMENT
12 1/4 - 11"	8 5/8"	24 "	400'	Circulate
7 1/8"	4 1/2"	9.5 "	4700'	250 Sx.

After drilling well, logs will be run and evaluations made, perforating and stimulating as necessary to attempt commercial production.

IN ABOVE SPACE DESCRIBE PROPOSED PROGRAM: If proposal is to deepen or plug back, give data on present productive zone and proposed new productive zone. If proposal is to drill or deepen directionally, give pertinent data on subsurface locations and measured and true vertical depths. Give blowout preventer program, if any.

24.

SIGNED

TITLE

DATE

(This space for Federal or State office use)

PERMIT NO.

APPROVAL DATE

APPROVED BY

TITLE

CONDITIONS OF APPROVAL, IF ANY:

DIST 0+7
5-USGS-Hobbs
1-J.W.B
1-Susp
1-W.S.

*See Instructions On Reverse Side

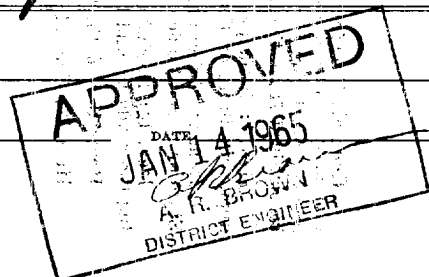

5. LEASE DESIGNATION AND SERIAL NO.

NM 0145685

6. IF INDIAN, ALLOTTEE OR TRIBE NAME

7. UNIT AGREEMENT NAME

8. FARM OR LEASE NAME

USA RUSSELL E. HORTON

9. WELL NO.

28

10. FIELD AND POOL, OR WILDCAT

MILNESAND San ANDRES

11. SEC., T., R., M., OR BLK. AND SURVEY OR AREA

29-8-35 N.M.P.M.

12. COUNTY OR PARISH

13. STATE

ROOSEVELT

N.M.

16. NO. OF ACRES IN LEASE

1920

17. NO. OF ACRES ASSIGNED TO THIS WELL

40

19. PROPOSED DEPTH

4700'

20. ROTARY OR CABLE TOOLS

ROTARY

22. APPROX. DATE WORK WILL START*

1-15-65

NEW MEXICO OIL CONSERVATION COMMISSION
WELL LOCATION AND ACREAGE DEDICATION PLAT

FORM C-128
Revised 5/1/57

SEE INSTRUCTIONS FOR COMPLETING THIS FORM ON THE REVERSE SIDE

SECTION A

Operator		Lease		Well No.	
PAN AMERICAN PETROLEUM CORP.		U.S.A. R. E. HORTON		28	
Unit Letter	Section	Township	Range	County	
A	29	8 SOUTH	35 EAST	ROOSEVELT	
Actual Footage Location of Well:					
330 feet from the NORTH line and 990 feet from the EAST line					
Ground Level Elev.	Producing Formation		Pool	Dedicated Acreage:	
	San Andres		Melissana San Andres	40 Acres	

1. Is the Operator the only owner in the dedicated acreage outlined on the plat below? YES ☒ NO ____ ("Owner" means the person who has the right to drill into and to produce from any pool and to appropriate the production either for himself or for himself and another. (65-3-29 (a) NMSA 1955 Comp.)
2. If the answer to question one is "no," have the interests of all the owners been consolidated by communitization agreement or otherwise? YES ____ NO ____ If answer is "yes," Type of Consolidation ____
3. If the answer to question two is "no," list all the owners and their respective interests below:

Owner	Land Description

SECTION B

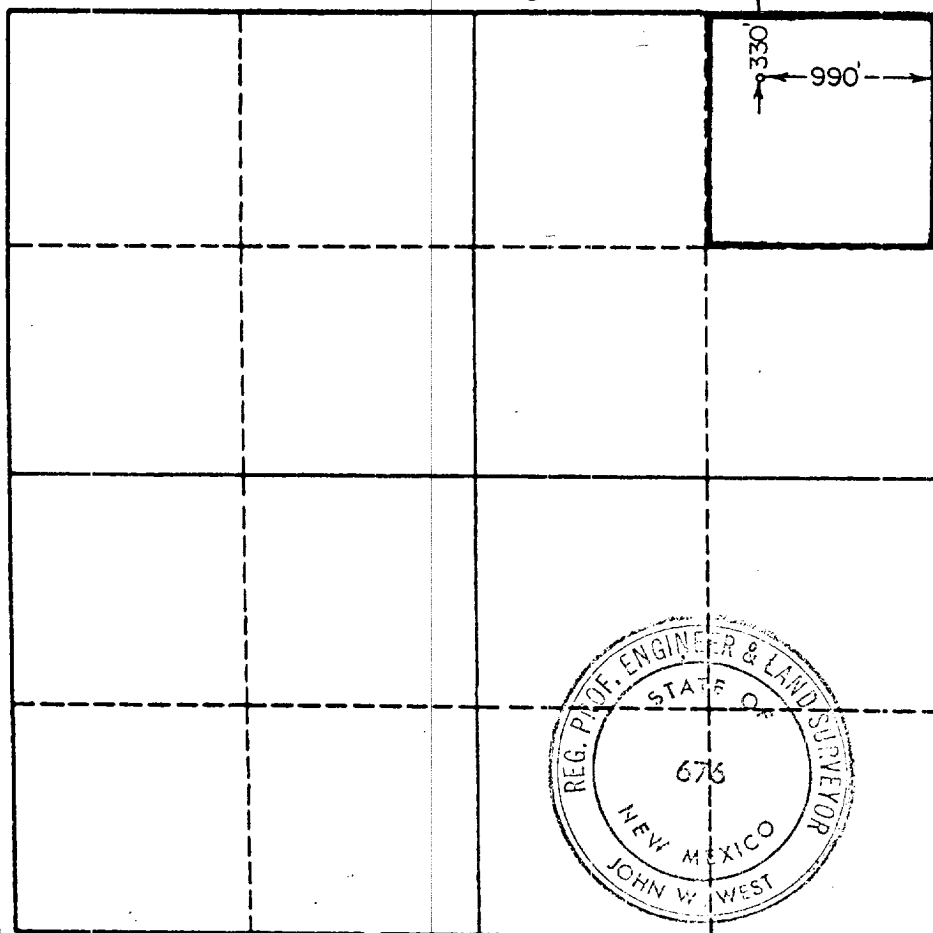

CERTIFICATION

I hereby certify that the information in SECTION A above is true and complete to the best of my knowledge and belief.

Name	
Position	Area Supt.
Company	Pan American Petro. Corp.
Date	January 11, 1965

I hereby certify that the well location shown on the plat is SECTION B was plotted from field notes of actual surveys made by me or under my supervision, and that the same is true and correct to the best of my knowledge and belief.

Date Surveyed	1-5-65
Registered Professional Engineer and/or Land Surveyor, JOHN W. WEST	
John W. West	
Certificate No.	N.M. - P.E. & L.S. NO. 676