

NO. OF COPIES RECEIVED	
DISTRIBUTION	
SANTA FE	
FILE	
U.S.G.S.	
LAND OFFICE	
OPERATOR	

# NEW MEXICO OIL CONSERVATION COMMISSION

Form C-101  
Revised 1-1-65

AUG 30 7 51

5A. Indicate Type of Lease	
5. State Oil & Gas Lease No.	

E-1369

## APPLICATION FOR PERMIT TO DRILL, DEEPEN, OR PLUG BACK

1a. Type of Work		7. Unit Agreement Name	
b. Type of Well DRILL <input checked="" type="checkbox"/> DEEPEN <input type="checkbox"/> PLUG BACK <input type="checkbox"/> OIL WELL <input checked="" type="checkbox"/> GAS WELL <input type="checkbox"/> OTHER <input type="checkbox"/> SINGLE ZONE <input checked="" type="checkbox"/> MULTIPLE ZONE <input type="checkbox"/>		8. Farm or Lease Name Hobbs "T"	
2. Name of Operator Skelly Oil Company		9. Well No. 5	
3. Address of Operator Box 730 - Hobbs, New Mexico		10. Field and Pool, or Wildcat Chaveroo	
4. Location of Well UNIT LETTER <b>H</b> LOCATED <b>1980'</b> FEET FROM THE <b>North</b> LINE AND <b>660</b> FEET FROM THE <b>East</b> LINE OF SEC. <b>33</b> TWP. <b>7-S</b> RGE. <b>33-E</b> NMPM		12. County Roosevelt	
19. Proposed Depth 1475'		19A. Formation San Andres	
20. Rotary or C.T. Rotary		21. Elevations (Show whether DF, RT, etc.) Unknown	
21A. Kind & Status Plug Bond Blanket Bond No. 1253688 \$100000 w/Ped. Ins. Co		21B. Drilling Contractor Cactus Drilling Corp	
22. Approx. Date Work will start SEP 5 1965			

### PROPOSED CASING AND CEMENT PROGRAM

SIZE OF HOLE	SIZE OF CASING	WEIGHT PER FOOT	SETTING DEPTH	SACKS OF CEMENT	EST. TOP
11	8-5/8"	24#	350'	250	Surface
7-7/8"	4-1/2"	10.5#	1475'	250	3750'

The pump and plug process will be used on cementing both strings of casing and cement will be circulated to surface on the 8-5/8" OD surface casing. The 4-1/2" OD casing will be perforated and the San Andres Zone treated with approx. 2000 gallons of reg. acid.

IN ABOVE SPACE DESCRIBE PROPOSED PROGRAM: IF PROPOSAL IS TO DEEPEN OR PLUG BACK, GIVE DATA ON PRESENT PRODUCTIVE ZONE AND PROPOSED NEW PRODUCTIVE ZONE. GIVE BLOWOUT PREVENTER PROGRAM, IF ANY.

I hereby certify that the information above is true and complete to the best of my knowledge and belief.

Signed (ORIGINAL SIGNED) H. E. Aab Title District Superintendent Date August 25, 1965  
(This space for State Use)

APPROVED BY \_\_\_\_\_ TITLE \_\_\_\_\_ DATE \_\_\_\_\_

CONDITIONS OF APPROVAL, IF ANY:

NEW MEXICO OIL CONSERVATION COMMISSION  
WELL LOCATION AND ACREAGE DEDICATION PLAT

Form No. 1  
Supervisors Use Only  
Effective 1-1-64

All distances must be from the outer boundaries of the Section.

Operator <b>SKELLY OIL COMPANY</b>				Lease <b>AUG 30 7 51 AM '65</b> <b>HOBBS</b>		Well No. <b>5</b>
Unit Letter <b>H</b>	Section <b>33</b>	Township <b>7 SOUTH</b>	Range <b>33 EAST</b>	County <b>ROOSEVELT</b>		
Actual Footage Location of Well: <b>1980</b> feet from the <b>NORTH</b> line and <b>660</b> feet from the <b>EAST</b> line.						
Ground Level Elev.	Producing Formation <b>San Andres</b>		Pool <b>Chavero</b>	Desired Acreage <b>40</b>		

1. Outline the acreage dedicated to the subject well by colored pencil or hachure marks on the plat below.
2. If more than one lease is dedicated to the well, outline each and identify the ownership thereof (both as to working interest and royalty).
3. If more than one lease of different ownership is dedicated to the well, have the interests of all owners been consolidated by communitization, unitization, force-pooling, etc?

☐ Yes ☐ No If answer is "yes," type of consolidation \_\_\_\_\_

If answer is "no," list the owners and tract descriptions which have actually been consolidated. (Use reverse side of this form if necessary.) \_\_\_\_\_

No allowable will be assigned to the well until all interests have been consolidated (by communitization, unitization, forced-pooling, or otherwise) or until a non-standard unit, eliminating such interests, has been approved by the Commission.

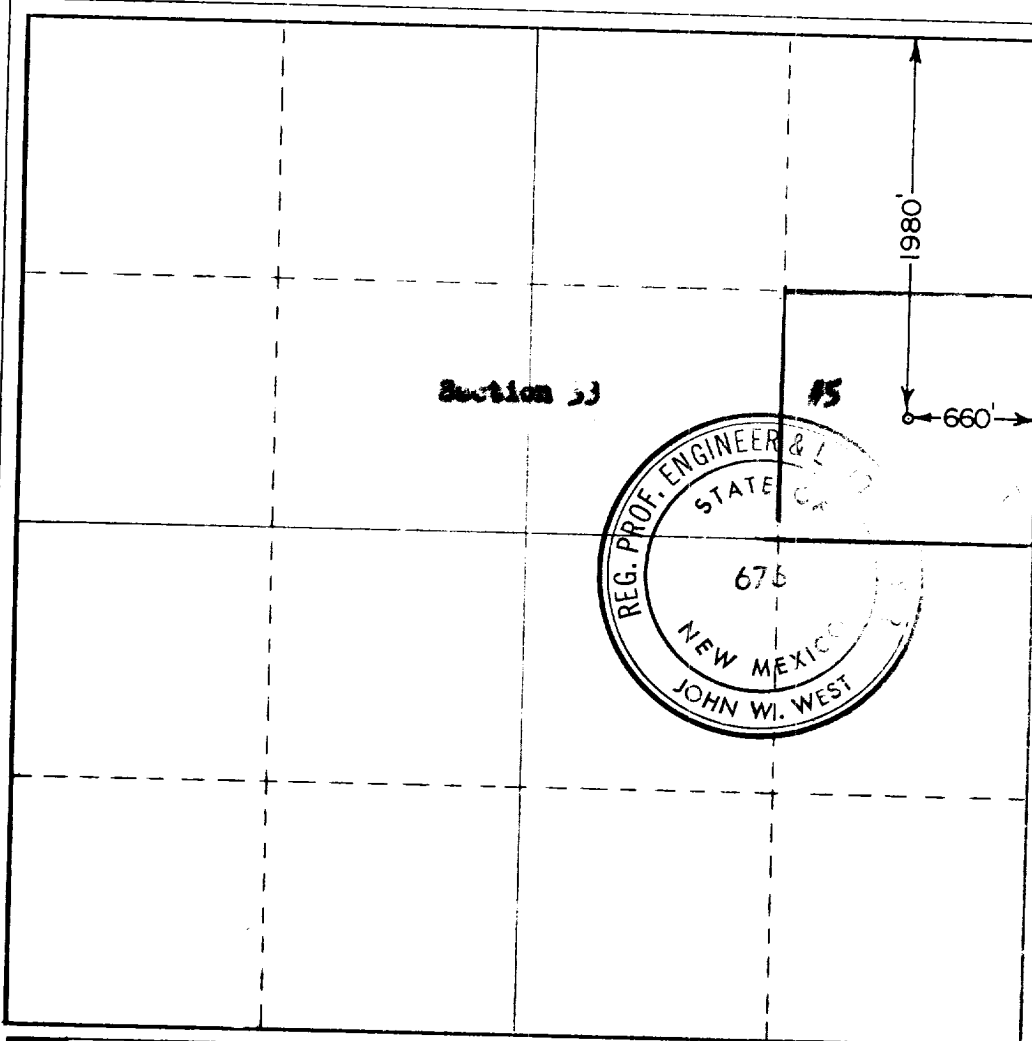

CERTIFICATION

I hereby certify that the information contained herein is true and complete to the best of my knowledge and belief.

(ORIGINAL)  
(SIGNED) **H. E. Aab**  
Position  
**District Superintendent**  
Company  
**Skelly Oil Company**

Date  
**August 25, 1965**

I hereby certify that the well location shown on this plat was plotted from field notes of actual surveys made by me or under my supervision, and that the same is true and correct to the best of my knowledge and belief.

Date Surveyed  
**AUGUST 23, 1965**

Registered Professional Engineer and/or Land Surveyor

*John W. West*  
Certificate No.

676

