

UNITED STATES  
DEPARTMENT OF THE INTERIOR  
GEOLOGICAL SURVEY

## APPLICATION FOR PERMIT TO DRILL, DEEPEN, OR PLUG BACK

## 1a. TYPE OF WORK

DRILL ☒DEEPEN ☐PLUG BACK ☐

## b. TYPE OF WELL

OIL  
WELL ☒GAS  
WELL ☐

OTHER

SINGLE  
ZONE ☒MULTIPLE  
ZONE ☐

## 2. NAME OF OPERATOR

Socony Mobil Oil Company, Inc.

## 3. ADDRESS OF OPERATOR

Box 1800, Hobbs, New Mexico

## 4. LOCATION OF WELL (Report location clearly and in accordance with any State requirements.)\*

At surface

660' FSL &amp; 660' FEL

At proposed prod. zone

Unit P SE/4 SE/4

## 14. DISTANCE IN MILES AND DIRECTION FROM NEAREST TOWN OR POST OFFICE\*

4 miles west of Milnesand, New Mexico

## 15. DISTANCE FROM PROPOSED\*

LOCATION TO NEAREST  
PROPERTY OR LEASE LINE, FT.  
(Also to nearest drlg. line, if any)

## 18. DISTANCE FROM PROPOSED LOCATION\*

TO NEAREST WELL, DRILLING, COMPLETED,  
OR APPLIED FOR, ON THIS LEASE, FT.

## 16. NO. OF ACRES IN LEASE

## 19. PROPOSED DEPTH

4800

17. NO. OF ACRES ASSIGNED  
TO THIS WELL

40

## 20. ROTARY OR CABLE TOOLS

Rotary

## 21. ELEVATIONS (Show whether DF, RT, GR, etc.)

NA

## 22. APPROX. DATE WORK WILL START\*

## 23.

## PROPOSED CASING AND CEMENTING PROGRAM

SIZE OF HOLE	SIZE OF CASING	WEIGHT PER FOOT	SETTING DEPTH	QUANTITY OF CEMENT
12 1/4"	8 5/8"	24 #	350	Circulate
7 7/8"	4 1/2"*	9.5#	4800	2500 sx.

\* If surplus 5 1/2" 14# J-55 casing available, it will be used instead of 4 1/2".

Drilling medium to be drilling mud surface to 350', then fresh water, brine water plus flosal & drispac as needed to clean hole and obtain samples to TD. Acoustic-Gamma Ray log will be run surface to TD. Laterolog from 2400' to TD.

IN ABOVE SPACE DESCRIBE PROPOSED PROGRAM: If proposal is to deepen or plug b. zone. If proposal is to drill or deepen directionally, give pertinent data on sub-preventer program, if any.

Give data on present productive zone and proposed new productive locations and measured and true vertical depths. Give blowout

SIGNED

*J. J. McDaniel*

TITLE

Group Supervisor

DATE

11/4/64

(This space for Federal or State office use)

PERMIT NO.

APPROVAL DATE

APPROVED BY

TITLE

CONDITIONS OF APPROVAL, IF ANY:

\*See Instructions On Reverse Side

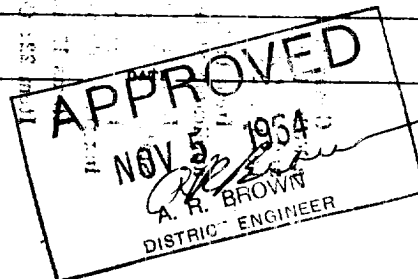

NEW MEXICO OIL CONSERVATION COMMISSION

Well Location and Acreage Dedication Plat

Section A.

Date November 4, 1964

Operator Socony Mobil Oil Company, Inc. Lease Jacobs Federal  
Well No. 6 Unit Letter P Section 19 Township E S Range 35 E NMPH  
Located 660 Feet From South Line, 660 Feet From East Line  
County Roosevelt G. L. Elevation 4220 Dedicated Acreage 40 Acres  
Name of Producing Formation San Andres Pool Undesignated

1. Is the Operator the only owner\* in the dedicated acreage outlined on the plat below?  
Yes X No       .
2. If the answer to question one is "no," have the interests of all the owners been consolidated by communitization agreement or otherwise? Yes        No       . If answer is "yes," Type of Consolidation
3. If the answer to question two is "no," list all the owners and their respective interests below:

Owner

Land Description

Section B.

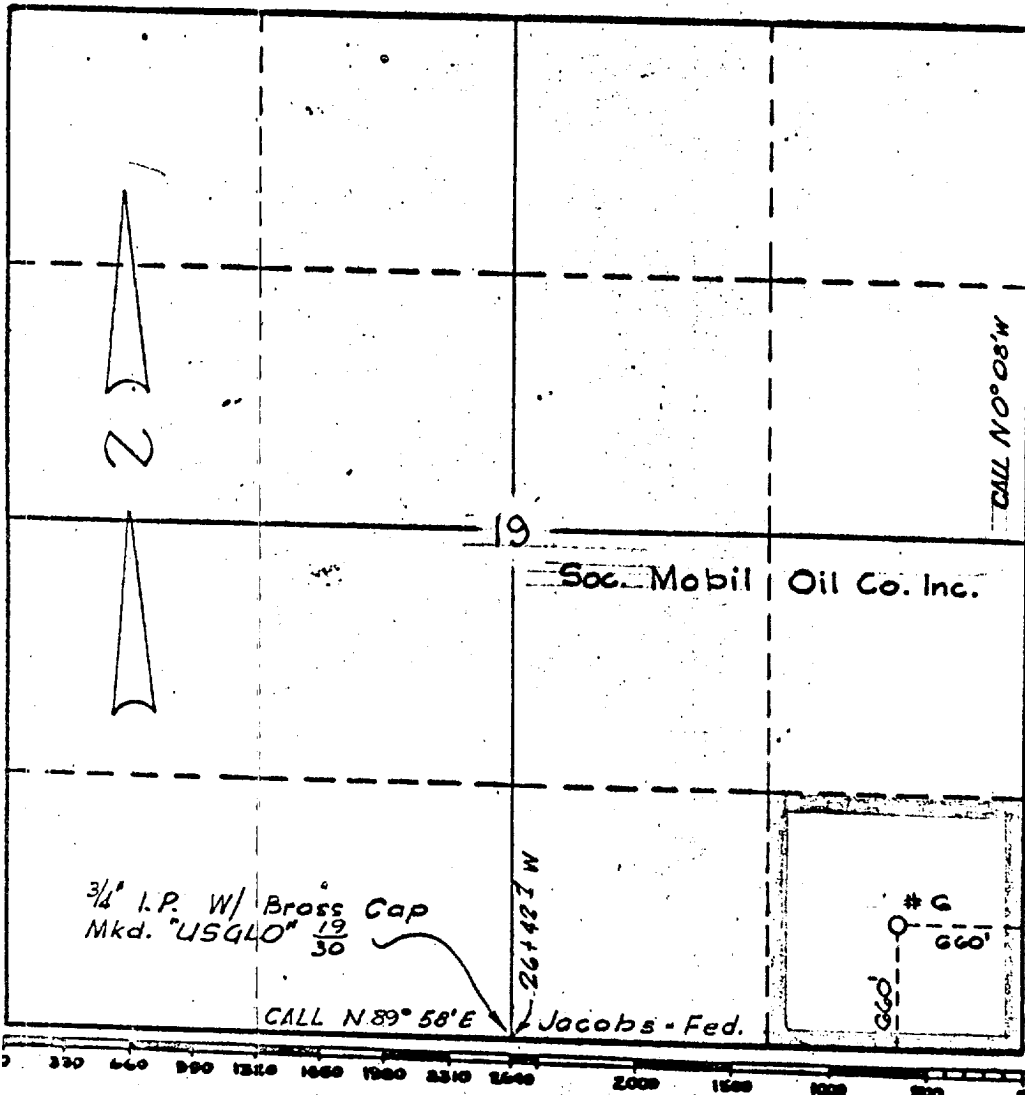

This is to certify that the information in Section A above is true and complete to the best of my knowledge and belief.

Socony Mobil Oil Company, Inc.

(Operator)

(Representative)

Box 1800, Hobbs, New Mexico  
Address

This is to certify that the well location shown on the plat in Section B was plotted from field notes of actual surveys made by me or under my supervision and that the same is true and correct to the best of my knowledge and belief.

Date Surveyed 10/30/64

Registered Professional Engineer and/or Land Surveyor.

Certificate No. 3959