

UNITED STATES
DEPARTMENT OF THE INTERIOR
GEOLOGICAL SURVEY

APPLICATION FOR PERMIT TO DRILL, DEEPEN, OR PLUG BACK

1a. TYPE OF WORK

DRILL ☒DEEPEN ☐PLUG BACK ☐

b. TYPE OF WELL

OIL
WELL ☒GAS
WELL ☐

OTHER

SINGLE
ZONE ☒MULTIPLE
ZONE ☐

2. NAME OF OPERATOR

Sweeney Mobil Oil Company, Inc.

3. ADDRESS OF OPERATOR

P. O. Box 1800, Hobbs, New Mexico

4. LOCATION OF WELL (Report location clearly and in accordance with any State requirements.)

At surface

660' FS&WL of Sec.

At proposed prod. zone

Unit "M" SW/4 SW/4

14. DISTANCE IN MILES AND DIRECTION FROM NEAREST TOWN OR POST OFFICE*

3 mi. west of Milnesand, New Mexico

15. DISTANCE FROM PROPOSED*

LOCATION TO NEAREST
PROPERTY OR LEASE LINE, FT.
(Also to nearest Crig. line, if any)18. DISTANCE FROM PROPOSED LOCATION*
TO NEAREST WELL, DRILLING, COMPLETED,
OR APPLIED FOR, ON THIS LEASE, FT.

16. NO. OF ACRES IN LEASE

2386.94

19. PROPOSED DEPTH

4,800

17. NO. OF ACRES ASSIGNED
TO THIS WELL

40

20. ROTARY OR CABLE TOOLS

Rotary

21. ELEVATIONS (Show whether DF, RT, GR, etc.)

NA

22. APPROX. DATE WORK WILL START*

23. PROPOSED CASING AND CEMENTING PROGRAM

SIZE OF HOLE	SIZE OF CASING	WEIGHT PER FOOT	SETTING DEPTH	QUANTITY OF CEMENT
12 1/4"	8 5/8"	24#	350'	Circulate
6 3/4"	4 1/2"	9.5#	4,800'	2,500 sks.

Drilling medium to be drilling mud, surface to 350'. Then fresh water, brine water plus lime & Gel as needed to obtain samples & clean hole. GR-Sonic, Caliper & resistivity logs will be run, surface to TD.

IN ABOVE SPACE DESCRIBE PROPOSED PROGRAM: If proposal is to deepen or plug b. zone. If proposal is to drill or deepen directionally, give pertinent data on sub-preventer program, if any.

Give data on present productive zone and proposed new productive locations and measured and true vertical depths. Give blowout

24.

SIGNED

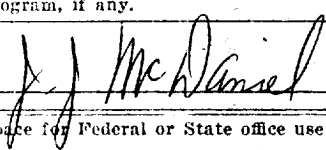

TITLE

Group Supervisor

DATE

11-25-64

(This space for Federal or State office use)

PERMIT NO.

APPROVAL DATE

APPROVED BY

TITLE

CONDITIONS OF APPROVAL, IF ANY:

*See Instructions On Reverse Side

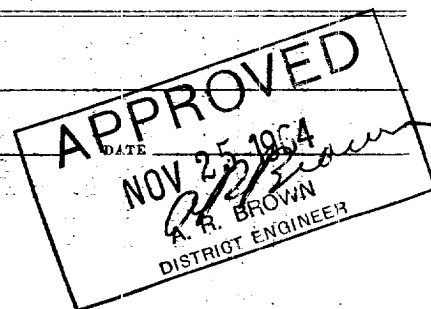

NEW MEXICO OIL CONSERVATION COMMISSION
Well Location and Acreage Dedication Plat

Section A.

Date 11-20-64

Operator Socony Mobil Oil Company, Inc. Lease Jacobs Federal
Well No. 8 Unit Letter M Section 20 Township 8S Range 35E NMPM
Located 660 Feet From South Line, 660 Feet From West Line
County Roosevelt G. L. Elevation 4210 Dedicated Acreage 40 Acres
Name of Producing Formation San Andres Pool Undesignated

1. Is the Operator the only owner* in the dedicated acreage outlined on the plat below?
Yes X No .
2. If the answer to question one is "no," have the interests of all the owners been consolidated by communitization agreement or otherwise? Yes No . If answer is "yes," Type of Consolidation
3. If the answer to question two is "no," list all the owners and their respective interests below:

Owner

Land Description

Section B.

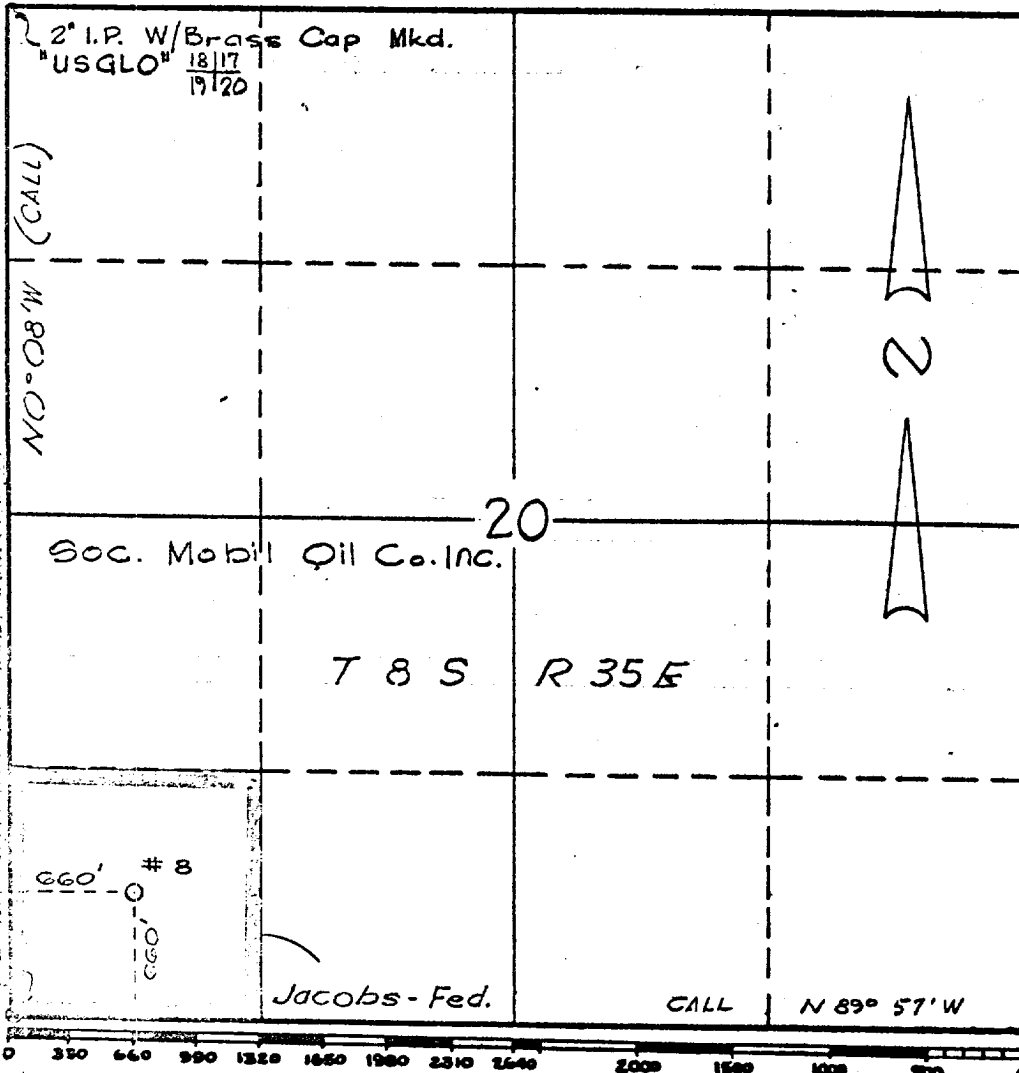

This is to certify that the information in Section A above is true and complete to the best of my knowledge and belief.

Socony Mobil Oil Company, Inc.

(Operator)

J. J. McDaniel
(Representative)

Box 1800, Hobbs, New Mexico
Address

This is to certify that the well location shown on the plat in Section B was plotted from field notes of actual surveys made by me or under my supervision and that the same is true and correct to the best of my knowledge and belief.

Date Surveyed 11-11-64

William D. Starn
Registered Professional
Engineer and/or Land Surveyor.

Certificate No. 3959