

UNITED STATES
DEPARTMENT OF THE INTERIOR
GEOLOGICAL SURVEY

APPLICATION FOR PERMIT TO DRILL, DEEPEN, OR PLUG BACK

1a. TYPE OF WORK DRILL <input checked="" type="checkbox"/> DEEPEN <input type="checkbox"/> PLUG BACK <input type="checkbox"/>		5. LEASE DESIGNATION AND SERIAL NO. LC 060978	
b. TYPE OF WELL OIL WELL <input checked="" type="checkbox"/> GAS WELL <input type="checkbox"/> OTHER <input type="checkbox"/>		6. IF INDIAN, ALLOTTEE OR TRIBE NAME	
2. NAME OF OPERATOR Bacony Mobil Oil Company, Inc.		7. UNIT AGREEMENT NAME	
3. ADDRESS OF OPERATOR Box 1800, Hobbs, New Mexico		8. FARM OR LEASE NAME Jacobs Federal	
4. LOCATION OF WELL (Report location clearly and in accordance with any State requirements.)* At surface 1720' FSL & 660' FWL of Sec. At proposed prod. zone Unit "L" NW/4 SW/4		9. WELL NO. 10	
14. DISTANCE IN MILES AND DIRECTION FROM NEAREST TOWN OR POST OFFICE* 3 miles west Milnesand, New Mexico		10. FIELD AND POOL, OR WILDCAT Milnesand San Andres	
15. DISTANCE FROM PROPOSED* LOCATION TO NEAREST PROPERTY OR LEASE LINE, FT. (Also to nearest dsg. line, if any)		11. SEC., T., R., M., OR BLK. AND SURVEY OR AREA 20 8S 35E	
16. NO. OF ACRES IN LEASE 2386.94		12. COUNTY OR PARISH Roosevelt	
17. NO. OF ACRES ASSIGNED TO THIS WELL 40		13. STATE New Mexico	
18. DISTANCE FROM PROPOSED LOCATION* TO NEAREST WELL DRILLING, COMPLETED, OR APPLIED FOR, ON THIS LEASE, FT. 4,800		20. ROTARY OR CABLE TOOLS Rotary	
21. ELEVATIONS (Show whether DF, RT, GR, etc.) 4213 GR		22. APPROX. DATE WORK WILL START*	

PROPOSED CASING AND CEMENTING PROGRAM

SIZE OF HOLE	SIZE OF CASING	WEIGHT PER FOOT	SETTING DEPTH	QUANTITY OF CEMENT
12 1/4"	8 5/8"	24#	350	Circulate
6 3/4"	4 1/2"	9.5#	4800	2,500 sks.

Drilling medium to be drilling mud, surface to 350'. Then fresh water, brine water plus lime & gel as needed to obtain samples & clean hole. GR-Sonic, Caliper & resistivity logs will be run, surface to TD.

IN ABOVE SPACE DESCRIBE PROPOSED PROGRAM: If proposal is to deepen or plug b. zone. If proposal is to drill or deepen directionally, give pertinent data on subs. preventer program, if any.

Give data on present productive zone and proposed new productive locations and measured and true vertical depths. Give blowout

24. SIGNED J. J. McDaniel TITLE Group Supervisor DATE 12-28-64
(This space for Federal or State office use)

PERMIT NO. _____ APPROVAL DATE _____

APPROVED BY _____ TITLE _____
CONDITIONS OF APPROVAL, IF ANY:

*See Instructions On Reverse Side

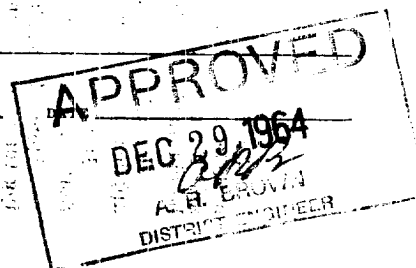

NEW MEXICO OIL CONSERVATION COMMISSION

Well Location and Acreage Dedication Plat

Section A.

Date December 23, 1964

Operator Socony Mobil Oil Company, Inc. Lease Jacobs Federal
Well No. 10 Unit Letter L Section 20 Township 8S Range 35E NMPH
Located 1720 Feet From South Line, 660 Feet From West Line
County Roosevelt G. L. Elevation 4213 Dedicated Acreage 40 Acres
Name of Producing Formation San Andres Pool Milnesand

1. Is the Operator the only owner* in the dedicated acreage outlined on the plat below?
Yes X No .
2. If the answer to question one is "no," have the interests of all the owners been consolidated by communitization agreement or otherwise? Yes No . If answer is "yes," Type of Consolidation
3. If the answer to question two is "no," list all the owners and their respective interests below:

Owner

Land Description

Section B.

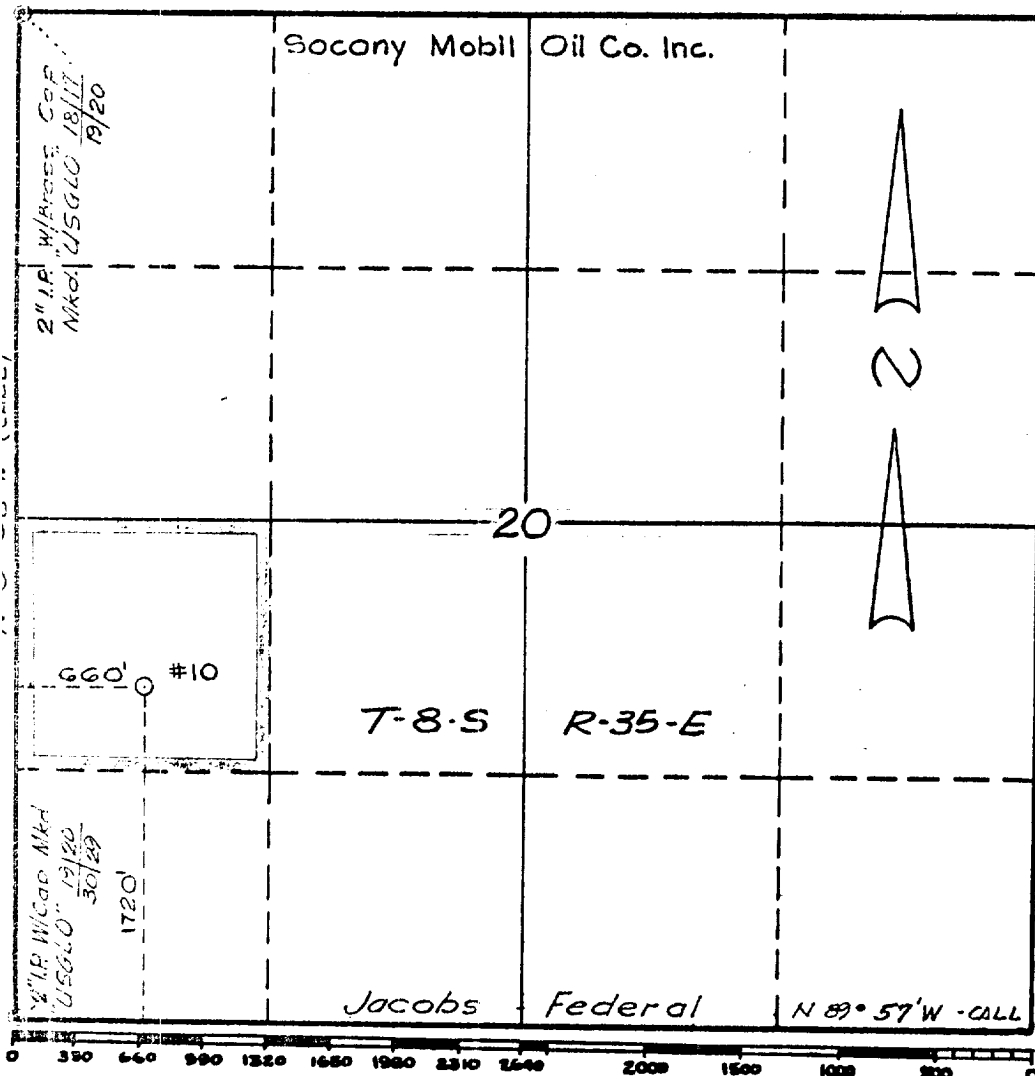

This is to certify that the information in Section A above is true and complete to the best of my knowledge and belief.

Socony Mobil Oil Company, Inc.

(Operator)

(Representative)

Box 1800, Hobbs, New Mexico
Address

This is to certify that the well location shown on the plat in Section B was plotted from field notes of actual surveys made by me or under my supervision and that the same is true and correct to the best of my knowledge and belief.

Date Surveyed 12-21-64

Registered Professional
Engineer and/or Land Surveyor.

Certificate No. 3959