

NUMBER OF COPIES RECEIVED	
DISTRIBUTION	
SANTA FE	
FILE	
U.S.G.S.	
LAND OFFICE	
TRANSPORTER	OIL GAS
PRODUCTION OFFICE	
OPERATOR	

NEW M CO OIL CONSERVATION COMMISSION
Santa Fe, New Mexico

Form G-101
Revised (12/1/55)

NOTICE OF INTENTION TO DRILL

Notice must be given to the District Office of the Oil Conservation Commission and approval obtained before drilling or recompletion begins. If changes in the proposed plan are considered advisable, a copy of this notice showing such changes will be returned to the operator. Submit this notice in **QUINTUPLICATE**. One copy will be returned following approval. See additional instructions in Rules and Regulations of the Commission. If State Land submit 6 Copies Attach Form G-128 in triplicate to first 3 copies of form G-101

January 23, 1963

Box 2880, Dallas, Texas

(Date)

OIL CONSERVATION COMMISSION
SANTA FE, NEW MEXICO

Gentlemen:

You are hereby notified that it is our intention to commence the Drilling of a well to be known as

Sun Oil Company

(Company, or Operator)

G. M. Cosby
(Lease)

, Well No. **2**, in **1941** (Unit) The well is

located **1980** feet from the **North** line and **660** feet from the

East

line of Section **12**, T. **38**, R. **34E**, NMPM.

(GIVE LOCATION FROM SECTION LINE) **Wilkesand - San Andres Pool, Roosevelt** County

If State Land the Oil and Gas Lease is No.

If patented land the owner is **G. M. Cosby**

Address **Box 168, Elmer, Texas**

We propose to drill well with drilling equipment as follows: **Rotary**

The status of plugging bond is **\$10,000.00 Blanket bond filed with State Land Office**

Drilling Contractor **(Un-Known)**

We intend to complete this well in the **San Andres Pay** formation at an approximate depth of **4550** feet.

CASING PROGRAM

We propose to use the following strings of Casing and to cement them as indicated:

Size of Hole	Size of Casing	Weight per Foot	New or Second Hand	Depth	Sacks Cement
12-1/4"	8-5/8"	24-lb	New	350'	225
7-7/8"	4-1/2"	9.5-lb	New	4700'	200

If changes in the above plans become advisable we will notify you immediately.

ADDITIONAL INFORMATION (If recompletion give full details of proposed plan of work.)

Approved _____, 19_____
Except as follows:

Sincerely yours,

Sun Oil Company
(Company or Operator)

By _____

Position **Division Superintendent**
Send Communications regarding well to

Name **A. S. Rhea**

Address **Dallas, Texas**

OIL CONSERVATION COMMISSION

By _____

NUMBER OF COPIES RECEIVED	
DISTRIBUTION	
SANTA FE	
FILE	
U.S.G.S.	
LAND OFFICE	
TRANSPORTER	01- 243
PRODUCTION OFFICE	
OPERATOR	

NEW MEXICO OIL CONSERVATION COMMISSION
WELL LOCATION AND ACREAGE DEDICATION PLAT
 SEE INSTRUCTIONS FOR COMPLETING THIS FORM ON THE REVERSE SIDE

FORM C-128
 Revised 5/1/57

200 JUN 22 PM 2:35

SECTION A

Operator Sun Oil Company		Lease G. H. Cosby		Well No. 2
Unit Letter 1000	Section 12	Township 8S	Range 34E	County Roosevelt
Actual Footage Location of Well: 1980 feet from the North line and 660 feet from the East line Ground Level Elev. 4249 Producing Formation San Andres Pay Pool Milnesand - San Andres Dedicated Acreage: 40 Acres				

1. Is the Operator the only owner in the dedicated acreage outlined on the plat below? YES _____ NO X . ("Owner" means the person who has the right to drill into and to produce from any pool and to appropriate the production either for himself or for himself and another. (65-3-29 (e) NMSA 1935 Comp.)
2. If the answer to question one is "no," have the interests of all the owners been consolidated by communitization agreement or otherwise? YES X NO ____ . If answer is "yes," Type of Consolidation Operating agreement between working interests.
3. If the answer to question two is "no," list all the owners and their respective interests below:

Owner	Land Description

SECTION B

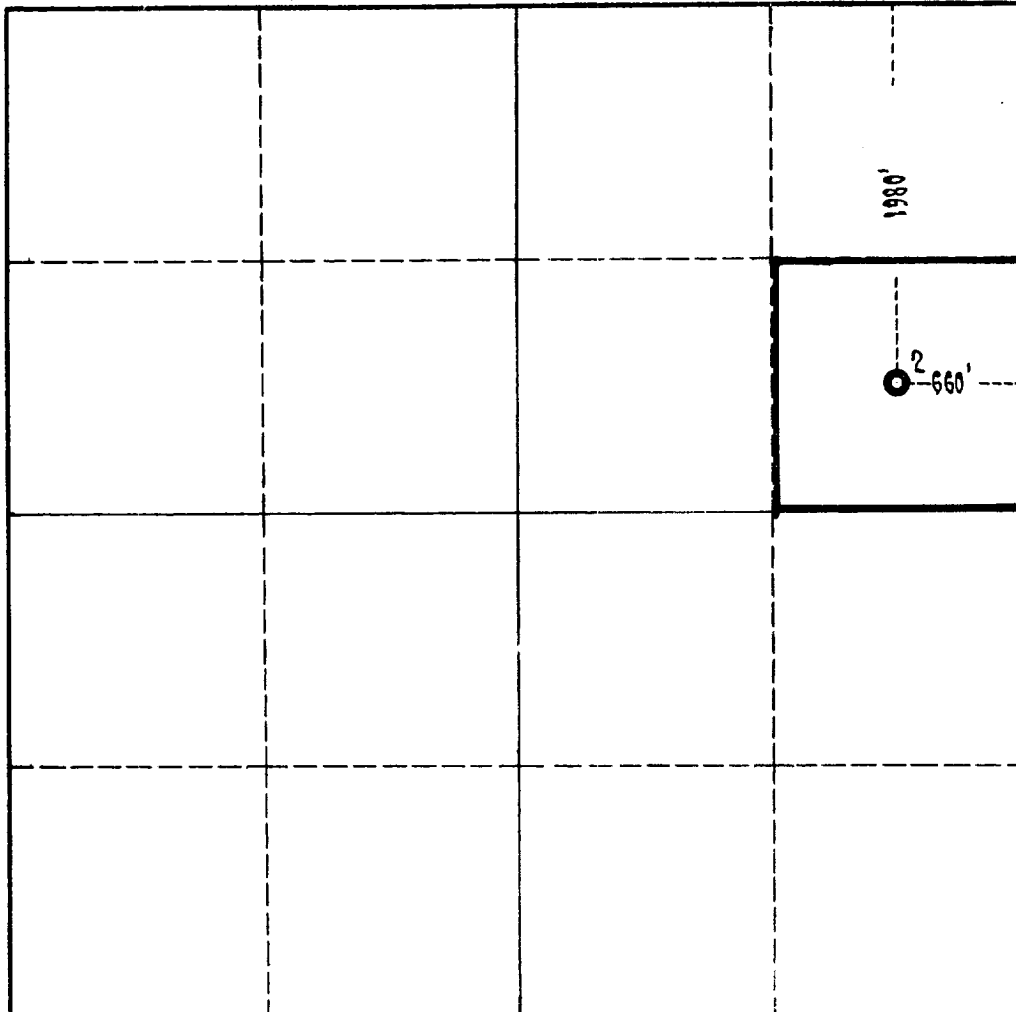

CERTIFICATION

I hereby certify that the information in SECTION A above is true and complete to the best of my knowledge and belief.

Name [Signature]
 Division Superintendent
 Position

Sun Oil Company
 Company

P.O. Box 2880, Dallas, Tex.
 Date

January 23, 1963

I hereby certify that the well location shown on the plat in SECTION B was plotted from field notes of actual surveys made by me or under my supervision, and that the same is true and correct to the best of my knowledge and belief.

Date Surveyed Jan 18 1963
 Registered Professional Engineer
 and/or Land Surveyor

[Signature]
 Certificate No. **3050**

0 330 660 990 1320 1650 1980 2310 2640 2000 1500 1000 500 0

INSTRUCTIONS FOR COMPLETION OF FORM C-128

1. Operator shall furnish and certify to the information called for in Section A.
2. Operator shall outline the dedicated acreage for *both* oil and gas wells on the plat in Section B.
3. A registered professional engineer or land surveyor registered in the State of New Mexico or approved by the Commission shall show on the plat the location of the well and certify this information in the space provided.
4. All distances shown on the plat must be from the outer boundaries of the Section.
5. If additional space is needed for listing owners and their respective interests as required in question 3 of Section A, please use space below.