

NO. OF COPIES RECEIVED	
DISTRIBUTION	
SANTA FE	
FILE	
U.S.G.S.	
LAND OFFICE	
OPERATOR	

NEW MEXICO OIL CONSERVATION COMMISSION

Form C-101
Revised 1-1-65

Aug 9 8 20 AM '65

5A. Indicate Type of Lease STATE <input checked="" type="checkbox"/> FEE <input type="checkbox"/>	
5. State Oil & Gas Lease No. K-3935	
7. Unit Agreement Name	
8. Farm or Lease Name N. M. State "AZ"	
9. Well No. 7	
10. Field and Pool, or Wildcat Chaveroo	
12. County Roosevelt	
19. Proposed Depth 4530'	19A. Formation San Andres
20. Rotary or C.T. Rotary	
21. Elevations (Show whether DF, RT, etc.) 4435 DF EST.	21A. Kind & Status Plug. Bond Approved
21B. Drilling Contractor Cactus Drilling Co.	
22. Approx. Date Work will start August 9, 1965	

APPLICATION FOR PERMIT TO DRILL, DEEPEN, OR PLUG BACK

1a. Type of Work b. Type of Well OIL WELL <input checked="" type="checkbox"/> GAS WELL <input type="checkbox"/> OTHER <input type="checkbox"/> SINGLE ZONE <input checked="" type="checkbox"/> MULTIPLE ZONE <input type="checkbox"/>		2. Name of Operator Sunray DX Oil Company	
3. Address of Operator P. O. Box 1416, Roswell, New Mexico		4. Location of Well UNIT LETTER I LOCATED 1980' FEET FROM THE South LINE AND 660' V FEET FROM THE East LINE OF SEC. 33 TWP. 7S RGE. 33E NMPM	
21. Elevations (Show whether DF, RT, etc.) 4435 DF EST.		21A. Kind & Status Plug. Bond Approved	
21B. Drilling Contractor Cactus Drilling Co.		22. Approx. Date Work will start August 9, 1965	

PROPOSED CASING AND CEMENT PROGRAM

SIZE OF HOLE	SIZE OF CASING	WEIGHT PER FOOT	SETTING DEPTH	SACKS OF CEMENT	EST. TOP
12 1/4"	8-5/8"	24#	350'	250	Circulate
7 7/8"	4-1/2"	9.5#	4530'	200	3700'

1. Drill 12-1/4" hole to approx 350'. Run 8-5/8", J-55, 24# csg to csg point 350'. Cement w/approx 250 sx regular cmt. WOC 18 hrs. test to 1000# 30 min.
2. Drill 7-7/8" hole to TD 4530'. Run logs. Run 4-1/2", J-55, 9.5# csg to csg point 4530'. Cmt w/approx 200 sx 50-50 Incore Pos. WOC 24 hrs. and test to 1000# 30 min.
3. Completion procedure to be determined after log analysis.

APPROVAL VALID
FOR 90 DAYS UNLESS
DRILLING COMMENCED.

EXPIRES

IN ABOVE SPACE DESCRIBE PROPOSED PROGRAM: IF PROPOSAL IS TO DEEPEN OR PLUG BACK, GIVE DATA ON PRESENT PRODUCTIVE ZONE AND PROPOSED NEW PRODUCTIVE ZONE. GIVE BLOWOUT PREVENTER PROGRAM, IF ANY.

I hereby certify that the information above is true and complete to the best of my knowledge and belief.

Signed B.F. Brawley Title District Engineer Date August 6, 1965

(This space for State Use)

APPROVED BY _____ TITLE _____ DATE _____

CONDITIONS OF APPROVAL, IF ANY:

**NEW MEXICO OIL CONSERVATION COMMISSION
WELL LOCATION AND ACREAGE DEDICATION PLAT**

Form C-102
Supersedes C-128
Effective 1-4-65

All distances must be from the outer boundaries of the Section.

Operator SUNRAY D-X OIL COMPANY				Lease No. 8 20 AM '65		Well No. 7
Unit Letter I	Section 33	Township 7 SOUTH	Range 33 EAST	County ROOSEVELT		
Actual Footage Location of Well: 1980 feet from the SOUTH line and 660 feet from the EAST line						
Geological Formation Permian	Producing Formation Permian	Pool Indefinite	Dedicated Acreage: 1.00 Acres			

1. Outline the acreage dedicated to the subject well by colored pencil or hatchure marks on the plat below.
2. If more than one lease is dedicated to the well, outline each and identify the ownership thereof (both as to working interest and royalty).
3. If more than one lease of different ownership is dedicated to the well, have the interests of all owners been consolidated by communitization unitization, force-pooling, etc?

☐ Yes ☐ No If answer is "yes," type of consolidation _____

If answer is "no," list the owners and tract descriptions which have actually been consolidated. (Use reverse side of this form if necessary.) _____

No allowable will be assigned to the well until all interests have been consolidated (by communitization, unitization, forced-pooling, or otherwise) or until a non-standard unit, eliminating such interests, has been approved by the Commission.

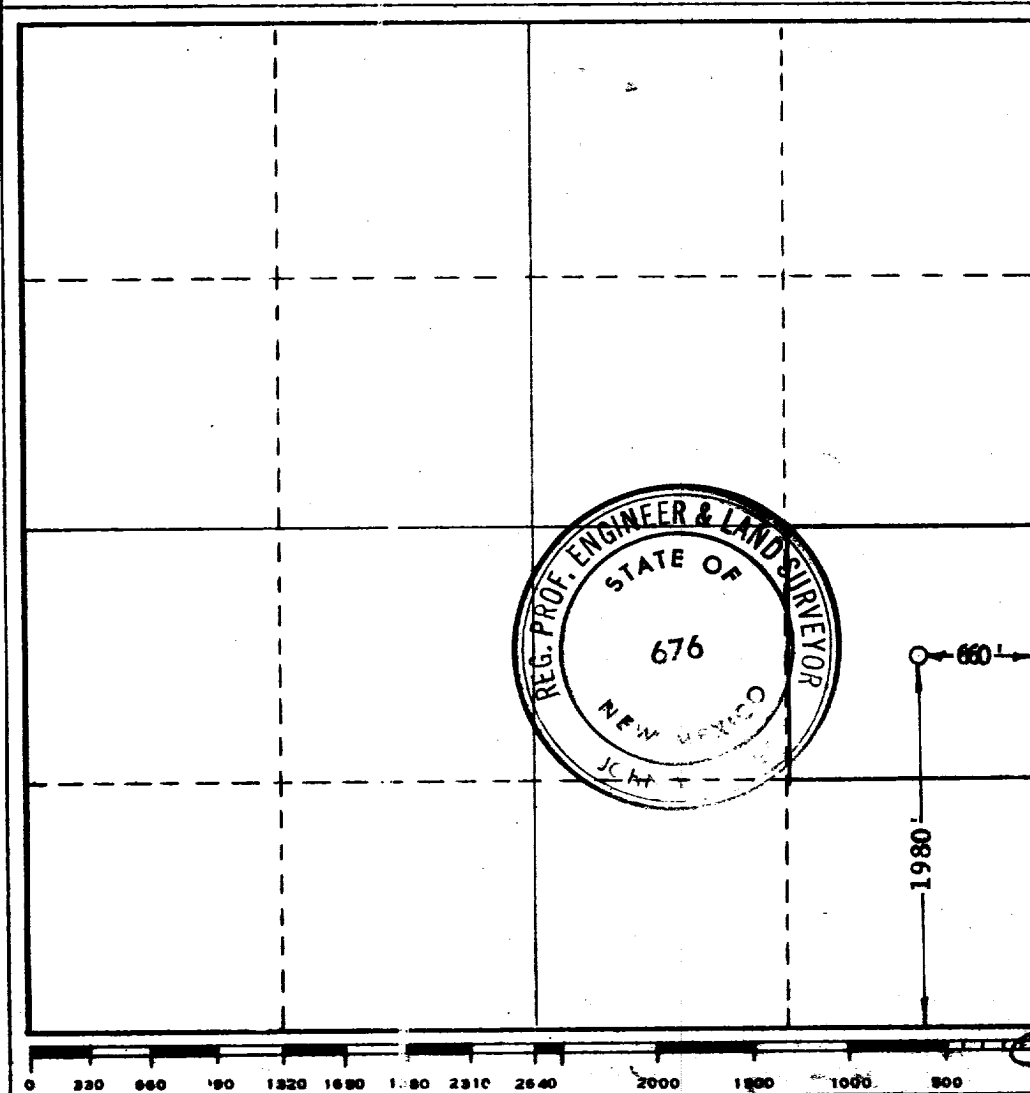

CERTIFICATION

I hereby certify that the information contained herein is true and complete to the best of my knowledge and belief.

Name **John W. West**
 Position **Registered Engineer**
 Company **Sunray D-X Oil Company**
 Date **August 6, 1965**

I hereby certify that the well location shown on this plat was plotted from field notes of actual surveys made by me or under my supervision, and that the same is true and correct to the best of my knowledge and belief.

Date Surveyed **7/31/65**
 Registered Professional Engineer and/or Land Surveyor
John W. West
 Certificate No. **NM PE & LS 676**