

NUMBER OF COPIES RECEIVED	
DISTRIBUTION	
SANTA FE	
FILE	
U.S.G.S.	
LAND OFFICE	
TRANSPORTER	OIL
	GAS
PHORATION OFFICE	
OPERATOR	

NEW MF OIL CONSERVATION COMMISS
Santa Fe, New Mexico

Form C-101
Revised (12/1/55)

OCT 2 8 46 AM '63

NOTICE OF INTENTION TO DRILL

Notice must be given to the District Office of the Oil Conservation Commission and approval obtained before drilling or recompleting begins. If changes in the proposed plan are considered advisable, a copy of this notice showing such changes will be returned to the sender. Submit this notice in **QUINTUPLICATE**. One copy will be returned following approval. See additional instructions in Rules and Regulations of the Commission. If State Land submit 6 Copies Attach Form C- 128 in triplicate to first 3 copies of form C-101

Midland, Texas
(Place)

October 2, 1963
(Date)

OIL CONSERVATION COMMISSION
SANTA FE, NEW MEXICO

Gentlemen:

You are hereby notified that it is our intention to commence the Drilling of a well to be known as
TEXACO Inc.

(Company, or Operator)

W. L. Rogers
(Lease)

Well No. **2**, in **A** (Unit) The well is

located **660** feet from the **North** line and **330** feet from the

East

Line of Section **25**, T **8S**, R **34E**, NMPM.

(GIVE LOCATION FROM SECTION LINE) **Milnesand San Andres** Dist, **Roosevelt** County

If State Land the Oil and Gas Lease is No

If patented land the owner is **Walter L. Rogers**

Address **East Star Rt., Box 3-A, Portales, New Mexico**
Rotary

We propose to drill well with drilling equipment as follows:

The status of plugging bond is **\$10,000 blanket surety bond of Maryland Casualty Co. filed with State Geologist**

Drilling Contractor **Unknown at present**

We intend to complete this well in the **San Andres** formation at an approximate depth of **4800** feet.

CASING PROGRAM

We propose to use the following strings of Casing and to cement them as indicated:

Size of Hole	Size of Casing	Weight per Foot	New or Second Hand	Depth	Sacks Cement
9-7/8"	7-5/8"	15.28	New	360'	250
6-3/4"	4-1/2"	9.5	New	4800'	350*
*Externally clean 4-1/2" casing 4550' TD & install centralizers & scratchers over same interval. Cement with 350 sx. Class "C", 4% gel.					

If changes in the above plans become advisable we will notify you immediately.

ADDITIONAL INFORMATION (If recompleting give full details of proposed plan of work.)

FORMATION TOPS EXPECTED

Anhydrite	2,210'	Base-Salt	2,610'	San Andres	3,892'	Total Depth
Top-Salt	2,280'	Yates	2,686'	Slaughter(Mkr)	4,515'	4800'

Approved....., 19.....
Except as follows:

Sincerely yours,

TEXACO Inc.

(Company or Operator)

By.....

Position **Assistant District Superintendent**

Send Communications regarding well to

Name **J. H. Markley**

Address **P.O. Box 3109-Midland, Texas**

OIL CONSERVATION COMMISSION

By.....

NEW MEXICO OIL CONSERVATION COMMISSION
WELL LOCATION AND ACREAGE DEDICATION PLAT

FORM C-128
 Revised 5/1/57

SEE INSTRUCTIONS FOR COMPLETING THIS FORM ON THE REVERSE SIDE

SECTION A

Operator TEXACO, Inc.		Lease W. L. Rogers		Well No. 2
Unit Letter A	Section 25	Township 9 South	Range 34 East	County Roosevelt
Actual Footage Location of Well: 660 feet from the North line and 330 feet from the East line				
Ground Level Elev.	Producing Formation San Andres	Pool Milnesand San Andres	Dedicated Acreage 40 Acres	

Depth: 4700'

1. Is the Operator the only owner in the dedicated acreage outlined on the plat below? YES ☒ NO ☐ *When well means the person who has the right to drill into and to produce from any pool and to appropriate the production either for himself or for himself and another. (65-3-29 (c) NMSA 1935 Comp.)*
2. If the answer to question one is "no," have the interests of all the owners been consolidated by communitization agreement or otherwise? YES ☐ NO ☐ If answer is "yes," Type of Consolidation _____
3. If the answer to question two is "no," list all the owners and their respective interests below:

Owner	Land Description

SECTION B

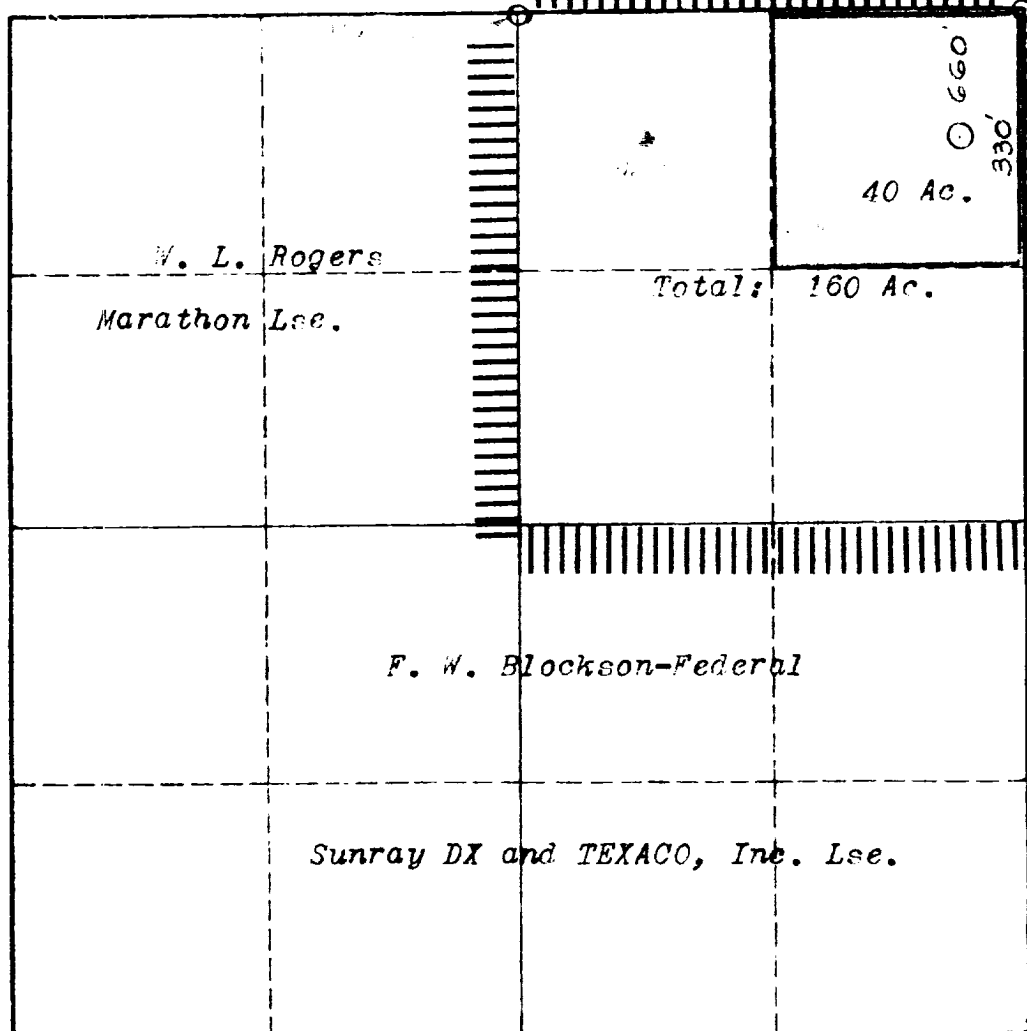

CERTIFICATION

I hereby certify that the information in SECTION A above is true and complete to the best of my knowledge and belief.

Name *[Signature]*
 Position **Assistant District Production Supt.**
 Company **TEXACO, Inc.**
 Date _____

I hereby certify that the well location shown on the plat in SECTION B was plotted from field notes of actual surveys made by me or under my supervision, and that the same is true and correct to the best of my knowledge and belief.

Date Surveyed **October 2, 1963**
 Registered Professional Engineer and/or Land Surveyor

[Signature]
 Certificate No. **1559**

0 330 660 990 1320 1650 1980 2310 2640 2000 1500 1000 500 0