

UNITED STATES  
DEPARTMENT OF THE INTERIOR

## GEOLOGICAL SURVEY

## APPLICATION FOR PERMIT TO DRILL, DEEPEN, OR PLUG BACK

1a. TYPE OF WORK DRILL <input checked="" type="checkbox"/> DEEPEN <input type="checkbox"/> PLUG BACK <input type="checkbox"/>			5. LEASE DESIGNATION AND SERIAL NO. <b>NM-016644</b>		
b. TYPE OF WELL OIL WELL <input checked="" type="checkbox"/> GAS WELL <input type="checkbox"/> OTHER <input type="checkbox"/> SINGLE ZONE <input checked="" type="checkbox"/> MULTIPLE ZONE <input type="checkbox"/>			6. IF INDIAN, ALLOTTEE OR TRIBE NAME		
2. NAME OF OPERATOR <b>Max M. Wilson</b>			7. UNIT AGREEMENT NAME		
3. ADDRESS OF OPERATOR <b>c/o Oil Reports &amp; Gas Services, Box 763, Hobbs, N. M.</b>			8. FARM OR LEASE NAME <b>Vincent Cuccia Federal</b>		
4. LOCATION OF WELL (Report location clearly and in accordance with any State requirements.)* At surface <b>660' FSL &amp; 660' FSL of Section 15</b> At proposed prod. zone			9. WELL NO. <b>1</b>		
14. DISTANCE IN MILES AND DIRECTION FROM NEAREST TOWN OR POST OFFICE* <b>7 1/2 miles NW Milnesand</b>			10. FIELD AND POOL, OR WILDCAT <b>Wildcat</b>		
15. DISTANCE FROM PROPOSED* LOCATION TO NEAREST PROPERTY OR LEASE LINE, FT. (Also to nearest drlg. unit line, if any) <b>660'</b>			11. SEC., T., R., M., OR BLK. AND SURVEY OR AREA <b>Sec. 15, T7S, R34E</b>		
16. NO. OF ACRES IN LEASE			12. COUNTY OR PARISH <b>Roosevelt</b>		
17. NO. OF ACRES ASSIGNED TO THIS WELL <b>40</b>			13. STATE <b>N. M.</b>		
18. DISTANCE FROM PROPOSED LOCATION* TO NEAREST WELL, DRILLING, COMPLETED, OR APPLIED FOR, ON THIS LEASE, FT.			19. PROPOSED DEPTH <b>4800</b>		
20. ROTARY OR CABLE TOOLS <b>Rotary</b>			21. ELEVATIONS (Show whether DF, RT, GR, etc.)		
22. APPROX. DATE WORK WILL START* <b>9/13/65</b>					

## 23. PROPOSED CASING AND CEMENTING PROGRAM

SIZE OF HOLE	SIZE OF CASING	WEIGHT PER FOOT	SETTING DEPTH	QUANTITY OF CEMENT
11"	8 5/8	24#	300	Circulated
7 7/8"	4 1/2	9.5#	4800	250

The above is proposed for a 4800' San Andres test. If commercial production is encountered 4 1/2" casing to be set at total depth, perforated and formation treated as deemed necessary.

IN ABOVE SPACE DESCRIBE PROPOSED PROGRAM: If proposal is to deepen or plug back, give data on present productive zone and proposed new productive zone. If proposal is to drill or deepen directionally, give pertinent data on subsurface locations and measured and true vertical depths. Give blowout preventer program, if any.

24. SIGNED H. L. Smut TITLE Agent DATE Sept. 9, 1965

(This space for Federal or State office use)

PERMIT NO. \_\_\_\_\_ APPROVAL DATE \_\_\_\_\_

APPROVED BY \_\_\_\_\_ TITLE \_\_\_\_\_ DATE \_\_\_\_\_

CONDITIONS OF APPROVAL, IF ANY:

APPROVED

SEP 15 1965

\*See Instructions On Reverse Side

J. L. GORDON  
ACTING DISTRICT ENGINEER

## Instructions

**General:** This form is designed for submitting proposals to perform certain well operations, as indicated, on all types of lands and leases for appropriate action by either a Federal or a State agency, or both, pursuant to applicable Federal and/or State laws and regulations. Any necessary special instructions concerning the use of this form and the number of copies to be submitted, particularly with regard to local, area, or regional procedures and practices, either are shown below or will be issued by, or may be obtained from, the local Federal and/or State office.

**Item 1:** If the proposal is to redrill to the same reservoir at a different subsurface location or to a new reservoir, use this form with appropriate notations. Consult applicable State or Federal regulations concerning subsequent work proposals or reports on the well.

**Item 4:** If there are no applicable State requirements, locations on Federal or Indian land should be described in accordance with Federal requirements. Consult local State or Federal office for specific instructions.

**Item 14:** Needed only when location of well cannot readily be found by road from the land or lease description. A plat, or plats, separate or on this reverse side, showing the roads to, and the surveyed location of, the well, and any other required information, should be furnished when required by Federal or State agency offices.

**Items 15 and 18:** If well is to be, or has been directionally drilled, give distances for subsurface location of hole in any present or objective production zone.

**Item 22:** Consult applicable Federal or State regulations, or appropriate officials, concerning approval of the proposal before operations are started.

**NEW MEXICO OIL CONSERVATION COMMISSION**  
**WELL LOCATION AND ACREAGE DEDICATION FORM**

Form C-102  
 Supersedes C-128  
 Effective 1-1-65

All distances must be from the outer boundaries of the Section.

Operator <b>MAX M. WILSON</b>			Lease <b>FED, VINCENT CUCCIA</b>		Well No. <b>1</b>
Unit Letter <b>P</b>	Section <b>15</b>	Township <b>7 SOUTH</b>	Range <b>34 EAST</b>	County <b>ROOSEVELT</b>	
Actual Footage Location of Well: <b>660</b> feet from the <b>SOUTH</b> line and <b>660</b> feet from the <b>EAST</b> line					
Ground Level Elev.	Producing Formation <b>San Andres</b>	Pool <b>Wildcat</b>	Dedicated Acreage: <b>40</b> Acres		

1. Outline the acreage dedicated to the subject well by colored pencil or hachure marks on the plat below.
2. If more than one lease is dedicated to the well, outline each and identify the ownership thereof (both as to working interest and royalty).
3. If more than one lease of different ownership is dedicated to the well, have the interests of all owners been consolidated by communitization, unitization, force-pooling, etc?

☐ Yes ☐ No If answer is "yes," type of consolidation \_\_\_\_\_

If answer is "no," list the owners and tract descriptions which have actually been consolidated. (Use reverse side of this form if necessary.) \_\_\_\_\_

No allowable will be assigned to the well until all interests have been consolidated (by communitization, unitization, forced-pooling, or otherwise) or until a non-standard unit, eliminating such interests, has been approved by the Commission.

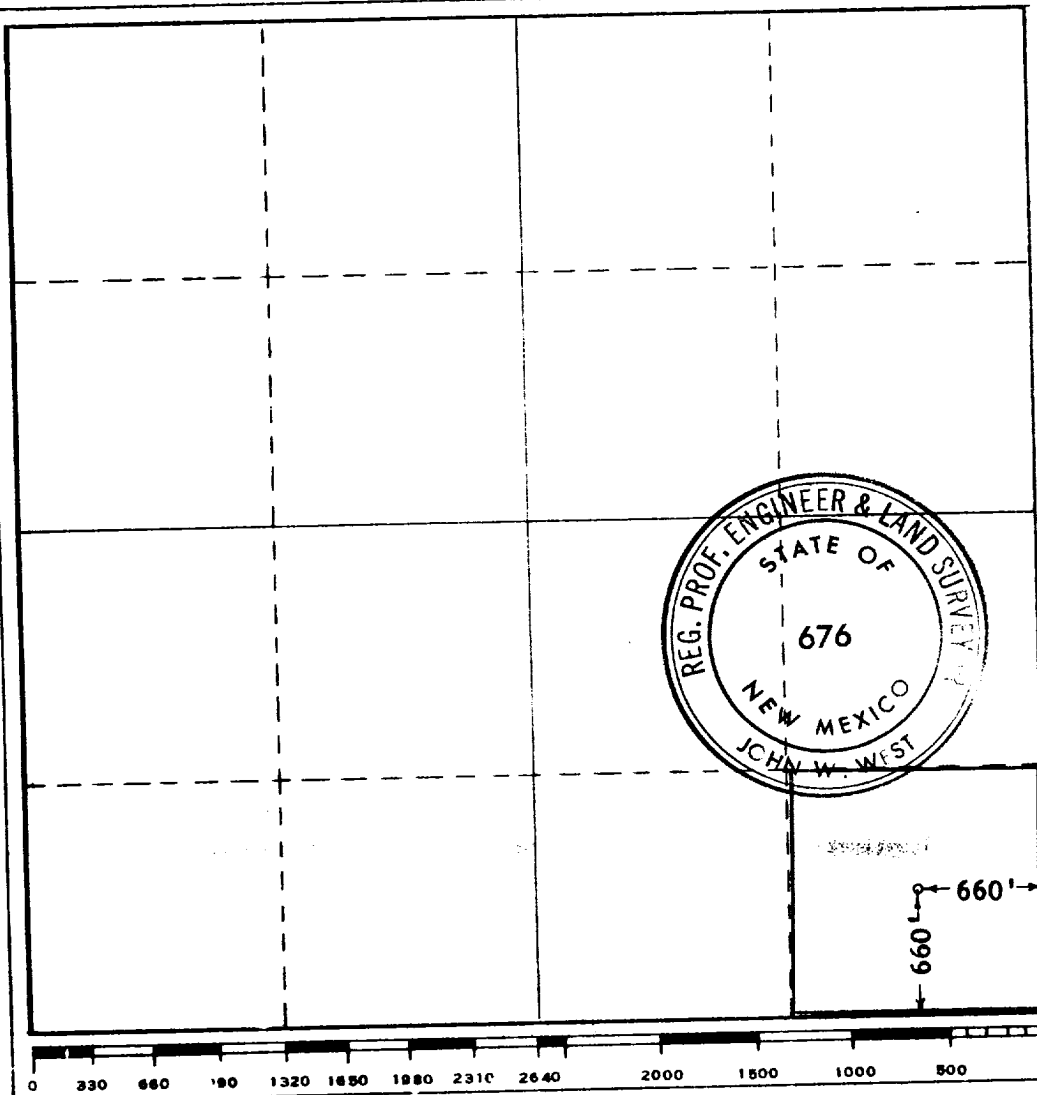

**CERTIFICATION**

I hereby certify that the information contained herein is true and complete to the best of my knowledge and belief.

Name **J. L. Smith**

Position  
**Agent**

Company  
**Max M. Wilson**

Date  
**September 9, 1965**

I hereby certify that the well location shown on this plat was plotted from field notes of actual surveys made by me or under my supervision, and that the same is true and correct to the best of my knowledge and belief.

Date Surveyed  
**9-4-65**

Registered Professional Engineer and/or Land Surveyor

**John W. West**  
 Certificate No.

**N.M. P.E. & L.S. NO. 676**