

NEW MEXICO OIL CONSERVATION COMMISSION
Santa Fe, New Mexico

Form G-101
Revised (12/1/55)

NOTICE OF INTENTION TO DRILL

Notice must be given to the District Office of the Oil Conservation Commission and approval obtained before drilling or recompletion begins. If changes in the proposed plan are considered advisable, a copy of this notice showing such changes will be returned to the sender. Submit this notice in QUINTUPLICATE. One copy will be returned following approval. See additional instructions in Rules and Regulations of the Commission. If State Land submit 6 Copies Attach Form G-128 in triplicate to first 3 copies of form G-101

Fort Worth, Texas
(Place)

May 27, 1963
(Date)

OIL CONSERVATION COMMISSION
SANTA FE, NEW MEXICO

Gentlemen:

You are hereby notified that it is our intention to commence the Drilling of a well to be known as

Maxwell Oil Company

(Company or Operator)

Fraser

(Lease)

Well No. **2**, in **P** (Unit) The well is

located **660** feet from the **South** line and **660** feet from the

East

Line of Section **6**, T. **8S**, R. **35E**, NMPM.

(GIVE LOCATION FROM SECTION LINE) **Milnesand - San Andres Pool, Roosevelt** County

D	C	B	A
E	F	G	H
L	K	J	I
M	N	O	EX

If State Land the Oil and Gas Lease is No.

If patented land the owner is **Cecil Pata,**

Address **Milnesand, New Mexico**

We propose to drill well with drilling equipment as follows: **rotary tools**
from top to approximately 4700 feet

The status of plugging bond is **active - \$10,000**

Santa Fe, New Mexico

Drilling Contractor **Monarch Drilling Company**

Box 3466 - Abilene, Texas

We intend to complete this well in the **San Andres**

formation at an approximate depth of **4650** feet.

CASING PROGRAM

We propose to use the following strings of Casing and to cement them as indicated:

Size of Hole	Size of Casing	Weight per Foot	New or Second Hand	Depth	Sacks Cement
11 inch	8-5/8	32#	S.H.	350	250
7-7/8	4-1/2	11.60 - 9.50	New	4700	400

If changes in the above plans become advisable we will notify you immediately.

ADDITIONAL INFORMATION (If recompletion give full details of proposed plan of work.)

Approved _____, 19_____
Except as follows:

Cement must tie back
into **8 1/2** casing

OIL CONSERVATION COMMISSION

By _____

Sincerely yours,

MAXWELL OIL COMPANY

(Company or Operator)

By **B. I. Miller**

Position **Production Superintendent**

Send Communications regarding well to

Name **Maxwell Oil Company**

Address **2017 Continental Natl. Bank Bldg.**
Fort Worth 2 Texas

NUMBER OF COPIES RECEIVED	
DISTRIBUTION	
SANTA FE	
FILE	
U.S.G.S.	
LAND OFFICE	
TRANSPORTER	OIL GAS
PRODUCTION OFFICE	
OPERATOR	

NEW MEXICO OIL CONSERVATION COMMISSION

FORM C-128
Revised 5/1/57

WELL LOCATION AND ACREAGE DEDICATION PLAT

SEE INSTRUCTIONS FOR COMPLETING THIS FORM ON THE REVERSE SIDE

SECTION A					
Operator Maxwell Oil Company			Lease Fraser		Well No. 2
Unit Letter	Section 6	Township 8 South	Range 35 East	County Roosevelt	
Actual Footage Location of Well: 660 feet from the South line and 660 feet from the East line					
Ground Level Elev. 4247.7	Producing Formation San Andres		Pool Milnesand	Dedicated Acreage: 40 Acres	

- Is the Operator the only owner in the dedicated acreage outlined on the plat below? YES ☒ NO ____ . ("Owner" means the person who has the right to drill into and to produce from any pool and to appropriate the production either for himself or for himself and another. (65-3-29 (e) NMSA 1935 Comp.)
- If the answer to question one is "no," have the interests of all the owners been consolidated by communitization agreement or otherwise? YES ____ NO ____ . If answer is "yes," Type of Consolidation ____
- If the answer to question two is "no," list all the owners and their respective interests below:

Owner Maxwell Oil Company	Land Description Center SE 1/4
-------------------------------------	--

SECTION B

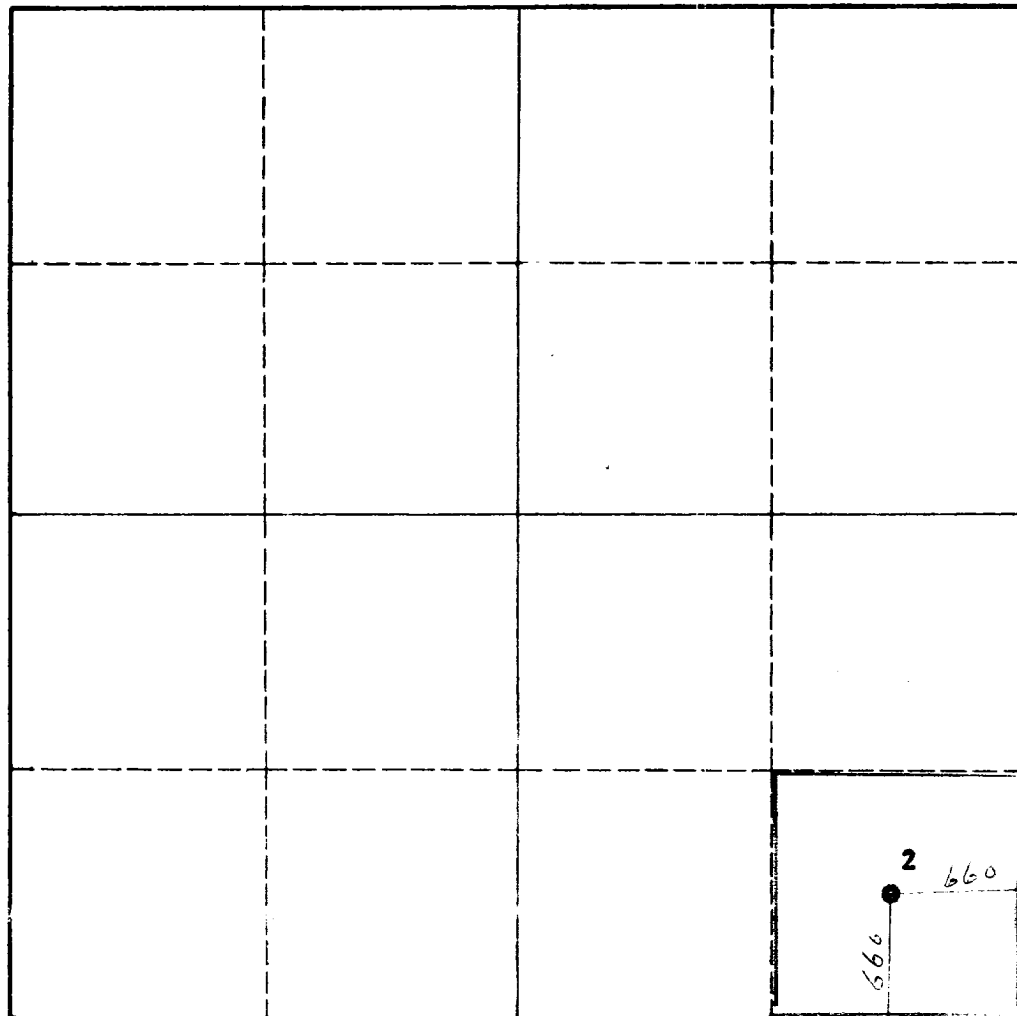

CERTIFICATION

I hereby certify that the information in SECTION A above is true and complete to the best of my knowledge and belief.

Name
B. I. Miller

Position
Supt. of Production

Company
Maxwell Oil Company

Date
May 27, 1963

I hereby certify that the well location shown on the plat in SECTION B was plotted from field notes of actual surveys made by me or under my supervision, and that the same is true and correct to the best of my knowledge and belief.

Date Surveyed
April 23, 1963

Registered Professional Engineer and/or Land Surveyor

Certificate No.
1502

0 330 660 990 1320 1650 1980 2310 2640 2000 1500 1000 500 0

INSTRUCTIONS FOR COMPLETION OF FORM C-128

1. Operator shall furnish and certify to the information called for in Section A.
2. Operator shall outline the dedicated acreage for *both* oil and gas wells on the plat in Section B.
3. A registered professional engineer or land surveyor registered in the State of New Mexico or approved by the Commission shall show on the plat the location of the well and certify this information in the space provided.
4. All distances shown on the plat must be from the outer boundaries of the Section.
5. If additional space is needed for listing owners and their respective interests as required in question 3 of Section A, please use space below.