

UNITED STATES
DEPARTMENT OF THE INTERIOR
GEOLOGICAL SURVEY

APPLICATION FOR PERMIT TO DRILL, DEEPEN, OR PLUG BACK

1a. TYPE OF WORK DRILL <input checked="" type="checkbox"/> DEEPEN <input type="checkbox"/> PLUG BACK <input type="checkbox"/>		5. LEASE DESIGNATION AND SERIAL NO. N.M. 0145685
b. TYPE OF WELL OIL WELL <input checked="" type="checkbox"/> GAS WELL <input type="checkbox"/> OTHER <input type="checkbox"/> SINGLE ZONE <input checked="" type="checkbox"/> MULTIPLE ZONE <input type="checkbox"/>		6. IF INDIAN, ALLOTTEE OR TRIBE NAME
2. NAME OF OPERATOR Am. American Petroleum Corp.		7. UNIT AGREEMENT NAME
3. ADDRESS OF OPERATOR Box 68 Hobbs, N.M. 88240		8. FARM OR LEASE NAME USA Russell E. HARTON
4. LOCATION OF WELL (Report location clearly and in accordance with any State requirements.)* At surface 990' FSL x 330' FWH. Sec. 29, (Unit M, SW/4 SW/4) At proposed prod. zone		9. WELL NO. 31
14. DISTANCE IN MILES AND DIRECTION FROM NEAREST TOWN OR POST OFFICE* 2 mi. So.; 3 mi. West of Milnesand, N.M.		10. FIELD AND POOL, OR WILDCAT MILNESAND SAN ANDRES
15. DISTANCE FROM PROPOSED* LOCATION TO NEAREST PROPERTY OR LEASE LINE, FT. (Also to nearest drlg. line, if any)	16. NO. OF ACRES IN LEASE 1920	11. SEC., T., R., M., OR BLK. AND SURVEY OR AREA 29-8-35 N.M.P.M.
18. DISTANCE FROM PROPOSED LOCATION* TO NEAREST WELL, DRILLING, COMPLETED, OR PLUGGED FOR, ON THIS LEASE, FT.	19. PROPOSED DEPTH 4700	12. COUNTY OR PARISH ROOSEVELT
21. ELEVATIONS (Show whether DF, RT, GR, etc.)		13. STATE N.M.
22. APPROX. DATE WORK WILL START* 4-1-65		

PROPOSED CASING AND CEMENTING PROGRAM

SIZE OF HOLE	SIZE OF CASING	WEIGHT PER FOOT	SETTING DEPTH	QUANTITY OF CEMENT
12 1/4"	8 5/8"	24 #	400'	225 Sx.
7 1/8"	4 1/2"	9.5 #	4700'	250 Sx.

After drilling well, logs will be run and evaluations made, perforating and stimulating as necessary in attempting commercial production.

IN ABOVE SPACE DESCRIBE PROPOSED PROGRAM: If proposal is to deepen or plug back, give data on present productive zone and proposed new productive zone. If proposal is to drill or deepen directionally, give pertinent data on subsurface locations and measured and true vertical depths. Give blowout preventer program, if any.

24. Original Signed by:
SIGNED **V. E. STALEY** TITLE **Area Supt** DATE **3-25-65**
(This space for Federal or State office use)

PERMIT NO. _____ APPROVAL DATE _____

APPROVED BY _____
CONDITIONS OF APPROVAL, IF ANY: _____

TITLE _____

DATE _____

C-7

C-4- USGS
C-1- JWB
C-5- SGP
C-6- WJ

*See Instructions On Reverse Side

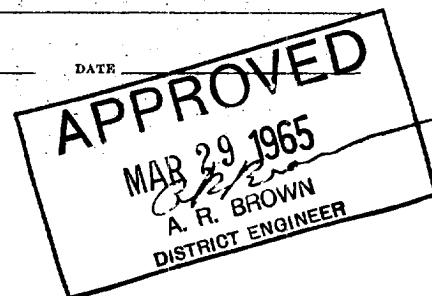

NEW MEXICO OIL CONSERVATION COMMISSION

WELL LOCATION AND ACREAGE DEDICATION PLAT

FORM C-128
Revised 2/1/57

SEE INSTRUCTIONS FOR COMPLETING THIS FORM ON THE REVERSE SIDE

SECTION A

Operator PAN AMERICAN PETROLEUM CORP.			Lease R. E. HORTON			Well No. 31		
Unit Letter M	Section 29	Township 8 SOUTH	Range 35 EAST	County ROOSEVELT				
Actual Passage Location of Well: 990 feet from the SOUTH line and 330 feet from the WEST line								
Ground Level Elev. 790	Producing Formation San Andres			Pool San Andres San Andres			Dedicated Acreage: Acres	

1. Is the Operator the only owner in the dedicated acreage outlined on the plat below? YES ☒ NO ☐ ("Owner" means the person who has the right to drill into and to produce from any pool and to appropriate the production either for himself or for himself and another. (65-3-29 (c) NMSA 1955 Comp.)
2. If the answer to question one is "no," have the interests of all the owners been consolidated by communitization agreement or otherwise? YES ☐ NO ☐ If answer is "yes," Type of Consolidation _____
3. If the answer to question two is "no," list all the owners and their respective interests below:

Owner	Land Description

SECTION B

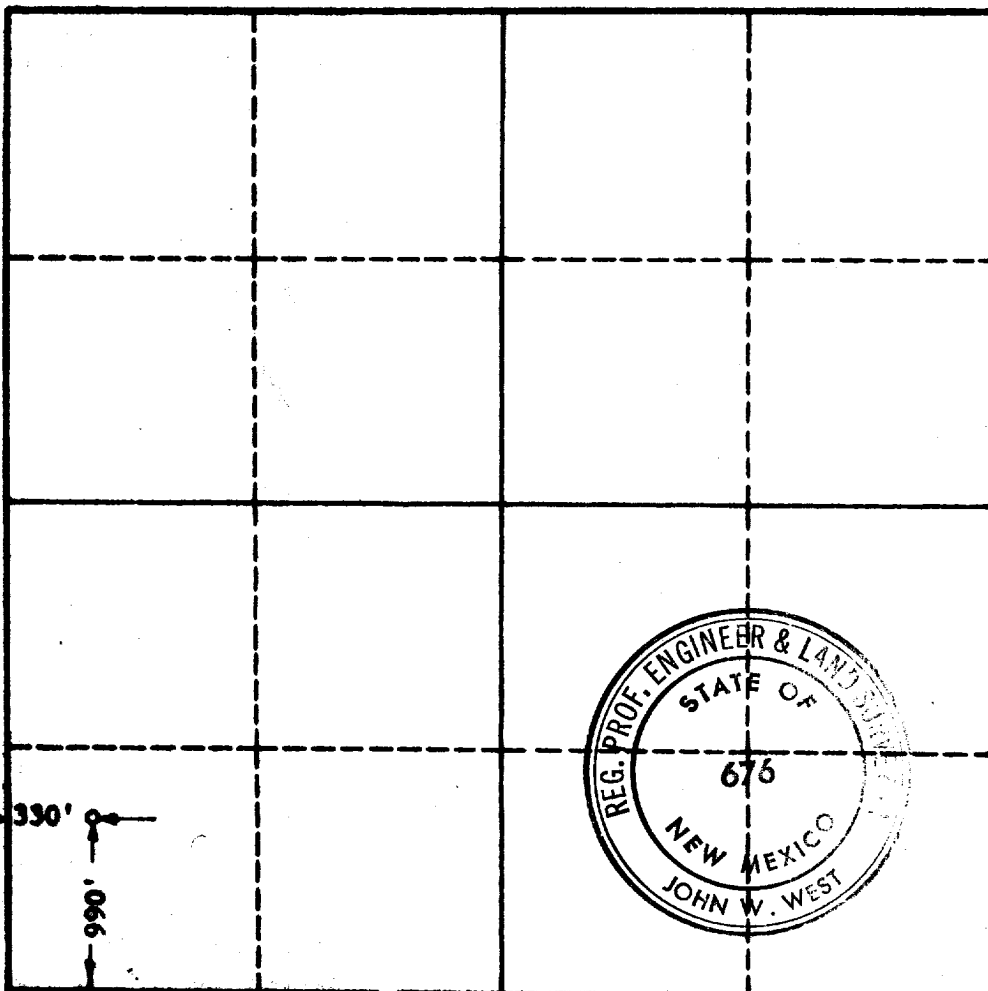

CERTIFICATION

I hereby certify that the information in SECTION A above is true and complete to the best of my knowledge and belief.

Name Original Signed by:
V. E. STALEY

Position
Surveyor

Company
Pan American Pet. Corp.

Date
March 23, 1965

I hereby certify that the well location shown on the plat in SECTION B was plotted from field notes of actual surveys made by me or under my supervision, and that the same is true and correct to the best of my knowledge and belief.

Date Surveyed
MARCH 24, 1965

Registered Professional Engineer and/or Land Surveyor, **JOHN W. WEST**

John W. West
Certificate No.
N.M. - P.E. & L.S. NO. 676

0 320 640 960 1280 1600 1920 2240 2560 2880 3200 3520 3600 0