

NO. OF COPIES RECEIVED	
DISTRIBUTION	
SANTA FE	
FILE	
U.S.G.S.	
LAND OFFICE	
OPERATOR	

# NEW MEXICO OIL CONSERVATION COMMISSION

Form C-101  
Revised 1-1-65

SEP 30

A. Indicate Type of Lease 1. Lease <input checked="" type="checkbox"/> FEE <input type="checkbox"/>
5. State Oil & Gas Lease No. <b>2-1369</b>

## APPLICATION FOR PERMIT TO DRILL, DEEPEN, OR PLUG BACK

1a. Type of Work b. Type of Well OIL WELL <input type="checkbox"/> GAS WELL <input type="checkbox"/> OTHER <input type="checkbox"/>		DRILL <input checked="" type="checkbox"/> DEEPEN <input type="checkbox"/> PLUG BACK <input type="checkbox"/>		SINGLE ZONE <input checked="" type="checkbox"/> MULTIPLE ZONE <input type="checkbox"/>	
2. Name of Operator <b>Stally Oil Company</b>				7. Unit Agreement Name <b>-</b>	
3. Address of Operator <b>Box 730 - Hobbs, New Mexico</b>				8. Farm or Lease Name <b>Hobbs "T"</b>	
4. Location of Well UNIT LETTER <b>D</b> LOCATED <b>660</b> FEET FROM THE <b>North</b> LINE AND <b>660</b> FEET FROM THE <b>West</b> LINE OF SEC. <b>34</b> TWP. <b>7-S</b> RGE. <b>33-E</b> NMPM				9. Well No. <b>9</b>	
10. Field and Pool, or Wildcat <b>Chavez San Andres</b>				12. County <b>Roosevelt</b>	
19. Proposed Depth <b>4475'</b>		19A. Formation <b>San Andres</b>		20. Rotary or C.T. <b>Rotary</b>	
21. Elevations (Show whether DF, RT, etc.) <b>Unknown</b>		21A. Kind & Status Plug. Bond <b>Blanket Bond No. 1233600 for \$100,000.00 w/ Federal Insurance Co.</b>		21B. Drilling Contractor <b>Cactus Drilling Corp.</b>	
22. Approx. Date Work will start <b>Immediately</b>					

23.

### PROPOSED CASING AND CEMENT PROGRAM

SIZE OF HOLE	SIZE OF CASING	WEIGHT PER FOOT	SETTING DEPTH	SACKS OF CEMENT	EST. TOP
11"	8-5/8"	24.4	390'	250	Surface
7-7/8"	4-1/2"	10.54	4475'	250	3750'
				350	

The Pump & Plug Process will be used in cementing both strings of casing and cement will be circulated to the surface on the 8-5/8" CD surface casing. The 4-1/2" CD casing will be perforated and the San Andres Zone treated with approx. 2000 gals. Reg. Acid, 30,000 gals. oil and 30,000# 20/40 sand.

APPROVAL VALID  
FOR 90 DAYS UNLESS  
DRILLING COMMENCED.  
EXPIRES Dec 30-65

IN ABOVE SPACE DESCRIBE PROPOSED PROGRAM; IF PROPOSAL IS TO DEEPEN OR PLUG BACK, GIVE DATA ON PRESENT PRODUCTIVE ZONE AND PROPOSED NEW PRODUCTIVE ZONE. GIVE BLOWOUT PREVENTER PROGRAM, IF ANY.

I hereby certify that the information above is true and complete to the best of my knowledge and belief.

Signed **(ORIGINAL SIGNED) H. E. Aab** Title **Dist. Superintendent** Date **Sept. 29, 1965**

(This space for State Use)

APPROVED BY \_\_\_\_\_ TITLE \_\_\_\_\_ DATE \_\_\_\_\_

CONDITIONS OF APPROVAL, IF ANY:

**NEW MEXICO OIL CONSERVATION COMMISSION  
WELL LOCATION AND ACREAGE DEDICATION PLAT**

Form C-102  
Supersedes C-128  
Effective 1-1-65

All distances must be from the outer boundaries of the section

SEP 30 9 AM '65

Operator <b>SKELLY OIL COMPANY</b>			Lease <b>HOBBS T</b>		Well No. <b>9</b>
Unit Letter <b>D</b>	Section <b>34</b>	Township <b>7 SOUTH</b>	Range <b>33 EAST</b>	County <b>ROOSEVELT</b>	
Actual Footage Location of Well: <b>660</b> feet from the <b>NORTH</b> line and <b>660</b> feet from the <b>WEST</b> line					
Ground Level Elev.	Producing Formation <b>San Andres</b>	Pool <b>Chavezco San Andres</b>	Dedicated Acreage: <b>40</b> Acres		

1. Outline the acreage dedicated to the subject well by colored pencil or hachure marks on the plat below.
2. If more than one lease is dedicated to the well, outline each and identify the ownership thereof (both as to working interest and royalty).
3. If more than one lease of different ownership is dedicated to the well, have the interests of all owners been consolidated by communitization, unitization, force-pooling, etc?

☐ Yes   ☐ No   If answer is "yes," type of consolidation \_\_\_\_\_

If answer is "no," list the owners and tract descriptions which have actually been consolidated. (Use reverse side of this form if necessary.) \_\_\_\_\_

No allowable will be assigned to the well until all interests have been consolidated (by communitization, unitization, forced-pooling, or otherwise) or until a non-standard unit, eliminating such interests, has been approved by the Commission.

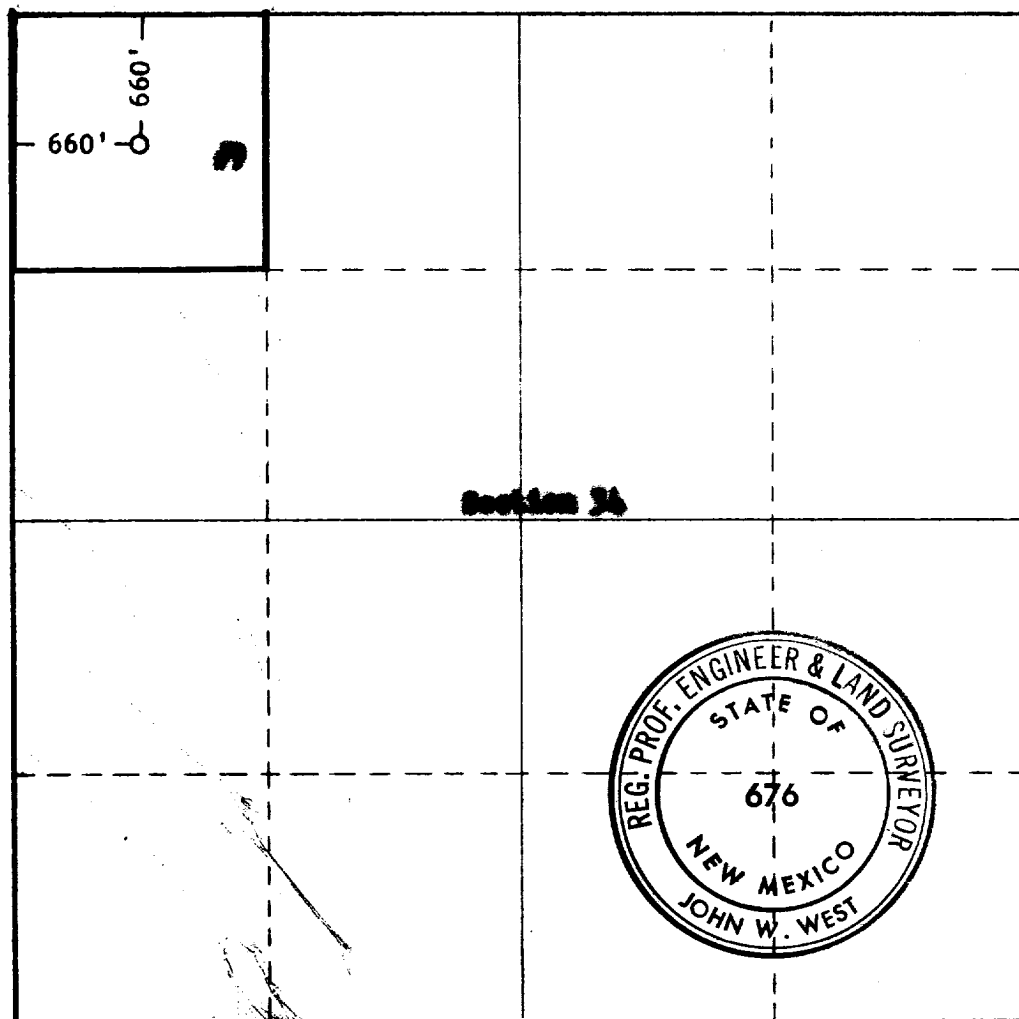

**CERTIFICATION**

I hereby certify that the information contained herein is true and complete to the best of my knowledge and belief.

Name (ORIGINAL SIGNED) **H. E. Asb**

Position **Dist. Superintendent**

Company **Skelly Oil Company**

Date **September 27, 1965**

I hereby certify that the well location shown on this plat was plotted from field notes of actual surveys made by me or under my supervision, and that the same is true and correct to the best of my knowledge and belief.

Date Surveyed  
**SEPT. 27, 1965**

Registered Professional Engineer and/or Land Surveyor

*John W. West*  
Certificate No. **676**

