

NO. OF COPIES RECEIVED	
DISTRIBUTION	
SANTA FE	
FILE	
U.S.G.S.	
LAND OFFICE	
OPERATOR	

NEW MEXICO OIL CONSERVATION COMMISSION

Form C-101
Revised 1-1-65

OCT 25 1 26 PM '65

5A. Indicate Type of Lease STATE <input checked="" type="checkbox"/> FEE <input type="checkbox"/>
5. State Oil & Gas Lease No. E-1369

APPLICATION FOR PERMIT TO DRILL, DEEPEN, OR PLUG BACK

1. Type of Work a. Type of Well DRILL <input checked="" type="checkbox"/> DEEPEN <input type="checkbox"/> PLUG BACK <input type="checkbox"/> b. Type of Well OIL WELL <input checked="" type="checkbox"/> GAS WELL <input type="checkbox"/> OTHER <input type="checkbox"/> SINGLE ZONE <input checked="" type="checkbox"/> MULTIPLE ZONE <input type="checkbox"/>		7. Unit Agreement Name -	
2. Name of Operator Shelly Oil Company		8. Farm or Lease Name Hobbs "T"	
3. Address of Operator Box 730 - Hobbs, New Mexico		9. Well No. 8	
4. Location of Well UNIT LETTER "J" LOCATED 1980 FEET FROM THE South LINE AND 1980 FEET FROM THE East LINE OF SEC. 34 TWP. 7-S RGE. 33-E NMPM		10. Field and Pool, or Wildcat Chavez San Andres	
11. Elevations (Show whether DF, RT, etc.) Unknown		12. County Hesselt	
21A. Kind & Status Plug. Bond Blanket Bond No. 1253488 for \$100,000.00 w/ Federal Insurance Co.		20. Rotary or C.T. Rotary	
21B. Drilling Contractor Cactus Drilling Corp.		22. Approx. Date Work will start Immediately	

PROPOSED CASING AND CEMENT PROGRAM

SIZE OF HOLE	SIZE OF CASING	WEIGHT PER FOOT	SETTING DEPTH	SACKS OF CEMENT	EST. TOP
11"	8-5/8"	24.5	350'	250	Surface
7-7/8"	4-1/2"	10.54	4475'	350	3750'

The Pump & Plug Process will be used in cementing both strings of casing and cement will be circulated to the surface on the 8-5/8" OD surface casing. The 4-1/2" OD casing will be perforated and the San Andres Zone treated with approx. 2000 gals. Reg. Acid, 30,000 gals. oil and 30,000# 20/40 sand.

NOTE:

This well was formerly located 660' FSL and 660' FSL of Section 33-75-33E. Form C-103 was filed on October 22, 1965, which abandoned the above location.

IN ABOVE SPACE DESCRIBE PROPOSED PROGRAM: IF PROPOSAL IS TO DEEPEN OR PLUG BACK, GIVE DATA ON PRESENT PRODUCTIVE ZONE AND PROPOSED NEW PRODUCTIVE ZONE. GIVE BLOWOUT PREVENTER PROGRAM, IF ANY.

I hereby certify that the information above is true and complete to the best of my knowledge and belief.

Signed **(ORIGINAL SIGNED) H. E. Aab** Title **Dist. Superintendent** Date **October 25, 1965**

(This space for State Use)
APPROVED BY **[Signature]** TITLE _____ DATE _____
CONDITIONS OF APPROVAL, IF ANY:

**NEW MEXICO OIL CONSERVATION COMMISSION
WELL LOCATION AND ACREAGE DEDICATION PLAT**

Form C-102
Supersedes C-128
Effective 1-1-65

All distances must be from the outer boundaries of the Section.

Operator SKELLY OIL COMPANY			Lease HOBS T		Well No. 8
Unit Letter J	Section 34	Township 7 SOUTH	Range 33 EAST	County ROOSEVELT	
Actual Footage Location of Well: 1980 feet from the SOUTH line and 1980 feet from the EAST line					
Ground Level Elev:	Producing Formation San Andres	Pool Clayton San Andres	Dedicated Acreage: 40 Acres		

1. Outline the acreage dedicated to the subject well by colored pencil or hatchure marks on the plat below.
2. If more than one lease is dedicated to the well, outline each and identify the ownership thereof (both as to working interest and royalty).
3. If more than one lease of different ownership is dedicated to the well, have the interests of all owners been consolidated by communitization, unitization, force-pooling, etc?

☐ Yes ☐ No If answer is "yes," type of consolidation _____

If answer is "no," list the owners and tract descriptions which have actually been consolidated. (Use reverse side of this form if necessary.) _____

No allowable will be assigned to the well until all interests have been consolidated (by communitization, unitization, forced-pooling, or otherwise) or until a non-standard unit, eliminating such interests, has been approved by the Commission.

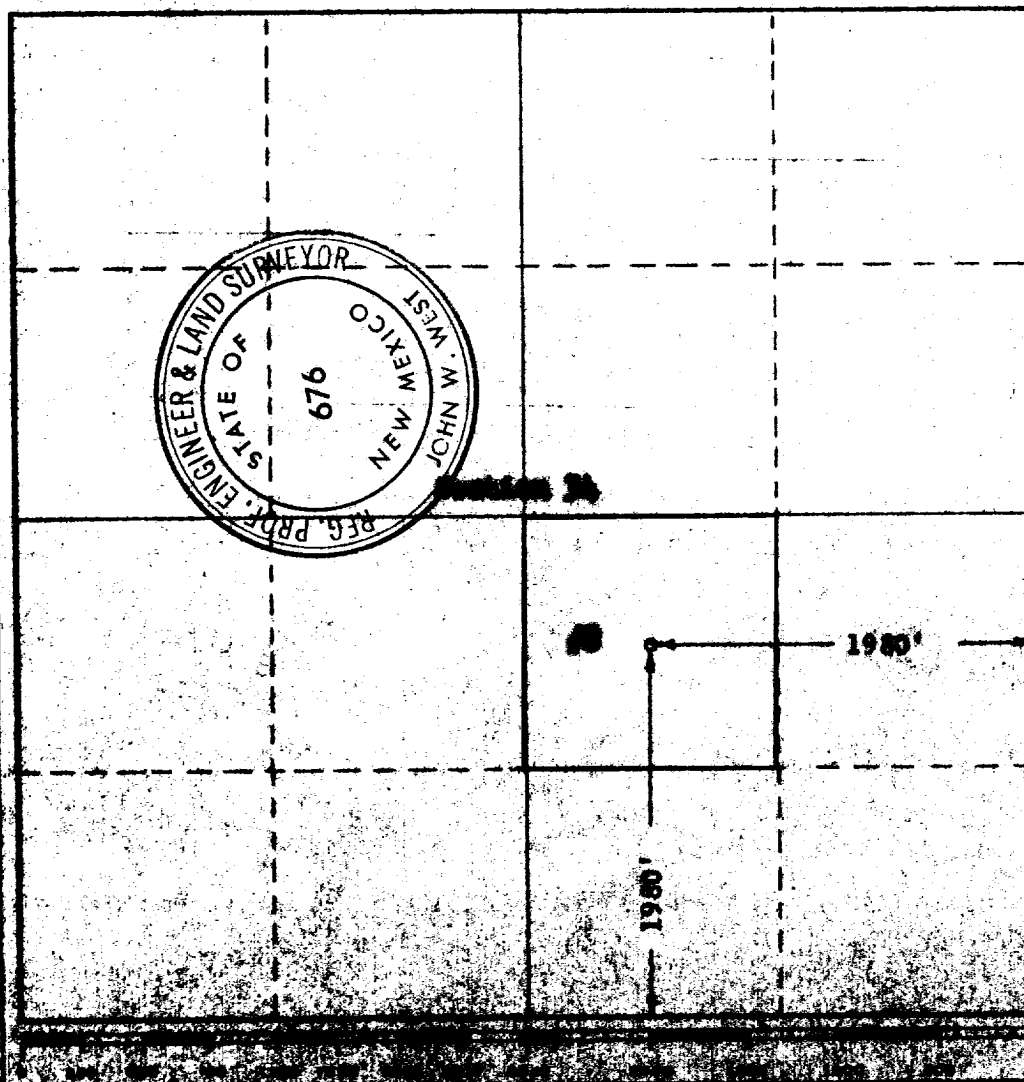

CERTIFICATION

I hereby certify that the information contained herein is true and complete to the best of my knowledge and belief.

Name
(ORIGINAL SIGNED) **H. E. Ash**

Position
Dist. Superintendent

Company
Skelly Oil Company

Date
October 23, 1965

I hereby certify that the well location shown on this plat was plotted from field notes of actual surveys made by me or under my supervision, and that the same is true and correct to the best of my knowledge and belief.

Date Surveyed
OCTOBER 22, 1965

Registered Professional Engineer
and/or Land Surveyor

John W. West
676