

**AMENDED LOCATION**  
Application to drill approved verbally  
by Joe D. Mone 10-26-65.

NO. OF COPIES RECEIVED	
DISTRIBUTION	
SANTA FE	
FILE	
U.S.G.S.	
LAND OFFICE	
OPERATOR	

NEW MEXICO OIL CONSERVATION COMMISSION

Nov 1 8 26 AM '65

Form C-101  
Revised 1-1-65

5A. Indicate Type of Lease	
STATE <input checked="" type="checkbox"/>	FEE <input type="checkbox"/>
5. State Oil & Gas Lease No. K-3935	

**APPLICATION FOR PERMIT TO DRILL, DEEPEN, OR PLUG BACK**

1a. Type of Work		7. Unit Agreement Name	
b. Type of Well OIL WELL <input checked="" type="checkbox"/> GAS WELL <input type="checkbox"/> OTHER <input type="checkbox"/>		8. Farm or Lease Name N. M. State "AZ"	
2. Name of Operator Sunray DX Oil Company		9. Well No. 11-Y	
3. Address of Operator P. O. Box 1416, Roswell, New Mexico		10. Field and Pool, or Wildcat Chaveroo San Andres	
4. Location of Well UNIT LETTER C LOCATED 1880 FEET FROM THE West LINE AND 660 FEET FROM THE North LINE OF SEC. 34 TWP. 7S RGE. 33E NMPM		12. County Roosevelt	
19. Proposed Depth 4450'		19A. Formation San Andres	20. Rotary or C.T. Rotary
21. Elevations (Show whether DF, RT, etc.) 4410 DF	21A. Kind & Status Plug. Bond Approved	21B. Drilling Contractor Cactus Corp.	22. Approx. Date Work will start 10-27-65

23.

**PROPOSED CASING AND CEMENT PROGRAM**

SIZE OF HOLE	SIZE OF CASING	WEIGHT PER FOOT	SETTING DEPTH	SACKS OF CEMENT	EST. TOP
11"	8 5/8	24	1950	600	Circ.
7 7/8"	4 1/2	9.5	4450	200	3700

1. Drill 11" hole to approx 1950'.
2. Run 8 5/8" csg to approx 1950'.
3. Cmt csg w/approx 600 sx cmt. Circ cmt. WOC 18 hrs. Pressure test to 1000 psig for 30 min.
4. Drill 7 7/8" hole to approx TD of 4450'. Run open hole logs. Run 4 1/2" OD, 9.5#, J-55 csg to TD. Cmt w/200 sx cmt. WOC 24 hrs. Pressure test to 1000 psig for 30 min.
5. Completion procedure to be determined following log analysis.

APPROVAL VALID  
FOR 90 DAYS UNLESS  
DRILLING COMMENCED

IN ABOVE SPACE DESCRIBE PROPOSED PROGRAM; IF PROPOSAL IS TO DEEPEN OR PLUG BACK, GIVE DATA ON PROPOSED PRODUCTIVE ZONE AND PROPOSED NEW PRODUCTIVE ZONE, GIVE BLOWOUT PREVENTER PROGRAM, IF ANY.

I hereby certify that the information above is true and complete to the best of my knowledge and belief.

Signed B.F. Brawley Title District Engineer Date 10-27-65

(This space for State Use)

APPROVED BY \_\_\_\_\_ TITLE \_\_\_\_\_ DATE \_\_\_\_\_

CONDITIONS OF APPROVAL, IF ANY:

**NEW MEXICO OIL CONSERVATION COMMISSION  
WELL LOCATION AND ACREAGE DEDICATION PLAT**

Form C-105  
Supersedes C-138  
Effective 1-1-65

All distances must be from the outer boundaries of the Section.

Operator <b>SUNRAY OX OIL COMPANY</b>			Lease <b>STATE A 2111 8 26 AM 65</b>		Well No. <b>11-3</b>
Unit Letter <b>C</b>	Section <b>34</b>	Township <b>7 SOUTH</b>	Range <b>33 EAST</b>	County <b>ROOSEVELT</b>	
Actual Footage Location of Well: <b>660</b> feet from the <b>NORTH</b> line and <b>1880</b> feet from the <b>WEST</b> line					
Ground Level Elev. <b></b>	Producing Formation <b>San Andres</b>		Pool <b>Chavezco San Andres</b>		Dedicated Acreage: <b>30</b> Acres

1. Outline the acreage dedicated to the subject well by colored pencil or hachure marks on the plat below.
2. If more than one lease is dedicated to the well, outline each and identify the ownership thereof (both as to working interest and royalty).
3. If more than one lease of different ownership is dedicated to the well, have the interests of all owners been consolidated by communitization, unitization, force-pooling, etc?

☐ Yes ☐ No If answer is "yes," type of consolidation \_\_\_\_\_

If answer is "no," list the owners and tract descriptions which have actually been consolidated. (Use reverse side of this form if necessary.) \_\_\_\_\_

No allowable will be assigned to the well until all interests have been consolidated (by communitization, unitization, forced-pooling, or otherwise) or until a non-standard unit, eliminating such interests, has been approved by the Commission.

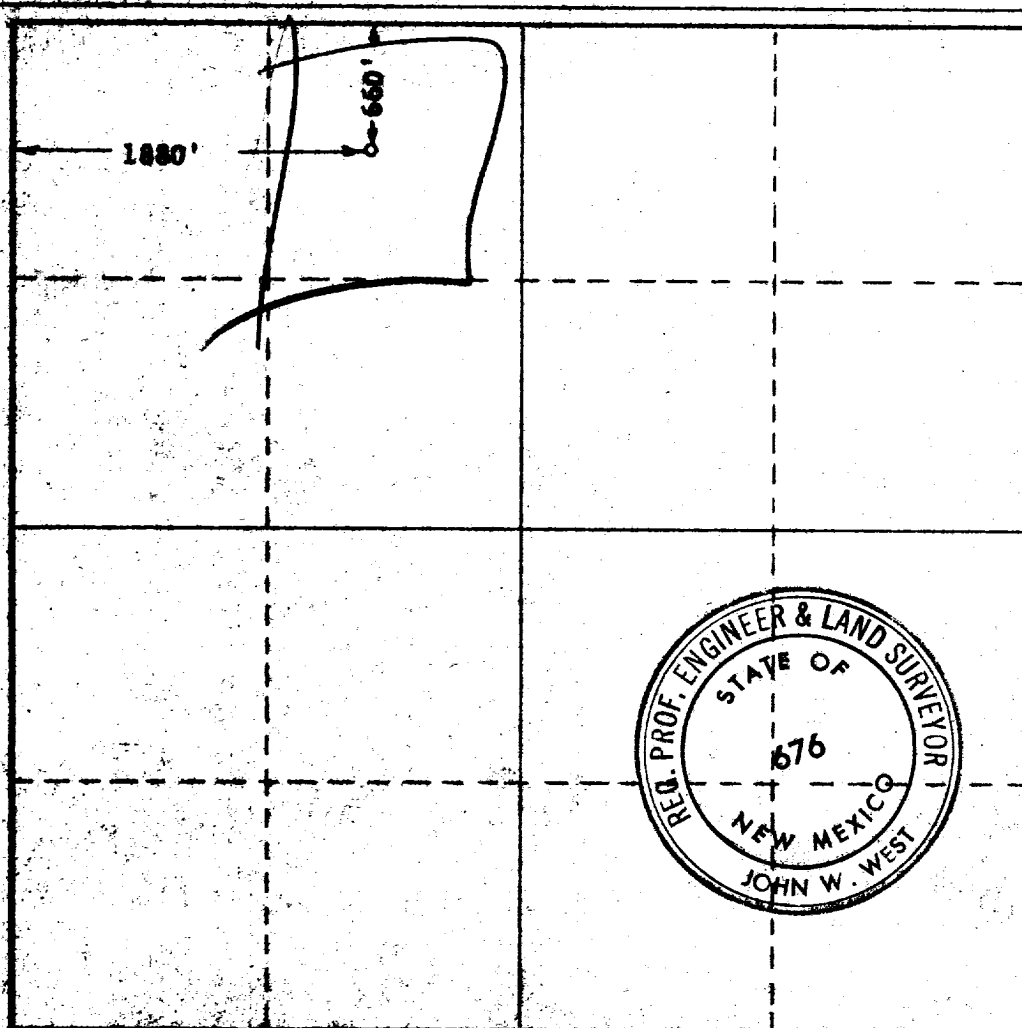

**CERTIFICATION**

I hereby certify that the information contained herein is true and complete to the best of my knowledge and belief.

Name John Hastings  
 Profession Production Engineer  
 Company Sunray Oil Company  
 Date 10-27-65

I hereby certify that the well location shown on this plat was plotted from field notes of actual surveys made by me or under my supervision, and that the same is true and correct to the best of my knowledge and belief.

Date Surveyed  
**OCTOBER 26, 1965**  
 Registered Professional Engineer  
 and/or Land Surveyor

John W. West  
 Certificate No. **676**

0 500 1000 1500 2000 2500 3000 3500 4000 4500 5000 5500 6000 6500 7000 7500 8000 8500 9000 9500 10000