

NO. OF COPIES RECEIVED	
DISTRIBUTION	
SANTA FE	
FILE	
U.S.G.S.	
LAND OFFICE	
OPERATOR	

HOBBS OFFICE O.C.C.
NEW MEXICO OIL CONSERVATION COMMISSION
Dec 10 3 12 PM '65

Form C-101
Revised 1-1-65

5A. Indicate Type of Lease STATE <input checked="" type="checkbox"/> FEE <input type="checkbox"/>
5. State Oil & Gas Lease No. K 3935

APPLICATION FOR PERMIT TO DRILL, DEEPEN, OR PLUG BACK

1a. Type of Work b. Type of Well OIL WELL <input type="checkbox"/> GAS WELL <input type="checkbox"/> OTHER <input type="checkbox"/>		DRILL <input checked="" type="checkbox"/> DEEPEN <input type="checkbox"/> PLUG BACK <input type="checkbox"/>	
2. Name of Operator Sunray Oil Company		7. Unit Agreement Name	
3. Address of Operator P. O. Box 1416, Roswell, New Mexico		8. Farm or Lease Name N. M. State "A"	
4. Location of Well UNIT LETTER P LOCATED 660 FEET FROM THE South LINE AND 660 FEET FROM THE East LINE OF SEC. 34 TWP. 78 RGE. 33E NMPM		9. Well No. 15	
		10. Field and Pool, or Wildcat Chavezco San Andres	
		12. County Reconevolt	
21. Elevations (Show whether DF, RT, etc.) Furnish later		19. Proposed Depth 4480	19A. Formation San Andres
21A. Kind & Status Plug. Bond Approved	21B. Drilling Contractor Cactus Corp.	20. Rotary or C.T. Rotary	
		22. Approx. Date Work will start 12-10-65	

23.

PROPOSED CASING AND CEMENT PROGRAM

SIZE OF HOLE	SIZE OF CASING	WEIGHT PER FOOT	SETTING DEPTH	SACKS OF CEMENT	EST. TOP
12 1/4"	8 5/8"	24.0 #	350	250	Circ. to Surf.
7 7/8"	4 1/2"	9.5 #	4480	200	3700'

- Spud 12 1/4" hole and drill to TD of approx. 350'. Run 8 5/8" casing to approx. 350' and cement w/250 sbs. reg. cnt. 25 Gall. WOC 18 hours. Test csg. to 1000' for 30 min.
- Drill 7 7/8" hole to TD of approx. 4480'. Run open hole logs. Run 4 1/2" csg. to approx. 4480'. Cnt. w/200 sbs. Inscr Pos cnt. WOC 24 hours.
- Completion procedure will be determined after log analysis.

APPROVAL VALID
FOR 90 DAYS UNLESS
DRILLING COMMENCED

EXPIRES 3/11/66

IN ABOVE SPACE DESCRIBE PROPOSED PROGRAM: IF PROPOSAL IS TO DEEPEN OR PLUG BACK, GIVE DATA ON PRESENT PRODUCTIVE ZONE AND PROPOSED NEW PRODUCTIVE ZONE, GIVE BLOWOUT PREVENTER PROGRAM, IF ANY.

I hereby certify that the information above is true and complete to the best of my knowledge and belief.

Signed B. F. Browley Title District Engineer Date 12-10-65

(This space for State Use)

APPROVED BY _____ TITLE _____ DATE _____

CONDITIONS OF APPROVAL, IF ANY:

**NEW MEXICO OIL CONSERVATION COMMISSION
WELL LOCATION AND ACREAGE DEDICATION PLAT**

Form C-102
Supersedes C-128
Effective 1-1-65

All distances must be from the outer boundaries of the Section. **HOBBS OFFICE O. C. C.**

Operator SUNRAY DX OIL COMPANY			Lease STATE DEC 48 3 12 PM '65		Well No. 15
Unit Letter P	Section 34	Township 7 SOUTH	Range 33 EAST	County ROOSEVELT	
Actual Footage Location of Well: 660 feet from the SOUTH line and 660 feet from the EAST line					
Ground Level Elev. FURNISH LATER	Producing Formation SAN ANDRES		Pool CHAUVERON SAN ANDRES	Dedicated Acreage: 40 Acres	

1. Outline the acreage dedicated to the subject well by colored pencil or hachure marks on the plat below.
2. If more than one lease is dedicated to the well, outline each and identify the ownership thereof (both as to working interest and royalty).
3. If more than one lease of different ownership is dedicated to the well, have the interests of all owners been consolidated by communitization, unitization, force-pooling, etc?

☐ Yes ☐ No If answer is "yes," type of consolidation _____

If answer is "no," list the owners and tract descriptions which have actually been consolidated. (Use reverse side of this form if necessary.) _____

No allowable will be assigned to the well until all interests have been consolidated (by communitization, unitization, forced-pooling, or otherwise) or until a non-standard unit, eliminating such interests, has been approved by the Commission.

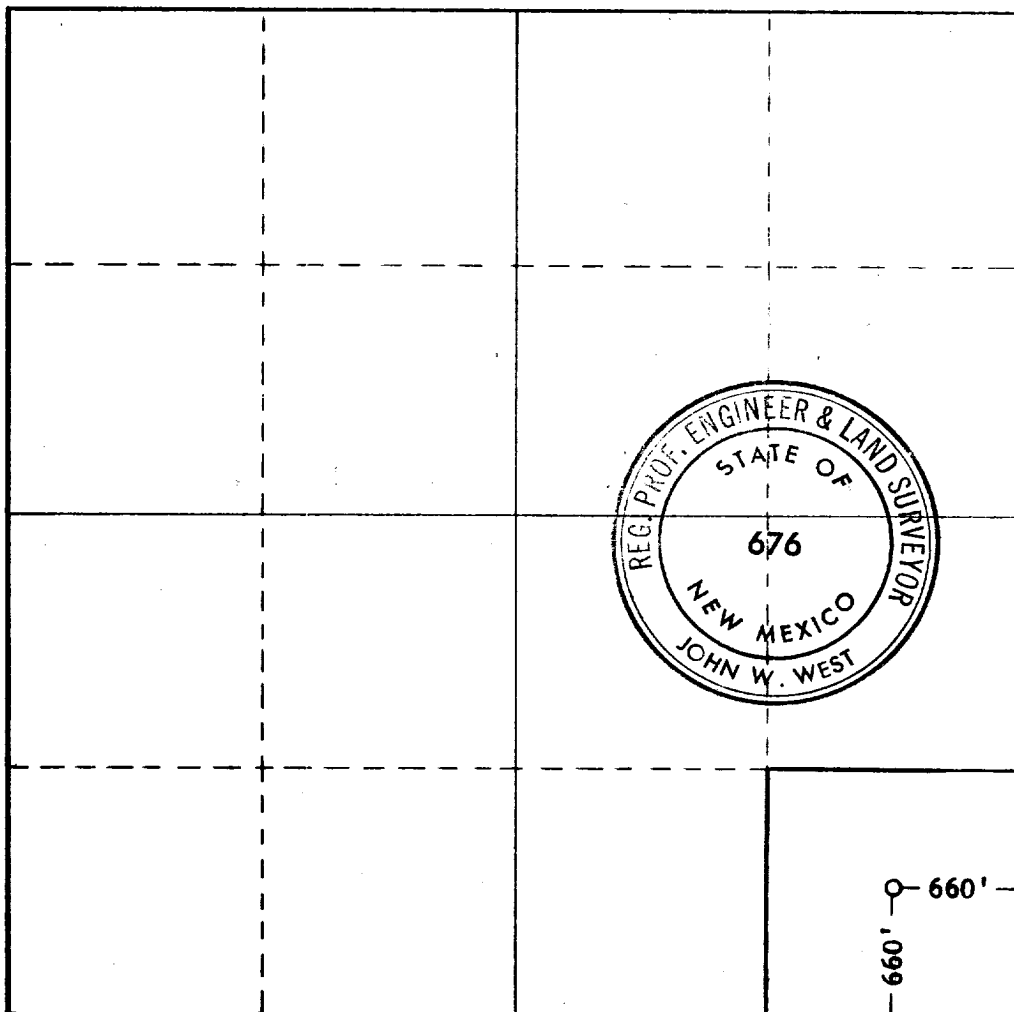

CERTIFICATION

I hereby certify that the information contained herein is true and complete to the best of my knowledge and belief.

Name *R. D. Hill*
 Position *District Office Mgr.*
 Company *Sunray Oil Co.*
 Date *12-10-65*

I hereby certify that the well location shown on this plat was plotted from field notes of actual surveys made by me or under my supervision, and that the same is true and correct to the best of my knowledge and belief.

Date Surveyed
DEC. 7, 1965

Registered Professional Engineer
and/or Land Surveyor

John W. West
 Certificate No. **676**

