

NO. OF COPIES RECEIVED	
DISTRIBUTION	
SANTA FE	
FILE	
U.S.G.S.	
LAND OFFICE	
OPERATOR	

NEW MEXICO OIL CONSERVATION COMMISSION

NOV 23 2 48 PM '65

Form C-101  
Revised 1-1-65

5A. Indicate Type of Lease STATE <input type="checkbox"/> FEE <input checked="" type="checkbox"/>
5. State Oil & Gas Lease No.
7. Unit Agreement Name
8. Farm or Lease Name <b>A. B. Hogan</b>
9. Well No. <b>1</b>
10. Field and Pool, or Wildcat <b>Wildcat</b>
12. County <b>Roosevelt</b>
19. Proposed Depth <b>4500</b>
19A. Formation <b>San Andres</b>
20. Rotary or C.T. <b>Rotary</b>
21. Elevations (Show whether DF, RT, etc.) <b>Gr. 4289</b>
21A. Kind & Status Plug. Bond <b>\$10,000 Blanket</b>
21B. Drilling Contractor <b>Unknown</b>
22. Approx. Date Work will start <b>At Once</b>

### APPLICATION FOR PERMIT TO DRILL, DEEPEN, OR PLUG BACK

1a. Type of Work DRILL <input checked="" type="checkbox"/> DEEPEN <input type="checkbox"/> PLUG BACK <input type="checkbox"/>
b. Type of Well OIL WELL <input checked="" type="checkbox"/> GAS WELL <input type="checkbox"/> OTHER <input type="checkbox"/>
2. Name of Operator <b>Texaco Inc.</b>
3. Address of Operator <b>P. O. Box 3109 Midland, Texas</b>
4. Location of Well UNIT LETTER <b>D</b> LOCATED <b>660</b> FEET FROM THE <b>North</b> LINE AND <b>660</b> FEET FROM THE <b>West</b> LINE OF SEC. <b>3</b> TWP. <b>8-S</b> RGE. <b>3-E</b> NMPM
19. Proposed Depth <b>4500</b>
19A. Formation <b>San Andres</b>
20. Rotary or C.T. <b>Rotary</b>
21. Elevations (Show whether DF, RT, etc.) <b>Gr. 4289</b>
21A. Kind & Status Plug. Bond <b>\$10,000 Blanket</b>
21B. Drilling Contractor <b>Unknown</b>
22. Approx. Date Work will start <b>At Once</b>

### PROPOSED CASING AND CEMENT PROGRAM

SIZE OF HOLE	SIZE OF CASING	WEIGHT PER FOOT	SETTING DEPTH	SACKS OF CEMENT	EST. TOP
9 7/8"	7 5/8"	24# & 15.28#	350'	200 sx *	to circulate
6 3/4"	4 1/2"	9.5#	4500'	500sx **	to tie back to 7 5/8" csg.

\* Cement with 200 sx class "C" neat with 1% calcium chloride (300% to circulate)

\*\* Cement with 300 sx TLM 110% Mix water, 12.0#/gal. followed by 200 sx Incoor 4% gel.-13.86#/gal. use 0.5% FRA in first 200 sx TLM. (150% to tie back to surface pipe)

### Completion Program

- Selectively perforate pag.
- Acidize with 2000gals. 15% NE Acid
- If necessary fracture with 15,000 gallons of gelled lease crude with 1/40# admite & 1# sand per gallon.

### Formation Tops Expected

Anhydrite 1926'  
Base of Salt 2374'

San Andres 3600'  
Slaughter "X" 4175'

Total Depth: 4500'

IN ABOVE SPACE DESCRIBE PROPOSED PROGRAM: IF PROPOSAL IS TO DEEPEN OR PLUG BACK, GIVE DATA ON PRESENT PRODUCTIVE ZONE AND PROPOSED NEW PRODUCTIVE ZONE. GIVE BLOWOUT PREVENTER PROGRAM, IF ANY.

I hereby certify that the information above is true and complete to the best of my knowledge and belief.

Signed J. J. Velten Title Division Civil Eng. Date Nov. 22, 1965

(This space for State Use)

APPROVED BY [Signature] TITLE  DATE

CONDITIONS OF APPROVAL, IF ANY:

NEW MEXICO OIL CONSERVATION COMMISSION  
WELL LOCATION AND ACREAGE DEDICATION

Form O-102  
Supersedes O-120  
Effective 1-1-65

All distances must be from the outer boundaries of the Section.

Operator <b>TEXACO Inc.</b>		Lease <b>A. B. Hogan</b>		Well No. <b>1</b>	
Unit Letter <b>D</b>	Section <b>3</b>	Township <b>8 South</b>	Range <b>34 East</b>	County <b>Roosevelt</b>	
Actual Footage Location of Well: 660 feet from the North line and 660 feet from the West line Sec. 3 Ground Level Elev: <b>1289</b> Producing Formation <b>San Andres</b> Pool <b>Wildcat</b> Dedicated Acreage: <b>40</b> Acres					

HOBBS OFFICE  
Nov 23 2 49 PM '65

1. Outline the acreage dedicated to the subject well by colored pencil or hatchure marks on the plat below.
2. If more than one lease is dedicated to the well, outline each and identify the ownership thereof (both as to working interest and royalty).
3. If more than one lease of different ownership is dedicated to the well, have the interests of all owners been consolidated by communitization, unitization, force-pooling, etc?

☐ Yes ☐ No If answer is "yes," type of consolidation \_\_\_\_\_

If answer is "no," list the owners and tract descriptions which have actually been consolidated. (Use reverse side of this form if necessary.) \_\_\_\_\_

No allowable will be assigned to the well until all interests have been consolidated (by communitization, unitization, forced-pooling, or otherwise) or until a non-standard unit, eliminating such interests, has been approved by the Commission.

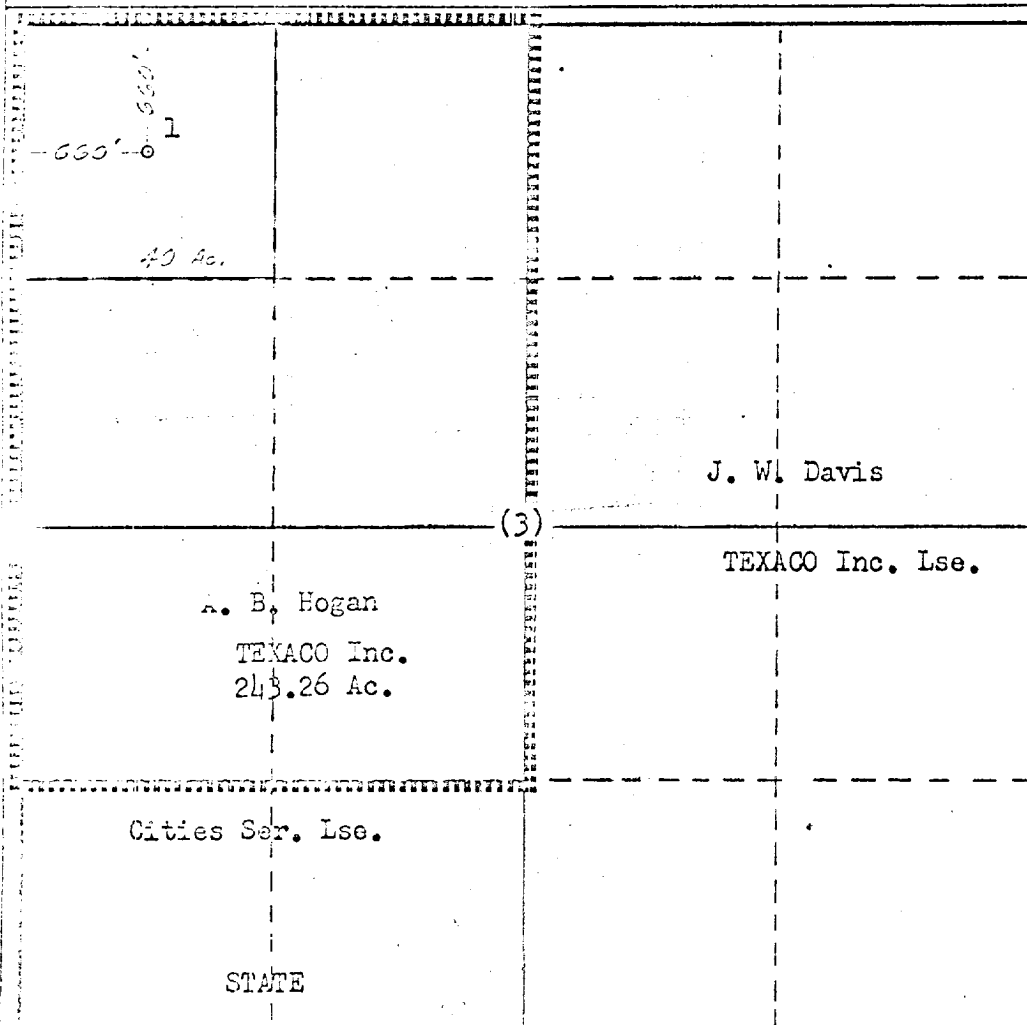

CERTIFICATION

I hereby certify that the information contained herein is true and complete to the best of my knowledge and belief.

*J. J. Velten*  
Name **J. J. Velten**

Position  
**Division Civil Engineer**

Company  
**TEXACO Inc.**

Date  
**11/22/65**

I hereby certify that the well location shown on this plat was plotted from field notes of actual surveys made by me or under my supervision, and that the same is true and correct to the best of my knowledge and belief.

Date Surveyed  
**11/20/65**

Registered Professional Engineer and/or Land Surveyor

*J. J. Velten*  
**J. J. Velten**

Certificate No.

**8147**