

NO. OF COPIES RECEIVED	
DISTRIBUTION	
SANTA FE	
FILE	
U.S.G.S.	
LAND OFFICE	
OPERATOR	

NEW MEXICO OIL CONSERVATION COMMISSION

Form C-101
Revised 1-1-65

DEC 10 11 23 AM '65

5A. Indicate Type of Lease STATE <input checked="" type="checkbox"/> FEE <input type="checkbox"/>
5. State Oil & Gas Lease No.
7. Unit Agreement Name
8. Farm or Lease Name Section 35 State
9. Well No. 1
10. Field and Pool, or Wildcat undesignated
12. County Roosevelt
19. Proposed Depth 4500'
19A. Formation San Andres
20. Rotary or C.T. Rotary
21. Elevations (Show whether DF, RT, etc.) unknown
21A. Kind & Status Plug. Bond current
21B. Drilling Contractor Cactus Drlg. Corp.
22. Approx. Date Work will start unknown

APPLICATION FOR PERMIT TO DRILL, DEEPEN, OR PLUG BACK

1a. Type of Work
b. Type of Well
OIL WELL ☒ GAS WELL ☐ OTHER ☐
DEEPEN ☐ PLUG BACK ☐
SINGLE ZONE ☐ MULTIPLE ZONE ☐

2. Name of Operator
Marathon Oil Company

3. Address of Operator
Box 220 Hobbs, New Mexico

4. Location of Well
UNIT LETTER L LOCATED 1980 FEET FROM THE south LINE
AND 660 FEET FROM THE west LINE OF SEC. 35 TWP. 7S RGE. 33E NMPM

23.

PROPOSED CASING AND CEMENT PROGRAM					
SIZE OF HOLE	SIZE OF CASING	WEIGHT PER FOOT	SETTING DEPTH	SACKS OF CEMENT	EST. TOP
12-1/4"	8-5/8"	24	350'	150	surface
7-7/8"	5-1/2"	15.5 and 17	4500'	350	3500'

IN ABOVE SPACE DESCRIBE PROPOSED PROGRAM: IF PROPOSAL IS TO DEEPEN OR PLUG BACK, GIVE DATA ON PRESENT PRODUCTIVE ZONE AND PROPOSED NEW PRODUCTIVE ZONE. GIVE BLOWOUT PREVENTER PROGRAM, IF ANY.

I hereby certify that the information above is true and complete to the best of my knowledge and belief.

Signed [Signature] Title Area Supt. Date 12-9-65

(This space for State Use)

APPROVED BY [Signature] TITLE DATE

CONDITIONS OF APPROVAL, IF ANY:

NEW MEXICO OIL CONSERVATION COMMISSION
WELL LOCATION AND ACREAGE DEDICATION PLAT

Form O-102
Supersedes O-128
Effective 1-1-65

All distances must be from the outer boundaries of the section.

Operator MARATHON OIL COMPANY		Lease DEC 10 11 23 AM '65		Well No. 1
Unit Letter L	Section 35	Township 7 SOUTH	Range 33 EAST	County ROOSEVELT
Actual Footage Location of Well: 1980 feet from the SOUTH line and 660 WEST line.				
Ground Level Elev.	Producing Formation SAN ANDRES PROSPECT	Pool UNDESIGNATED	Dedicated Acreage 40	

1. Outline the acreage dedicated to the subject well by colored pencil or hatch marks on the plat below.
2. If more than one lease is dedicated to the well, outline each and identify the ownership thereof (both as to working interest and royalty).
3. If more than one lease of different ownership is dedicated to the well, have the interests of all owners been consolidated by communitization, unitization, force-pooling, etc?

☐ Yes ☐ No If answer is "yes," type of consolidation _____

If answer is "no," list the owners and tract descriptions which have actually been consolidated. (Use reverse side of this form if necessary.) _____

No allowable will be assigned to the well until all interests have been consolidated (by communitization, unitization, forced-pooling, or otherwise) or until a non-standard unit, eliminating such interests, has been approved by the Commission.

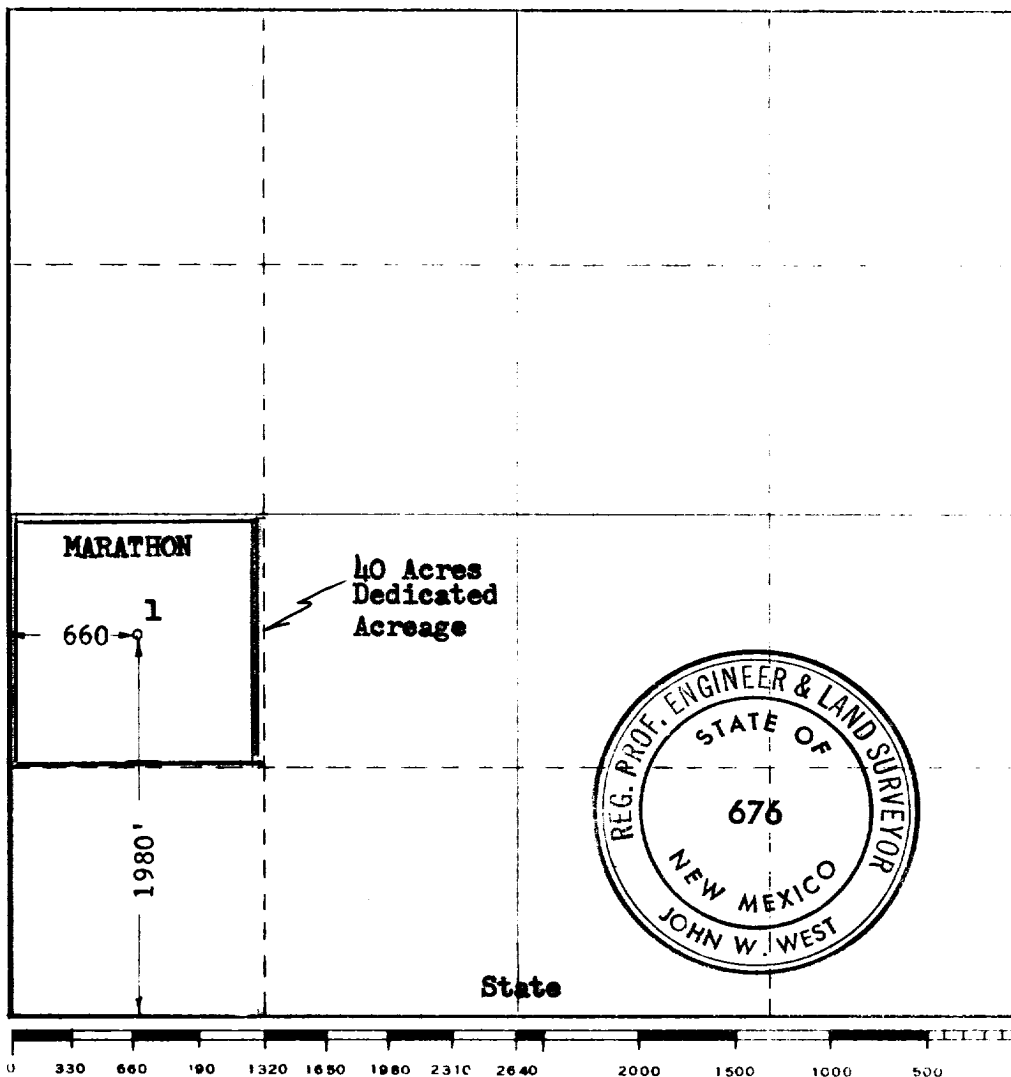

CERTIFICATION

I hereby certify that the information contained herein is true and complete to the best of my knowledge and belief.

J. R. Barber
J. R. Barber

Area Petroleum Engineer

Marathon Oil Company

Date
12-8-65

I hereby certify that the well location shown on this plat was plotted from field notes of actual surveys made by me or under my supervision, and that the same is true and correct to the best of my knowledge and belief.

Date Surveyed
DEC. 4, 1965

Registered Professional Engineer and/or Land Surveyor

John W. West
Certificate No. **676**