

NO. OF COPIES RECEIVED	
DISTRIBUTION	
SANTA FE	
FILE	
U.S.G.S.	
LAND OFFICE	
OPERATOR	

NEW MEXICO OIL CONSERVATION COMMISSION

Form C-101
Revised 1-1-65

OCT 20 11 28 AM '65

5A. Indicate Type of Lease	
STATE <input type="checkbox"/>	FEE <input checked="" type="checkbox"/>
5. State Oil & Gas Lease No.	
7. Unit Agreement Name	
8. Farm or Lease Name Carter	
9. Well No. 1	
10. Field and Pool, or Wildcat Milnesand-San Andres	
12. County Roosevelt	
19. Proposed Depth 4800	19A. Formation San Andres
20. Rotary or C.T. Rotary Tools	
21. Elevations (Show whether DF, RT, etc.) 4197 GL	21A. Kind & Status Plug. Bond State Wide
21B. Drilling Contractor Sutton & Norton	
22. Approx. Date Work will start October 23, 1965	

APPLICATION FOR PERMIT TO DRILL, DEEPEN, OR PLUG BACK

a. Type of Work	
DRILL <input checked="" type="checkbox"/>	DEEPEN <input type="checkbox"/>
b. Type of Well	
OIL WELL <input checked="" type="checkbox"/>	GAS WELL <input type="checkbox"/>
OTHER <input type="checkbox"/>	
2. Name of Operator Tom L. Ingram	
3. Address of Operator P. O. Box 1757 - Roswell, New Mexico	
4. Location of Well	
UNIT LETTER E	LOCATED 1650'
FEET FROM THE North LINE	
AND 330	FEET FROM THE West LINE OF SEC. 28
TWP. 8-S RGE. 35-E NMPM	
19. Proposed Depth 4800	
19A. Formation San Andres	
20. Rotary or C.T. Rotary Tools	
21. Elevations (Show whether DF, RT, etc.) 4197 GL	
21A. Kind & Status Plug. Bond State Wide	
21B. Drilling Contractor Sutton & Norton	
22. Approx. Date Work will start October 23, 1965	

PROPOSED CASING AND CEMENT PROGRAM

SIZE OF HOLE	SIZE OF CASING	WEIGHT PER FOOT	SETTING DEPTH	SACKS OF CEMENT	EST. TOP
11	8-5/8"	24#	300	200	Circ.
6-3/4	4-1/2"	9.5#	4800	200	

Drill to 4800', test, set casing, perforate, stimulate and complete.

IN ABOVE SPACE DESCRIBE PROPOSED PROGRAM: IF PROPOSAL IS TO DEEPEN OR PLUG BACK, GIVE DATA ON PRESENT PRODUCTIVE ZONE AND PROPOSED NEW PRODUCTIVE ZONE. GIVE BLOWOUT PREVENTER PROGRAM, IF ANY.

I hereby certify that the information above is true and complete to the best of my knowledge and belief.

Signed Tom L. Ingram Title Operator Date October 18, 1965

(This space for State Use)

APPROVED BY Joe L. Ramirez TITLE _____ DATE _____

CONDITIONS OF APPROVAL, IF ANY:

**NEW MEXICO OIL CONSERVATION COMMISSION
WELL LOCATION AND ACREAGE DEDICATION PLAT**

Form O-112
Supersedes O-128
Effective 4-1-65

All distances must be from the outer boundaries of the Section.

Operator TOM L. INGRAM			Lease CARTER		Well No. 1
Unit Letter E	Section 28	Township 8 SOUTH	Range 35 EAST	County ROOSEVELT	
Actual Footage Location of Well:					
1650 feet from the NORTH line and		330 feet from the WEST line			
Ground Level Elev. 4197 GL	Producing Formation San Andres		Pool Milnesand-San Andres		Estimated Acreage 40

1. Outline the acreage dedicated to the subject well by colored pencil or hachure marks on the plat below
2. If more than one lease is dedicated to the well, outline each and identify the ownership thereof (both as to working interest and royalty).
3. If more than one lease of different ownership is dedicated to the well, have the interests of all owners been consolidated by communitization, unitization, force-pooling, etc?

☐ Yes ☐ No If answer is "yes," type of consolidation _____

If answer is "no," list the owners and tract descriptions which have actually been consolidated. (Use reverse side of this form if necessary.) _____

No allowable will be assigned to the well until all interests have been consolidated (by communitization, unitization, forced-pooling, or otherwise) or until a non-standard unit, eliminating such interests, has been approved by the Commission.

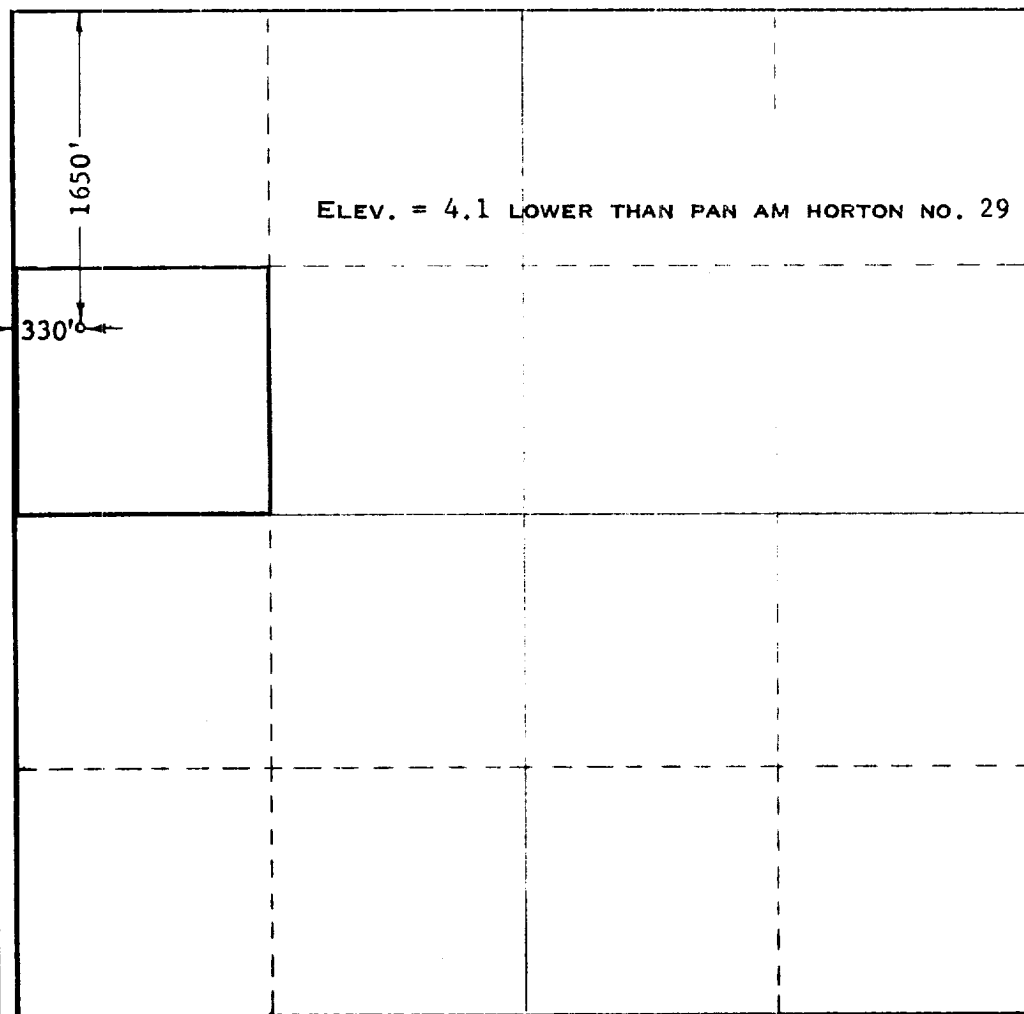

CERTIFICATION

I hereby certify that the information contained herein is true and complete to the best of my knowledge and belief.

Tom L. Ingram
Name _____

Operator

Position _____

Tom L. Ingram

Company _____

October 18, 1965

Date _____

I hereby certify that the well location shown on this plat was plotted from field notes of actual surveys made by me or under my supervision and that the same is true and correct to the best of my knowledge and belief.

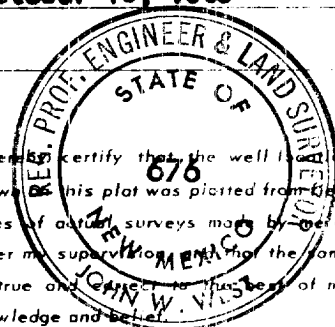

Date Surveyed _____

10-15-65

Registered Professional Engineer and/or Land Surveyor

John W. West
Certificate No. _____

N.M. P.E. & L.S. No. 676

