

UNITED STATES
DEPARTMENT OF THE INTERIOR
GEOLOGICAL SURVEY

(Other instructions on
reverse side)

Budget Bureau

APPLICATION FOR PERMIT TO DRILL, DEEPEN, OR PLUG BACK

1a. TYPE OF WORK DRILL <input checked="" type="checkbox"/> DEEPEN <input type="checkbox"/> PLUG BACK <input type="checkbox"/>		5. LEASE DESIGNATION AND SERIAL NO. NM 0108997-A
b. TYPE OF WELL OIL WELL <input checked="" type="checkbox"/> GAS WELL <input type="checkbox"/> OTHER <input type="checkbox"/>		6. IF INDIAN, ALLOTTEE OR TRIBE NAME -
2. NAME OF OPERATOR Kern County Land Company		7. UNIT AGREEMENT NAME -
3. ADDRESS OF OPERATOR 418 First State Bank Bldg., Midland, Texas		8. FARM OR LEASE NAME Federal 23
4. LOCATION OF WELL (Report location clearly and in accordance with any State requirements.) At surface 660' FWL, & 1980' FSL Sec. 23 (Unit L NW/4 SW/4) At proposed prod. zone		9. WELL NO. 5
14. DISTANCE IN MILES AND DIRECTION FROM NEAREST TOWN OR POST OFFICE* Approx. 16 miles N&W of Milnesand, N.M.		10. FIELD AND POOL, OR WILDCAT Chaveroo - San Andres
15. DISTANCE FROM PROPOSED* LOCATION TO NEAREST PROPERTY OR LEASE LINE, FT. (Also to nearest drilg. unit line, if any)	16. NO. OF ACRES IN LEASE 2160	11. SEC., T., R., M., OR BLK. AND SURVEY OR AREA 23-T7S-R33E, NMPM
18. DISTANCE FROM PROPOSED LOCATION* TO NEAREST WELL, DRILLING, COMPLETED, OR APPLIED FOR, ON THIS LEASE, FT.	19. PROPOSED DEPTH 4500	12. COUNTY OR PARISH Roosevelt
21. ELEVATIONS (Show whether DF, RT, GR, etc.) To be furnished later.		13. STATE N.M.
20. ROTARY OR CABLE TOOLS Rotary		17. NO. OF ACRES ASSIGNED TO THIS WELL 40
22. APPROX. DATE WORK WILL START* April, 1966		

23. PROPOSED CASING AND CEMENTING PROGRAM				
SIZE OF HOLE	SIZE OF CASING	WEIGHT PER FOOT	SETTING DEPTH	QUANTITY OF CEMENT
11-12 1/4"	8 5/8"	24	430	Circulate
7 7/8"	4 1/2"	9.5	4500	Fill 600' above pay.

Drill well to total depth. Run logs and evaluate well. Run and cement casing.
Perforate and stimulate well as necessary for commercial production.

IN ABOVE SPACE DESCRIBE PROPOSED PROGRAM: If proposal is to deepen or plug back, give data on present productive zone and proposed new productive zone. If proposal is to drill or deepen directionally, give pertinent data on subsurface locations and measured and true vertical depths. Give blowout preventer program, if any.

24. SIGNED E. J. E. Jones TITLE District Engineer DATE 3-31-66

(This space for Federal or State office use)

PERMIT NO. 7 APPROVAL DATE _____

APPROVED BY _____ TITLE _____ DATE _____
CONDITIONS OF APPROVAL, IF ANY:

*See Instructions On Reverse Side

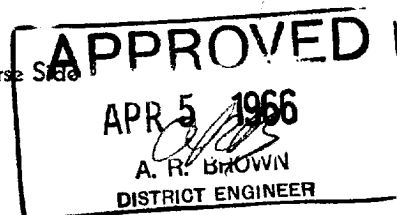

NEW MEXICO OIL CONSERVATION COMMISSION
WELL LOCATION AND ACREAGE DEDICATION PLAT

Form C-102
Supersedes C-128
Effective 1-1-65

All distances must be from the outer boundaries of the Section.

Operator KERN COUNTY LAND CO.			Lease FEDERAL 23		Well No. 5
Unit Letter L	Section 23	Township 7 SOUTH	Range 33 EAST	County ROOSEVELT	
Actual Footage Location of Well: 1980 feet from the SOUTH line and 660 feet from the WEST line					
Ground Level Elev.	Producing Formation SAN ANDRES		Pool CHAVEROO - SAN ANDRES	Dedicated Acreage: 40-NW$\frac{1}{4}$ or SW$\frac{1}{4}$ Acres	

1. Outline the acreage dedicated to the subject well by colored pencil or hatchure marks on the plat below.
2. If more than one lease is dedicated to the well, outline each and identify the ownership thereof (both as to working interest and royalty).
3. If more than one lease of different ownership is dedicated to the well, have the interests of all owners been consolidated by communitization, unitization, force-pooling, etc? —

☐ Yes ☐ No If answer is "yes," type of consolidation —

If answer is "no," list the owners and tract descriptions which have actually been consolidated. (Use reverse side of this form if necessary.) —

No allowable will be assigned to the well until all interests have been consolidated (by communitization, unitization, forced-pooling, or otherwise) or until a non-standard unit, eliminating such interests, has been approved by the Commission.

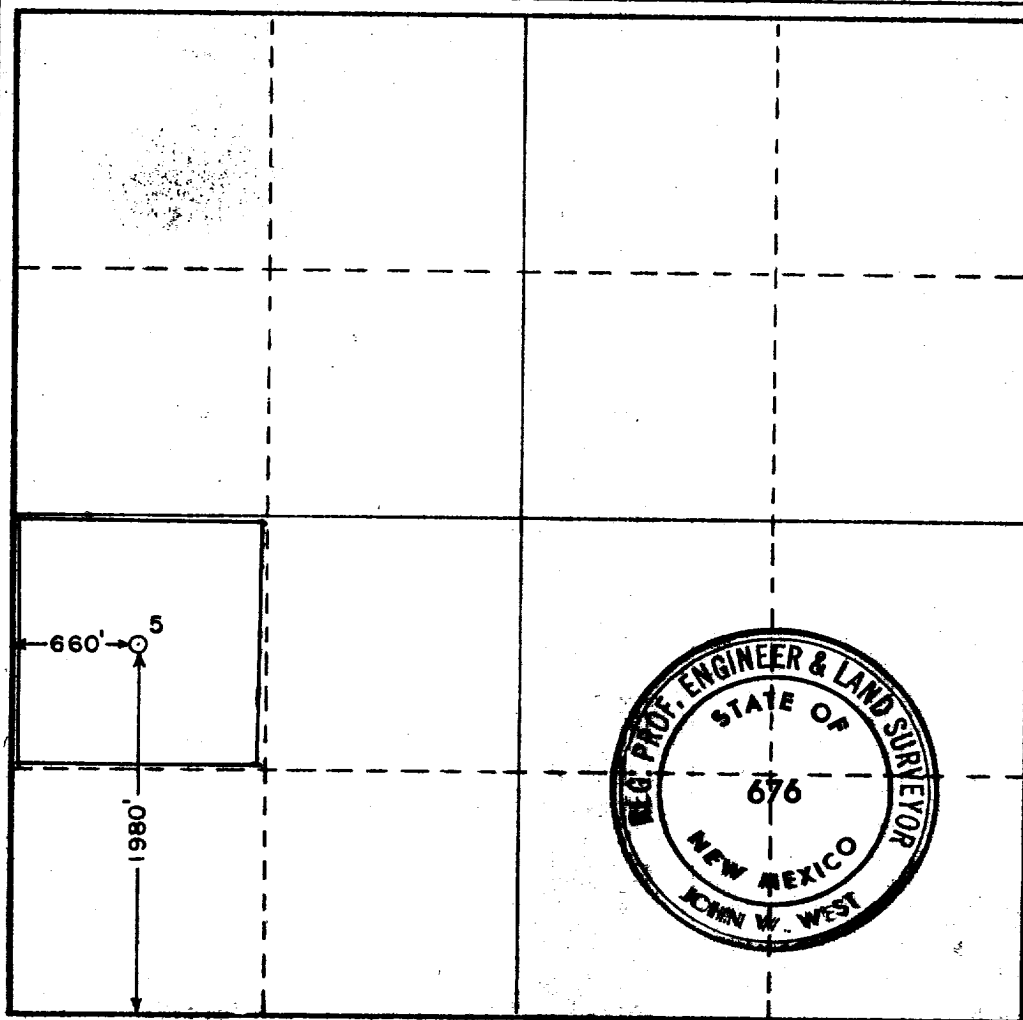

CERTIFICATION

I hereby certify that the information contained herein is true and complete to the best of my knowledge and belief.

Name *Ronald W. Young*
Position *Dist. Prod. Supt.*
Company *Kern County Land Co.*
Date *4-1-66*

I hereby certify that the well location shown on this plat was plotted from field notes of actual surveys made by me or under my supervision, and that the same is true and correct to the best of my knowledge and belief.

Date Surveyed **MARCH 31, 1966**

Registered Professional Engineer and/or Land Surveyor

John W. West
Certificate No.

NM PE & LS 676