

NEW MEXICO OIL CONSERVATION COMMISSION  
WELL LOCATION AND ACREAGE DEDICATION PLAT

Form C-102  
Supersedes C-128  
Effective 1-1-65

All distances must be from the outer boundaries of the Section

Lessee <b>PAN AMERICAN PETROLEUM CORP.</b>		Lease <b>STATE DB</b>		Well No. <b>669</b>
Unit Letter <b>D</b>	Section <b>25</b>	Township <b>7 SOUTH</b>	Range <b>33 EAST</b>	County <b>ROOSEVELT</b>

Actual Location of Well:

<b>660</b> feet from the <b>SOUTH</b> line and <b>1980</b> feet from the <b>EAST</b> line	Ground Level Elev. <b>SAN ANDRES</b>	Producing Formation <b>CHAUEROO SAN ANDRES</b>	Dedicated Acreage: <b>40</b> Acres
---	---	---	---------------------------------------

1. Outline the acreage dedicated to the subject well by colored pencil or hatchure marks on the plat below.
2. If more than one lease is dedicated to the well, outline each and identify the ownership thereof (both as to working interest and royalty).
3. If more than one lease of different ownership is dedicated to the well, have the interests of all owners been consolidated by communitization, unitization, force-pooling, etc?

☐ Yes ☐ No If answer is "yes," type of consolidation \_\_\_\_\_

If answer is "no," list the owners and tract descriptions which have actually been consolidated. (Use reverse side of this form if necessary.) \_\_\_\_\_

No allowable will be assigned to the well until all interests have been consolidated (by communitization, unitization, forced-pooling, or otherwise) or until a non-standard unit, eliminating such interests, has been approved by the Commission.

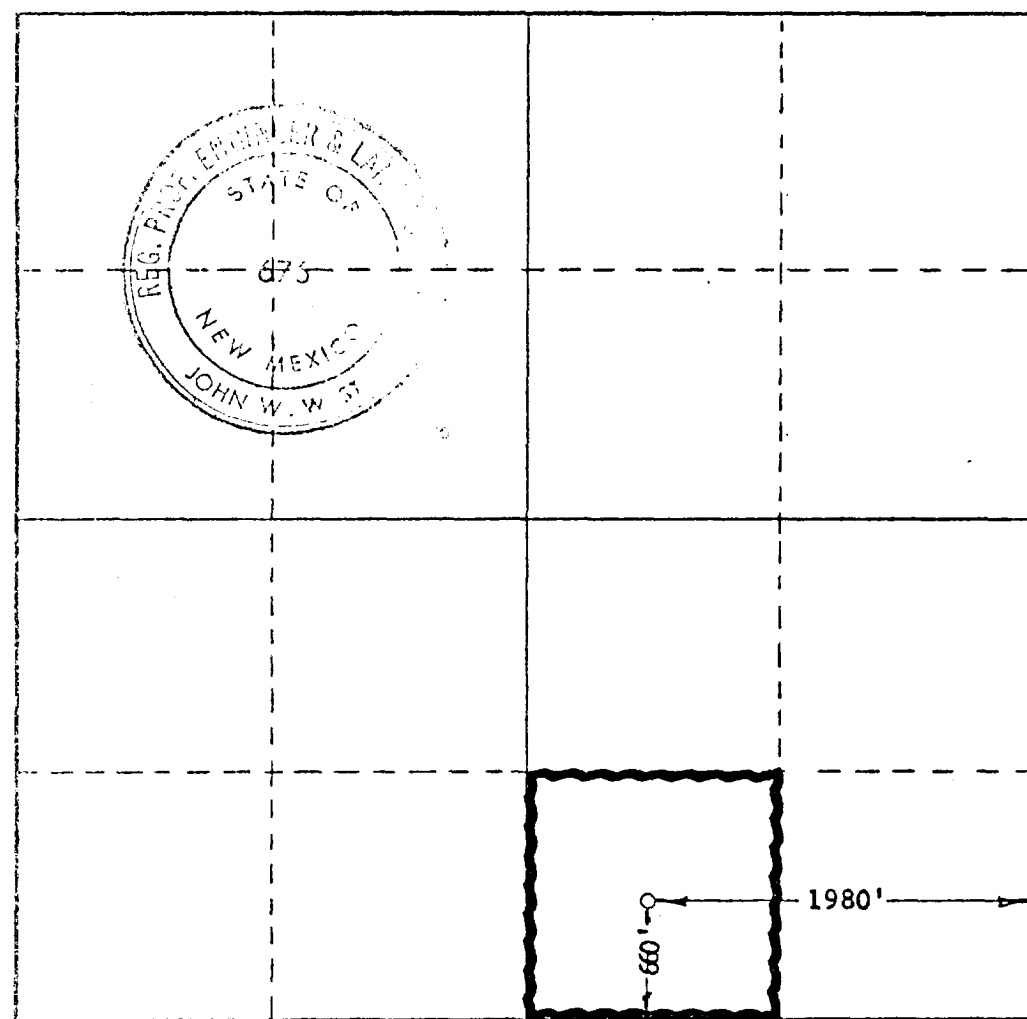

CERTIFICATION

I hereby certify that the information contained herein is true and complete to the best of my knowledge and belief.

Name \_\_\_\_\_

Position \_\_\_\_\_

Company \_\_\_\_\_

Date \_\_\_\_\_

I hereby certify that the well location shown on this plat was plotted from field notes of actual surveys made by me or under my supervision, and that the same is true and correct to the best of my knowledge and belief.

Date Surveyed \_\_\_\_\_

**6/7/66**

Registered Professional Engineer and/or Land Surveyor

*John W. West*

Certificate No. \_\_\_\_\_

**676**



**LTR**



**Job separation sheet**

COUNTY	ROOSEVELT		FIELD	Chaveroo		STATE	NM	
OPR	PAN AMERICAN PETROLEUM CORPORATION						MAP	
	9 State "DB"							
	Sec. 25, T-7-S, R-33-E						CO-ORD	
	660' FSL, 1980' FEL of Sec.						MX 10591	
	Spd 6-10-66		CLASS		ED [REDACTED]			
	Cmp 7-12-66		FORMATION	DATUM	FORMATION	DATUM		
CSG & SX - TUBING								
8 5/8" 449' 250								
4 1/2" 4498' 800								
LOGS EL GR RA IND HC A								
			TD 4498', PBD 4457'					

IP San Andres Perfs 4223-4373' Pmpd 67 BOPD + 8 BW. Pot. based on 24 hr test, gravity 24., GOR 318.

Distribution limited and publication prohibited by subscribers' agreement.  
Reproduction rights reserved by Williams & Lee Scouting Service, Inc.

CONT.	Chico Drlg. Co.	PROP DEPTH	4465'	TYPE
DATE				

F.R. 6-16-66; Opr's Elev. 4390' ~~KS~~  
 PD 4465' - SA  
 Contr. - Chico Drlg. Co.  
 6-14-66 Drlg. 3169'.  
 6-20-66 Drlg. 4440'.  
 6-27-66 TD 4498', PBD 4457', tstg.  
 Perf 4223-25', 4235-45', 4264-66', 4273-77',  
 4281-83', 4285-87', 4297-4303', 4306-10',  
 4317-23', 4330-34', 4336-40', 4343-47',  
 4353-55', 4357-63', 4369-73' W/2 SPF  
 Acid (4223-4373') 2000 gals.  
 Swbd 40 BNO + 22 BLW/8½ hrs.  
 Frac (4223-4373') 30,000 gals oil + 45,000#  
 sd. + 3000# glass beads; IR 33.6 BPM  
 Flwd 110 BLO/24 hrs thru 15/64" chk.

7-5-66 TD 4498', PBD 4457', pmpg load.  
Pmpd 31 BLO/12 hrs (-452 BLO)  
7-11-66 TD 4498', PBD 4457', pmpg load.  
Pmpd 97 BLO + 5 BLW + 18 BNW/24 hrs.  
7-18-66 TD 4498', PBD 4457', COMPLETE.  
LOG TOPS: Yates 2274', Queen 2990',  
San Andres 3475'.