

NO. OF COPIES RECEIVED	
DISTRIBUTION	
SANTA FE	
FILE	
U.S.G.S.	
LAND OFFICE	
OPERATOR	

NEW MEXICO OIL CONSERVATION COMMISSION  
OFFICE OF THE COMMISSIONER

JUN 21 12 55 PM '66

Form C-101  
Revised 1-4-65

5A. Indicate Type of Lease STATE <input checked="" type="checkbox"/> FEE <input type="checkbox"/>
5. State Oil & Gas Lease No. OG 1193
7. Unit Agreement Name
8. Farm or Lease Name State 0
9. Well No. 4
10. Field and Pool, or Wildcat Chavaroo
12. County Roosevelt
19. Proposed Depth 4500
19A. Formation San Andres
20. Rotary or C.T. Rotary
21. Elevations (Show whether DF, RT, etc.) 21A. Kind & Status Plug. Bond In Effect
21B. Drilling Contractor
22. Approx. Date Work will start 6-30-66

APPLICATION FOR PERMIT TO DRILL, DEEPEN, OR PLUG BACK

1a. Type of Work b. Type of Well OIL WELL <input checked="" type="checkbox"/> GAS WELL <input type="checkbox"/> OTHER <input type="checkbox"/> DEEPEN <input type="checkbox"/> PLUG BACK <input type="checkbox"/> SINGLE ZONE <input checked="" type="checkbox"/> MULTIPLE ZONE <input type="checkbox"/>	2. Name of Operator Kerr-McGee Corporation	3. Address of Operator Box K Sunray Texas	4. Location of Well UNIT LETTER 0 LOCATED 660 FEET FROM THE South LINE AND 2310 FEET FROM THE East LINE OF SEC. 19 TWP. 7 RGE. 34 E NMPM
23.			

PROPOSED CASING AND CEMENT PROGRAM

SIZE OF HOLE	SIZE OF CASING	WEIGHT PER FOOT	SETTING DEPTH	SACKS OF CEMENT	EST. TOP
12 1/4	8 5/8	24	400	275	Circulate
7 7/8	5 1/2	14	4500	350	3200

Drill 12 1/4" hole with rotary to 400'. Set 8 5/8" OD 24# casing and cement to surface. Then drill 7 7/8" hole to 4500' and set 5 1/2" OD 14# casing and cement with 350 sxs of cement. Run logs and complete in the San Andres. Will install 8" Shaffer, Type 45 BOP's with pipe rams in top and blind rams in bottom. Casinghead outlets will be used for kill and choke lines.

IN ABOVE SPACE DESCRIBE PROPOSED PROGRAM: IF PROPOSAL IS TO DEEPEN OR PLUG BACK, GIVE DATA ON PRESENT PRODUCTIVE ZONE AND PROPOSED NEW PRODUCTIVE ZONE. GIVE BLOWOUT PREVENTER PROGRAM, IF ANY.

I hereby certify that the information above is true and complete to the best of my knowledge and belief.

Signed W.C. Barton Title Division Supt of Production Date 6-20-1966  
(This space for State Use)

APPROVED BY \_\_\_\_\_ TITLE \_\_\_\_\_ DATE \_\_\_\_\_  
CONDITIONS OF APPROVAL, IF ANY:

NEW MEXICO OIL CONSERVATION COMMISSION  
WELL LOCATION AND ACREAGE DEDICATION PLAT

Form C-102  
Supersedes C-128  
Effective 1-4-65

All distances must be from the outer boundaries of the Section.

JUN 21 1 42 PM '66  
OFFICE O. C. C.

Operator <b>KERR MCGEE CORPORATION</b>		Lease <b>STATE G</b>		
Unit Letter <b>O</b>	Section <b>19</b>	Township <b>7 SOUTH</b>	Range <b>34 EAST</b>	County <b>ROOSEVELT</b>
Actual Footage Location of Well: <b>660</b> feet from the <b>SOUTH</b> line and <b>2310</b> feet from the <b>EAST</b> line				
Ground Level Elev.	Producing Formation <b>SAN ANDRES</b>	Pool <b>CHAVEROO</b>	Dedicated Acreage: <b>40</b> Acres	

1. Outline the acreage dedicated to the subject well by colored pencil or hachure marks on the plat below.
2. If more than one lease is dedicated to the well, outline each and identify the ownership thereof (both as to working interest and royalty).
3. If more than one lease of different ownership is dedicated to the well, have the interests of all owners been consolidated by communitization, unitization, force-pooling, etc?

☐ Yes ☐ No If answer is "yes," type of consolidation \_\_\_\_\_

If answer is "no," list the owners and tract descriptions which have actually been consolidated. (Use reverse side of this form if necessary.) \_\_\_\_\_

No allowable will be assigned to the well until all interests have been consolidated (by communitization, unitization, forced-pooling, or otherwise) or until a non-standard unit, eliminating such interests, has been approved by the Commission.

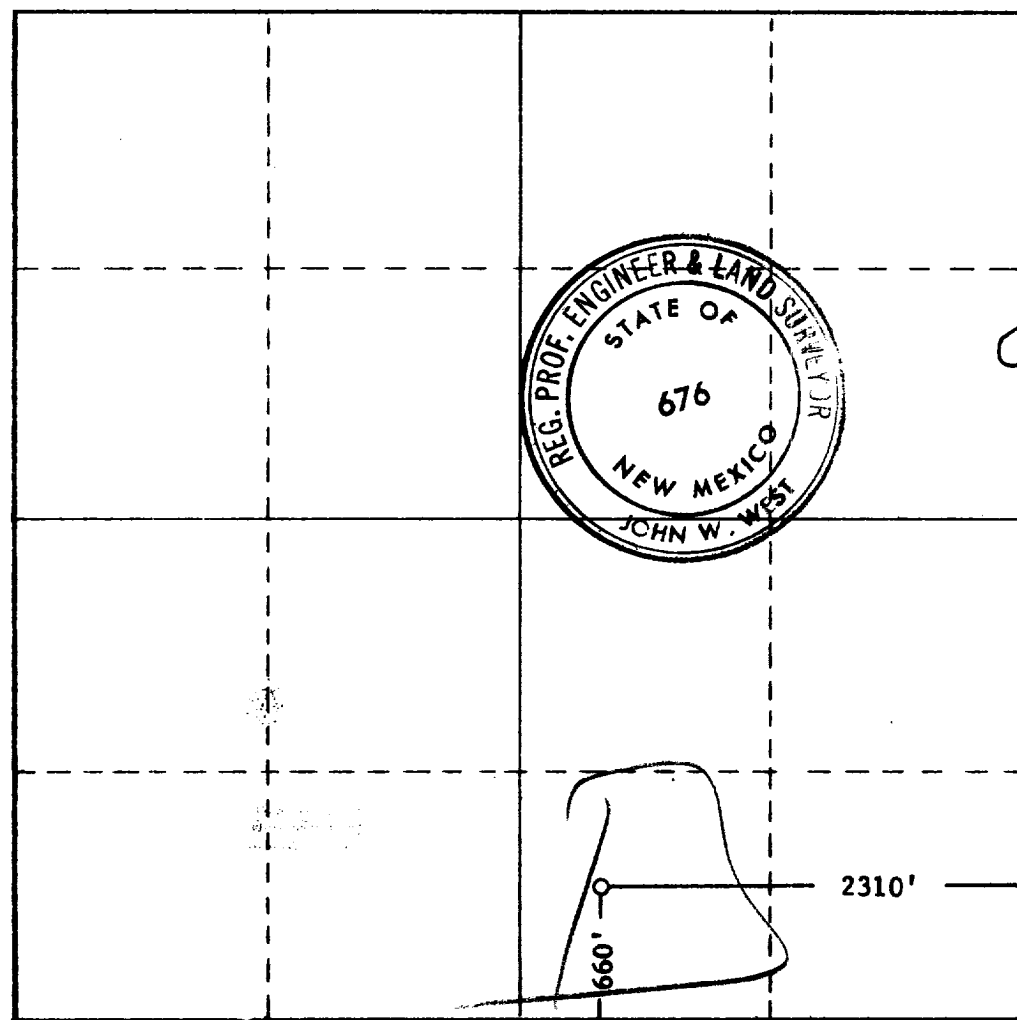

CERTIFICATION

I hereby certify that the information contained herein is true and complete to the best of my knowledge and belief.

Name John W. West  
Position AGENT  
Company KERR MCGEE CORP.  
Date 6-21-1966

I hereby certify that the well location shown on this plat was plotted from field notes of actual surveys made by me or under my supervision, and that the same is true and correct to the best of my knowledge and belief.

Date Surveyed 6-21-1966

Registered Professional Engineer and/or Land Surveyor

John W. West  
Certificate No. 676

