

NO. OF COPIES RECEIVED	
DISTRIBUTION	
SANTA FE	
FILE	
U.S.G.S.	
LAND OFFICE	
OPERATOR	

NEW MEXICO OIL CONSERVATION COMMISSION

Form C-103
Supersedes Old
C-102 and C-103
Effective 1-1-65

5a. Indicate Type of Lease	State <input checked="" type="checkbox"/> Fee <input type="checkbox"/>
----------------------------	--

5. State Oil & Gas Lease No.

CG-91

SUNDRY NOTICES AND REPORTS ON WELLS

(DO NOT USE THIS FORM FOR PROPOSALS TO DRILL OR TO DEEPEN OR PLUG BACK TO A DIFFERENT RESERVOIR. USE "APPLICATION FOR PERMIT -" (FORM C-101) FOR SUCH PROPOSALS.)

1. OIL WELL <input checked="" type="checkbox"/> GAS WELL <input type="checkbox"/> OTHER <input type="checkbox"/>	7. Unit Agreement Name
2. Name of Operator Ard Drilling Company	8. Farm or Lease Name Ohio State
3. Address of Operator c/o Oil Reports & Gas Services, Box 763, Hobbs, New Mexico	9. Well No. 1
4. Location of Well UNIT LETTER E , 1980 FEET FROM THE North LINE AND 660 FEET FROM THE West LINE, SECTION 32 TOWNSHIP 8S RANGE 34E NMPM.	10. Field and Pool, or Wildcat Undes. CLR-San Andres
15. Elevation (Show whether DF, RT, GR, etc.) 4297.7 GL	12. County Roosevelt

16.

Check Appropriate Box To Indicate Nature of Notice, Report or Other Data

NOTICE OF INTENTION TO:

PERFORM REMEDIAL WORK ☐
TEMPORARILY ABANDON ☐
PULL OR ALTER CASING ☐
OTHER ☐

PLUG AND ABANDON ☐
CHANGE PLANS ☐

SUBSEQUENT REPORT OF:

REMEDIAL WORK ☐
COMMENCE DRILLING OPNS. ☒
CASING TEST AND CEMENT JOB ☒
OTHER ☐

ALTERING CASING ☐
PLUG AND ABANDONMENT ☐

17. Describe Proposed or Completed Operations (Clearly state all pertinent details, and give pertinent dates, including estimated date of starting any proposed work) SEE RULE 1103.

Spudded 7:30 A.M. 8/18/66. Cemented 8 5/8" 24# J-55 casing at 377 feet with 275 sacks regular cement with 2% calcium chloride. Plug down 3:15 P.M. 8/18/66. Cement circulated to surface. Casing held under pressure 8 hours and tested with 600# for 30 minutes test O.K. Drilled out plug 3:15 A.M. 8/19/66. Compression strength 500 psi by Halliburton.

18. I hereby certify that the information above is true and complete to the best of my knowledge and belief.

SIGNED

H. L. Smith

TITLE

Agent

DATE

August 19, 1966

APPROVED BY

TITLE

DATE

CONDITIONS OF APPROVAL, IF ANY:

NO. OF COPIES RECEIVED	
DISTRIBUTION	
SANTA FE	
FILE	
U.S.G.S.	
LAND OFFICE	
OPERATOR	

NEW MEXICO OIL CONSERVATION COMMISSION

Form C-101
Revised 1-4-55

5A. Indicate Type of Lease
STATE <input checked="" type="checkbox"/> FEE <input type="checkbox"/>
5. State Oil & Gas Lease No.
06-91
7. Unit Agreement Name
8. Farm or Lease Name
Ohio State
9. Well No.
1
10. Field and Pool, or Wildcat
Undes. CLR-San Andres
12. County
Roosevelt
19. Proposed Depth
4700
19A. Formation
San Andres
20. Rotary or C.T.
Rotary
21. Elevations (Show whether DF, RT, etc.)
4297.7 GL
21A. Kind & Status Plug. Bond
Being Filed
21B. Drilling Contractor
Company tools
22. Approx. Date Work will start
Upon Approval

APPLICATION FOR PERMIT TO DRILL, DEEPEN, OR PLUG BACK

1a. Type of Work	DRILL <input checked="" type="checkbox"/>	DEEPEN <input type="checkbox"/>	PLUG BACK <input type="checkbox"/>
b. Type of Well	OIL WELL <input checked="" type="checkbox"/>	GAS WELL <input type="checkbox"/>	OTHER <input type="checkbox"/>
2. Name of Operator	Ard Drilling Company		
3. Address of Operator	c/o Oil Reports & Gas Services, Box 763, Hobbs, New Mexico		
4. Location of Well	UNIT LETTER <u>E</u> LOCATED <u>1980</u> FEET FROM THE <u>North</u> LINE		
AND <u>660</u> FEET FROM THE <u>West</u> LINE OF SEC. <u>32</u> TWP. <u>8 S</u> RGE. <u>34 E</u> NMPM			
21. Elevations (Show whether DF, RT, etc.)	21A. Kind & Status Plug. Bond	21B. Drilling Contractor	22. Approx. Date Work will start
4297.7 GL	Being Filed	Company tools	Upon Approval

23.

PROPOSED CASING AND CEMENT PROGRAM

SIZE OF HOLE	SIZE OF CASING	WEIGHT PER FOOT	SETTING DEPTH	SACKS OF CEMENT	EST. TOP
12 1/4	8 5/8	24#	350	Circulated	
7 7/8	4 1/2	9.5#	4700	300	3300

APPROVAL VALID
FOR 90 DAYS UNLESS
EARLIER COMPLETION

EXPIRES 11/17/66

IN ABOVE SPACE DESCRIBE PROPOSED PROGRAM: IF PROPOSAL IS TO DEEPEN OR PLUG BACK, GIVE DATA ON PRESENT PRODUCTIVE ZONE AND PROPOSED NEW PRODUCTIVE ZONE. GIVE BLOWOUT PREVENTER PROGRAM, IF ANY.

I hereby certify that the information above is true and complete to the best of my knowledge and belief.

Signed H. L. Smith Title Agent Date August 15, 1956
(This space for State Use)

APPROVED BY _____ TITLE _____ DATE _____
CONDITIONS OF APPROVAL, IF ANY:

**NEW MEXICO OIL CONSERVATION COMMISSION
WELL LOCATION AND ACREAGE DEDICATION PLAT**

Form C-102
Supersedes C-128
Effective 1-1-65

All distances must be from the outer boundaries of the Section.

Operator ARD DRILLING COMPANY			Lease OHIO STATE <i>AUG 15 6 15 AM '66</i>		Well No. 1
Unit Letter E	Section 32	Township 3 SOUTH	Range 34 EAST	County ROOSEVELT	
Actual Footage Location of Well: <div style="display: flex; justify-content: space-between;"> 80 feet from the NORTH line and 600 feet from the WEST line </div>					
Ground Level Elev. 4297.7	Producing Formation San Andres	Pool Undes. (CLR-San Andres)	Dedicated Acreage: 40 Acres		

1. Outline the acreage dedicated to the subject well by colored pencil or hachure marks on the plat below.
2. If more than one lease is dedicated to the well, outline each and identify the ownership thereof (both as to working interest and royalty).
3. If more than one lease of different ownership is dedicated to the well, have the interests of all owners been consolidated by communitization, unitization, force-pooling, etc?

☐ Yes ☐ No If answer is "yes," type of consolidation _____

If answer is "no," list the owners and tract descriptions which have actually been consolidated. (Use reverse side of this form if necessary.) _____

No allowable will be assigned to the well until all interests have been consolidated (by communitization, unitization, forced-pooling, or otherwise) or until a non-standard unit, eliminating such interests, has been approved by the Commission.

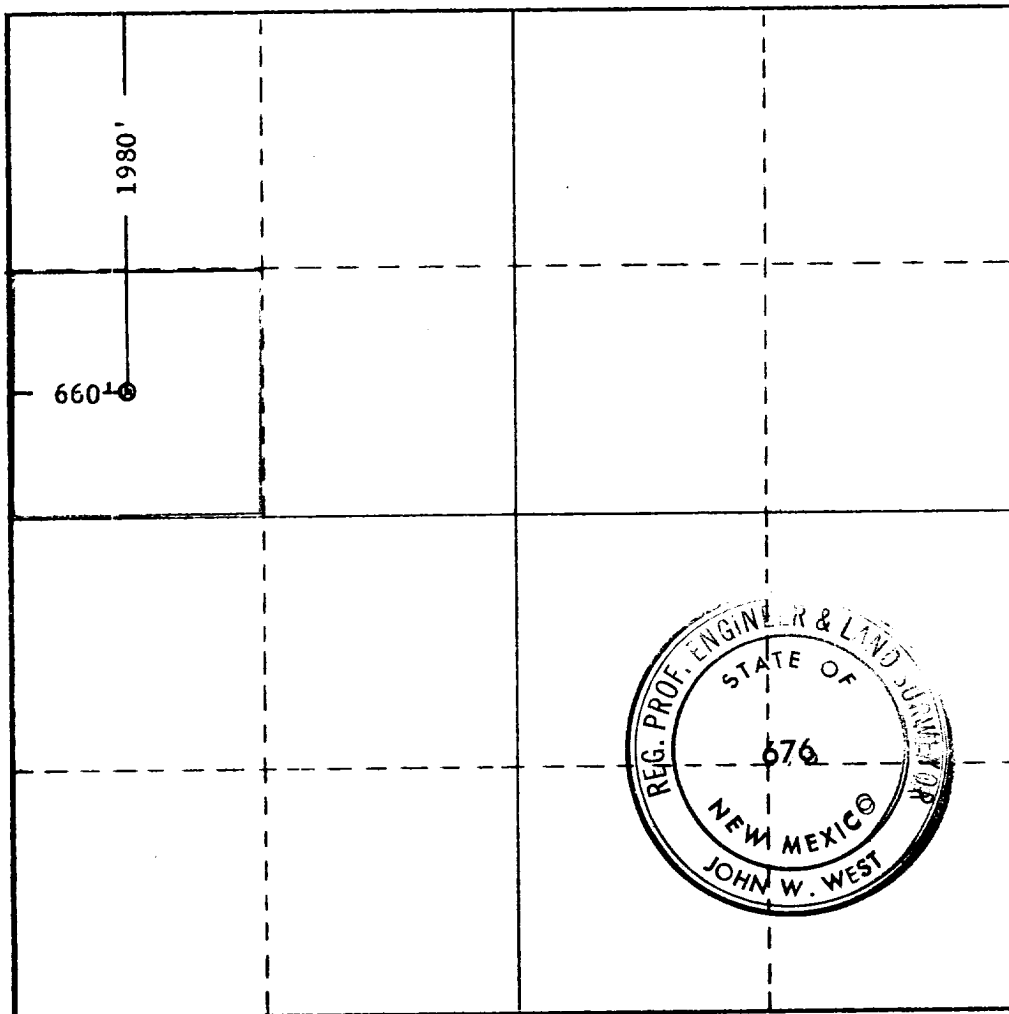

CERTIFICATION

I hereby certify that the information contained herein is true and complete to the best of my knowledge and belief.

Name *A. L. Smith*
 Position **Agent**
 Company **Ard Drilling Company**
 Date **August 15, 1966**

I hereby certify that the well location shown on this plat was plotted from field notes of actual surveys made by me or under my supervision, and that the same is true and correct to the best of my knowledge and belief.

Date Surveyed **AUGUST 12, 1966**
 Registered Professional Engineer and/or Land Surveyor

John W. West
 Certificate No. **576**

