

NEW MEXICO OIL CONSERVATION COMMISSION  
WELL LOCATION AND ACREAGE DEDICATION PLAT

Form C-102  
Supersedes C-128  
Effective 1-1-65

All distances must be from the outer boundaries of the Section.

Operator <b>INCA OIL AND GAS INC.</b>			Lease <b>FELMONT FEDERAL</b>		Well No. <b>1</b>
Unit Letter <b>A</b>	Section <b>9</b>	Township <b>8 SOUTH</b>	Range <b>37 EAST</b>	County <b>ROOSEVELT</b>	
Actual Footage Location of Well: <b>990</b> feet from the <b>NORTH</b> line and <b>990</b> feet from the <b>EAST</b> line					
Ground Level Elev. <b>4054.4</b>	Producing Formation <b>San Andres</b>		Pool <b>Bluitt Gas</b>	Dedicated Acreage: <b>320</b> Acres	

1. Outline the acreage dedicated to the subject well by colored pencil or hachure marks on the plat below.
2. If more than one lease is dedicated to the well, outline each and identify the ownership thereof (both as to working interest and royalty).
3. If more than one lease of different ownership is dedicated to the well, have the interests of all owners been consolidated by communitization, unitization, force-pooling, etc?

☐ Yes ☐ No If answer is "yes," type of consolidation \_\_\_\_\_

If answer is "no," list the owners and tract descriptions which have actually been consolidated. (Use reverse side of this form if necessary.) \_\_\_\_\_

No allowable will be assigned to the well until all interests have been consolidated (by communitization, unitization, forced-pooling, or otherwise) or until a non-standard unit, eliminating such interests, has been approved by the Commission.

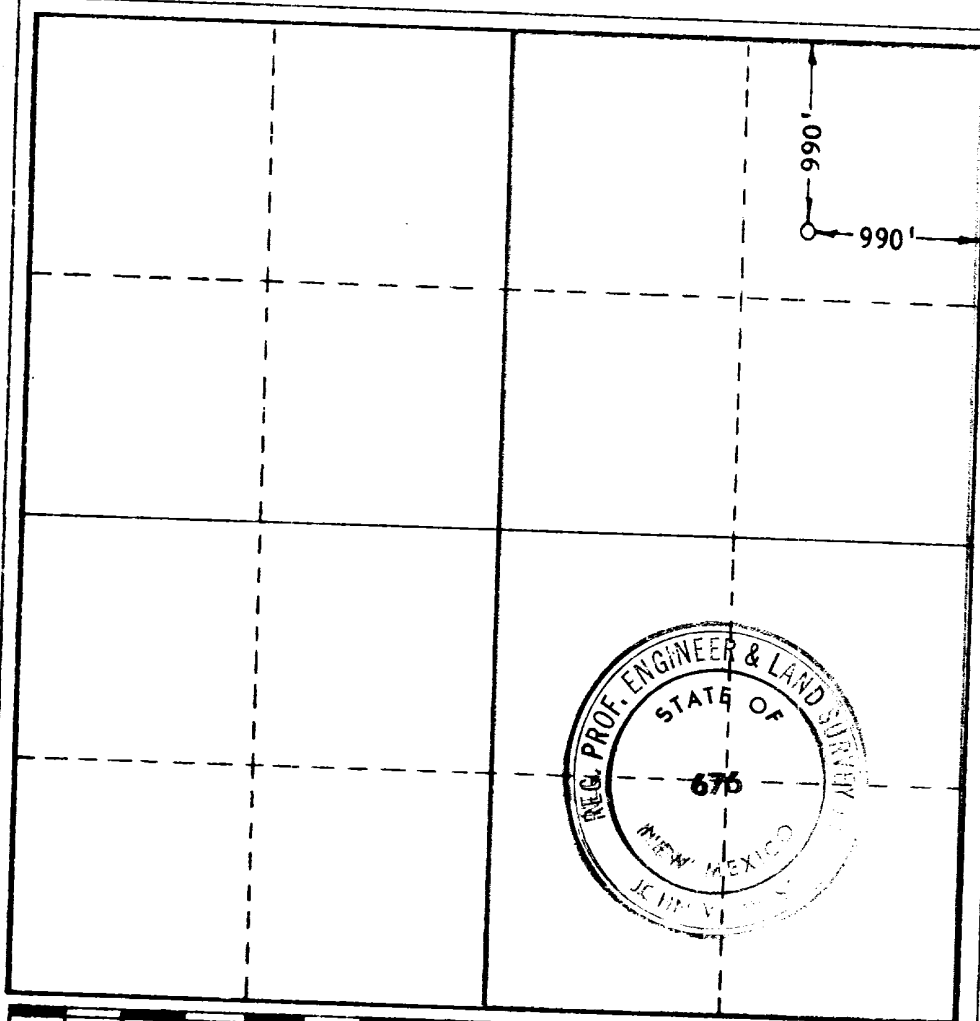

CERTIFICATION

I hereby certify that the information contained herein is true and complete to the best of my knowledge and belief.

Name  
*H. L. Brant*

Position  
**Agent**

Company  
**Inca Oil & Gas Inc.**

Date  
**September 2, 1966**

I hereby certify that the well location shown on this plat was plotted from field notes of actual surveys made by me or under my supervision, and that the same is true and correct to the best of my knowledge and belief.

Date Surveyed  
**8/31/66**

Registered Professional Engineer and/or Land Surveyor

*John C. West*  
Certificate No.

676

COUNTY	ROOSEVELT		FIELD	Bluit-SA		STATE	NM	
OPR	VNA OIL & GAS, INC.					MAP		
	1 Belmont-Federal							
	Sec. 9, T-8-S, R-37-E					CO-ORD		
	990' EEL, 990' EEL of Sec.					MX 10631		
	Std 9-9-66		CLASS		E [REDACTED]			
	Opr 12-27-66		FORMATION	DATUM	FORMATION	DATUM		
CSG & SX - TUBING								
8 5/8" 388' 150								
4 1/2" 4570' 100								
LOGS EL GR RA IND HC A								
			TD 4570'					
TP San Andres Perfs 4383-4510' Pmpd 40 BOED + 6 BW. Fct. Based on 24 hr test, TP 15#, GP 30#.								

Distribution limited and publication prohibited by subscribers' agreement.  
Reproduction rights reserved by Williams & Lee Consulting Service, Inc.

CONT	Verna Drilg. Co.	PROP DEPTH	4700'	TYPE
DATE				

F.R. 9-9-66; Opr's Elev. 4063' KB  
PD 4700' ~ SA  
Contr. - Verna  
9-12-66 Drilg. 3005'  
9-19-66 TD 4570', WO Completion Unit.  
9-27-66 TD 4570', WO Completion Unit.  
10-3-66 TD 4570', WO Completion Unit.  
10-10-66 TD 4570', instg.  
Perf @ 4383', 4388', 4414', 4427', 4446',  
4463', 4470', 4485', 4490', 4496', 4505',  
4510' w/1 SPI  
Acid (4383-4510') 1500 gals.  
Frac (4383-4510') 30,000 gals salt wtr +  
30,000# sd.  
Flwg load wtr + gas @ est. 2000 MCF/GED.  
10-17-66 TD 4570', prep potential.  
10-24-66 TD 4570', prep potential.  
11-1-66 TD 4570', prep potential.

11-2-66      ID 4570', WO Pot.  
11-14-66      ID 4570', WO Pot.  
11-21-66      TD 4570', WO Pot.  
12-5-66      TD 4570', WO Pot.  
12-12-66      TD 4570', WO Pot.  
12-19-66      TD 4570', WO Pot.  
1-3-67      ID 4570', WO Pot.  
1-16-67      TD 4570', COMPLETE.  
LOU TOPS: Rustler 2140', Bates 2534',  
San Andres 3750', Fl Marker 4200', Slaughter  
"A" 4351'.