

NO. OF COPIES RECEIVED		
DISTRIBUTION		
SANTA FE		
FILE		
U.S.G.S.		
LAND OFFICE		
OPERATOR		

NEW MEXICO OIL CONSERVATION COMMISSION

Form C-103  
Supersedes Old  
C-102 and C-103  
Effective 1-1-65

SEP 28 1 23 PM '66

5a. Indicate Type of Lease State <input checked="" type="checkbox"/> Fee <input type="checkbox"/>	
5. State Oil & Gas Lease No. <b>K-1370</b>	
7. Unit Agreement Name -----	
8. Farm or Lease Name <b>Hobbs "W"</b>	
9. Well No. <b>4</b>	
10. Field and Pool, or Wildcat <b>Chavezco San Andres</b>	
12. County <b>Roosevelt</b>	

SUNDRY NOTICES AND REPORTS ON WELLS

(DO NOT USE THIS FORM FOR PROPOSALS TO DRILL OR TO DEEPEN OR PLUG BACK TO A DIFFERENT RESERVOIR. USE "APPLICATION FOR PERMIT" (FORM C-101) FOR SUCH PROPOSALS.)

1. OIL WELL <input checked="" type="checkbox"/> GAS WELL <input type="checkbox"/> OTHER <input type="checkbox"/>
2. Name of Operator <b>Skelly Oil Company</b>
3. Address of Operator <b>P. O. Box 730 - Hobbs, New Mexico</b>
4. Location of Well UNIT LETTER <b>"T"</b> , <b>1650</b> FEET FROM THE <b>North</b> LINE AND <b>660</b> FEET FROM THE <b>East</b> LINE, SECTION <b>30</b> TOWNSHIP <b>7-S</b> RANGE <b>34-E</b> NMPM.
15. Elevation (Show whether DF, RT, GR, etc.) <b>4319' BP</b>

Check Appropriate Box To Indicate Nature of Notice, Report or Other Data

NOTICE OF INTENTION TO:

SUBSEQUENT REPORT OF:

PERFORM REMEDIAL WORK ☐  
TEMPORARILY ABANDON ☐  
PULL OR ALTER CASING ☐

PLUG AND ABANDON ☐  
CHANGE PLANS ☐

REMEDIAL WORK ☐  
COMMENCE DRILLING OPNS. ☐  
CASING TEST AND CEMENT JOBS ☒

ALTERING CASING ☐  
PLUG AND ABANDONMENT ☐

OTHER ☐

17. Describe Proposed or Completed Operations (Clearly state all pertinent details, and give pertinent dates, including estimated date of starting any proposed work) SEE RULE 1103.

Reached total depth of 4475' on September 21, 1966. Set 138 joints (4457') of new 4-1/2"OD 10.5# 8-R SS J-55 KMG casing at 4468'. Cemented with 350 sacks of cement by the pump and plug process. Plug down 1:30 A.M. September 22, 1966. Temperature survey indicated top of cement outside of 4-1/2"OD casing at 3404', from the surface. WOC 24 hours. Pressured casing up to 600# for 30 minutes and casing tested OK. Did not drill out cement plug at 4433'. FBTD 4433'.

18. I hereby certify that the information above is true and complete to the best of my knowledge and belief.

SIGNED **(ORIGINAL SIGNED) H. E. Amb** TITLE **District Superintendent** DATE **September 28, 1966**

APPROVED BY \_\_\_\_\_ TITLE \_\_\_\_\_ DATE \_\_\_\_\_

CONDITIONS OF APPROVAL, IF ANY:

NO. OF COPIES RECEIVED		
DISTRIBUTION		
SANTA FE		
FILE		
U.S.G.S.		
LAND OFFICE		
OPERATOR		

NEW MEXICO OIL CONSERVATION COMMISSION

SEP 15 10 34 AM '66

Form C-103  
Supersedes Old  
C-102 and C-103  
Effective 1-1-65

5a. Indicate Type of Lease	
State <input checked="" type="checkbox"/>	Fee <input type="checkbox"/>
5. State Oil & Gas Lease No.	
E-1370	
7. Unit Agreement Name	
*****	
8. Farm or Lease Name	
Hobbs "W"	
9. Well No.	
4	
10. Field and Pool, or Wildcat	
Cheveree San Andres	
12. County	
Bernalillo	

SUNDRY NOTICES AND REPORTS ON WELLS

(DO NOT USE THIS FORM FOR PROPOSALS TO DRILL OR TO DEEPEN OR PLUG BACK TO A DIFFERENT RESERVOIR. USE "APPLICATION FOR PERMIT -" (FORM C-101) FOR SUCH PROPOSALS.)

1. OIL WELL <input checked="" type="checkbox"/> GAS WELL <input type="checkbox"/> OTHER <input type="checkbox"/>
2. Name of Operator
Shelly Oil Company
3. Address of Operator
P. O. Box 730 - Hobbs, New Mexico
4. Location of Well
UNIT LETTER <b>H</b> <b>1630</b> FEET FROM THE <b>North</b> LINE AND <b>640</b> FEET FROM THE <b>East</b> LINE, SECTION <b>30</b> TOWNSHIP <b>7-S</b> RANGE <b>34-E</b> NMPM.
15. Elevation (Show whether DF, RT, GR, etc.)
Unknown

Check Appropriate Box To Indicate Nature of Notice, Report or Other Data  
NOTICE OF INTENTION TO:

PERFORM REMEDIAL WORK <input type="checkbox"/>	PLUG AND ABANDON <input type="checkbox"/>
TEMPORARILY ABANDON <input type="checkbox"/>	CHANGE PLANS <input type="checkbox"/>
PULL OR ALTER CASING <input type="checkbox"/>	OTHER <input type="checkbox"/>

SUBSEQUENT REPORT OF:

REMEDIAL WORK <input type="checkbox"/>	ALTERING CASING <input type="checkbox"/>
COMMENCE DRILLING OPNS. <input type="checkbox"/>	PLUG AND ABANDONMENT <input type="checkbox"/>
CASING TEST AND CEMENT JOB <input checked="" type="checkbox"/>	OTHER <input type="checkbox"/>

17. Describe Proposed or Completed Operations (Clearly state all pertinent details, and give pertinent dates, including estimated date of starting any proposed work) SEE RULE 1103.

Well spudded September 12, 1966. Set 11 Jts. (350') of new 2-5/8" OD 24# ST 80 J-55 2-2 EH&S casing at 371'. Cemented with 250 sacks of cement by the pump and plug process. Plug down at 4:30 P.M. September 12, 1966. Cement circulated to the surface. WAS 24 hours. Pressured casing up to 1000# for 30 minutes and casing tested OK. Drilled plug and tested casing up to 600# for 30 minutes and casing shutoff tested OK.

18. I hereby certify that the information above is true and complete to the best of my knowledge and belief.

SIGNED (ORIGINAL SIGNED) H. E. Ash TITLE District Superintendent DATE September 14, 1966  
APPROVED BY \_\_\_\_\_ TITLE \_\_\_\_\_ DATE \_\_\_\_\_  
CONDITIONS OF APPROVAL, IF ANY:

NO. OF COPIES RECEIVED	
DISTRIBUTION	
SANTA FE	
FILE	
U.S.G.S.	
LAND OFFICE	
OPERATOR	

NEW MEXICO OIL CONSERVATION COMMISSION

Form Q-101  
Revised 4-65

SEP 7 2 37

5A. Indicate Type of Lease	<input checked="" type="checkbox"/> P11-66	FEE <input type="checkbox"/>
5. State Oil & Gas Lease No.		
<b>K-1370</b>		

APPLICATION FOR PERMIT TO DRILL, DEEPEN, OR PLUG BACK

1a. Type of Work		7. Unit Agreement Name	
b. Type of Well OIL WELL <input checked="" type="checkbox"/> GAS WELL <input type="checkbox"/> OTHER <input type="checkbox"/>		8. Farm or Lease Name	
2. Name of Operator		9. Well No.	
3. Address of Operator		10. Field and Pool, or Wildcat	
4. Location of Well		12. County	
UNIT LETTER <b>H</b> LOCATED <b>1650</b> FEET FROM THE <b>North</b> LINE		<b>Roosevelt</b>	
AND <b>660</b> FEET FROM THE <b>East</b> LINE OF SEC. <b>30</b> TWP. <b>7-S</b> RGE. <b>34-E</b> NMPM			
19. Proposed Depth		19A. Formation	20. Rotary or C.T.
<b>4500'</b>		<b>San Andres</b>	<b>Rotary</b>
21. Elevations (Show whether DF, RT, etc.)	21A. Kind & Status Plug. Bond	21B. Drilling Contractor	22. Approx. Date Work will start
<b>Unknown</b>	<b>Blanket Bond #1253688</b>	<b>Cactus Drilling Corp.</b>	<b>Immediately</b>
23.			

PROPOSED CASING AND CEMENT PROGRAM

SIZE OF HOLE	SIZE OF CASING	WEIGHT PER FOOT	SETTING DEPTH	SACKS OF CEMENT	EST. TOP
<b>11"</b>	<b>8-5/8"</b>	<b>24#</b>	<b>350'</b>	<b>250</b>	<b>Surface</b>
<b>7-7/8"</b>	<b>4-1/2"</b>	<b>10.5#</b>	<b>4500'</b>	<b>350</b>	<b>3750'</b>

The Pump and Plug Process will be used in cementing both strings of casing and cement will be circulated to the surface on the 8-5/8" casing. The 4-1/2" casing will be perforated and the San Andres Zone treated with approximately 2000 gallons of Regular Acid, 30,000 gallons oil and 30,000# 20/40 sand.

APPROVAL VALID  
FOR 90 DAYS UNLESS  
DRILLING COMMENCED,  
EXPIRES 12-10-66

IN ABOVE SPACE DESCRIBE PROPOSED PROGRAM; IF PROPOSAL IS TO DEEPEN OR PLUG BACK, GIVE DATA ON PRESENT PRODUCTIVE ZONE AND PROPOSED NEW PRODUCTIVE ZONE. GIVE BLOWOUT PREVENTER PROGRAM, IF ANY.

I hereby certify that the information above is true and complete to the best of my knowledge and belief.

Signed J. W. George Title Asst. Dist. Superintendent Date September 8, 1966  
(This space for State Use)

APPROVED BY \_\_\_\_\_ TITLE \_\_\_\_\_ DATE \_\_\_\_\_

CONDITIONS OF APPROVAL, IF ANY:

**NEW MEXICO OIL CONSERVATION COMMISSION  
WELL LOCATION AND ACREAGE DEDICATION PLAT**

Form C-102  
Supersedes C-128  
Effective 1-1-65

All distances must be from the outer boundaries of the Section.  
HOBBS DISTRICT O. C. C.

Operator <b>SKELLY OIL COMPANY</b>			Lease <b>HOBBS "SEP 8 2 37 PM '66"</b>		Well No. <b>4</b>
Unit Letter <b>H</b>	Section <b>30</b>	Township <b>7 SOUTH</b>	Range <b>34 EAST</b>	County <b>ROOSEVELT</b>	
Actual Footage Location of Well: <b>1650</b> feet from the <b>NORTH</b> line and <b>660</b> feet from the <b>EAST</b> line					
Ground Level Elev.	Producing Formation <b>San Andres</b>	Pool <b>Chavero San Andres</b>	Dedicated Acreage: <b>40</b> Acres		

1. Outline the acreage dedicated to the subject well by colored pencil or hachure marks on the plat below.
2. If more than one lease is dedicated to the well, outline each and identify the ownership thereof (both as to working interest and royalty).
3. If more than one lease of different ownership is dedicated to the well, have the interests of all owners been consolidated by communization, unitization, force-pooling, etc?

☐ Yes ☐ No If answer is "yes," type of consolidation \_\_\_\_\_

If answer is "no," list the owners and tract descriptions which have actually been consolidated. (Use reverse side of this form if necessary.) \_\_\_\_\_

No allowable will be assigned to the well until all interests have been consolidated (by communization, unitization, forced-pooling, or otherwise) or until a non-standard unit, eliminating such interests, has been approved by the Commission.

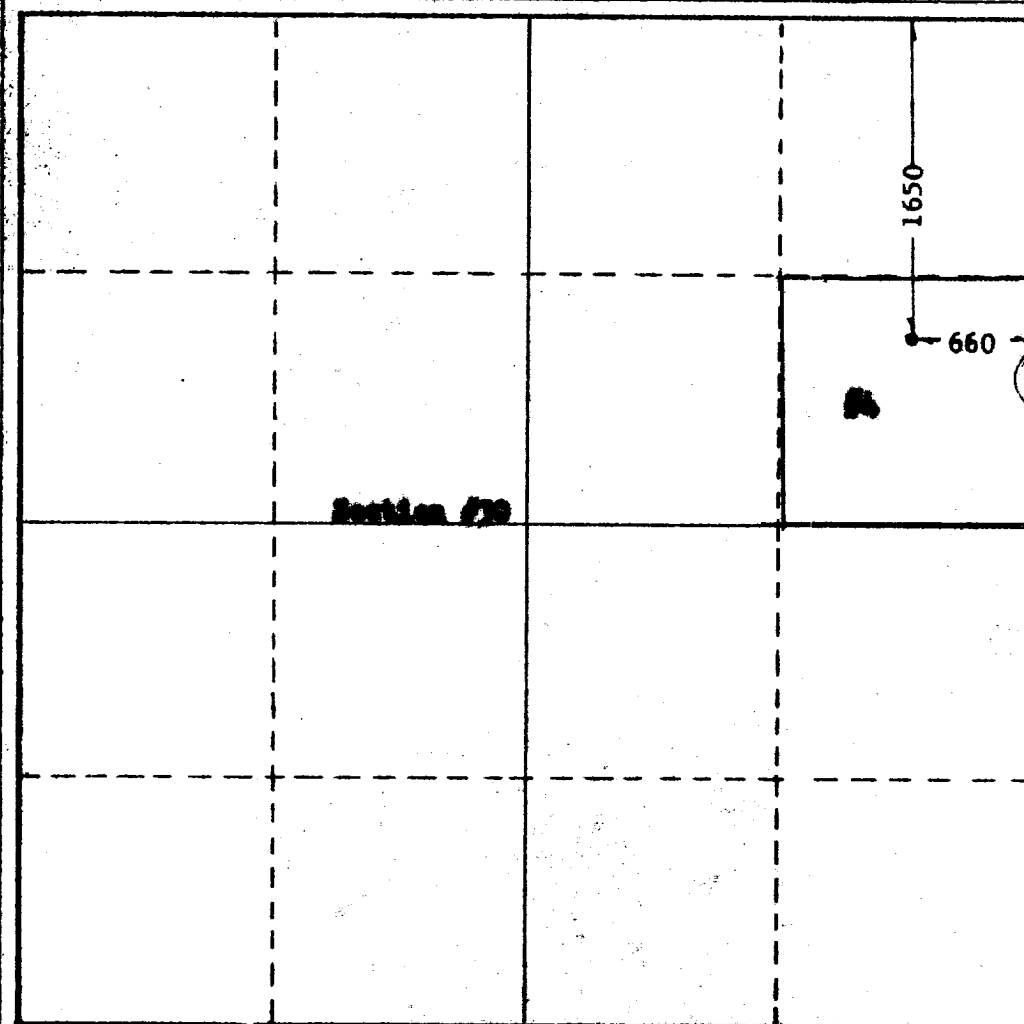

**CERTIFICATION**

I hereby certify that the information contained herein is true and complete to the best of my knowledge and belief.

Name \_\_\_\_\_  
 Position *J.W. George*  
 Company *Asst. District Superintendent*  
 Date *Skelly Oil Company*  
*September 8, 1966*

I hereby certify that the well location shown on this plat was plotted from field notes of actual surveys made by me or under my supervision, and that the same is true and correct to the best of my knowledge and belief.

Date Surveyed  
**9-2-66**

Registered Professional Engineer  
and/or Land Surveyor

*John W. West*

Certificate No.

**676**

