

NO. OF COPIES RECEIVED	
DISTRIBUTION	
SANTA FE	
FILE	
U.S.G.S.	
LAND OFFICE	
OPERATOR	

# NEW MEXICO OIL CONSERVATION COMMISSION

Form C-101  
Revised 1-4-65

SEP 15 3 53 AM '67

5A. Indicate Type of Lease	
STATE <input checked="" type="checkbox"/>	FEE <input type="checkbox"/>
5. State Oil & Gas Lease No.	
K-3995	

## APPLICATION FOR PERMIT TO DRILL, DEEPEN, OR PLUG BACK

1a. Type of Work		7. Unit Agreement Name	
b. Type of Well DRILL <input checked="" type="checkbox"/> DEEPEN <input type="checkbox"/> PLUG BACK <input type="checkbox"/> OIL WELL <input checked="" type="checkbox"/> GAS WELL <input type="checkbox"/> OTHER <input type="checkbox"/> SINGLE ZONE <input checked="" type="checkbox"/> MULTIPLE ZONE <input type="checkbox"/>		8. Farm or Lease Name Anderson State	
2. Name of Operator Taylor Pruitt		9. Well No. 7	
3. Address of Operator c/o Oil Reports & Gas Services, Box 763, Hobbs, New Mexico		10. Field and Pool, or Wildcat Undes. Chaveroo-SA	
4. Location of Well UNIT LETTER C LOCATED 660 FEET FROM THE North LINE AND 1980 FEET FROM THE West LINE OF SEC. 36 TWP. 7 S RGE. 32 E NMPM		12. County Roosevelt	
19. Proposed Depth 4400		19A. Formation San Andres	
20. Rotary or C.T. Rotary			
21. Elevations (Show whether DF, RT, etc.) 4455' 4455' 4455'		21A. Kind & Status Plug, Bond Blanket	
21B. Drilling Contractor Verna Drilling Co		22. Approx. Date Work will start 10/20/67	

23.

## PROPOSED CASING AND CEMENT PROGRAM

SIZE OF HOLE	SIZE OF CASING	WEIGHT PER FOOT	SETTING DEPTH	SACKS OF CEMENT	EST. TOP
12 1/4	8 5/8	20#	325	Circ	
7 7/8	5 1/2	14#	4400	250	3000

THE COMMISSION MUST BE NOTIFIED  
24 HOURS PRIOR TO RUNNING CASING.

APPROVAL VALID  
FOR 90 DAYS UNLESS  
DRILLING COMMENCED.

EXPIRES 12 14 67

IN ABOVE SPACE DESCRIBE PROPOSED PROGRAM: IF PROPOSAL IS TO DEEPEN OR PLUG BACK, GIVE DATA ON PRESENT PRODUCTIVE ZONE AND PROPOSED NEW PRODUCTIVE ZONE. GIVE BLOWOUT PREVENTER PROGRAM, IF ANY.

I hereby certify that the information above is true and complete to the best of my knowledge and belief.

Signed A. L. Smith Title Agent Date 9/15/67  
(This space for State Use)

APPROVED BY 1 TITLE \_\_\_\_\_ DATE \_\_\_\_\_

CONDITIONS OF APPROVAL, IF ANY:

**NEW MEXICO OIL CONSERVATION COMMISSION**  
**WELL LOCATION AND ACREAGE DEDICATION PLAT**

Form C-102  
 Supersedes C-128  
 Effective 1-1-65

All distances must be from the outer boundaries of the Section.

Operator <b>TAYLOR FRUITT</b>			Lease <b>ANDERSON, FRUITT &amp; State</b>		Well No. <b>7</b>
Unit Letter <b>C</b>	Section <b>36</b>	Township <b>7 SOUTH</b>	Range <b>32 EAST</b>	County <b>ROOSEVELT</b>	
Actual Footage Location of Well: <b>660</b> feet from the <b>NORTH</b> line and <b>1980</b> feet from the <b>WEST</b> line					
Ground Level Elev. <del>4471.1</del>	Producing Formation <b>San Andres</b>	Pool <b>Undes. Chaveroo</b>		Dedicated Acreage: <b>40</b> Acres	

1. Outline the acreage dedicated to the subject well by colored pencil or hatchure marks on the plat below.
2. If more than one lease is dedicated to the well, outline each and identify the ownership thereof (both as to working interest and royalty).
3. If more than one lease of different ownership is dedicated to the well, have the interests of all owners been consolidated by communitization, unitization, force-pooling, etc?

☐ Yes ☐ No If answer is "yes," type of consolidation \_\_\_\_\_

If answer is "no," list the owners and tract descriptions which have actually been consolidated. (Use reverse side of this form if necessary.) \_\_\_\_\_

No allowable will be assigned to the well until all interests have been consolidated (by communitization, unitization, forced-pooling, or otherwise) or until a non-standard unit, eliminating such interests, has been approved by the Commission.

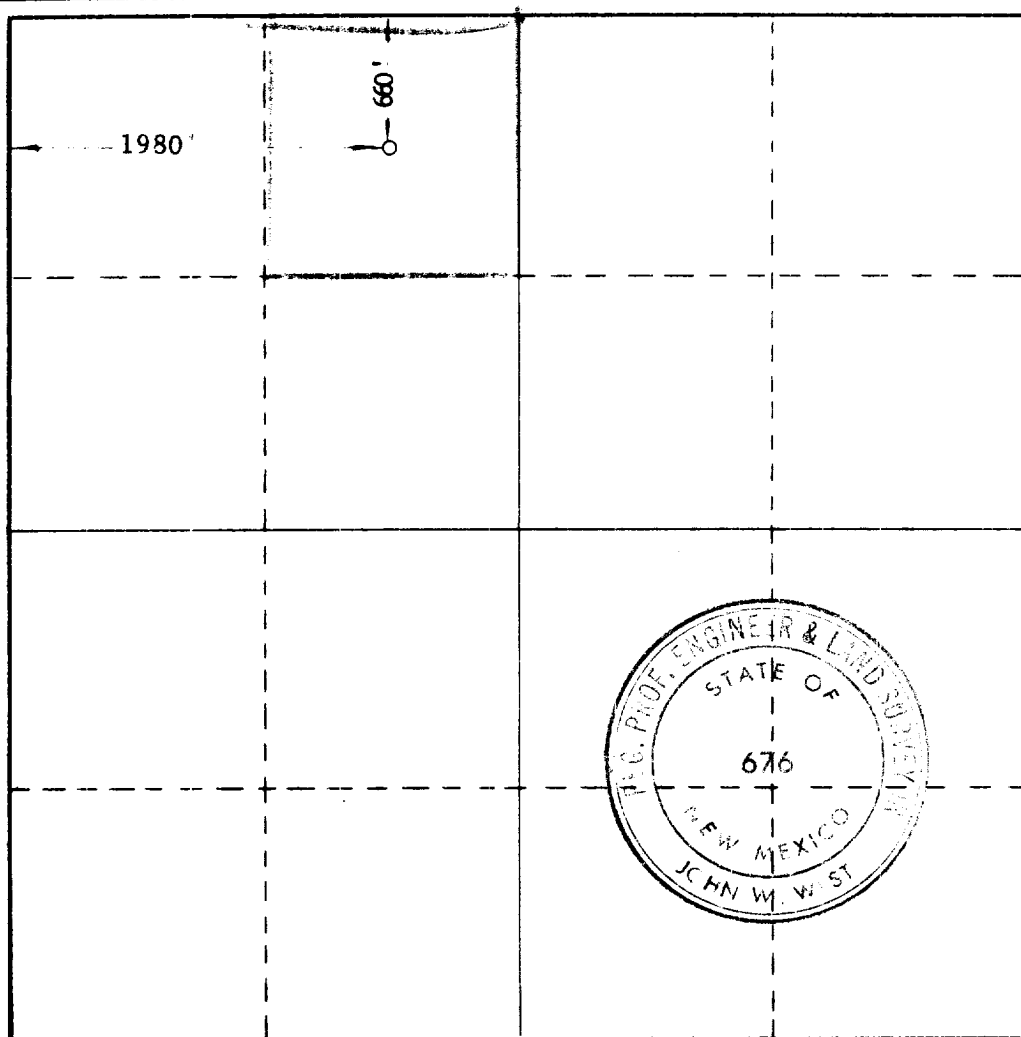

**CERTIFICATION**

I hereby certify that the information contained herein is true and complete to the best of my knowledge and belief.

Name *H. L. Smith*

Position  
**Agent**

Company  
**Taylor Pruitt**

Date  
**9/15/67**

I hereby certify that the well location shown on this plat was plotted from field notes of actual surveys made by me or under my supervision, and that the same is true and correct to the best of my knowledge and belief.

Date Surveyed  
**9/13/67**

Registered Professional Engineer and/or Land Surveyor

*John W. West*

Certificate No. **676**

