

UNITED STATES
DEPARTMENT OF THE INTERIOR
GEOLOGICAL SURVEY

APPLICATION FOR PERMIT TO DRILL, DEEPEN, OR PLUG BACK

1a. TYPE OF WORK DRILL <input checked="" type="checkbox"/> DEEPEN <input type="checkbox"/> PLUG BACK <input type="checkbox"/>		5. LEASE DESIGNATION AND SERIAL NO. NN 0139989		
b. TYPE OF WELL OIL WELL <input checked="" type="checkbox"/> GAS WELL <input type="checkbox"/> OTHER <input type="checkbox"/> SINGLE ZONE <input type="checkbox"/> MULTIPLE ZONE <input type="checkbox"/>		6. IF INDIAN, ALLOTTEE OR TRIBE NAME		
2. NAME OF OPERATOR FRANKLIN, ASTON & FAIR, INC.		7. UNIT AGREEMENT NAME		
3. ADDRESS OF OPERATOR P. O. Box 1090, Roswell, New Mexico 88201		8. FARM OR LEASE NAME Livaudais Federal		
4. LOCATION OF WELL (Report location clearly and in accordance with any State requirements.)* At surface 660' FSL and 660' FEL of Sec. 30, T 7 S, R 36 E. At proposed prod. zone		9. WELL NO. 5		
14. DISTANCE IN MILES AND DIRECTION FROM NEAREST TOWN OR POST OFFICE*		10. FIELD AND POOL, OR WILDCAT Todd Lower San Andres		
15. DISTANCE FROM PROPOSED* LOCATION TO NEAREST PROPERTY OR LEASE LINE, FT. (Also to nearest drlg. unit line, if any)		11. SEC., T., R., M., OR BLK. AND SURVEY OR AREA Sec. 30, T 7 S, R 36 E, N.M.P.M.		
16. NO. OF ACRES IN LEASE 1293.84		12. COUNTY OR PARISH Roosevelt		
17. NO. OF ACRES ASSIGNED TO THIS WELL 80		13. STATE New Mexico		
18. DISTANCE FROM PROPOSED LOCATION* TO NEAREST WELL, DRILLING, COMPLETED, OR APPLIED FOR, ON THIS LEASE, FT.		20. ROTARY OR CABLE TOOLS Rotary		
19. PROPOSED DEPTH 4,325 ft.		22. APPROX. DATE WORK WILL START* Dec. 8, 1967		
21. ELEVATIONS (Show whether DF, RT, GR, etc.) 4,129.1 GR				
23. PROPOSED CASING AND CEMENTING PROGRAM				
SIZE OF HOLE 12 1/4" 7 7/8"	SIZE OF CASING 8 5/8" 5 1/2"	WEIGHT PER FOOT 24# 14#	SETTING DEPTH 275' 4,325'	QUANTITY OF CEMENT 150 sacks, circ surf. 250 sacks

IN ABOVE SPACE DESCRIBE PROPOSED PROGRAM: If proposal is to deepen or plug back, give data on present productive zone and proposed new productive zone. If proposal is to drill or deepen directionally, give pertinent data on subsurface locations and measured and true vertical depths. Give blowout preventer program, if any.

24. SIGNED Erant M. Smith TITLE Geologist DATE December 1, 1967

(This space for Federal or State office use)

PERMIT NO. _____ APPROVAL DATE **APPROVED**

APPROVED BY _____ TITLE _____ DATE **DEC 4 1967**

CONDITIONS OF APPROVAL, IF ANY:

J L GORDON
*See Instructions On Reverse Side ACTING DISTRICT ENGINEER

Instructions

General: This form is designed for submitting proposals to perform certain well operations, as indicated, on all types of lands and leases for appropriate action by either a Federal or a State agency, or both, pursuant to applicable Federal and/or State laws and regulations. Any necessary special instructions concerning the use of this form and the number of copies to be submitted, particularly with regard to local, area, or regional procedures and practices, either are shown below or will be issued by, or may be obtained from, the local Federal and/or State office.

Item 1: If the proposal is to redrill to the same reservoir at a different subsurface location or to a new reservoir, use this form with appropriate notations. Consult applicable State or Federal regulations concerning subsequent work proposals or reports on the well.

Item 4: If there are no applicable State requirements, locations on Federal or Indian land should be described in accordance with Federal requirements. Consult local State or Federal office for specific instructions.

Item 14: Needed only when location of well cannot readily be found by road from the land or lease description. A plat, or plats, separate or on this reverse side, showing the roads to, and the surveyed location of, the well, and any other required information, should be furnished when required by Federal or State agency offices.

Items 16 and 18: If well is to be, or has been directionally drilled, give distances for subsurface location of hole in any present or objective production zone.

Item 22: Consult applicable Federal or State regulations, or appropriate officials, concerning approval of the proposal before operations are started.

NEW MEXICO OIL CONSERVATION COMMISSION
WELL LOCATION AND ACREAGE DEDICATION PLAT

Form C-102
Supersedes C-128
Effective 1-1-65

All distances must be from the outer boundaries of the Section.

Operator FRANKLIN ASTON AND FAIR, Inc.		Lease LIVAUDAIS <i>DEC 5 11 67</i>		Well No. 5
Unit Letter P	Section 30	Township 7 SOUTH	Range 36 EAST	County ROOSEVELT
Actual Portage Location of Well: 660 feet from the SOUTH line and 660 feet from the EAST line				
Ground Level Elev. 4129.1	Producing Formation San Andres (Slaughter B)		Pool Todd Lower San Andres	Dedicated Acreage: 80 Acres

1. Outline the acreage dedicated to the subject well by colored pencil or hachure marks on the plat below.
2. If more than one lease is dedicated to the well, outline each and identify the ownership thereof (both as to working interest and royalty).
3. If more than one lease of different ownership is dedicated to the well, have the interests of all owners been consolidated by communitization, unitization, force-pooling, etc?

☐ Yes ☐ No If answer is "yes," type of consolidation _____

If answer is "no," list the owners and tract descriptions which have actually been consolidated. (Use reverse side of this form if necessary.) _____

No allowable will be assigned to the well until all interests have been consolidated (by communitization, unitization, forced-pooling, or otherwise) or until a non-standard unit, eliminating such interests, has been approved by the Commission.

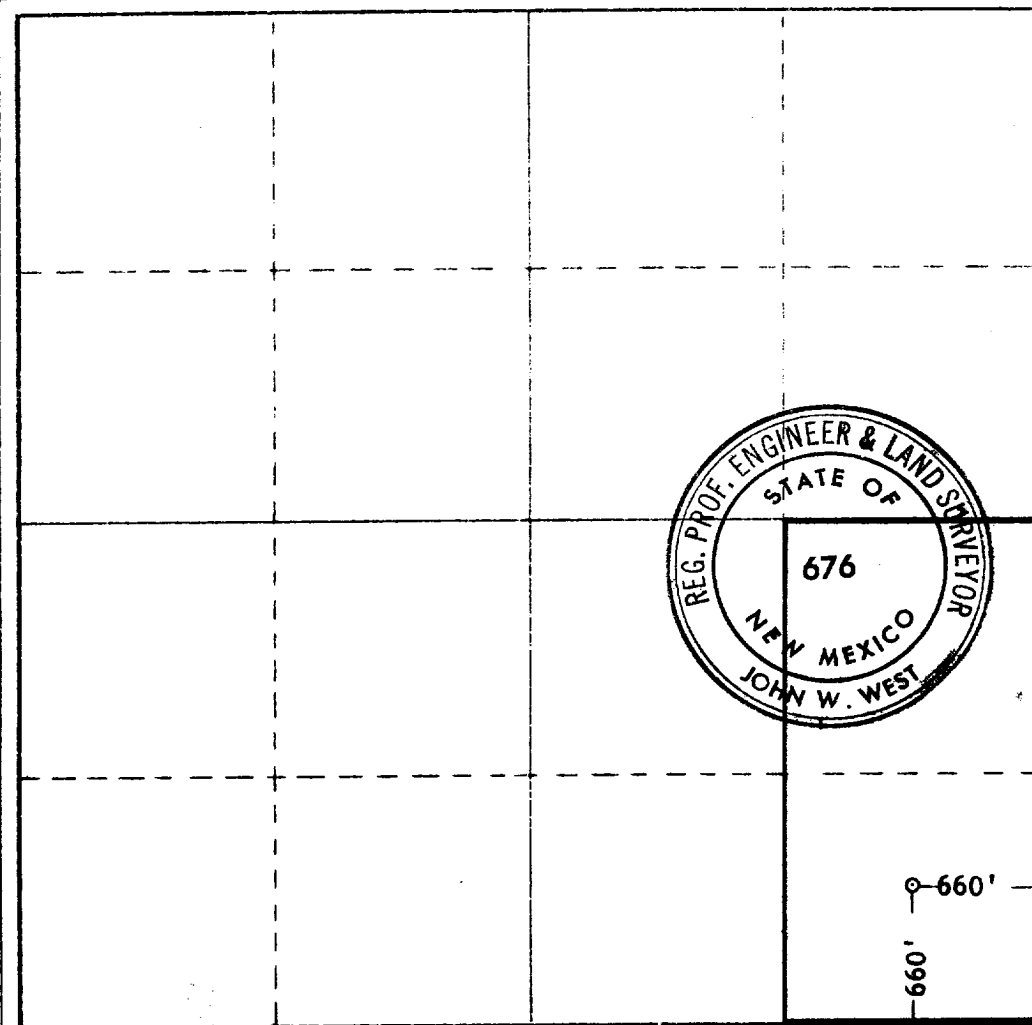

CERTIFICATION

I hereby certify that the information contained herein is true and complete to the best of my knowledge and belief.

Name *Grant M. Smith*
Position
Geologist
Company
Franklin, Aston & Fair, Inc.
Date
December 1, 1967

I hereby certify that the well location shown on this plat was plotted from field notes of actual surveys made by me or under my supervision, and that the same is true and correct to the best of my knowledge and belief.

Date Surveyed
11-28-1967
Registered Professional Engineer and/or Land Surveyor

John W. West
Certificate No. **676**