

Cactus Drilling Corporation

Box 32

HUBBS OFFICE O.C.C.  
Midland, Texas 79701

Henderson

1

May 31 2 57 PM '68  
Undersigned

1980' FNL 660' FEL Sec. 10 Township 7south, R nge 35 east

Depth	Angle	Declination (degrees)	Logarithm	Logarithm
367	0.44	1.1648	1.1648	
860	0.87	4.2891	5.9039	
1340	0.87	4.1760	10.0799	
1867	1.31	6.9037	16.9836	
2050	1.31	2.1353	19.1189	
2500	1.75	8.2250	27.3439	
2958	1.31	5.9998	33.3437	
3332	1.75	6.5450	39.8887	
3608	2.18	6.0168	45.9055	
3943	2.18	7.3030	53.2085	
4220	1.75	4.8475	58.0560	
4385	1.31	2.1615	60.2175	

Cactus Drilling Corporation

*Geo. W. Baker*  
Vice Pres.

George Baker

*Geo. W. Baker*

27

January

*Argene L. Brown*

NO. OF COPIES RECEIVED	
DISTRIBUTION	
SANTA FE	
FILE	
U.S.G.S.	
LAND OFFICE	
OPERATOR	

# NEW MEXICO OIL CONSERVATION COMMISSION

Form C-103  
Supersedes Old  
C-102 and C-103  
Effective 1-1-65

5a. Indicate Type of Lease	
State <input type="checkbox"/>	Fee <input checked="" type="checkbox"/>
5. State Oil & Gas Lease No.	
7. Unit Agreement Name	
8. Farm or Lease Name	
Henderson	
9. Well No.	
1	
10. Field and Pool, or Wildcat	
Wildcat	
12. County	
Roosevelt	

## SUNDRY NOTICES AND REPORTS ON WELLS

(DO NOT USE THIS FORM FOR PROPOSALS TO DRILL OR TO DEEPEN OR PLUG BACK TO A DIFFERENT RESERVOIR. USE "APPLICATION FOR PERMIT -" (FORM C-101) FOR SUCH PROPOSALS.)

1. OIL <input type="checkbox"/> GAS <input type="checkbox"/> OTHER <input type="checkbox"/>
2. Name of Operator
Cactus Drilling Corporation Of Texas
3. Address of Operator
P.O. BOX 2068 Hobbs, New Mexico
4. Location of Well
UNIT LETTER <u>I</u> 1980 FEET FROM THE <u>8</u> LINE AND <u>660</u> FEET FROM
THE <u>E</u> LINE, SECTION <u>10</u> TOWNSHIP <u>7</u> south RANGE <u>35</u> east NMPM.
15. Elevation (Show whether DF, RT, GR, etc.)

16. Check Appropriate Box To Indicate Nature of Notice, Report or Other Data	
NOTICE OF INTENTION TO:	SUBSEQUENT REPORT OF:
PERFORM REMEDIAL WORK <input type="checkbox"/>	REMEDIAL WORK <input type="checkbox"/>
TEMPORARILY ABANDON <input type="checkbox"/>	COMMENCE DRILLING OPNS. <input type="checkbox"/>
PULL OR ALTER CASING <input type="checkbox"/>	CASING TEST AND CEMENT JOB <input checked="" type="checkbox"/>
OTHER <input type="checkbox"/>	OTHER <input type="checkbox"/>

17. Describe Proposed or Completed Operations (Clearly state all pertinent details, and give pertinent dates, including estimated date of starting any proposed work) SEE RULE 1103.

1/19/68

Drilled 7 7/8" hole to 4392. Set 139 joints of 4 1/2, 10.50 pound casing. Cemented with 200 sacks of Incor 8% salt. W.O.C. 24 hours, tested casing at 1000 pounds P.S.I. for 30 minutes, no drop in pressure. Proceeding with completion.

18. I hereby certify that the information above is true and complete to the best of my knowledge and belief.

SIGNED [Signature] TITLE Geologist DATE January 26, 1968

APPROVED BY [Signature] TITLE  DATE

CONDITIONS OF APPROVAL IF ANY:

NO. OF COPIES RECEIVED	
DISTRIBUTION	
SANTA FE	
FILE	
U.S.G.S.	
LAND OFFICE	
OPERATOR	

# NEW MEXICO OIL CONSERVATION COMMISSION

Form C-103  
Supersedes Old  
C-102 and C-103  
Effective 1-1-65

5a. Indicate Type of Lease	
State <input type="checkbox"/>	Fee <input checked="" type="checkbox"/>
5. State Oil & Gas Lease No.	

## SUNDRY NOTICES AND REPORTS ON WELLS (DO NOT USE THIS FORM FOR PROPOSALS TO DRILL OR TO DEEPEN OR PLUG BACK TO A DIFFERENT RESERVOIR. USE "APPLICATION FOR PERMIT --" (FORM C-101) FOR SUCH PROPOSALS.)

1. <input type="checkbox"/> OIL WELL <input type="checkbox"/> GAS WELL <input type="checkbox"/> OTHER-		7. Unit Agreement Name
2. Name of Operator <b>Cactus Drilling Corporation Of Texas</b>		8. Farm or Lease Name <b>Henderson</b>
3. Address of Operator <b>P.O. BOX 2068 Hobbs, New Mexico</b>		9. Well No. <b>1</b>
4. Location of Well UNIT LETTER <b>R</b> <b>1980</b> FEET FROM THE <b>8</b> LINE AND <b>660</b> FEET FROM THE <b>E</b> LINE, SECTION <b>10</b> TOWNSHIP <b>7 south</b> RANGE <b>35 east</b> NMPM.		10. Field and Pool, or Wildcat <b>Wildcat</b>
15. Elevation (Show whether DF, RT, GR, etc.)		12. County <b>Roosevelt</b>

### 16. Check Appropriate Box To Indicate Nature of Notice, Report or Other Data NOTICE OF INTENTION TO: SUBSEQUENT REPORT OF:

PERFORM REMEDIAL WORK <input type="checkbox"/>	PLUG AND ABANDON <input type="checkbox"/>	REMEDIAL WORK <input type="checkbox"/>	ALTERING CASING <input type="checkbox"/>
TEMPORARILY ABANDON <input type="checkbox"/>	CHANGE PLANS <input type="checkbox"/>	COMMENCE DRILLING OPNS. <input type="checkbox"/>	PLUG AND ABANDONMENT <input type="checkbox"/>
PULL OR ALTER CASING <input type="checkbox"/>	OTHER <input type="checkbox"/>	CASING TEST AND CEMENT JOB <input checked="" type="checkbox"/>	OTHER <input type="checkbox"/>

17. Describe Proposed or Completed Operations (Clearly state all pertinent details, and give pertinent dates, including estimated date of starting any proposed work) SEE RULE 1103.

1/10/68 Spud at 10:30am, drilled 11" hole to 367 feet. Ran 8 5/8 O.D. 20 pound, limited service casing. Set at 367 feet. Cemented with 100 sacks of Incor, 4% gel, + 100 sacks neet 2% C.C., cemented and circulated to surface. W.O.C. -18 hours, nipples up to 8 5/8 and tested 8 5/8 casing. 1000 pound P.S.I. for 30 minutes, no decrease in pressure- drilling ahead.

18. I hereby certify that the information above is true and complete to the best of my knowledge and belief.

SIGNED Jim L. Mang TITLE Geologist DATE January 26, 1968

APPROVED BY [Signature] DATE 1  
CONDITIONS OF APPROVAL, IF ANY: ORIGINAL FILED BY: ENGINEER DISTRICT

NO. OF COPIES RECEIVED	
DISTRIBUTION	
SANTA FE	
FILE	
U.S.G.S.	
LAND OFFICE	
OPERATOR	

# NEW MEXICO OIL CONSERVATION COMMISSION

Form C-101  
Revised 1-1-65

5A. Indicate Type of Lease	
STATE <input type="checkbox"/>	FEE <input checked="" type="checkbox"/>
5. State Oil & Gas Lease No.	

## APPLICATION FOR PERMIT TO DRILL, DEEPEN, OR PLUG BACK

1a. Type of Work		7. Unit Agreement Name	
b. Type of Well DRILL <input checked="" type="checkbox"/> DEEPEN <input type="checkbox"/> PLUG BACK <input type="checkbox"/> OIL WELL <input checked="" type="checkbox"/> GAS WELL <input type="checkbox"/> OTHER <input type="checkbox"/> SINGLE ZONE <input type="checkbox"/> MULTIPLE ZONE <input type="checkbox"/>		8. Farm or Lease Name <b>Henderson</b>	
2. Name of Operator <b>Cactus Drilling Corporation of Texas</b>		9. Well No. <b>1</b>	
3. Address of Operator <b>Drawer 2068, Hobbs, New Mexico</b>		10. Field and Pool, or Wildcat <b>Wildcat</b>	
4. Location of Well UNIT LETTER <b>H</b> LOCATED <b>1980</b> FEET FROM THE <b>North</b> LINE AND <b>660</b> FEET FROM THE <b>East</b> LINE OF SEC. <b>10</b> TWP. <b>7S</b> RGE. <b>35E</b> NMPM		12. County <b>Roosevelt</b>	
19. Proposed Depth <b>4350</b>		19A. Formation <b>San Andres</b>	
20. Rotary or C.T. <b>Rotary</b>		21. Elevations (Show whether DF, RT, etc.) <b>To Be furnished</b>	
21A. Kind & Status Plug. Bond <b>On file</b>		21B. Drilling Contractor <b>Cactus Drilling Co.</b>	
22. Approx. Date Work will start <b>On approval</b>			

23.

## PROPOSED CASING AND CEMENT PROGRAM

SIZE OF HOLE	SIZE OF CASING	WEIGHT PER FOOT	SETTING DEPTH	SACKS OF CEMENT	EST. TOP
11"	8-5/8	20#	350	200 sx	(circulated)
7-7/8"	4-1/2	9.50	T D	125 sx	

It is proposed to drill the well to approximate depth of 4350' to test the San Andres Formation, and, if oil string is run, to perforate into the indicated productive zone, treat, and complete as a commercial producer.

THE COMMISSION MUST BE NOTIFIED  
24 HOURS BEFORE COMMENCING  
CASING.

RECEIVED  
OCT 11 1967  
COMMENCED

EXPIRES 3-25-68

IN ABOVE SPACE DESCRIBE PROPOSED PROGRAM: IF PROPOSAL IS TO DEEPEN OR PLUG BACK, GIVE DATA ON PRESENT PRODUCTIVE ZONE AND PROPOSED NEW PRODUCTIVE ZONE. GIVE BLOWOUT PREVENTER PROGRAM, IF ANY.

I hereby certify that the information above is true and complete to the best of my knowledge and belief.

Signed Jim L. [Signature] Title Geologist Date 12/26/67  
(This space for State Use)

APPROVED BY [Signature] DATE 12/26/67  
CONDITIONS OF APPROVAL, IF ANY:

NEW MEXICO OIL CONSERVATION COMMISSION  
WELL LOCATION AND ACREAGE DEDICATION PLAT

Form C-102  
Supersedes C-128  
Effective 1-1-65

All distances must be from the outer boundaries of the Section.

Operator <b>CACTUS DRILLING CORP. of Texas</b>			Lease <b>HENDERSON # 1237</b>		Well No. <b>1</b>
Unit Letter <b>H</b>	Section <b>10</b>	Township <b>7 SOUTH</b>	Range <b>35 EAST</b>	County <b>ROOSEVELT</b>	
Actual Footage Location of Well: <b>1980</b> feet from the <b>NORTH</b> line and <b>660</b> feet from the <b>EAST</b> line					
Ground Level Elev. <b>4218.8</b>	Producing Formation <b>San Andres</b>		Pool <b>Wildcat</b>	Dedicated acreage: <b>40</b> Acres	

- Outline the acreage dedicated to the subject well by colored pencil or hatchure marks on the plat below.
- If more than one lease is dedicated to the well, outline each and identify the ownership thereof (both as to working interest and royalty).
- If more than one lease of different ownership is dedicated to the well, have the interests of all owners been consolidated by communitization, unitization, force-pooling, etc?

☐ Yes ☐ No If answer is "yes," type of consolidation \_\_\_\_\_

If answer is "no," list the owners and tract descriptions which have actually been consolidated. (Use reverse side of this form if necessary.) \_\_\_\_\_

No allowable will be assigned to the well until all interests have been consolidated (by communitization, unitization, forced-pooling, or otherwise) or until a non-standard unit, eliminating such interests, has been approved by the Commission.

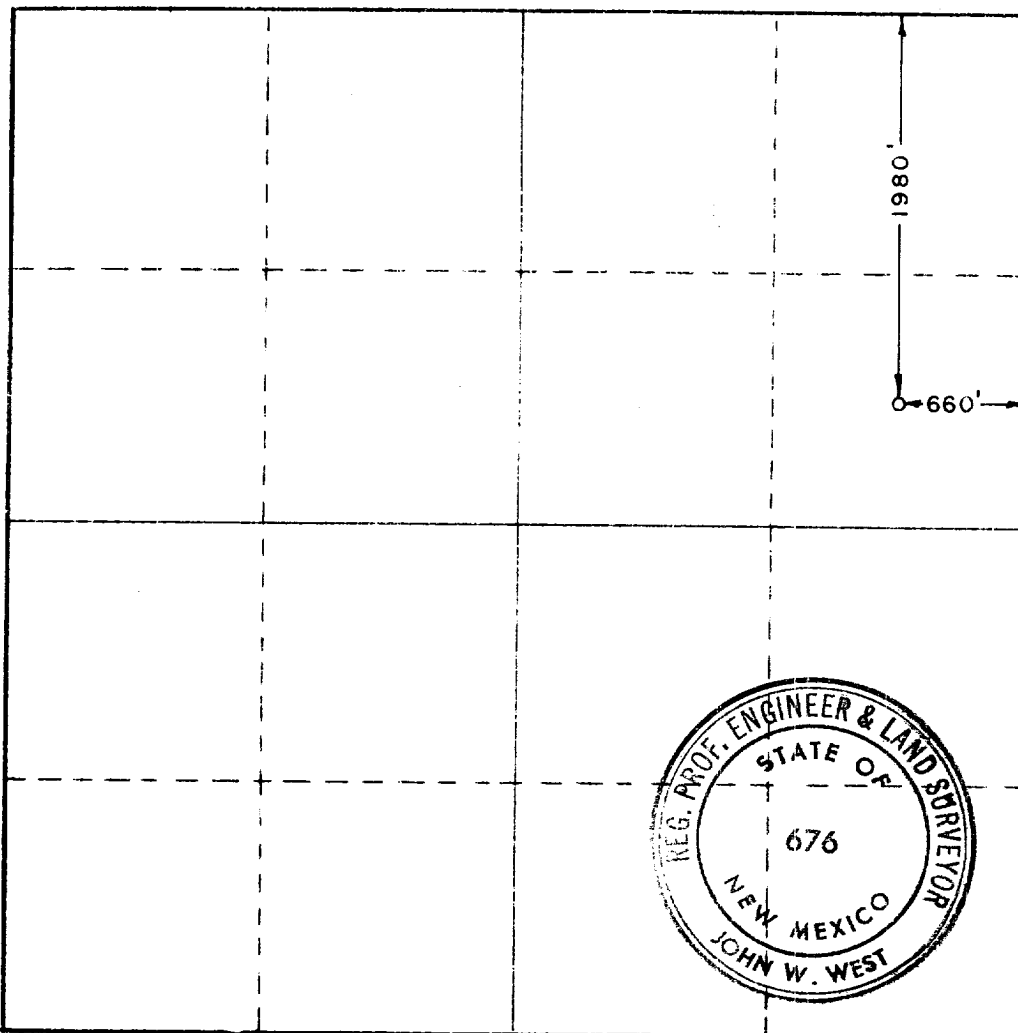

CERTIFICATION

I hereby certify that the information contained herein is true and complete to the best of my knowledge and belief.

Name *Geo. W. Baker*  
Position **Vice President**  
Company **Cactus Drig. Corp. of Texas**  
Date **12/18/67**

I hereby certify that the well location shown on this plat was plotted from field notes of actual surveys made by me or under my supervision, and that the same is true and correct to the best of my knowledge and belief.

Date Surveyed  
**DECEMBER 12, 1967**  
Registered Professional Engineer and/or Land Surveyor

*John W. West*  
Certificate No. **676**

