

NO. OF COPIES RECEIVED	
DISTRIBUTION	
SANTA FE	
FILE	
U.S.G.S.	
LAND OFFICE	
OPERATOR	

NEW MEXICO OIL CONSERVATION COMMISSION

Form C-101
Revised 1-1-65

OCT 2 10 15 AM '68

5A. Indicate Type of Lease	
STATE <input type="checkbox"/>	FEE <input checked="" type="checkbox"/>
5. State Oil & Gas Lease No.	

APPLICATION FOR PERMIT TO DRILL, DEEPEN, OR PLUG BACK

1a. Type of Work			7. Unit Agreement Name		
b. Type of Well DRILL <input checked="" type="checkbox"/> DEEPEN <input type="checkbox"/> PLUG BACK <input type="checkbox"/> OIL WELL <input checked="" type="checkbox"/> GAS WELL <input type="checkbox"/> OTHER <input type="checkbox"/> SINGLE ZONE <input checked="" type="checkbox"/> MULTIPLE ZONE <input type="checkbox"/>			8. Farm or Lease Name Tucker-Hall		
2. Name of Operator Taylor Pruitt			9. Well No. 1		
3. Address of Operator c/o Oil Reports & Gas Services, Box 763, Hobbs, New Mexico			10. Field and Pool, or Wildcat Under Chavero-SA		
4. Location of Well UNIT LETTER 0 LOCATED 660 FEET FROM THE South LINE 1980 FEET FROM THE East LINE OF SEC. 25 TWP. 7 S RGE. 32 E NMPM			12. County Roosevelt		
13. Proposed Depth 4500			19A. Formation San Andres		20. Rotary or C.T. Rotary
21. Elevations (Show whether DF, RT, etc.) 4444.7 GR	21A. Kind & Status Plug. Bond Blanket	21B. Drilling Contractor Verna Drilling Company	22. Approx. Date Work will start 10/2/68		

23. PROPOSED CASING AND CEMENT PROGRAM

SIZE OF HOLE	SIZE OF CASING	WEIGHT PER FOOT	SETTING DEPTH	SACKS OF CEMENT	EST. TOP
12 1/4	8 5/8	204	325	225	circ.
7 7/8	5 1/2	144	4500	250	3000

APPROVAL VALID
FOR 90 DAYS UNLESS
DRILLING COMMENCED.

8 5/8

1-2-69

IN ABOVE SPACE DESCRIBE PROPOSED PROGRAM: IF PROPOSAL IS TO DEEPEN OR PLUG BACK, GIVE DATA ON PRESENT PRODUCTIVE ZONE AND PROPOSED NEW PRODUCTIVE ZONE, GIVE BLOWOUT PREVENTER PROGRAM, IF ANY.

I hereby certify that the information above is true and complete to the best of my knowledge and belief.

Signed *H. L. Smith* Title Agent Date 10/1/68

(This space for State Use)

APPROVED BY *Joe J. Hines* TITLE DATE 10/2 1968

CONDITIONS OF APPROVAL, IF ANY:

**NEW MEXICO OIL CONSERVATION COMMISSION
WELL LOCATION AND ACREAGE DEDICATION PLAT**

Form C-102
Supersedes C-128
Effective 1-1-65

All distances must be from the outer boundaries of the Section

Operator TAYLOR PRUITT, INC.			Lease TUCKER-HALL		Well No. 1
Section Letter O	Section 25	Township 7 SOUTH	Range 32 EAST	County ROOSEVELT	
Actual Footage Location of Well:					
660 feet from the SOUTH line and		1980 feet from the EAST line			
Ground Level Elev. 4444.7	Producing Formation San Andres		Pool Undec. Chaveroo	Dedicated Acreage: 40 Acres	

1. Outline the acreage dedicated to the subject well by colored pencil or hatchure marks on the plat below.
2. If more than one lease is dedicated to the well, outline each and identify the ownership thereof (both as to working interest and royalty).
3. If more than one lease of different ownership is dedicated to the well, have the interests of all owners been consolidated by communitization, unitization, force-pooling, etc?

☐ Yes ☐ No If answer is "yes," type of consolidation _____

If answer is "no," list the owners and tract descriptions which have actually been consolidated. (Use reverse side of this form if necessary.) _____

No allowable will be assigned to the well until all interests have been consolidated (by communitization, unitization, forced-pooling, or otherwise) or until a non-standard unit, eliminating such interests, has been approved by the Commission.

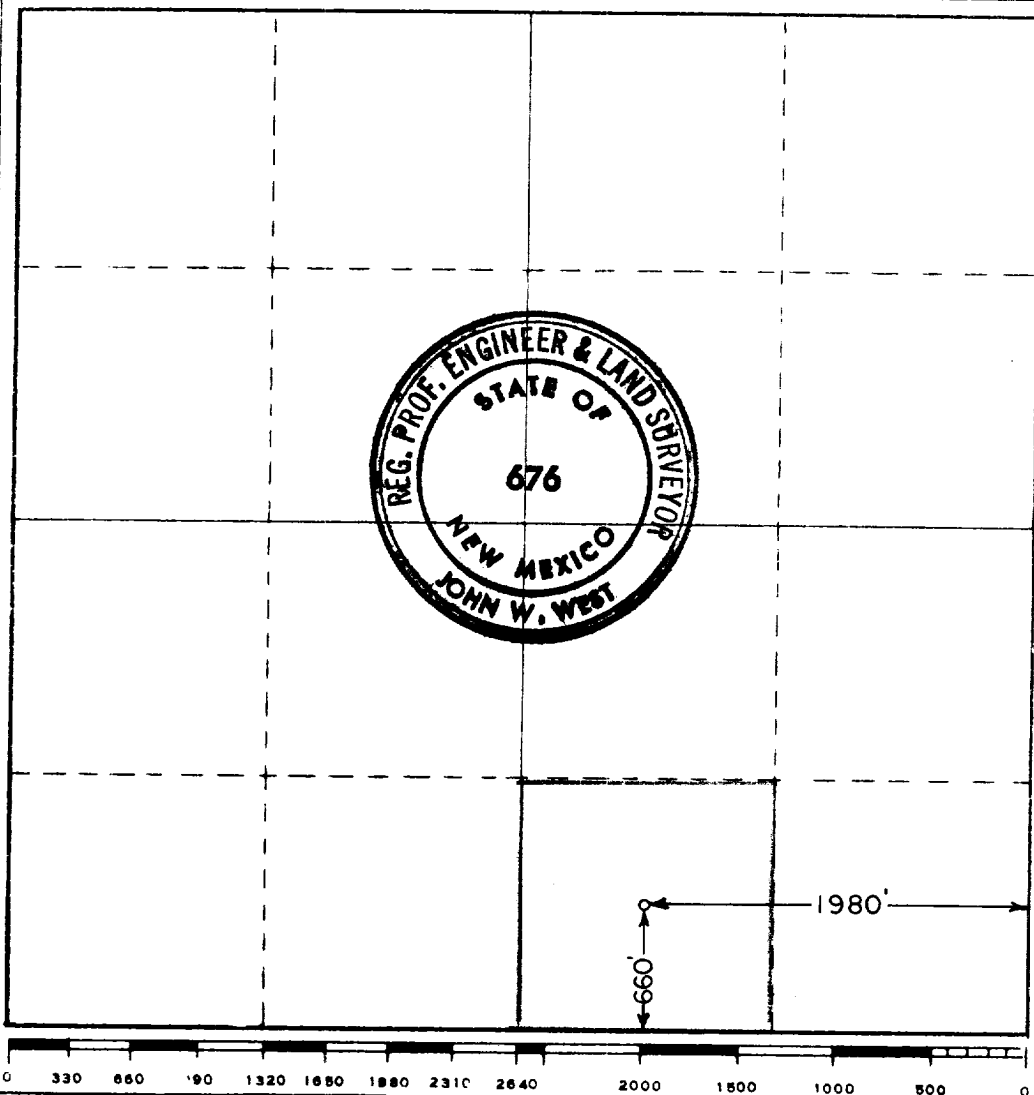

CERTIFICATION

I hereby certify that the information contained herein is true and complete to the best of my knowledge and belief.

Name A. L. Smith
 Position Agent
 Company Taylor Pruitt
 Date 10/1/68

I hereby certify that the well location shown on this plat was plotted from field notes of actual surveys made by me or under my supervision, and that the same is true and correct to the best of my knowledge and belief.

Date Surveyed SEPTEMBER 20, 1968
 Registered Professional Engineer and/or Land Surveyor
John W. West
 Certificate No. 676