

District I  
PO Box 1980, Hobbs, NM 88241-1980  
District II  
811 South First, Artesia, NM 88210  
District III  
1000 Rio Brazos Rd., Aztec, NM 87410  
District IV  
2040 South Pacheco, Santa Fe, NM 87505

State of New Mexico  
Energy, Minerals & Natural Resources Department

**OIL CONSERVATION DIVISION**  
2040 South Pacheco  
Santa Fe, NM 87505

Form C-102  
Revised October 18, 1994  
Instruction on back  
Submit to Appropriate District Office  
State Lease - 4 Copies  
Fee Lease - 3 Copies

☐ AMENDED REPORT

**WELL LOCATION AND ACREAGE DEDICATION PLAT**

<sup>1</sup> API Number 30-041-20161		<sup>2</sup> Pool Code 06880		<sup>3</sup> Pool Name Bluitt San Andres Assoc	
<sup>4</sup> Property Code 025450		<sup>5</sup> Property Name Bluitt SA 18 Federal			<sup>6</sup> Well Number 12
<sup>7</sup> OGRID No. 148967		<sup>8</sup> Operator Name Saga Petroleum LLC			<sup>9</sup> Elevation

**<sup>10</sup> Surface Location**

UL or lot no.	Section	Township	Range	Lot Idn	Feet from the	North/South line	Feet from the	East/West line	County
L	18	8S	38E		1980	S	660	W	ROOSEVELT

**<sup>11</sup> Bottom Hole Location If Different From Surface**

UL or lot no.	Section	Township	Range	Lot Idn	Feet from the	North/South line	Feet from the	East/West line	County

<sup>12</sup> Dedicated Acres 40*	<sup>13</sup> Joint or Infill	<sup>14</sup> Consolidation Code	<sup>15</sup> Order No.
--------------------------------------	-------------------------------	----------------------------------	-------------------------

\*Share allowable w/NS 240 acre proration unit  
NO ALLOWABLE WILL BE ASSIGNED TO THIS COMPLETION UNTIL ALL INTERESTS HAVE BEEN CONSOLIDATED OR A  
NON-STANDARD UNIT HAS BEEN APPROVED BY THE DIVISION

	<p><b><sup>17</sup> OPERATOR CERTIFICATION</b></p> <p>I hereby certify that the information contained herein is true and complete to the best of my knowledge and belief</p> <p><i>Bonnie Husband</i> _____ Signature</p> <p>Printed Name <b>BONNIE HUSBAND</b></p> <p>Title <b>PRODUCTION ANALYST</b></p> <p>Date <b>09/21/2000</b></p>
	<p><b><sup>18</sup> SURVEYOR CERTIFICATION</b></p> <p>I hereby certify that the well location shown on this plat was plotted from field notes of actual surveys made by me or under</p> <p>_____ Date of Survey</p> <p>_____ Signature and Seal of Professional Surveyor</p>
	<p>_____ Certificate Number</p>

District I  
PO Box 1980, Hobbs, NM 88241-1980  
District II  
811 South First, Artesia, NM 88210  
District III  
1000 Rio Brazos Rd., Aztec, NM 87410  
District IV  
2040 South Pacheco, Santa Fe, NM 87505

State of New Mexico  
Energy, Minerals & Natural Resources Department

OIL CONSERVATION DIVISION  
2040 South Pacheco  
Santa Fe, NM 87505

Form C-102  
Revised October 18, 1994  
Instruction on back  
Submit to Appropriate District Office  
State Lease - 4 Copies  
Fee Lease - 3 Copies

☐ AMENDED REPORT

WELL LOCATION AND ACREAGE DEDICATION PLAT

<sup>1</sup> API Number 30-041-20161		<sup>2</sup> Pool Code 06880		<sup>3</sup> Pool Name Bluitt San Andres Assoc	
<sup>4</sup> Property Code 025450		<sup>5</sup> Property Name Bluitt SA 18 Federal			<sup>6</sup> Well Number 12
<sup>7</sup> OGRID No. 148967		<sup>8</sup> Operator Name Saga Petroleum LLC			<sup>9</sup> Elevation

<sup>10</sup> Surface Location

UL or lot no. L	Section 18	Township 8S	Range 38E	Lot Idn	Feet from the 1980	North/South line S	Feet from the 660	East/West line W	County ROOSEVELT
--------------------	---------------	----------------	--------------	---------	-----------------------	-----------------------	----------------------	---------------------	---------------------

<sup>11</sup> Bottom Hole Location If Different From Surface

UL or lot no.	Section	Township	Range	Lot Idn	Feet from the	North/South line	Feet from the	East/West line	County
<sup>12</sup> Dedicated Acres 240		<sup>13</sup> Joint or Infill		<sup>14</sup> Consolidation Code		<sup>15</sup> Order No. NSL-4576<SD>			

\*Share allowable w/NS 240 acre proration Unit  
NO ALLOWABLE WILL BE ASSIGNED TO THIS COMPLETION UNTIL ALL INTERESTS HAVE BEEN CONSOLIDATED OR A  
NON-STANDARD UNIT HAS BEEN APPROVED BY THE DIVISION

<p>16</p> <p>#5 Q</p> <p>#12 660'</p> <p>1980'</p> <p>1980'</p> <p>#14 660'</p>				<p><sup>17</sup> OPERATOR CERTIFICATION</p> <p>I hereby certify that the information contained herein is true and complete to the best of my knowledge and belief</p> <p><i>Bonnie Husband</i></p> <p>Signature</p> <p>Printed Name BONNIE HUSBAND</p> <p>Title PRODUCTION ANALYST</p> <p>Date 09/21/2000</p>	
				<p><sup>18</sup> SURVEYOR CERTIFICATION</p> <p>I hereby certify that the well location shown on this plot was plotted from field notes of actual surveys made by me or under</p>	
				<p>Date of Survey</p> <p>Signature and Seal of Professional Surveyor</p>	
				<p>Certificate Number</p>	

49

COUNTY ROOSEVELT FIELD Bluitt, E. STATE NM 30-41-20161  
OPR FRANKLIN, ASTON & FAIR, INC. MAP

1 Shaw-Federa  
Sec 18, T-8-S R-38-E CO-ORD

1980' FSL, 660' FWL of Sec.  
Spd 12-2-68

Cmp 12-12-68 CLASS [REDACTED]

CSG & SX - TUBING	FORMATION		DATUM	
	FORMATION	DATUM	FORMATION	DATUM
8 5/8" at 295' w/175 sx				
5 1/2" at 4740' w/275 sx				
LOGS EL GR RA IND HC A				
	TD 4740'			

IP (San Andres) Perf 4688-4704' F 156 BOPD. Pot based on 24 hr test thru 16/64" chk, TP 200#

Distribution limited and publication prohibited by subscribers' agreement.  
Reproduction rights reserved by Williams & Lee Scouting Service, Inc.

CONT  
DATE PROP DEPTH 4700' TYPE

F.R. 11-21-68  
PD 4700' - San Andres  
11-28-68 AMEND TO ADD REFERENCE NO.  
12-19-68 AMEND FIELD NAME, Formerly reported as Undesignated.  
12-4-68 Drlg. 2729'  
12-11-68 Drlg. 4350'  
12-16-68 TD 4740'; COMPLETE  
Perf @ 4688', 4690', 4692', 4693', 4696', 4697',  
4700', 4702', 4704' w/1 SPI  
Acid (4688-4704') 3000 gals  
LOG TOP: San Andres 3875'  
12-19-68 COMPLETION REPORTED

**AMENDED**

NEW MEXICO OIL CONSERVATION COMMISSION  
WELL LOCATION AND ACREAGE DEDICATION PLAT

Form C-102  
Supersedes C-128  
Effective 1-1-65

All distances must be from the outer boundaries of the Section.

Operator <b>FRANKLIN, ASTON &amp; FAIR, INC.</b>			Lease <b>Shaw-Federal</b>		Well No. <b>1</b>
Unit Letter <b>L</b>	Section <b>18</b>	Township <b>8 South</b>	Range <b>38 East</b>	County <b>Roosevelt</b>	
Actual Footage Location of Well: <b>1980</b> feet from the <b>South</b> line and <b>660</b> feet from the <b>West</b> line					
Ground Level Elev. <b>3984.7'</b>	Producing Formation <b>San Andres (Slaughter #)</b>		Pool <b>East Bluit-San Andres</b>		Dedicated Acreage: <b>80</b> Acres

1. Outline the acreage dedicated to the subject well by colored pencil or hatchure marks on the plat below.
2. If more than one lease is dedicated to the well, outline each and identify the ownership thereof (both as to working interest and royalty).
3. If more than one lease of different ownership is dedicated to the well, have the interests of all owners been consolidated by communitization, unitization, force-pooling, etc?

☐ Yes    ☐ No    If answer is "yes," type of consolidation \_\_\_\_\_

If answer is "no," list the owners and tract descriptions which have actually been consolidated. (Use reverse side of this form if necessary.) \_\_\_\_\_

No allowable will be assigned to the well until all interests have been consolidated (by communitization, unitization, forced-pooling, or otherwise) or until a non-standard unit, eliminating such interests, has been approved by the Commission.

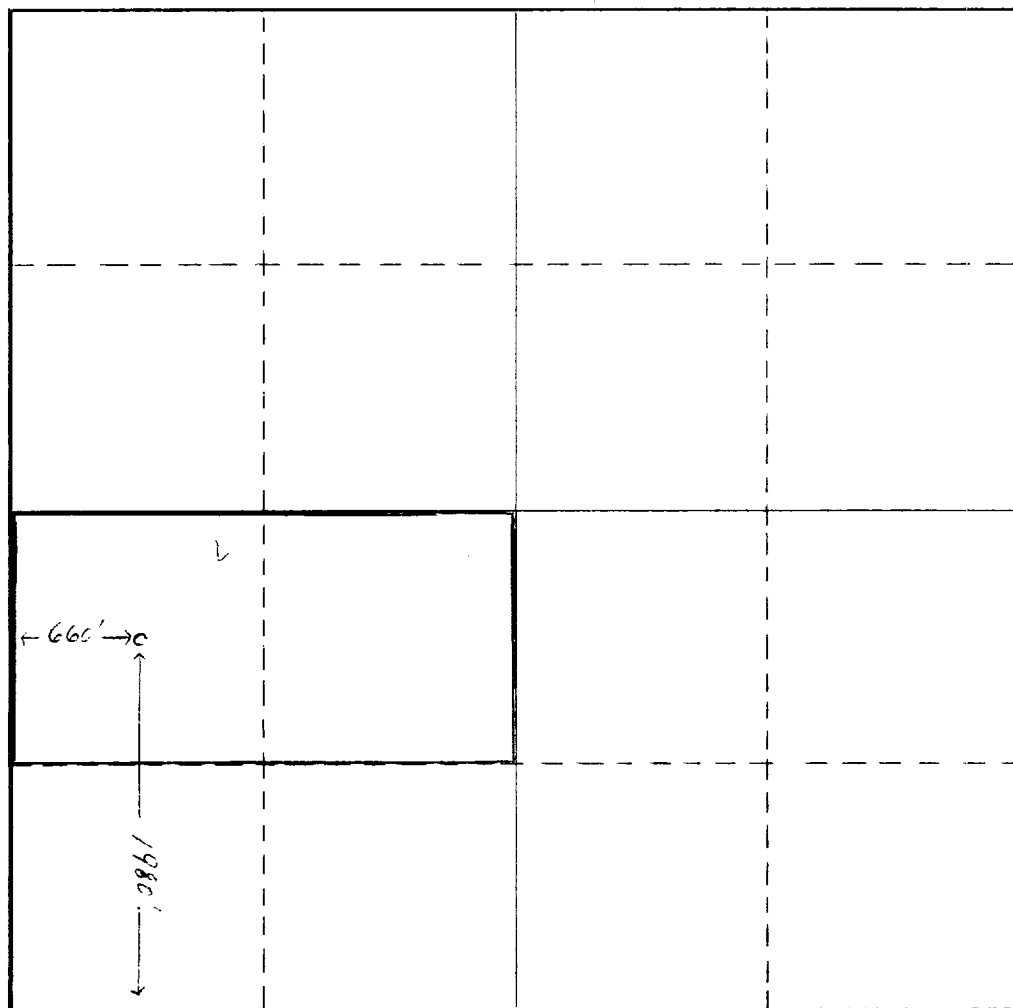

**CERTIFICATION**

*I hereby certify that the information contained herein is true and complete to the best of my knowledge and belief.*

*Tom P. Stephens*

Name  
**Tom P. Stephens**

Position  
**Executive Vice-President**

Company  
**Franklin, Aston & Fair, Inc.**

Date  
**1-27-69**

*I hereby certify that the well location shown on this plat was plotted from field notes of actual surveys made by me or under my supervision, and that the same is true and correct to the best of my knowledge and belief.*

Date Surveyed  
**11-9-68**

Registered Professional Engineer and/or Land Surveyor

**c/s John W. West**

Certificate No.  
**676**

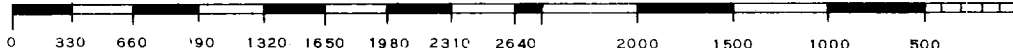

AMENDED  
NEW MEXICO OIL CONSERVATION COMMISSION  
WELL LOCATION AND ACREAGE DEDICATION PLAT

Form C-102  
Supersedes C-120  
Effective 1-1-65

All distances must be from the outer boundaries of the Section.

Operator <b>FRANKLIN, ASTON &amp; FAIR, INC.</b>			Lease <b>Shaw-Federal</b>		Well No. <b>1</b>
Unit Letter <b>L</b>	Section <b>18</b>	Township <b>8 South</b>	Range <b>38 East</b>	County <b>Roosevelt</b>	
Actual Footage Location of Well: <b>1980</b> feet from the <b>South</b> line and <b>660</b> feet from the <b>West</b> line					
Ground Level Elev. <b>3984.7'</b>	Producing Formation <b>San Andres (Slaughter B)</b>		Pool <b>Undesignated</b>		Dedicated Acreage: <b>80</b> Acres

1. Outline the acreage dedicated to the subject well by colored pencil or hachure marks on the plat below.
2. If more than one lease is dedicated to the well, outline each and identify the ownership thereof (both as to working interest and royalty).
3. If more than one lease of different ownership is dedicated to the well, have the interests of all owners been consolidated by communitization, unitization, force-pooling, etc?

☐ Yes ☐ No If answer is "yes," type of consolidation \_\_\_\_\_

If answer is "no," list the owners and tract descriptions which have actually been consolidated. (Use reverse side of this form if necessary.) \_\_\_\_\_

No allowable will be assigned to the well until all interests have been consolidated (by communitization, unitization, forced-pooling, or otherwise) or until a non-standard unit, eliminating such interests, has been approved by the Commission.

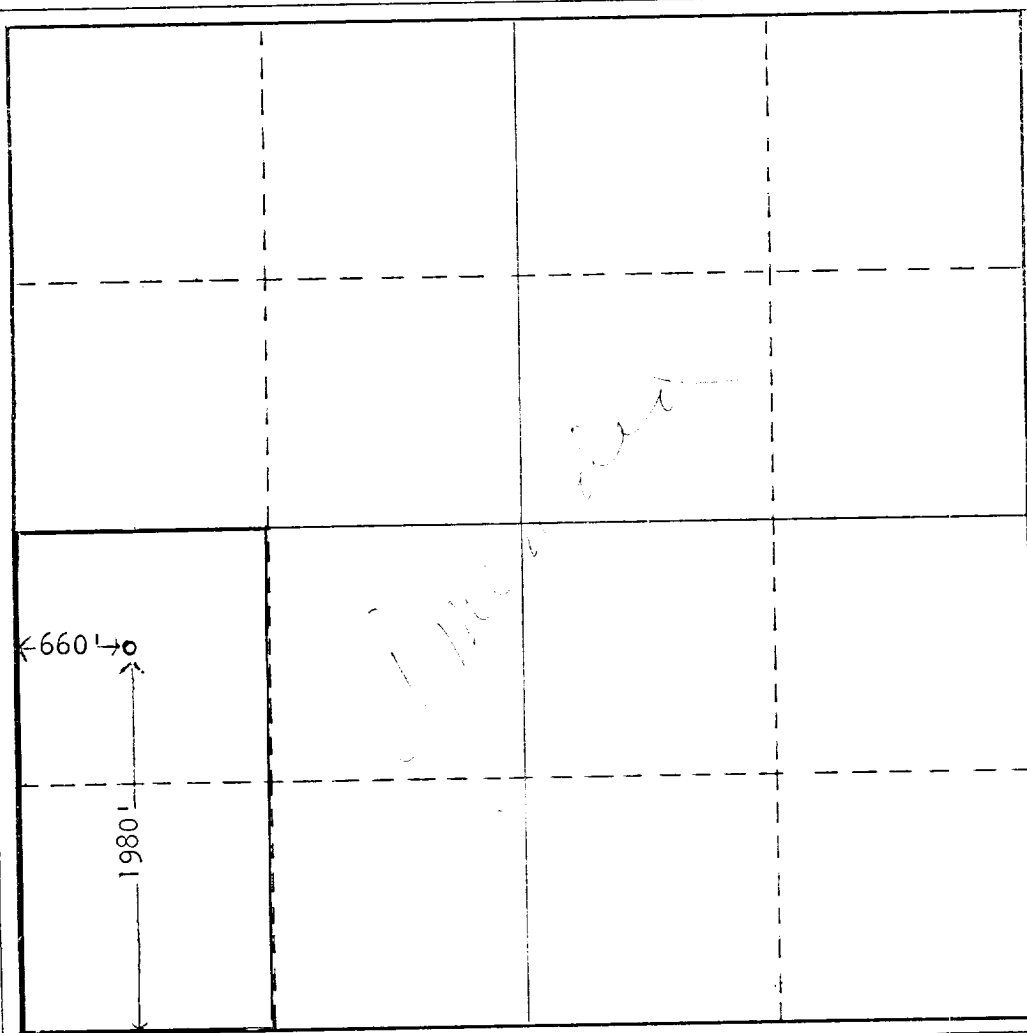

CERTIFICATION

I hereby certify that the information contained herein is true and complete to the best of my knowledge and belief.

*Tom P. Stephens*  
Name

Tom P. Stephens

Position  
Executive Vice-President

Company  
Franklin, Aston & Fair, Inc.

Date  
12-12-68

I hereby certify that the well location shown on this plat was plotted from field notes of actual surveys made by me or under my supervision, and that the same is true and correct to the best of my knowledge and belief.

Date Surveyed  
11-9-68

Registered Professional Engineer  
and/or Land Surveyor

O/S John W. West

Certificate No.  
676

0 330 660 990 1320 1650 1980 2310 2640 2000 1500 1000 500 0