

NEW MEXICO OIL CONSERVATION COMMISSION
WELL LOCATION AND ACREAGE DEDICATION PLAT

Form C-102
Supersedes C-128
Effective 1-1-65

All distances must be from the outer boundaries of the Section.

Operator FRANKLIN, ASTON & FAIR, INC.			Lease SHAW FEDERAL		Well No. 1
Unit Letter L	Section 18	Township 8 SOUTH	Range 38 EAST	County ROOSEVELT	
Actual Footage Location of Well: 1980 feet from the SOUTH line and 660 feet from the WEST line					
Ground Level Elev. 3984.7'	Producing Formation San Andres ("B" zone)		Pool Undesignated	Dedicated Acreage: 40 Acres	

1. Outline the acreage dedicated to the subject well by colored pencil or hachure marks on the plat below.
2. If more than one lease is dedicated to the well, outline each and identify the ownership thereof (both as to working interest and royalty).
3. If more than one lease of different ownership is dedicated to the well, have the interests of all owners been consolidated by communitization, unitization, force-pooling, etc?

☐ Yes ☐ No If answer is "yes," type of consolidation _____

If answer is "no," list the owners and tract descriptions which have actually been consolidated. (Use reverse side of this form if necessary.) _____

No allowable will be assigned to the well until all interests have been consolidated (by communitization, unitization, forced-pooling, or otherwise) or until a non-standard unit, eliminating such interests, has been approved by the Commission.

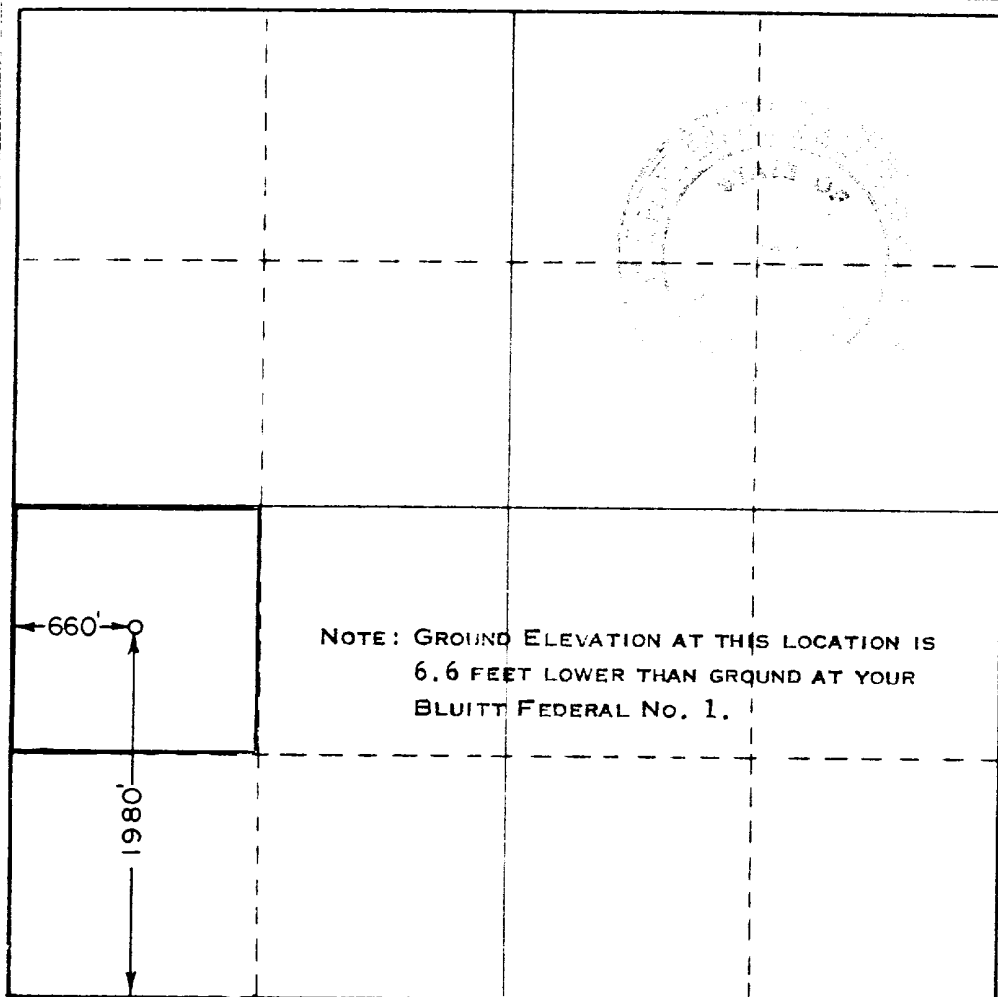

CERTIFICATION

I hereby certify that the information contained herein is true and complete to the best of my knowledge and belief.

Grant M. Smith
Name

Grant M. Smith

Position

Geologist

Company

Franklin, Aston & Fair, Inc.

Date

Nov. 13, 1968

I hereby certify that the well location shown on this plat was plotted from field notes of actual surveys made by me or under my supervision, and that the same is true and correct to the best of my knowledge and belief.

Date Surveyed

NOVEMBER 9, 1968

Registered Professional Engineer
and/or Land Surveyor

John W. West
Certificate No. 676

NOV 10 1968 DEC 18 1968

NSL-4576 (SD) 1980/s & 660/w Bluff SA Assoc
4/24/01 240 ac w/2 NW/4 & SW/4 shares
w/ # 5-E, 11-K, 14-N

NOV 19 1968 DEC 18 1968

R.