

UNITED STATES
DEPARTMENT OF THE INTERIOR
GEOLOGICAL SURVEY

APPLICATION FOR PERMIT TO DRILL, DEEPEN, OR PLUG BACK

1a. TYPE OF WORK

DRILL ☒DEEPEN ☐PLUG BACK ☐

b. TYPE OF WELL

OIL
WELL ☒GAS
WELL ☐OTHER ☐SINGLE
ZONE ☒MULTIPLE
ZONE ☐

2. NAME OF OPERATOR

ROGER C. HANKS

3. ADDRESS OF OPERATOR

606 Wall Towers West, Midland, Texas 79701

4. LOCATION OF WELL (Report location clearly and in accordance with any State requirements.*)

At surface

660' FEL and 1830' FNL

At proposed prod. zone

Bough "C"

14. DISTANCE IN MILES AND DIRECTION FROM NEAREST TOWN OR POST OFFICE*

5 North and 5 East of Crossroads, New Mexico

15. DISTANCE FROM PROPOSED*

LOCATION TO NEAREST
PROPERTY OR LEASE LINE, FT.
(Also to nearest drlg. unit line, if any)

660' FEL

16. NO. OF ACRES IN LEASE

160

17. NO. OF ACRES ASSIGNED
TO THIS WELL

160

18. DISTANCE FROM PROPOSED LOCATION*
TO NEAREST WELL, DRILLING, COMPLETED,
OR APPLIED FOR, ON THIS LEASE, FT.

1170' from

Salt Water Disp.

19. PROPOSED DEPTH

9900'

20. ROTARY OR CABLE TOOLS

Rotary

21. ELEVATIONS (Show whether DF, RT, GR, etc.)

22. APPROX. DATE WORK WILL START*

Immediately upon approval

23.

PROPOSED CASING AND CEMENTING PROGRAM

SIZE OF HOLE	SIZE OF CASING	WEIGHT PER FOOT	SETTING DEPTH	QUANTITY OF CEMENT
17"	13 3/8"	48#	450'	Circulate to surface
11"	8 5/8"	28# - 32#	5200'	500 Sacks
7 7/8"	5 1/2"	17#	9900'	450 Sacks

Operator plans to drill an 11" hole to 5200' to assure below depth that salt water injection operations are presently under operation in Lone Star Producing Company's salt water disposal well 1170' north of this well. 8 5/8" casing will be run and cemented with a salt water sulphur resistant cement and allow sufficient waiting time of 24 hours then pressure test same. If zone anticipated at approximately 9800' appears to be productive of oil and/or gas, then operator will run string of 5 1/2" weighted casing to T.D. and cement with 450 sacks of pozmix cement.

IN ABOVE SPACE DESCRIBE PROPOSED PROGRAM: If proposal is to deepen or plug back, give data on present productive zone and proposed new productive zone. If proposal is to drill or deepen directionally, give pertinent data on subsurface locations and measured and true vertical depths. Give blowout preventer program, if any.

24.

SIGNED

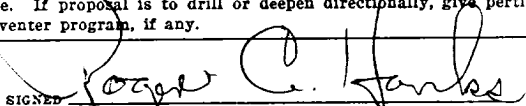

TITLE

Operator

DATE 3-25-69

(This space for Federal or State office use)

PERMIT NO.

APPROVAL

APPROVED BY

TITLE

CONDITIONS OF APPROVAL, IF ANY:

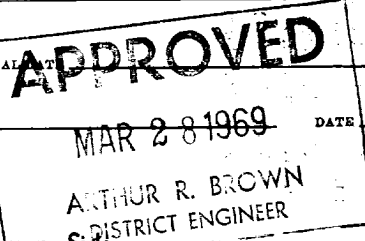

*See Instructions On Reverse Side

NEW MEXICO OIL CONSERVATION COMMISSION
WELL LOCATION AND ACREAGE DEDICATION

Form C-102
Supersedes C-128
Effective 1-1-65

All distances must be from the outer boundaries of the Section.

Operator ROGER C. HANKS			Lease LONE STAR-FEDERAL			Well No. 1		
Unit Letter H	Section 29	Township 8-S	Range 36-E	County ROOSEVELT				
Actual Footage Location of Well: 1830 feet from the NORTH line and 660 feet from the EAST line								
Ground Level Elev. 4117.8	Producing Formation Bough "C" (9800')		Pool Prairie Cisco South			Dedicated Acreage: 160 Acres		

1. Outline the acreage dedicated to the subject well by colored pencil or hachure marks on the plat below.
2. If more than one lease is dedicated to the well, outline each and identify the ownership thereof (both as to working interest and royalty).
3. If more than one lease of different ownership is dedicated to the well, have the interests of all owners been consolidated by communitization, unitization, force-pooling, etc?

☐ Yes ☒ No If answer is "yes," type of consolidation _____

If answer is "no," list the owners and tract descriptions which have actually been consolidated. (Use reverse side of this form if necessary.) U. S. Government NE/4

No allowable will be assigned to the well until all interests have been consolidated (by communitization, unitization, forced-pooling, or otherwise) or until a non-standard unit, eliminating such interests, has been approved by the Commission.

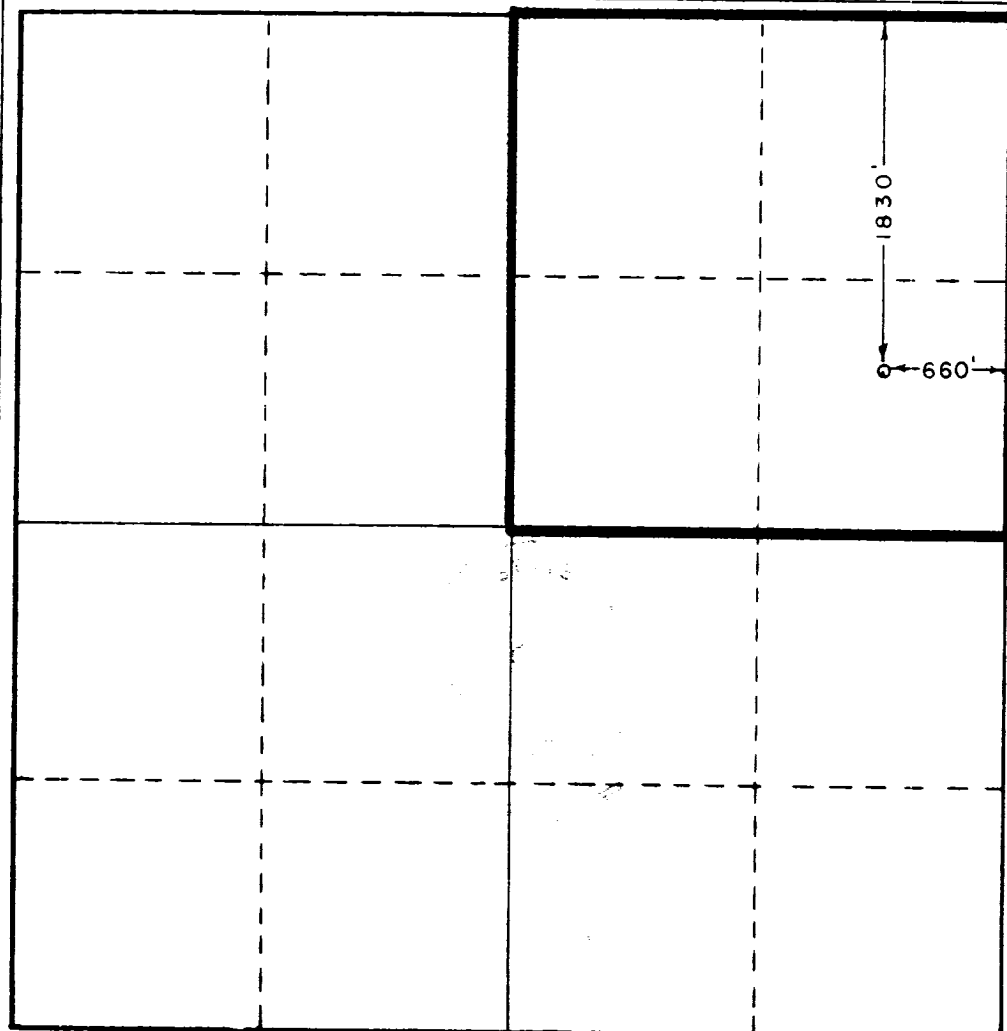

CERTIFICATION

I hereby certify that the information contained herein is true and complete to the best of my knowledge and belief.

Name
Owner

Position
Roger C. Hanks

Company
March 28, 1969

Date

I hereby certify that the well location shown on this plat was plotted from field notes of actual surveys made by me or under my supervision, and that the same is true and correct to the best of my knowledge and belief.

Date Surveyed
MARCH 25, 1969

Registered Professional Engineer and/or Land Surveyor

John W. West

Certificate No. **676**

