

WRS COMPLETION REPORT

REISSUES SEC 34 TWP 8S RGE 35E
PI# 30-T-0006 01/10/92 30-041-20257-0001 PAGE 1

NMEX ROOSEVLT * 510FSL 1980FWL SEC SE SW
STATE COUNTY FOOTAGE SPOT
PETROLEUM PROD MGMT D D DO
OPERATOR WELL CLASS INIT FIN
3 WILL "693" LTD
WELL NO. LEASE NAME
4189GR MILNESAND
OPER ELEV FIELD POOL AREA
API 30-041-20257-0001

LEASE NO. PERMIT OR WELL I.D. NO.
07/01/1990 08/11/1990 ROTARY VERT OIL-WO
SPUD DATE COMF. DATE TYPE TOOL HOLE TYPE STATUS
9795 ABO NORTON DRLG 4
PROJ. DEPTH PROJ. FORM CONTRACTOR
DTD 9815 PB 9810 OTD 9795 FM/TD BOUGH C
DRILLERS T.D. LOG T.D. PLUG BACK TD OLD T.D. FORM T.D.

LOCATION DESCRIPTION

5 MI S MILNESAND, NM

WELL IDENTIFICATION/CHANGES

PROJ FM CHGD FROM PENNSYLVANIAN
FIELD CHGD FROM VADA
INIT CLASS CHGD FROM DX
LSE NAME CHGD FROM WILL FEDERAL "693" LTD

WHIPSTOCK DEPTH

WSD 4160 SET PLUG, DOC TO 4175 & DRLD OFF IN STH

REMEDIAL SIDETRACK HOLE DATA

ORIGINAL HOLE TD 9795

CASING/LINER DATA

CSG 5 1/2 @ 9814 W/ 425 SACKS
PULLED 4280 FT OF OLD 5 1/2 CSG

INITIAL POTENTIAL

IPF 32BOPD 24 MCFD 24/64CK 24HRS
ABO PERF W/ 80/IT 8924- 8948 GROSS
TP 100
GTY 42.0 GOR 750
FCP PKR

CONTINUED IC# 300417000990

COPYRIGHT 1992



Petroleum Information
Corporation

PI-WRS-GE
Form No: 67

REISSUES
PI# 30-T-0006 01/10/92 SEC 34 TWP 8S RGE 35E
30-041-20257-0001 PAGE 2

PETROLEUM PROD MGMT
3 WILL "693" LTD D D DO

FORMATION TEST DATA
DST 1 8916- 8963 ABO
TITE

PRODUCTION TEST DATA
ABO PERF W/ 80/IT 8924- 8948 GROSS
PERF 8924- 8934 8938- 8948
CLAG 8924- 8948 1500GALS
15% MCA

LOGS AND SURVEYS /INTERVAL,TYPE/
LOGS DLL MLL GR
LOGS CNL CBL FMF
LOGS DDL CZDN

DRILLING PROGRESS DETAILS

PETROLEUM PROD MGMT
BOX 957
CROSSROADS, NM 88114
505-675-2478
OWWO: OLD INFO: FORMERLY BTA OIL 3 WILL "693"
LTD. ELEV 4189 GR. SPUD 3/13/70. 12 3/4 @ 390
W/375 SX, 8 5/8 @ 4031 W/400 SX, 5 1/2 @ 9795
W/300 SX. LOG TOPS: ABO 7762, WOLFCAMP 8996.
BOUGH C 9755. OTD 9795. COMP 4/21/70. IPP 180
BO, 918 BWP. PROD ZONE: BOUGH C 9760-9782.
07/11 LOC/1990/
07/10 9795 TD, DRLG BY @ 5592
07/17 9795 TD, DRLG BY @ 8134
07/25 9795 TD, DRLG BY @ 9218
08/01 DRLG 9815
08/08 9815 TD, MICT
08/08 DEEPENED TO 9815 IN STH
RAN 5 1/2 CSG
DEVIATION SURVEYS @ 4445 (2 DEG), 4542 (1 3/4
DEG), 5015 (1 1/2 DEG), 5549 (1 DEG), 6049 (1
DEG), 6546 (1/2 DEG), 7046 (1/2 DEG), 7550 (1/2
DEG), 8070 (1/2 DEG), 8567 (1/2 DEG), 8963 (3/4
DEG), 9815 (1/4 DEG)
RIG REL 08/02/90

CONTINUED

REISSUES SEC 34 TWP 8S RGE 35E
PI# 30-T-0006 01/10/92 30-041-20257-0001 PAGE 3

PETROLEUM PROD MGMT
3 WILL "693" LTD

D D DO

DRILLING PROGRESS DETAILS

08/29 9815 TD, PB 9810
COMP 8/11/90, IPF 32 BO, 24 MCFGPD, 24/64
CK, GOR 750, GTY 42, FTP
100, FCP PKR
PROD ZONE - ABO 8924-8948
NO CORES, ONE DST (TITE) RPTD
01/09 REISSUED TO CORRECT LSE NAME, FM @ TD,
TREATMENT & ADD SHOTS, LOGS, GTY, GOR,
& WHIPSTOCK INFO
REPLACEMENT FOR CT ISSUED 8/30/90

Submit to Appropriate
District Office
State Lease - 4 copies
Fee Lease - 3 copies

State of New Mexico
Energy, Minerals and Natural Resources Department

Form C-102
Revised 1-1-89

OIL CONSERVATION DIVISION

P.O. Box 2088

Santa Fe, New Mexico 87504-2088

DISTRICT I

P.O. Box 1980, Hobbs, NM 88240

DISTRICT II

P.O. Drawer DD, Artesia, NM 88210

DISTRICT III

1000 Rio Brazos Rd., Aztec, NM 87410

WELL LOCATION AND ACREAGE DEDICATION PLAT

All Distances must be from the outer boundaries of the section

Operator Petroleum Production Management, Inc.			Lease Will 693 Ltd.		Well No. 3
Unit Letter N	Section 34	Township 8S	Range 35E	County NMPM	Roosevelt
Actual Footage Location of Well: 510 feet from the South line and 1980 feet from the West line					
Ground level Elev. 4182'	Producing Formation Abo		Pool Milnesand Abo	Dedicated Acreage: 80 Acres	

- Outline the acreage dedicated to the subject well by colored pencil or hatchure marks on the plat below.
- If more than one lease is dedicated to the well, outline each and identify the ownership thereof (both as to working interest and royalty).
- If more than one lease of different ownership is dedicated to the well, have the interest of all owners been consolidated by communitization, unitization, force-pooling, etc?
☐ Yes ☐ No If answer is "yes" type of consolidation _____
If answer is "no" list the owners and tract descriptions which have actually been consolidated. (Use reverse side of this form if necessary.) _____
No allowable will be assigned to the well until all interests have been consolidated (by communitization, unitization, forced-pooling, or otherwise) or until a non-standard unit, eliminating such interest, has been approved by the Division.

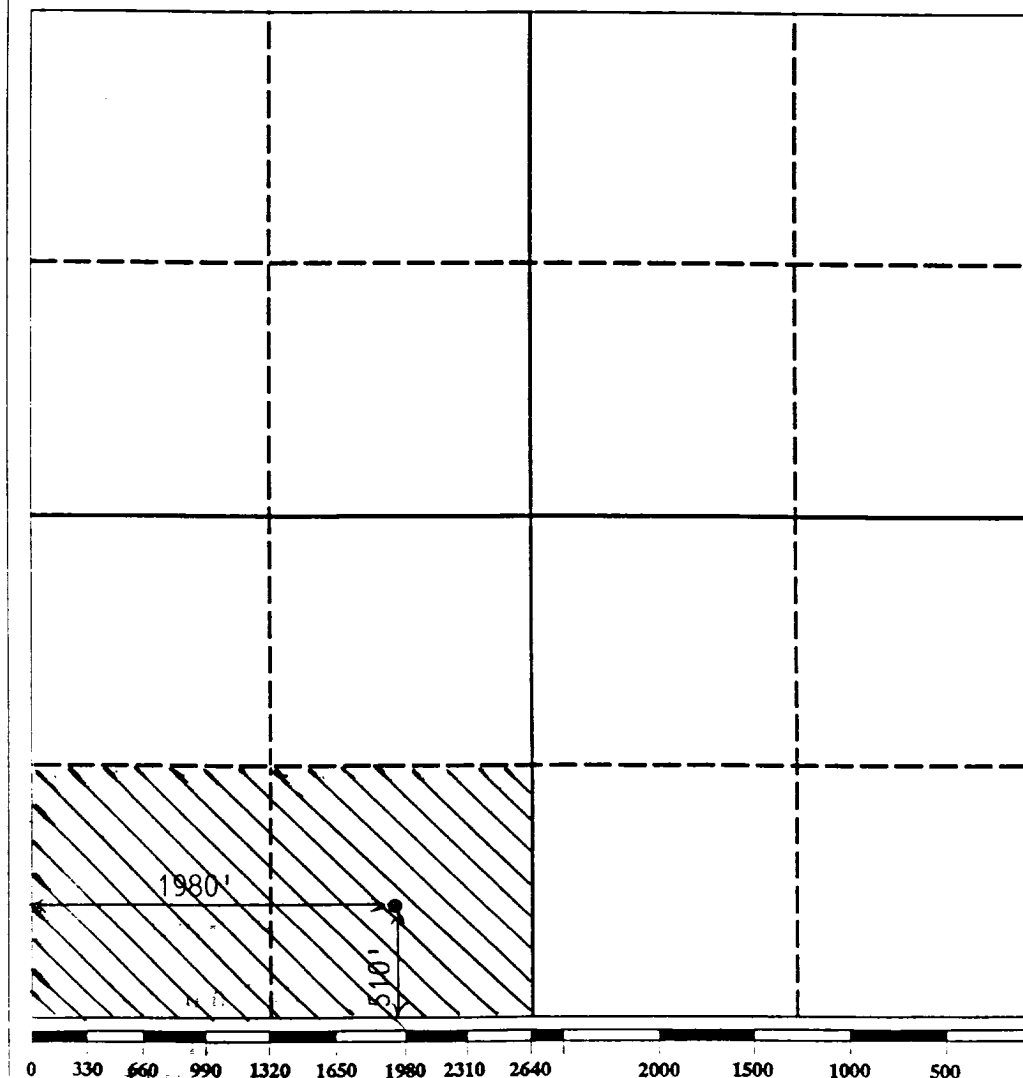

OPERATOR CERTIFICATION

I hereby certify that the information contained herein is true and complete to the best of my knowledge and belief.

Signature

Gary T. Cothran

Printed Name

Gary T. Cothran

Position

District Superintendent

Company

Petroleum Prod. Mgt., Inc.

Date

12-5-91

SURVEYOR CERTIFICATION

I hereby certify that the well location shown on this plat was plotted from field notes of actual surveys made by me or under my supervision, and that the same is true and correct to the best of my knowledge and belief.

Date Surveyed

Signature & Seal of
Professional Surveyor

Certificate No.



STATE OF NEW MEXICO
ENERGY, MINERALS AND NATURAL RESOURCES DEPARTMENT
OIL CONSERVATION DIVISION
HOBBS DISTRICT OFFICE

November 22, 1991

BRUCE KING
GOVERNOR

POST OFFICE BOX 1980
HOBBS, NEW MEXICO 88241-1980
(505) 393-6161

Petroleum Production Management, Inc.
Sutton Place Building, Suite 200
Wichita, Kansas 67202

Re: Division Order R-9594
Special Rules for the Milnesand-Abo Oil Pool

Gentlemen:

According to the provisions of Division Order R-9594, effective November 1, 1991, special rules have been adopted for the Milnesand-Abo Oil Pool, which include the following:

- 1> A standard proration unit to be 80 acres, consisting of the N/2, S/2, E/2 or the W/2 of a governmental quarter section.
- 2> Each well to be located within 150 feet of a quarter/quarter section.
- 3> A depth bracket allowable to be 310 barrels of oil per day.

We request that you submit a new Form C-102 dedicating a standard proration unit to your Will 693 Ltd Well No. 3 located in Unit N, and your Will 693 Ltd Well No. 4 located in Unit J, both in Section 34, Township 8 South, Range 35 East.

The locations of wells currently completed or presently drilling in the Milnesand-Abo Pool are approved.

You are requested to notify this office by letter of any well not meeting the criteria for a standard location.

Very truly yours

OIL CONSERVATION DIVISION

Jerry Sexton
Supervisor, District I

JS:bp

File