

UNITED STATES
DEPARTMENT OF THE INTERIOR
GEOLOGICAL SURVEY

APPLICATION FOR PERMIT TO DRILL, DEEPEN, OR PLUG BACK

1a. TYPE OF WORK DRILL <input checked="" type="checkbox"/> DEEPEN <input type="checkbox"/> PLUG BACK <input type="checkbox"/>			5. LEASE DESIGNATION AND SERIAL NO. NM 0328425	
b. TYPE OF WELL OIL WELL <input checked="" type="checkbox"/> GAS WELL <input type="checkbox"/> OTHER <input type="checkbox"/>			6. IF INDIAN, ALLOTTEE OR TRIBE NAME	
2. NAME OF OPERATOR ROGER C. HANKS			7. UNIT AGREEMENT NAME	
3. ADDRESS OF OPERATOR 606 Wall Towers West, Midland, Texas 79701			8. FARM OR LEASE NAME NANCY-FEDERAL	
4. LOCATION OF WELL (Report location clearly and in accordance with any State requirements.)* At surface 1980' FNL and 660' FEL of Section 28, Township 8 South, Range 36 East At proposed prod. zone Pennsylvanian			9. WELL NO. 1	
14. DISTANCE IN MILES AND DIRECTION FROM NEAREST TOWN OR POST OFFICE* 4 miles Southeast of Milnesand, New Mexico			10. FIELD AND POOL, OR WILDCAT Middle Allison	
15. DISTANCE FROM PROPOSED* LOCATION TO NEAREST PROPERTY OR LEASE LINE, FT. (Also to nearest drlg. unit line, if any) 660'			11. SEC., T., R., M., OR BLK. AND SURVEY OR AREA 28-8S-36E	
16. NO. OF ACRES IN LEASE 160			12. COUNTY OR PARISH 13. STATE Roosevelt New Mexico	
17. DISTANCE FROM PROPOSED* LOCATION TO NEAREST WELL, DRILLING, COMPLETED, OR APPLIED FOR, ON THIS LEASE, FT. 3960'E			17. NO. OF ACRES ASSIGNED TO THIS WELL 160	
18. PROPOSED DEPTH 10,000'			20. ROTARY OR CABLE TOOLS Rotary	
21. ELEVATIONS (Show whether DF, RT, GR, etc.) 4091' GR			22. APPROX. DATE WORK WILL START* March 1, 1970	

PROPOSED CASING AND CEMENTING PROGRAM

SIZE OF HOLE	SIZE OF CASING	WEIGHT PER FOOT	SETTING DEPTH	QUANTITY OF CEMENT
17"	12 3/4"	42#	450'	300 sx. Circ. to Surface
11"	8 5/8"	32# & 24#	4250'	400 sx.
7 7/8"	5 1/2"	17# N-80 & J-55	10,000'	400 sx.

Operator plans to drill the well to TD of approximately 10,000' and test zone either by DST or log analysis. If information indicates zone is productive of oil and/or gas, then operator plans to run 5 1/2" casing, cement same, perforate and acidize for production tests. If dry hole is indicated, well will be plugged and abandoned in accordance with Federal Rules and Regulations.

IN ABOVE SPACE DESCRIBE PROPOSED PROGRAM: If proposal is to deepen or plug back, give data on present productive zone and proposed new productive zone. If proposal is to drill or deepen directionally, give pertinent data on subsurface locations and measured and true vertical depths. Give blowout preventer program, if any.

24. SIGNED Roger C. Hanks TITLE Operator DATE 2-12-70
(This space for Federal or State office use)

PERMIT NO. _____

APPROVED BY _____

CONDITIONS OF APPROVAL, IF ANY: _____

TITLE _____

APPROVAL DATE

APPROVED

MAY 22 1970

ARTHUR R. BROWN
DISTRICT ENGINEER

*See Instructions On Reverse Side

RECEIVED

MAY 14 1970

OIL CONSERVATION COMM.
HOUSTON, TEXAS

**NEW MEXICO OIL CONSERVATION COMMISSION
WELL LOCATION AND ACREAGE DEDICATION PLAT**

Form C-102
Supersedes C-128
Effective 1-1-65

All distances must be from the outer boundaries of the Section.

Operator ROGER C. HANKS			Lease NANCY-FEDERAL		Well No. 1
Unit Letter H	Section 28	Township 8 SOUTH	Range 36 EAST	County ROOSEVELT	
Actual Footage Location of Well: 1980 feet from the NORTH line and 660 feet from the EAST line					
Ground Level Elev. 4091	Producing Formation Pennsylvanian	Pool Middle Allison		Dedicated Acreage: 160 Acres	

1. Outline the acreage dedicated to the subject well by colored pencil or hachure marks on the plat below.
2. If more than one lease is dedicated to the well, outline each and identify the ownership thereof (both as to working interest and royalty).
3. If more than one lease of different ownership is dedicated to the well, have the interests of all owners been consolidated by communitization, unitization, force-pooling, etc?

☐ Yes ☐ No If answer is "yes," type of consolidation _____

If answer is "no," list the owners and tract descriptions which have actually been consolidated. (Use reverse side of this form if necessary.) _____

No allowable will be assigned to the well until all interests have been consolidated (by communitization, unitization, forced-pooling, or otherwise) or until a non-standard unit, eliminating such interests, has been approved by the Commission.

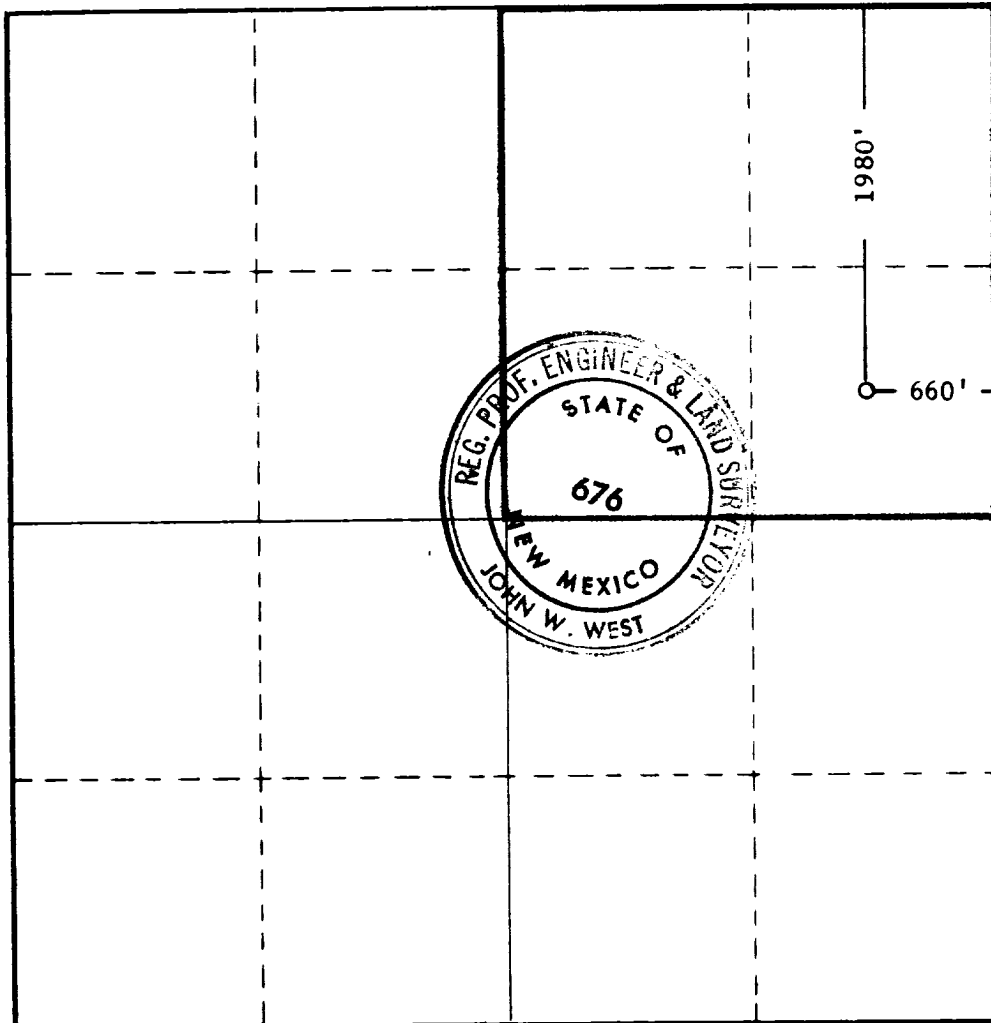

CERTIFICATION

I hereby certify that the information contained herein is true and complete to the best of my knowledge and belief.

Name _____
Position _____
Operator

Company
Roger C. Hanks

Date
February 13, 1970

I hereby certify that the well location shown on this plat was plotted from field notes of actual surveys made by me or under my supervision, and that the same is true and correct to the best of my knowledge and belief.

Date Surveyed
FEB. 10, 1970

Registered Professional Engineer and/or Land Surveyor

John W. West
Certificate No. **676**



RECEIVED

MAY 25 1970

UPL CONSERVATION COMM.
POBBS, N. M.