

NO. OF COPIES RECEIVED	
DISTRIBUTION	
SANTA FE	
FILE	
U.S.G.S.	
LAND OFFICE	
OPERATOR	

Form C-105
Revised 1-1-65

NEW MEXICO OIL CONSERVATION COMMISSION WELL COMPLETION OR RECOMPLETION REPORT AND LOG

5a. Indicate Type of Lease	
State <input checked="" type="checkbox"/>	Fee <input type="checkbox"/>
5. State Oil & Gas Lease No.	
E-8948	

1a. TYPE OF WELL						7. Unit Agreement Name	
OIL WELL <input checked="" type="checkbox"/> GAS WELL <input type="checkbox"/> DRY <input type="checkbox"/> OTHER <input type="checkbox"/>						8. Farm or Lease Name	
b. TYPE OF COMPLETION						8. Farm or Lease Name	
NEW WELL <input type="checkbox"/> WORK OVER <input type="checkbox"/> DEEPEN <input type="checkbox"/> PLUG BACK <input type="checkbox"/> DIFF. RESVR. <input type="checkbox"/> OTHER <input type="checkbox"/>						8. Farm or Lease Name	
2. Name of Operator						9. Well No.	
FRANKLIN, ASTON & FAIR, INC.						3	
3. Address of Operator						10. Field and Pool, or Wildcat	
P. O. Box 1090, Roswell, New Mexico 88201						Todd Lower San Andres	
4. Location of Well						12. County	
UNIT LETTER H LOCATED 1830 FEET FROM THE North LINE AND 660 FEET FROM THE East LINE OF SEC. 31 TWP. 7S RGE. 36E NMPM						Roosevelt	
15. Date Spudded	16. Date T.D. Reached	17. Date Compl. (Ready to Prod.)	18. Elevations (DF, RKB, RT, GR, etc.)	19. Elev. Casinghead			
7-8-70	7-16-70	7-22-70	4129.3' GR				
20. Total Depth	21. Plug Back T.D.	22. If Multiple Compl., How Many	23. Intervals Drilled By	Rotary Tools	Cable Tools		
4300'			surf	surf	TD 4300'		
24. Producing Interval(s), of this completion — Top, Bottom, Name						25. Was Directional Survey Made	
4256' - 4278'						No	
26. Type Electric and Other Logs Run						27. Was Well Cored	
Gamma Ray Sonic						No	
28. CASING RECORD (Report all strings set in well)							
CASING SIZE	WEIGHT LB./FT.	DEPTH SET	HOLE SIZE	CEMENTING RECORD		AMOUNT PULLED	
8 5/8"	20#	287'	12"	175 sacks - circ. to surface			
4 1/2"	9.5#	4300'	7 7/8"	275 sacks		None	
29. LINER RECORD							
SIZE	TOP	BOTTOM	SACKS CEMENT	SCREEN	30. TUBING RECORD		
None					SIZE	DEPTH SET	PACKER SET
31. Perforation Record (Interval, size and number)				32. ACID, SHOT, FRACTURE, CEMENT SQUEEZE, ETC.			
4256'	4267'	4278'					
4258'	4271'						
4261'	4272'						
4263'	4276'						
33. PRODUCTION							
Date First Production		Production Method (Flowing, gas lift, pumping — Size and type pump)				Well Status (Prod. or Shut-in)	
7-22-70		Swabbing & Flowing (Pumping)				Prod.	
Date of Test	Hours Tested	Choke Size	Prod'n. For Test Period	Oil — Bbl.	Gas — MCF	Water — Bbl.	Gas — Oil Ratio
8-1-70	24			75.85	244	153.80	1952:1
Flow Tubing Press.	Casing Pressure	Calculated 24-Hour Rate	Oil — Bbl.	Gas — MCF	Water — Bbl.	Oil Gravity — API (Corr.)	
						26°	
34. Disposition of Gas (Sold, used for fuel, vented, etc.)						Test Witnessed By	
Vented Will be connected to Cities Service line						J. W. Brasfield	
35. List of Attachments							
Amended Dedication Plat							
36. I hereby certify that the information shown on both sides of this form is true and complete to the best of my knowledge and belief.							
SIGNED Grant M. Smith				TITLE Geologist		DATE 8-3-70	

INSTRUCTIONS

This form is to be filed with the appropriate District Office of the Commission not later than 20 days after the completion of any newly-drilled or deepened well. It shall be accompanied by one copy of all electrical and radio-activity logs run on the well and a summary of all special tests conducted, including drill stem tests. All depths reported shall be measured depths. In the case of directionally drilled wells, true vertical depths shall also be reported. For multiple completions, Items 30 through 34 shall be reported for each zone. The form is to be filed in quintuplicate except on state land, where six copies are required. See Rule 1105.

INDICATE FORMATION TOPS IN CONFORMANCE WITH GEOGRAPHICAL SECTION OF STATE

Southeastern New Mexico

Northwestern New Mexico

T. Anhy _____	T. Canyon _____	T. Ojo Alamo _____	T. Penn. "B" _____
T. Salt _____	T. Strawn _____	T. Kirtland-Fruitland _____	T. Penn. "C" _____
B. Salt _____	T. Atoka _____	T. Pictured Cliffs _____	T. Penn. "D" _____
T. Yates _____	T. Miss _____	T. Cliff House _____	T. Leadville _____
T. 7 Rivers _____	T. Devonian _____	T. Menefee _____	T. Madison _____
T. Queen _____	T. Silurian _____	T. Point Lookout _____	T. Elbert _____
T. Grayburg _____	T. Montoya _____	T. Mancos _____	T. McCracken _____
T. San Andres _____	T. Simpson _____	T. Gallup _____	T. Ignacio Qtzte _____
T. Glorieta _____	T. McKee _____	Base Greenhorn _____	T. Granite _____
T. Paddock _____	T. Ellenburger _____	T. Dakota _____	T. _____
T. Blinebry _____	T. Gr. Wash _____	T. Morrison _____	T. _____
T. Tubb _____	T. Granite _____	T. Todilto _____	T. _____
T. Drinkard _____	T. Delaware Sand _____	T. Entrada _____	T. _____
T. Abo _____	T. Bone Springs _____	T. Wingate _____	T. _____
T. Wolfcamp _____	T. _____	T. Chinle _____	T. _____
T. Penn. _____	T. _____	T. Permian _____	T. _____
T. Cisco (Bough C) _____	T. _____	T. Penn. "A" _____	T. _____

FORMATION RECORD (Attach additional sheets if necessary)

From	To	Thickness in Feet	Formation	From	To	Thickness in Feet	Formation
3490'			Top San Andres				
4141'	4231'	90	(Slaughter A)				
4231'	4244'	13	2nd Anhydrite				
4244'	4286'	42	(Slaughter B)				
4286'	4300'	TD	3rd Anhydrite				

RECEIVED
 AUG 1 1970
 OIL CONSERVATION DIV.
 WASHINGTON, D.C.

NEW MEXICO OIL CONSERVATION COMMISSION
WELL LOCATION AND ACREAGE DEDICATION PLAT

Form C-102
Supersedes C-128
Effective 1-1-65

All distances must be from the outer boundaries of the Section.

Operator FRANKLIN, ASTON & FAIR, INC.			Lease SMITH STATE SKELLY STATE		Well No. 3
Unit Letter H	Section 31	Township 7 SOUTH	Range 36 EAST	County ROOSEVELT	
Actual Footage Location of Well: 1830 feet from the NORTH line and 660 feet from the EAST line					
Ground Level Elev. 4129.3	Producing Formation San Andres (Slaughter B)		Pool Todd Lower San Andres		Dedicated Acreage: 80 Acres

1. Outline the acreage dedicated to the subject well by colored pencil or hatchure marks on the plat below.
2. If more than one lease is dedicated to the well, outline each and identify the ownership thereof (both as to working interest and royalty).
3. If more than one lease of different ownership is dedicated to the well, have the interests of all owners been consolidated by communitization, unitization, force-pooling, etc?

☐ Yes ☐ No If answer is "yes," type of consolidation _____

If answer is "no," list the owners and tract descriptions which have actually been consolidated. (Use reverse side of this form if necessary.) _____

No allowable will be assigned to the well until all interests have been consolidated (by communitization, unitization, forced-pooling, or otherwise) or until a non-standard unit, eliminating such interests, has been approved by the Commission.

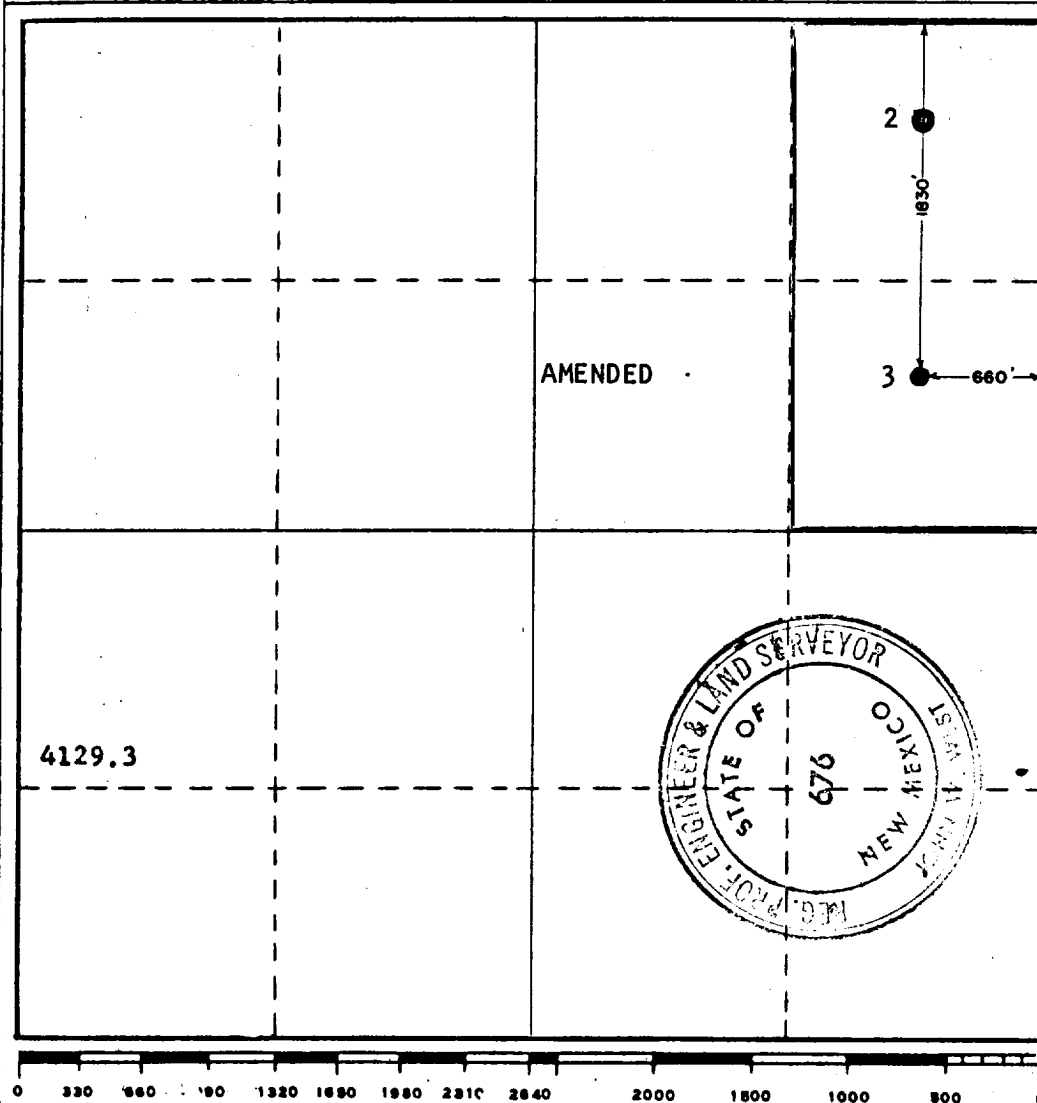

CERTIFICATION

I hereby certify that the information contained herein is true and complete to the best of my knowledge and belief.

/s/ Tom P. Stephens
Name

Tom P. Stephens

Position

Executive Vice-President

Company

FRANKLIN, ASTON & FAIR, INC.

Date

July 1, 1970

I hereby certify that the well location shown on this plat was plotted from field notes of actual surveys made by me or under my supervision, and that the same is true and correct to the best of my knowledge and belief.

JUNE 26, 1970

Date Surveyed

Registered Professional Engineer and/or Land Surveyor

John W. West
Certificate No.

676