

NO. OF COPIES RECEIVED	
DISTRIBUTION	
SANTA FE	
FILE	
U.S.G.S.	
LAND OFFICE	
OPERATOR	

NEW MEXICO OIL CONSERVATION COMMISSION

Form C-101
Revised 1-1-65

5A. Indicate Type of Lease STATE <input checked="" type="checkbox"/> FEE <input type="checkbox"/>
5. State Oil & Gas Lease No. K-4348
7. Unit Agreement Name
8. Farm or Lease Name Blond-State
9. Well No. 2
10. Field Name Vada Pennsylvanian

APPLICATION FOR PERMIT TO DRILL, DEEPEN, OR PLUG BACK

1a. Type of Work b. Type of Well OIL WELL <input checked="" type="checkbox"/> GAS WELL <input type="checkbox"/> OTHER <input type="checkbox"/> SINGLE ZONE <input checked="" type="checkbox"/> MULTIPLE ZONE <input type="checkbox"/>		2. Name of Operator Roger C. Hanks	
3. Address of Operator 2100 Wilco Building, Midland, Texas 79701		7. Unit Agreement Name	
4. Location of Well UNIT LETTER <u>P</u> LOCATED <u>660</u> FEET FROM THE <u>South</u> LINE AND <u>660</u> FEET FROM THE <u>East</u> LINE OF SEC. <u>32</u> TWP. <u>8S</u> RGE. <u>35E</u> NMPM		8. Farm or Lease Name Blond-State	
12. County Roosevelt		9. Well No. 2	
19. Proposed Depth 10,000'		19A. Formation Bough "C"	
20. Rotary or C.T. Rotary		21. Elevations (Show whether DF, RT, etc.) 4203.1 GK	
21A. Kind & Status Plug. Bond \$10,000 D&P		21B. Drilling Contractor FWA Drlg. Co.	
22. Approx. Date Work will start October 1, 1970			

PROPOSED CASING AND CEMENT PROGRAM

SIZE OF HOLE	SIZE OF CASING	WEIGHT PER FOOT	SETTING DEPTH	SACKS OF CEMENT	EST. TOP
17 1/2"	12 3/4"	42#	450'	300	Surface
11"	8 5/8"	32# & 24#	4,250'	400	450'
7 7/8"	5 1/2"	17# N-80&J-	10,000'	400	4,250'

Operator plans to drill the well to TD of approximately 10,000' and test zone either by DST or log analysis. If information indicates zone is productive of oil and/or gas, the operator plans to run 5 1/2" casing, cement same, perforate and acidize for production tests. If dry hole is indicated, well will be plugged and abandoned in accordance with Oil Conservation Commission Rules and Regulations.

APPROVAL VALID
FOR 90 DAYS UNLESS
DRILLING IS COMMENCED,
EXPIRES Jan. 3, 1971

THE COMMISSION MUST BE NOTIFIED
24 HOURS BEFORE TO RUNNING 12 1/2"
CASING.

IN ABOVE SPACE DESCRIBE PROPOSED PROGRAM: IF PROPOSAL IS TO DEEPEN OR PLUG BACK, GIVE DATA ON PRESENT PRODUCTIVE ZONE AND PROPOSED NEW PRODUCTIVE ZONE. GIVE BLOWOUT PREVENTER PROGRAM, IF ANY.

I hereby certify that the information above is true and complete to the best of my knowledge and belief.

Signed Wanda Sanders Title Production Clerk Date Sept. 30, 1970

(This space for State Use)

APPROVED BY John W. Runyan TITLE Geologist DATE Oct 5 1970

CONDITIONS OF APPROVAL, IF ANY:

RECEIVED

1970 01370

OIL CONSERVATION COMM.
1970 01370

**NEW MEXICO OIL CONSERVATION COMMISSION
WELL LOCATION AND ACREAGE DEDICATION PLAT**

Form C-102
Supersedes C-128
Effective 1-1-65

All distances must be from the outer boundaries of the Section.

Operator ROGER C. HANKS			Lease BLOND STATE		Well No. 2
Unit Letter P	Section 32	Township 8 SOUTH	Range 35 EAST	County ROOSEVELT	
Actual Footage Location of Well: 660 feet from the SOUTH line and 660 feet from the EAST line					
Ground Level Elev. 4203.1	Producing Formation Bough "C"		Pool Vada Pennsylvanian	Dedicated Acreage: 160 Acres	

1. Outline the acreage dedicated to the subject well by colored pencil or hachure marks on the plat below.
2. If more than one lease is dedicated to the well, outline each and identify the ownership thereof (both as to working interest and royalty).
3. If more than one lease of different ownership is dedicated to the well, have the interests of all owners been consolidated by communitization, unitization, force-pooling, etc?

☐ Yes ☐ No If answer is "yes," type of consolidation _____

If answer is "no," list the owners and tract descriptions which have actually been consolidated. (Use reverse side of this form if necessary.) _____

No allowable will be assigned to the well until all interests have been consolidated (by communitization, unitization, forced-pooling, or otherwise) or until a non-standard unit, eliminating such interests, has been approved by the Commission.

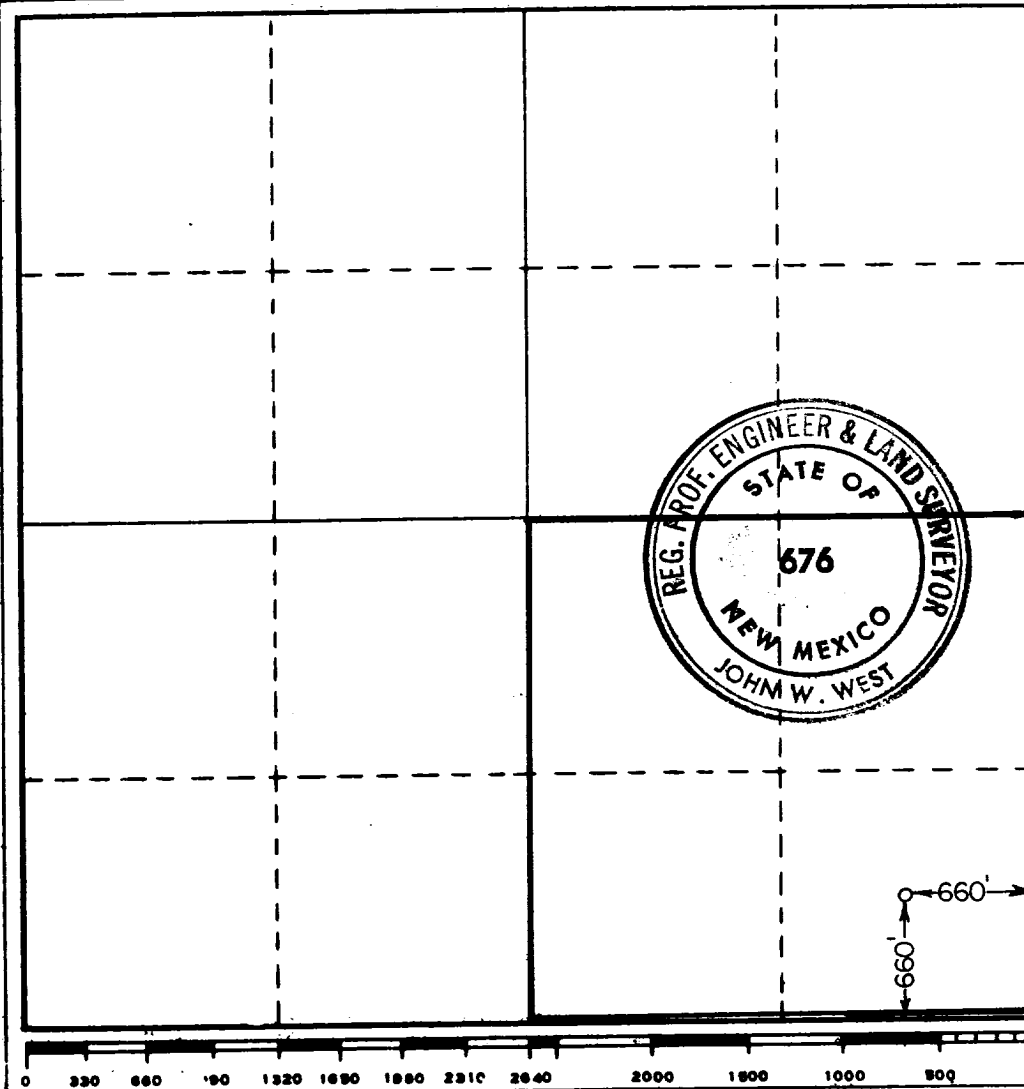

CERTIFICATION

I hereby certify that the information contained herein is true and complete to the best of my knowledge and belief.

Roger C. Hanks
Name
Wanda Sanders
Position
Operator

Company
Roger C. Hanks

Date
October 1, 1970

I hereby certify that the well location shown on this plat was plotted from field notes of actual surveys made by me or under my supervision, and that the same is true and correct to the best of my knowledge and belief.

Date Surveyed
SEPTEMBER 30, 1970

Registered Professional Engineer and/or Land Surveyor

John W. West
Certificate No.

676

RECEIVED

OL CONSERVATION COMM.
FORMS