

UNITED STATES
DEPARTMENT OF THE INTERIOR
GEOLOGICAL SURVEY

APPLICATION FOR PERMIT TO DRILL, DEEPEN, OR PLUG BACK

1a. TYPE OF WORK DRILL <input checked="" type="checkbox"/> DEEPEN <input type="checkbox"/> PLUG BACK <input type="checkbox"/>			5. LEASE DESIGNATION AND SERIAL NO. MM 0497735	
b. TYPE OF WELL OIL WELL <input checked="" type="checkbox"/> GAS WELL <input type="checkbox"/> OTHER <input type="checkbox"/> SINGLE ZONE <input checked="" type="checkbox"/> MULTIPLE ZONE <input type="checkbox"/>			6. IF INDIAN, ALLOTTEE OR TRIBE NAME	
2. NAME OF OPERATOR TEXACO INC. % MR. DARRELL SMITH			7. UNIT AGREEMENT NAME	
3. ADDRESS OF OPERATOR P. O. BOX 3109, Midland, Texas 79701			8. FARM OR LEASE NAME M. A. Cunningham-Fed.NCT-1	
4. LOCATION OF WELL (Report location clearly and in accordance with any State requirements.)* At surface 660' FNL & 1980' FWL. Sec. 26 At proposed prod. zone Same			9. WELL NO. 1	
14. DISTANCE IN MILES AND DIRECTION FROM NEAREST TOWN OR POST OFFICE* 3 miles No. of Milnesand, New Mexico			10. FIELD AND POOL, OR WILDCAT Bravo(Wolfcamp)Undesignated	
15. DISTANCE FROM PROPOSED* LOCATION TO NEAREST PROPERTY OR LEASE LINE, FT. (Also to nearest drlg. unit line, if any) 660'			11. SEC., T., R., M., OR BLK. AND SURVEY OR AREA Sec. 26, T-7-S, R-35, E	
16. NO. OF ACRES IN LEASE 280			12. COUNTY OR PARISH Roosevelt	
17. NO. OF ACRES ASSIGNED TO THIS WELL 40			13. STATE New Mexico	
18. DISTANCE FROM PROPOSED LOCATION* TO NEAREST WELL, DRILLING, COMPLETED, OR APPLIED FOR, ON THIS LEASE, FT. 1st Well (this fld)			20. ROTARY OR CABLE TOOLS Rotary	
21. ELEVATIONS (Show whether DF, RT, GR, etc.) Gr. 4186			22. APPROX. DATE WORK WILL START* At Once	

PROPOSED CASING AND CEMENTING PROGRAM

SIZE OF HOLE	SIZE OF CASING	WEIGHT PER FOOT	SETTING DEPTH	QUANTITY OF CEMENT
15"	11 3/4"	42#	350'	*380sx- 300% to circulate
11"	8 5/8"	24#, 32#	4800'	**1140sx-150% to tie back
7 7/8"	5 1/2"	14#, 15.5#, 17#	7750'	***640 sx-150% to tie back

*380sx Class C, 17 CaCl, 14.8 ppg (300% to circulate) cement must circulate
**840 sx TLW, 12 ppg, followed by 300 sx Class C w/10# salt/sk and 1/4# flocele/sk 14.9 ppg. (150% to tie back-not required)
***440 sx TLW, 12 ppg, followed by 200 sx chem comp expanding cmt. w/0.2% D 86 retarder. (150% to tie back-not required)

COMPLETION PROGRAM

L 1. Selectively perf. pay. 2. Treat w/1500 gals 15% NEA

FORMATION TOPS EXPECTED

Yates	2335'	Wolfcamp "A" Zone	7545'
San Andres	4905'	Wolfcamp "B" Zone	7660'
Tubb	6040'	Total Depth	7750'
Abo	6720'		

IN ABOVE SPACE DESCRIBE PROPOSED PROGRAM: If proposal is to deepen or plug back, give data on present productive zone and proposed new productive zone. If proposal is to drill or deepen directionally, give pertinent data on subsurface locations and measured and true vertical depths. Give blowout preventer program, if any.

24.

SIGNED

J. J. Velton

TITLE

Division Civil EngineerDATE **November 13, 1970**

(This space for Federal or State office use)

PERMIT NO.

APPROVAL DATE

APPROVED BY

TITLE

CONDITIONS OF APPROVAL, IF ANY:

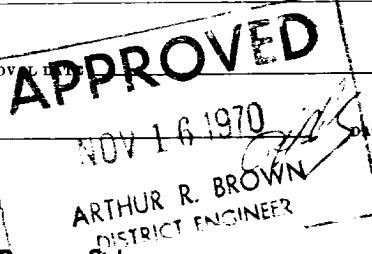

*See Instructions On Reverse Side

Instructions

General: This form is designed for submitting proposals to perform certain well operations, as indicated, on all types of lands and leases for appropriate action by either a Federal or a State agency, or both, pursuant to applicable Federal and/or State laws and regulations. Any necessary special instructions concerning the use of this form and the number of copies to be submitted, particularly with regard to local, area, or regional procedures and practices, either are shown below or will be issued by, or may be obtained from, the local Federal and/or State office.

Item 1: If the proposal is to redrill to the same reservoir at a different subsurface location or to a new reservoir, use this form with appropriate notations. Consult applicable State or Federal regulations concerning subsequent work proposals or reports on the well.

Item 4: If there are no applicable State requirements, locations on Federal or Indian land should be described in accordance with Federal requirements. Consult local State or Federal office for specific instructions.

Item 14: Needed only when location of well cannot readily be found by road from the land or lease description. A plat, or plats, separate or on this reverse side, showing the roads to, and the surveyed location of, the well, and any other required information, should be furnished when required by Federal or State agency offices.

Items 15 and 18: If well is to be, or has been directionally drilled, give distances for subsurface location of hole in any present or objective production zone.

Item 22: Consult applicable Federal or State regulations, or appropriate officials, concerning approval of the proposal before operations are started.

RECEIVED

11 1070

OIL CONSERVATION COMM.
HOBBES W

NEW MEXICO OIL CONSERVATION COMMISSION
WELL LOCATION AND ACREAGE DEDICATION PLAT

Form C-102
Supersedes C-128
Effective 1-1-65

All distances must be from the outer boundaries of the Section.

Operator TEXACO Inc.			Lease M. A. Cunningham Federal NCT-1		Well No. 1
Unit Letter C	Section 26	Township 7-South	Range 35-East	County Roosevelt	
Actual Footage Location of Well: 660 feet from the North line and 1980 feet from the West line Sec. 26					
Ground Level Elev. 4186'	Producing Formation Wolfcamp Dolomite	Pool Bravo (Wolfcamp) - Undesignated		Dedicated Acreage: 40 Acres	

1. Outline the acreage dedicated to the subject well by colored pencil or hachure marks on the plat below.
2. If more than one lease is dedicated to the well, outline each and identify the ownership thereof (both as to working interest and royalty).
3. If more than one lease of different ownership is dedicated to the well, have the interests of all owners been consolidated by communitization, unitization, force-pooling, etc?

☐ Yes ☐ No If answer is "yes," type of consolidation _____

If answer is "no," list the owners and tract descriptions which have actually been consolidated. (Use reverse side of this form if necessary.) _____

No allowable will be assigned to the well until all interests have been consolidated (by communitization, unitization, forced-pooling, or otherwise) or until a non-standard unit, eliminating such interests, has been approved by the Commission.

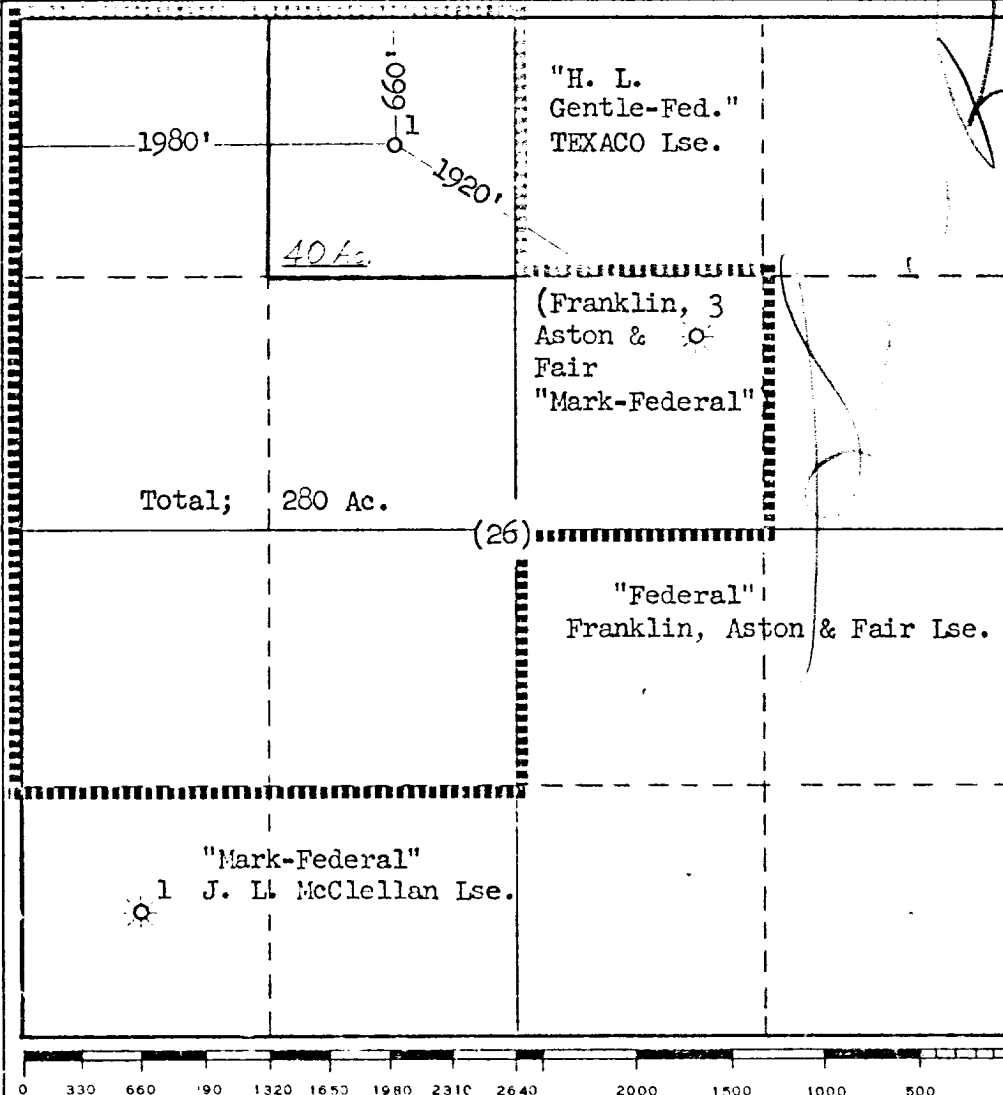

CERTIFICATION

I hereby certify that the information contained herein is true and complete to the best of my knowledge and belief.

Name **J. J. Velten**
Position **Division Civil Engineer**
Company **TEXACO Inc.**

Date **11/13/70**

I hereby certify that the well location shown on this plat was plotted from field notes of actual surveys made by me or under my supervision, and that the same is true and correct to the best of my knowledge and belief.

Date Surveyed **11/12/70**

Registered Professional Engineer and/or Land Surveyor

J. J. Velten

Certificate No. **8174**

RECEIVED

NOV 17 1970

**OIL CONSERVATION COMM.
HOBBS, N. M.**