

SUBMIT IN TRIPLICATE*
(Other instructions on
reverse side)Form approved,
Budget Bureau No. 42-R1425.UNITED STATES
DEPARTMENT OF THE INTERIOR
GEOLOGICAL SURVEY20-041-20311
5. LEASE DESIGNATION AND SERIAL NO.

NM-0145897

6. IF INDIAN, ALLOTTEE OR TRIBE NAME

7. UNIT AGREEMENT NAME

8. FARM OR LEASE NAME

Light

9. WELL NO.

1

10. FIELD AND POOL, OR WILDCAT

Wildcat

11. SEC. T. R. M. OR BLK.
AND SURVEY OR AREA

15-8S-37E

12. COUNTY OR PARISH

Roosevelt

13. STATE

NM

17. NO. OF ACRES ASSIGNED
TO THIS WELL

2040

20. ROTARY OR CABLE TOOL

Rotary tool

22. APPROX. DATE WORK WILL START*

By 1-30-71

APPLICATION FOR PERMIT TO DRILL, DEEPEN, OR PLUG BACK

1a. TYPE OF WORK

DRILL ☒DEEPEN ☐PLUG BACK ☐

b. TYPE OF WELL

OIL
WELL ☒GAS
WELL ☐

OTHER

SINGLE
ZONE ☒MULTIPLE
ZONE ☐

2. NAME OF OPERATOR

TOM L. INGRAM

3. ADDRESS OF OPERATOR

POB 1757 - Roswell, New Mexico 88201

4. LOCATION OF WELL (Report location clearly and in accordance with any State requirements.)*

At surface

1980' FSL & 660' FEL of section

At proposed prod. zone

Same

14. DISTANCE IN MILES AND DIRECTION FROM NEAREST TOWN OR POST OFFICE*

7 miles west of Bledsoe, Texas

10. DISTANCE FROM PROPOSED*

LOCATION TO NEAREST
PROPERTY OR LEASE LINE, FT.
(Also to nearest drig. unit line, if any)

660'

16. NO. OF ACRES IN LEASE

318.47

18. DISTANCE FROM PROPOSED LOCATION*
TO NEAREST WELL, DRILLING, COMPLETED,
OR APPLIED FOR, ON THIS LEASE, FT.

--

19. PROPOSED DEPTH

4800'

21. ELEVATIONS (Show whether DF, RT, GR, etc.)

23.

PROPOSED CASING AND CEMENTING PROGRAM

SIZE OF HOLE	SIZE OF CASING	WEIGHT PER FOOT	SETTING DEPTH	QUANTITY OF CEMENT
11"	8-5/8	20#	375'	375 SX CIRCULATE
7-7/8"	4-1/2	9-1/2#	4800'	250 SX

Will drill to TD, set production casing, perforate, stimulate, and complete
as an oil well. Blow-out preventer will be used.

IN ABOVE SPACE DESCRIBE PROPOSED PROGRAM: If proposal is to deepen or plug back, give data on present productive zone and proposed new productive zone. If proposal is to drill or deepen directionally, give pertinent data on subsurface locations and measured and true vertical depths. Give blowout preventer program, if any.

24.

SIGNED

Tom L. Ingram

TITLE

Operator

DATE

1-28-71

(This space for Federal or State office use)

PERMIT NO.

APPROVAL DATE

APPROVED BY

CONDITIONS OF APPROVAL, IF ANY:

TITLE

APPROVED

JAN 29 1971

ARTHUR R. BROWN
DISTRICT ENGINEER

*See Instructions On Reverse Side

RECEIVED

FEB 2 1977

OIL CONSERVATION COMM.
HOUSTON, TEX.

**NEW MEXICO OIL CONSERVATION COMMISSION
WELL LOCATION AND ACREAGE DEDICATION PLAT**

Form C-102
Supersedes C-128
Effective 1-1-65

All distances must be from the outer boundaries of the Section.

Operator TOM L. INGRAM			Lease LIGHT		Well No. 1
Unit Letter I	Section 15	Township 8 SOUTH	Range 37 EAST	County ROOSEVELT	
Actual Footage Location of Well:					
1980 feet from the SOUTH line and		660 feet from the EAST line			
Ground Level Elev. 4011.3	Producing Formation SAN ANDRES	Pool WILDCAT		Dedicated Acreage: 40	Acres

1. Outline the acreage dedicated to the subject well by colored pencil or hatchure marks on the plat below.
2. If more than one lease is dedicated to the well, outline each and identify the ownership thereof (both as to working interest and royalty).
3. If more than one lease of different ownership is dedicated to the well, have the interests of all owners been consolidated by communitization, unitization, force-pooling, etc?

☐ Yes ☐ No If answer is "yes," type of consolidation _____

If answer is "no," list the owners and tract descriptions which have actually been consolidated. (Use reverse side of this form if necessary.) _____

No allowable will be assigned to the well until all interests have been consolidated (by communitization, unitization, forced-pooling, or otherwise) or until a non-standard unit, eliminating such interests, has been approved by the Commission.

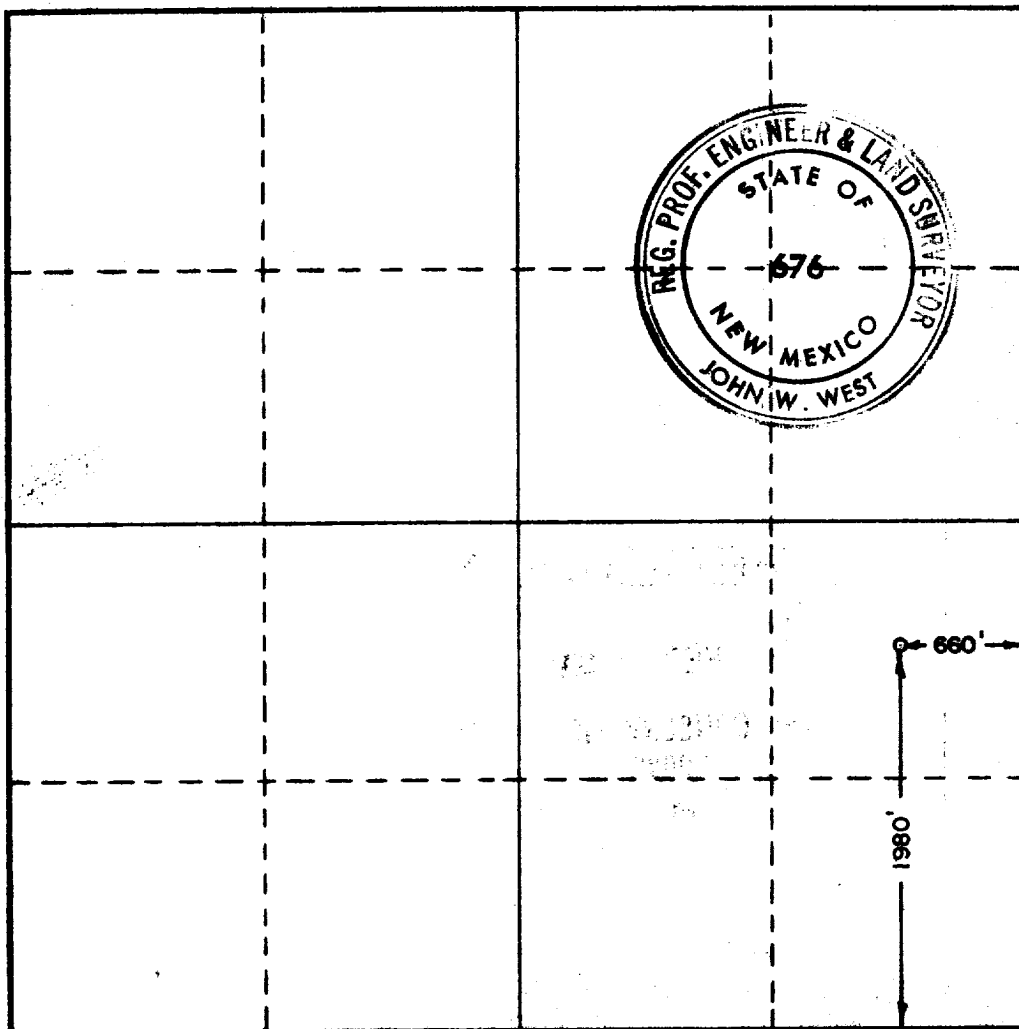

CERTIFICATION

I hereby certify that the information contained herein is true and complete to the best of my knowledge and belief.

Name John W. West
Position AGENT
Company TOM L. INGRAM
Date 1-28-1971

I hereby certify that the well location shown on this plat was plotted from field notes of actual surveys made by me or under my supervision, and that the same is true and correct to the best of my knowledge and belief.

Date Surveyed 1-28-1971
Registered Professional Engineer and/or Land Surveyor

John W. West
Certificate No. 676



RECEIVED

FEB 2 1971

OIL CONSERVATION COMM.
HOBBBS, N. H.