

COUNTY	ROOSEVELT	FIELD	Wildcat	STATENM	30-041-20311
OPR	INGRAM, TOM L.			MAP	
	1 Light				
	Sec 15, T-8-S, R-37-E				
	1980' FSL, 660' FEL of Sec				
	Spd 1-31-71				
	Camp 3-27-71		CLASS	EL 40232	
	FORMATION	DATUM	FORMATION	DATUM	
CSG & SX - TUBING					
8 5/8" at 376' w/275 sx					
5 1/2" at 4815' w/250 sx.					
LOGS EL GR RA IND HC A					
	TD 4815'; PBD 4750'				
IP (San Andres) Perfs 4630-4730' CAOF 2320 MCFGPD. GOR 152,900; Grav (gas) .740; (cond) 37.7; SIWHP 1300#.					

Distribution limited and publication prohibited by subscribers' agreement.
Reproduction rights reserved by Williams & Lee Scouting Service, Inc.

CONT.	Verna	PROP DEPTH	4800'	TYPE	RT
DATE					

F.R. 2-2-71; Opr's Elev. 4023' KB
PD 4800' RT (San Andres)
Contractor - Verna
2-2-71 Drlg. 2700'
2-8-71 TD 4815' dolo; WOC
No Tests or Cores
Ran Logs to TD
2-15-71 TD 4815' dolo; Prep Perf
2-22-71 TD 4815'; PBD 4750'; Rng Tubing
Perf @ 4766', 4767', 4774', 4776', 4785', 4786',
4791', 4793' w/1 SPI
Acid (4766-93') 500 gals
Swbd 14 BWPH for 6 hrs (4766-93')
PB to 4750'
Perf @ 4686', 4690', 4698', 4709', 4713', 4724',
4730' w/1 SPI

ROOSEVELT
INGRAM, TOM L.

Wildcat
1 Light

NM

30-051-20311

Page #2

3-1-71 TD 4815'; PBD 4750'; Tstg
3-8-71 TD 4815'; PBD 4750'; Prep Acid (4630-4730')
Acid (4686-4730') 6500 gals
Perf @ 4630', 4632', 4634', 4642', 4652',
4654', 4661', 4666' w/1 SPI
Swbd small amt gas & oil (4630-66')
3-15-71 TD 4815'; PBD 4750'; SI PBU
Acid (4630-4730') 2500 gals
3-23-71 TD 4815'; PBD 4750'; Prep Frac
3-29-71 TD 4815'; PBD 4750'; Swbg Load
Frac (4630-4730') 15,000 gals wtr + 15,000# sd
4-5-71 TD 4815'; PBD 4750'; Tstg
4-12-71 TD 4815'; PBD 4750'; WO Potential
CAOF 2320 MCFGPD, SIWHP 1350#

4-26-71 TD 4815'; PBD 4750'; COMPLETE
(San Andres) FOUR POINT GAUGES:
Flwd 788 MCFGPD, 1.25" orifice, 1 hr, TP 1040#
Flwd 1054 MCFGPD, 1.25" orifice, 1 hr, TP 935#
Flwd 1233 MCFGPD, 1.25" orifice, 1 hr, TP 855#
Flwd 1512 MCFGPD, 1.25" orifice, 1 hr, TP 720#
LOG TOPS: Yates 2700', San Andres 3912'
San Andres Discovery
4-29-71 COMPLETION REPORTED

**NEW MEXICO OIL CONSERVATION COMMISSION
WELL LOCATION AND ACREAGE DEDICATION PLAT**

Form C-102
Supersedes C-128
Effective 1-1-65

All distances must be from the outer boundaries of the Section.

Operator Tom L. Ingram		Lease Light		Well No. 1
Unit Letter 1	Section 15	Township 8 South	Range 37 East	County Roosevelt
Actual Footage Location of Well:				
1980	feet from the South	line and 660	feet from the East	line
Ground Level Elev 4011.3	Producing Formation San Andres	Pool Bluitt-San Andres Assoc.	Dedicated Acreage: 320 Acres	

1. Outline the acreage dedicated to the subject well by colored pencil or hatchure marks on the plat below.
2. If more than one lease is dedicated to the well, outline each and identify the ownership thereof (both as to working interest and royalty).
3. If more than one lease of different ownership is dedicated to the well, have the interests of all owners been consolidated by communitization, unitization, force-pooling, etc?

☒ Yes ☐ No If answer is "yes," type of consolidation Communitization Agreement

If answer is "no," list the owners and tract descriptions which have actually been consolidated. (Use reverse side of this form if necessary.) _____

No allowable will be assigned to the well until all interests have been consolidated (by communitization, unitization, forced-pooling, or otherwise) or until a non-standard unit, eliminating such interests, has been approved by the Commission.

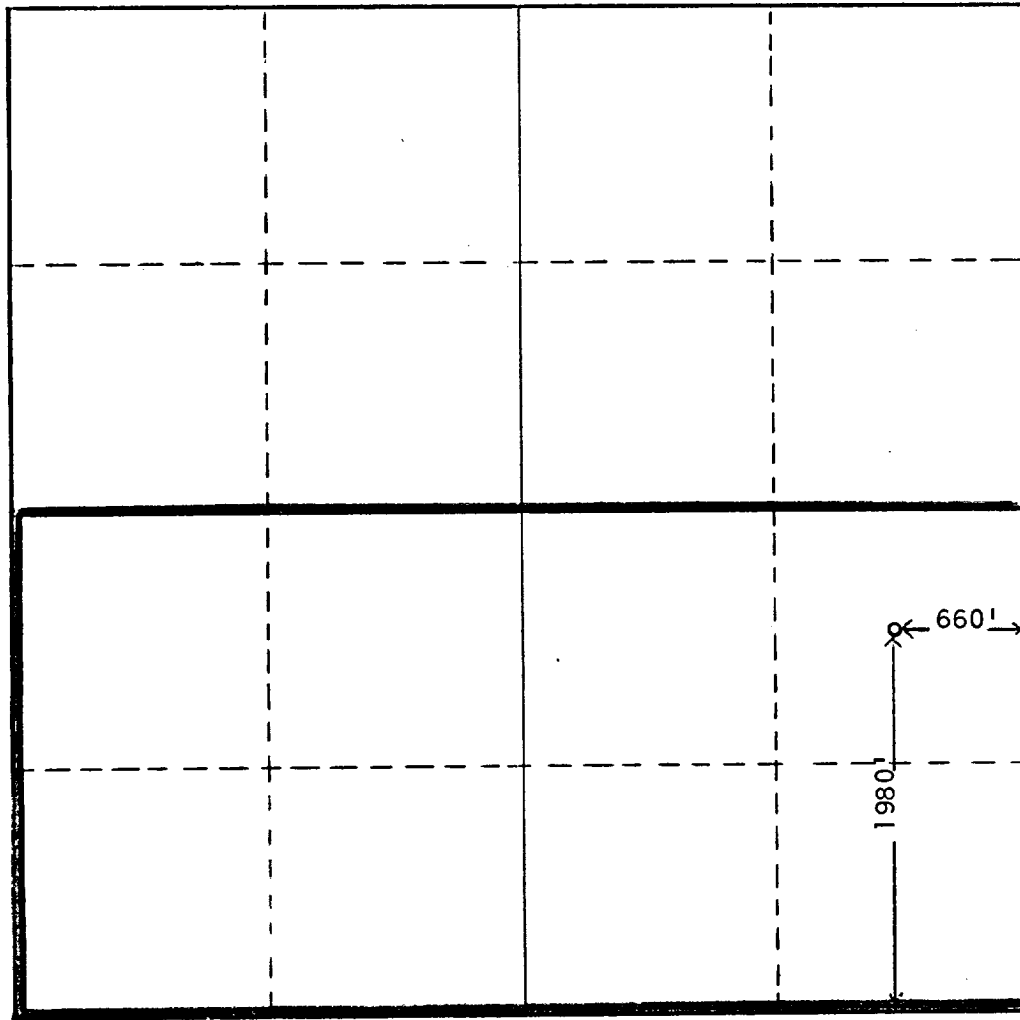

CERTIFICATION

I hereby certify that the information contained herein is true and complete to the best of my knowledge and belief.

Name

Position

Company

Date

Clerk

Tom L. Ingram

11/1/71

REVISED

I hereby certify that the well location shown on this plat was plotted from field notes of actual surveys made by me or under my supervision, and that the same is true and correct to the best of my knowledge and belief.

Date Surveyed

Registered Professional Engineer
and/or Land Surveyor

Certificate No.

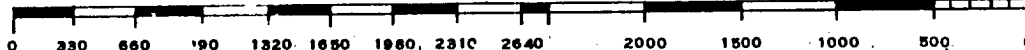

RECEIVED

FEB 21 1971

OIL CONSERVATION COMM.
HOBBS, L. L.

NEW MEXICO OIL CONSERVATION COMMISSION
WELL LOCATION AND ACREAGE DEDICATION PLAT

Form C-102
Supersedes C-101
Effective 1-1-65

All distances must be from the outer boundaries of the Section.

Operator TOM L. INGRAM			Lease LIGHT			Well No. 1
Unit Letter I	Section 15	Township 8 SOUTH	Range 37 EAST	County ROOSEVELT		
Actual Footage Location of Well: 1980 feet from the SOUTH line and 660 feet from the EAST line						
Ground Level Elev. 4011.3	Producing Formation SAN ANDRES		Pool Bluitt-San Andres, Assoc.		Dedicated Acreage: 40X 320	

1. Outline the acreage dedicated to the subject well by colored pencil or hachure marks on the plat below.
2. If more than one lease is dedicated to the well, outline each and identify the ownership thereof (both as to working interest and royalty).
3. If more than one lease of different ownership is dedicated to the well, have the interests of all owners been consolidated by communitization, unitization, force-pooling, etc?

☒ Yes ☐ No If answer is "yes," type of consolidation Communitization Agreement

If answer is "no," list the owners and tract descriptions which have actually been consolidated. (Use reverse side of this form if necessary.)

No allowable will be assigned to the well until all interests have been consolidated (by communitization, unitization, forced-pooling, or otherwise) or until a non-standard unit, eliminating such interests, has been approved by the Commission.

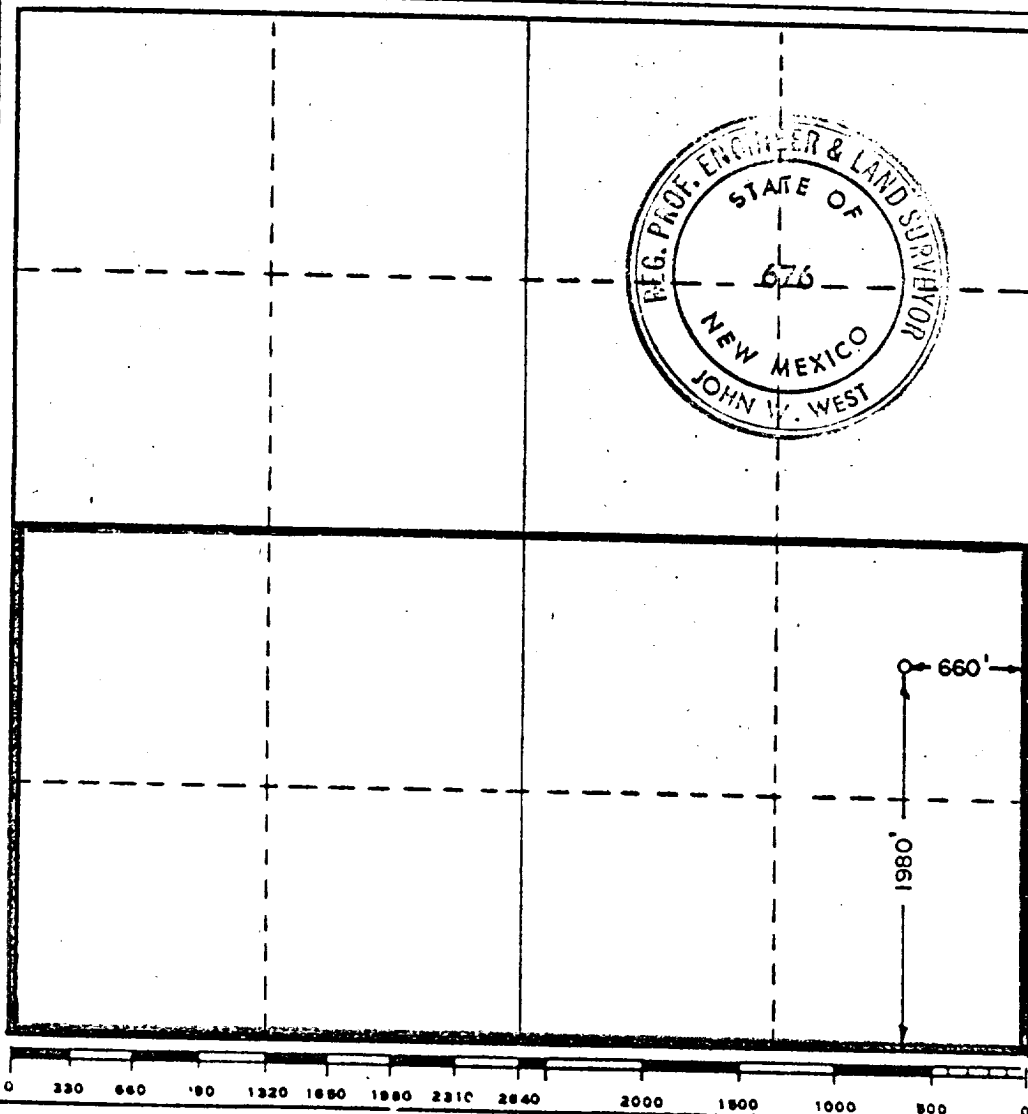

CERTIFICATION

I hereby certify that the information contained herein is true and complete to the best of my knowledge and belief.

Name John W. West
Position AGENT
Company TOM L. INGRAM
Date 1-28-1971

Amended July 1, 1971

I hereby certify that the well location shown on this plat was plotted from field notes of actual surveys made by me or under my supervision, and that the same is true and correct to the best of my knowledge and belief.

Date Surveyed 1-28-1971
Registered Professional Engineer and/or Land Surveyor
John W. West
Certificate No. 676