

UNITED STATES
DEPARTMENT OF THE INTERIOR
GEOLOGICAL SURVEY

APPLICATION FOR PERMIT TO DRILL, DEEPEN, OR PLUG BACK

1a. TYPE OF WORK

DRILL ☒DEEPEN ☐PLUG BACK ☐

b. TYPE OF WELL

OIL
WELL ☒GAS
WELL ☐

OTHER

SINGLE
ZONE ☒MULTIPLE
ZONE ☐

2. NAME OF OPERATOR

TEXACO, INC. 2 Mr. Darrell Smith

3. ADDRESS OF OPERATOR

P. O. Box 3109 Midland, Texas 79701

4. LOCATION OF WELL (Report location clearly and in accordance with any State requirements.)*

At surface 1980' FSL & 1980' FEL, Sec. 21

At proposed prod. zone Same

14. DISTANCE IN MILES AND DIRECTION FROM NEAREST TOWN OR POST OFFICE*

3 miles NW of Milnesand, New Mexico

15. DISTANCE FROM PROPOSED*

LOCATION TO NEAREST
PROPERTY OR LEASE LINE, FT.
(Also to nearest drlg. unit line, if any)

660'

18. DISTANCE FROM PROPOSED LOCATION*

TO NEAREST WELL, DRILLING COMPLETED,
OR APPLIED FOR, ON THIS LEASE, FT.

1st Well

16. NO. OF ACRES IN LEASE

320

19. PROPOSED DEPTH

7665'

17. NO. OF ACRES ASSIGNED
TO THIS WELL

40

20. ROTARY OR CABLE TOOLS

Rotary

21. ELEVATIONS (Show whether DF, RT, GR, etc.)

Gr. 4218

22. APPROX. DATE WORK WILL START*

At once

23.

PROPOSED CASING AND CEMENTING PROGRAM

SIZE OF HOLE	SIZE OF CASING	WEIGHT PER FOOT	SETTING DEPTH	QUANTITY OF CEMENT
15'	11 3/4"	42	350'	*380 sx (300% to circulate)
11"	8 5/8"	24.32	4800'	**300 sx (not required to circ.)
7 7/8"	4 1/2"	9.5, 10.5, 11.6	7665'	***650 sx (150% to tieback)

- * 380 sx Class "C" w/1% Ca Cl₂, 14.8 ppg. (300 % to circulate) cmt. must circulate.
** 300 sx Class "C" w/10% salt/sk & 1/4% floccle per sx, 15 ppg. (not required to circulate)
*** 450 sx TLW, 12 ppg followed by 200 sx Chem. Comp. expanding cmt. w/2% DSR
(150 % to tie back-not required)

COMPLETION PROGRAM

1. Perf Wolfcamp pay. 2. Acidize w/1000 gals, 15% NEA @ 1000 psi & overflush w/2 bbls.
treated fresh water. 3. Swab back load & Test.

FORMATION TOPS EXPECTED

San Andres	3450'	Wc. B' Zone	7520
Wc. A' Zone	7410'	Total Depth	7665

IN ABOVE SPACE DESCRIBE PROPOSED PROGRAM: If proposal is to deepen or plug back, give data on present productive zone and proposed new productive zone. If proposal is to drill or deepen directionally, give pertinent data on subsurface locations and measured and true vertical depths. Give blowout preventer program, if any.

24.

SIGNED

J. J. Veltun

TITLE

Division Civil Engineer

DATE

March 9, 1971

(This space for Federal or State office use)

PERMIT NO.

APPROVAL DATE

APPROVED BY

TITLE

CONDITIONS OF APPROVAL, IF ANY:

APPROVED

MAR 10 1971

ARTHUR R. BROWN
DISTRICT ENGINEER

*See Instructions On Reverse Side

NEW MEXICO OIL CONSERVATION COMMISSION
WELL LOCATION AND ACREAGE DEDICATION PLAT

Form C-102
Supersedes C-128
Effective 1-1-65

All distances must be from the outer boundaries of the Section.

Operator TEXACO Inc.		Lease H. E. Roelofs - Federal NCT-1		Well No. 1
Unit Letter J	Section 21	Township 7-South	Range 35-East	County Roosevelt
Actual Footage Location of Well: 1980 feet from the South line on 1980 feet from the East line Sec. 21				
Ground Level Elev. 4218'	Producing Formation Wolfcamp "A"	Pool Todd, Wolfcamp	Dedicated Acreage 40 Acres	

1. Outline the acreage dedicated to the subject well by colored pencil or hachure marks on the plat below.
2. If more than one lease is dedicated to the well, outline each and identify the ownership thereof (both as to working interest and royalty).
3. If more than one lease of different ownership is dedicated to the well, have the interests of all owners been consolidated by communitization, unitization, force-pooling, etc?

☐ Yes ☐ No If answer is "yes," type of consolidation _____

If answer is "no," list the owners and tract descriptions which have actually been consolidated. (Use reverse side of this form if necessary.) _____

No allowable will be assigned to the well until all interests have been consolidated (by communitization, unitization, forced-pooling, or otherwise) or until a non-standard unit, eliminating such interests, has been approved by the Commission.

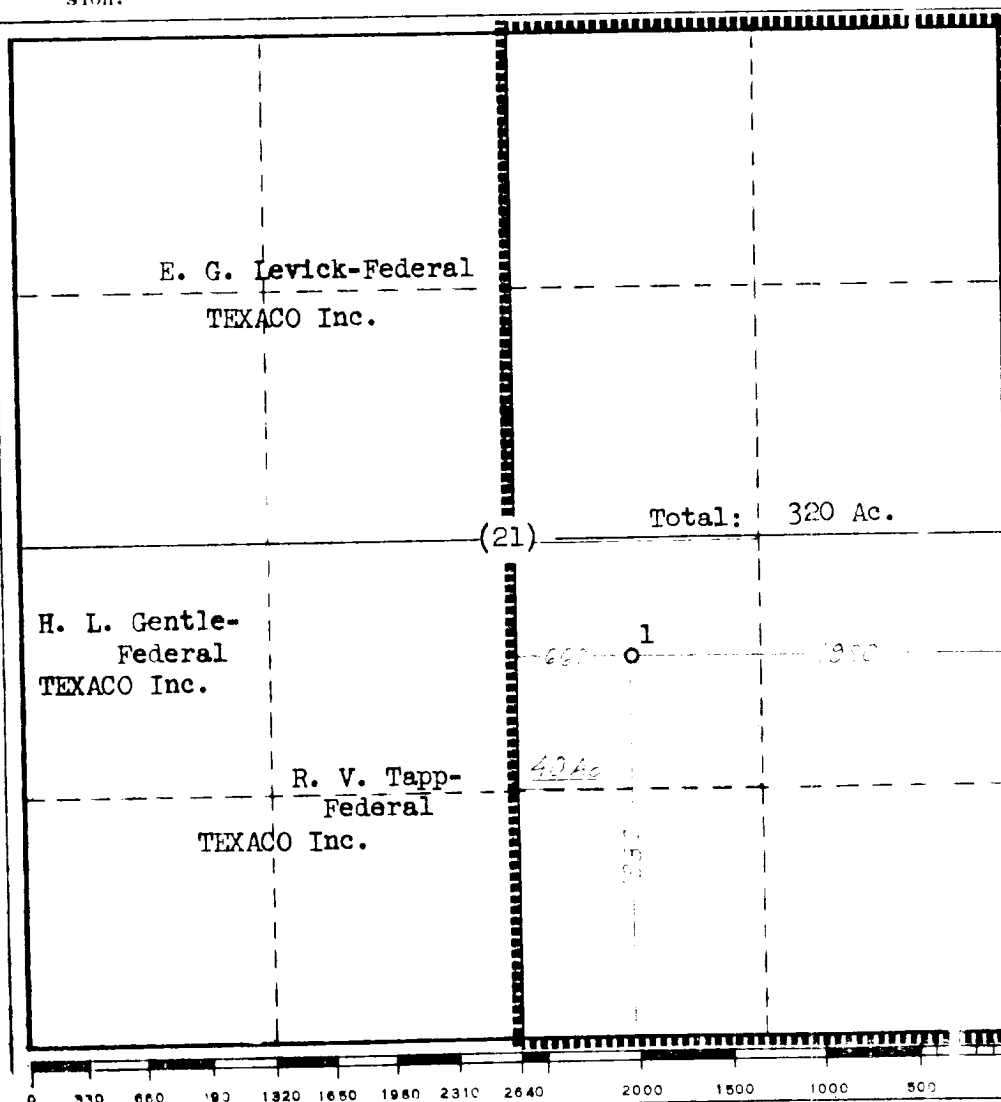

CERTIFICATION

I hereby certify that the information contained herein is true and complete to the best of my knowledge and belief.

Name

J. J. Velten

Position

Division Civil Engineer

Company

TEXACO Inc.

Date

3/9/71

I hereby certify that the well location shown on this plat was plotted from field notes of actual surveys made by me or under my supervision, and that the same is true and correct to the best of my knowledge and belief.

Date Surveyed

3/2/71

Registered Professional Engineer and/or Land Surveyor

J. J. Velten

Certificate No.

8174