

NO. OF COPIES RECEIVED	
DISTRIBUTION	
SANTA FE	
FILE	
U.S.G.S.	
LAND OFFICE	
OPERATOR	

NEW MEXICO OIL CONSERVATION COMMISSION

Form C-101
Revised 1-1-65

5A. Indicate Type of Lease	
STATE <input type="checkbox"/>	FEE <input checked="" type="checkbox"/>
5. State Oil & Gas Lease No.	

APPLICATION FOR PERMIT TO DRILL, DEEPEN, OR PLUG BACK

1a. Type of Work		7. Unit Agreement Name	
b. Type of Well OIL WELL <input checked="" type="checkbox"/> GAS WELL <input type="checkbox"/> OTHER <input type="checkbox"/>		8. Farm or Lease Name McGrail	
2. Name of Operator Union Oil Company of California		9. Well No. 1	
3. Address of Operator P. O. Box 671 - Midland, Texas 79701		10. Field and Pool, or Wildcat Bluitt San Andres Assoc.	
4. Location of Well UNIT LETTER H LOCATED 2130' FEET FROM THE North LINE AND 660 FEET FROM THE East LINE OF SEC. 18 TWP. 8-S RGE. 38-E NMPM		12. County Roosevelt	
19. Proposed Depth 4850'		19A. Formation San Andres	
20. Rotary or C.T. Rotary		21. Elevations (Show whether DF, RT, etc.) 3986.8 CR	
21A. Kind & Status Plug. Bond Blanket		21B. Drilling Contractor Unknown at Present	
22. Approx. Date Work will start On Approval			

PROPOSED CASING AND CEMENT PROGRAM

SIZE OF HOLE	SIZE OF CASING	WEIGHT PER FOOT	SETTING DEPTH	SACKS OF CEMENT	EST. TOP
11"	8-5/8"	24#	330'	175	Circ. to Surface
7-7/8"	4-1/2"	9.5#	4850'	300	2630'

3000# Manual BOP

8 3/4

8-20-71

IN ABOVE SPACE DESCRIBE PROPOSED PROGRAM; IF PROPOSAL IS TO DEEPEN OR PLUG BACK, GIVE DATA ON PRESENT PRODUCTIVE ZONE AND PROPOSED NEW PRODUCTIVE ZONE. GIVE BLOWOUT PREVENTER PROGRAM, IF ANY.

I hereby certify that the information above is true and complete to the best of my knowledge and belief.

Signed J. R. Gray J. R. Gray Title District Drilling Supt. Date 5-18-71

(This space for State Use)

APPROVED BY [Signature] TITLE SUPERVISOR DISTRICT 1 DATE MAY 20 1971

CONDITIONS OF APPROVAL, IF ANY:

**NEW MEXICO OIL CONSERVATION COMMISSION
WELL LOCATION AND ACREAGE DEDICATION PLAT**

Form C-102
Supersedes C-128
Effective 1-1-65

All distances must be from the outer boundaries of the Section.

Operator UNION OIL COMPANY OF CALIFORNIA			Lease MCGRAIL		Well No. 1
Unit Letter H	Section 18	Township 8 SOUTH	Range 38 EAST	County ROOSEVELT	
Actual Footage Location of Well: 2130 feet from the NORTH line and 660 feet from the EAST line					
Ground Level Elev. 3786.8	Producing Formation San Andres		Pool Bluitt San Andres Assoc.		Dedicated Acreage: 80 Acres

1. Outline the acreage dedicated to the subject well by colored pencil or hachure marks on the plat below.
2. If more than one lease is dedicated to the well, outline each and identify the ownership thereof (both as to working interest and royalty).
3. If more than one lease of different ownership is dedicated to the well, have the interests of all owners been consolidated by communitization, unitization, force-pooling, etc?

☐ Yes ☐ No If answer is "yes," type of consolidation _____

If answer is "no," list the owners and tract descriptions which have actually been consolidated. (Use reverse side of this form if necessary.) _____

No allowable will be assigned to the well until all interests have been consolidated (by communitization, unitization, forced-pooling, or otherwise) or until a non-standard unit, eliminating such interests, has been approved by the Commission.

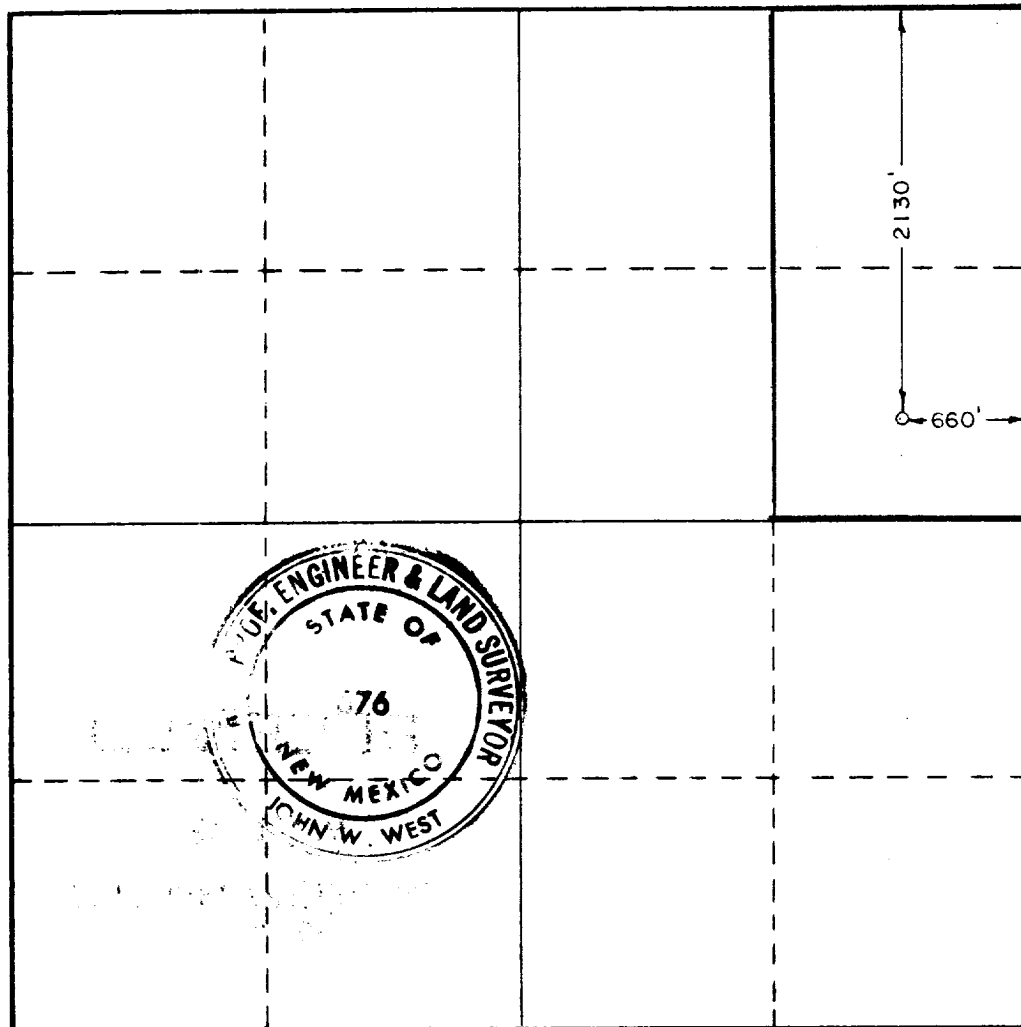

CERTIFICATION

I hereby certify that the information contained herein is true and complete to the best of my knowledge and belief.

Name _____
 Position _____
District Drilling Supt.
 Company _____
Union Oil Company of Calif.
 Date _____
May 18, 1971

I hereby certify that the well location shown on this plat was plotted from field notes of actual surveys made by me or under my supervision, and that the same is true and correct to the best of my knowledge and belief.

Date Surveyed
MAY 15, 1971

Registered Professional Engineer
 and/or Land Surveyor

John W. West
 Certificate No. **676**

