

NO. OF COPIES RECEIVED	
DISTRIBUTION	
SANTA FE	
FILE	
U.S.G.S.	
LAND OFFICE	
OPERATOR	

NEW MEXICO OIL CONSERVATION COMMISSION

Form C-101
Revised 1-1-65 *31 141-7212*

5A. Indicate Type of Lease	
STATE <input type="checkbox"/>	FEE <input checked="" type="checkbox"/>
5. State Oil & Gas Lease No.	
7. Unit Agreement Name	
8. Farm or Lease Name Beisel	
9. Well No. 1	
10. Field and Pool, or Wildcat Bluitt San Andres	
12. County Roosevelt	
19. Proposed Depth 4,800'	19A. Formation San Andres
20. Rotary or C.T. Rotary	
21. Elevations (Show whether DF, RT, etc.) 3980.8' GR	21A. Kind & Status Plug. Bond
21B. Drilling Contractor Sitton & Norton	
22. Approx. Date Work will start October 25, 1972	

APPLICATION FOR PERMIT TO DRILL, DEEPEN, OR PLUG BACK	
1a. Type of Work	
b. Type of Well DRILL <input checked="" type="checkbox"/> DEEPEN <input type="checkbox"/> PLUG BACK <input type="checkbox"/> OIL WELL <input checked="" type="checkbox"/> GAS WELL <input type="checkbox"/> OTHER <input type="checkbox"/> SINGLE ZONE <input type="checkbox"/> MULTIPLE ZONE <input type="checkbox"/>	
2. Name of Operator Century Petroleum Co., Inc. & Ted Weiner Oil Properties	
3. Address of Operator 1616 Oil & Gas Bldg., Fort Worth, Texas 76102	
4. Location of Well UNIT LETTER <u>A</u> LOCATED <u>660</u> FEET FROM THE <u>North</u> LINE AND <u>660</u> FEET FROM THE <u>East</u> LINE OF SEC. <u>7</u> TWP. <u>8-S</u> RGE. <u>38-E</u> NMPM	
23.	

PROPOSED CASING AND CEMENT PROGRAM

SIZE OF HOLE	SIZE OF CASING	WEIGHT PER FOOT	SETTING DEPTH	SACKS OF CEMENT	EST. TOP
10 3/4"	8 5/8"	20#	350'	300 sx. circulate	
7 7/8"	4 1/2 - 5 1/2	9.5#, 15.5#	4800'	250 sx.	

Proposed Operation:

1. Prepare location as shown on attached plat C-102
2. Drill 10 3/4" hole to 350'. Set 8 5/8" #40 20# casing and cement with 225 sx Class H cement with 2% Cacl. WOC 12 hrs.
3. Install 10" 900 Series Hydraulic operated Shaeffer BOP's W/4 1/2" pipe rams.
4. Drill 7 7/8" hole to TD 4800'. Set 4 1/2" K-55 9.5# casing and cement W/300 sx Class "C" preceded by 50 gal mud flush.

APPROVAL VALID
FOR 90 DAYS UNLESS
DRILLING COMMENCED,

EXPIRES 1-25-73

IN ABOVE SPACE DESCRIBE PROPOSED PROGRAM: IF PROPOSAL IS TO DEEPEN OR PLUG BACK, GIVE DATA ON PRESENT PRODUCTIVE ZONE AND PROPOSED NEW PRODUCTIVE ZONE. GIVE BLOWOUT PREVENTER PROGRAM, IF ANY.

I hereby certify that the information above is true and complete to the best of my knowledge and belief.

Signed B. L. Carls Title Petroleum Engineer General Partner Date October 19, 1972

APPROVED BY [Signature] TITLE SUPERVISOR DISTRICT I DATE OCT 25 1972

CONDITIONS OF APPROVAL, IF ANY:

RECEIVED

OCT 24 1972

OIL CONSERVATION COMM.
HOBBS, N. M.

**NEW MEXICO OIL CONSERVATION COMMISSION
WELL LOCATION AND ACREAGE DEDICATION PLAT**

Form C-102
Supersedes C-128
Effective 1-1-65

All distances must be from the outer boundaries of the Section.

Operator TED WEINER OIL PROPERTIES & CENTURY PETROLEUM LTD.			Lease BEISEL		Well No. 1
Unit Letter A	Section 7	Township 8 SOUTH	Range 38 EAST	County ROOSEVELT	
Actual Footage Location of Well: 660 feet from the NORTH line and 660 feet from the EAST line					
Ground Level Elev. 4004.1'	Producing Formation		Pool		Dedicated Acreage: Acres

1. Outline the acreage dedicated to the subject well by colored pencil or hachure marks on the plat below.
2. If more than one lease is dedicated to the well, outline each and identify the ownership thereof (both as to working interest and royalty).
3. If more than one lease of different ownership is dedicated to the well, have the interests of all owners been consolidated by communitization, unitization, force-pooling, etc?

☐ Yes ☐ No If answer is "yes," type of consolidation _____

If answer is "no," list the owners and tract descriptions which have actually been consolidated. (Use reverse side of this form if necessary.) _____

No allowable will be assigned to the well until all interests have been consolidated (by communitization, unitization, forced-pooling, or otherwise) or until a non-standard unit, eliminating such interests, has been approved by the Commission.

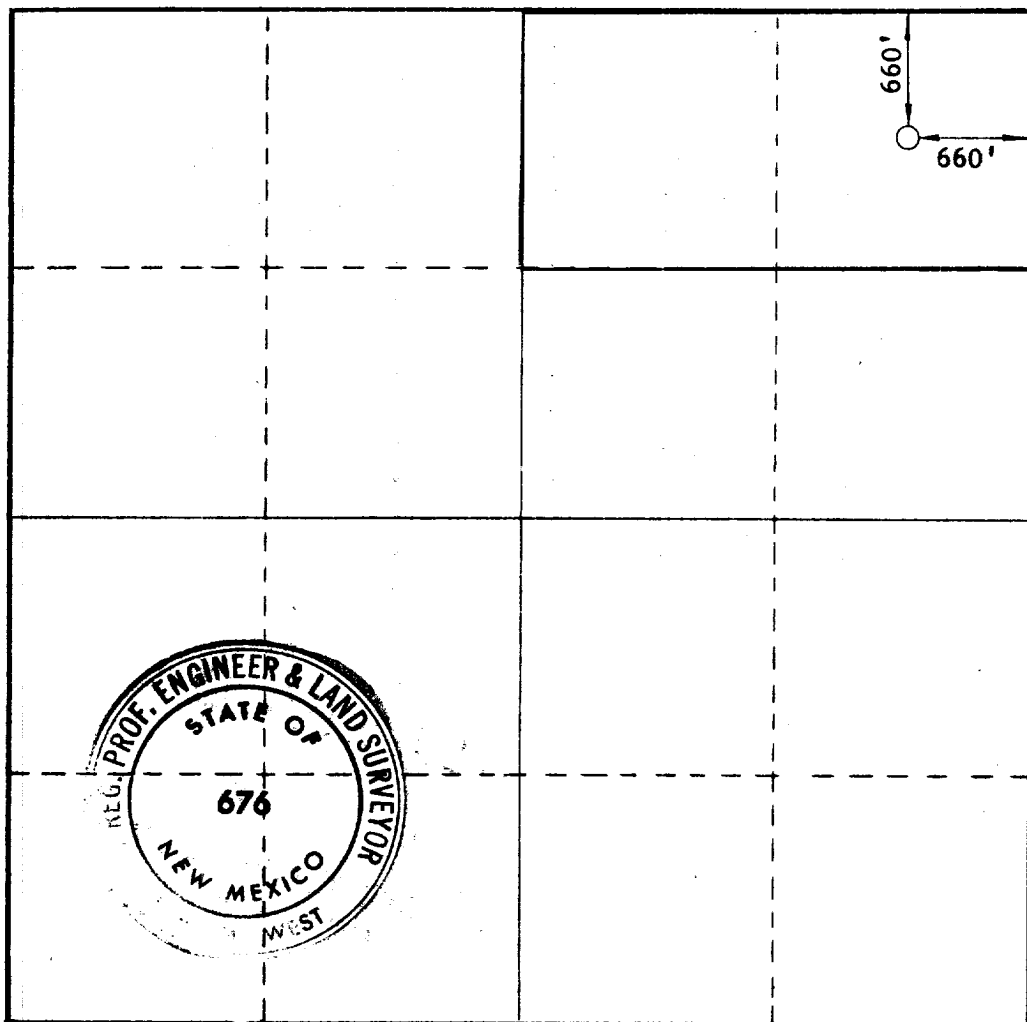

CERTIFICATION

I hereby certify that the information contained herein is true and complete to the best of my knowledge and belief.

Name *B. P. Carls*
Petroleum Engineer
Position
Century Petroleum Ltd.

Company
October 19, 1972

Date

I hereby certify that the well location shown on this plat was plotted from field notes of actual surveys made by me or under my supervision, and that the same is true and correct to the best of my knowledge and belief.

Date Surveyed
OCTOBER 17, 1972

Registered Professional Engineer
and/or Land Surveyor

John W. West
Certificate No. **676**

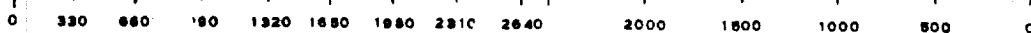



RECEIVED

001 24 1972

**OIL CONSERVATION COMM.
HOBBS, N. M.**