

NO. OF COPIES RECEIVED	
DISTRIBUTION	
SANTA FE	
FILE	
U.S.G.S.	
LAND OFFICE	
OPERATOR	

NEW MEXICO OIL CONSERVATION COMMISSION

Form C-103
Supersedes Old
C-102 and C-103
Effective 1-1-65

5a. Indicate Type of Lease	
State <input type="checkbox"/>	Fee <input checked="" type="checkbox"/>
5. State Oil & Gas Lease No.	

SUNDRY NOTICES AND REPORTS ON WELLS

(DO NOT USE THIS FORM FOR PROPOSALS TO DRILL OR TO DEEPEN OR PLUG BACK TO A DIFFERENT RESERVOIR.
USE "APPLICATION FOR PERMIT -" (FORM C-101) FOR SUCH PROPOSALS.)

1. <input checked="" type="checkbox"/> OIL WELL <input type="checkbox"/> GAS WELL <input type="checkbox"/> OTHER		7. Unit Agreement Name
2. Name of Operator Union Oil Company of California		8. Farm or Lease Name Tucker
3. Address of Operator P.O. Box 671 - Midland, Texas 79701		9. Well No. 1
4. Location of Well UNIT LETTER <u>D</u> , <u>660</u> FEET FROM THE <u>north</u> LINE AND <u>660</u> FEET FROM THE <u>west</u> LINE, SECTION <u>8</u> TOWNSHIP <u>7-S</u> RANGE <u>33-E</u> N.M.P.M.		10. Field and Pool, or Wildcat Wildcat
15. Elevation (Show whether DF, RT, GR, etc.) 4416' GR		12. County Roosevelt

16. Check Appropriate Box To Indicate Nature of Notice, Report or Other Data	
NOTICE OF INTENTION TO:	SUBSEQUENT REPORT OF:
PERFORM REMEDIAL WORK <input type="checkbox"/>	REMEDIAL WORK <input type="checkbox"/>
TEMPORARILY ABANDON <input type="checkbox"/>	COMMENCE DRILLING OPNS. <input type="checkbox"/>
PULL OR ALTER CASING <input type="checkbox"/>	CASING TEST AND CEMENT JOB <input type="checkbox"/>
OTHER <input type="checkbox"/>	OTHER <u>Spud & casing test</u> <input checked="" type="checkbox"/>
PLUG AND ABANDON <input type="checkbox"/>	ALTERING CASING <input type="checkbox"/>
CHANGE PLANS <input type="checkbox"/>	PLUG AND ABANDONMENT <input type="checkbox"/>

17. Describe Proposed or Completed Operations (Clearly state all pertinent details, and give pertinent dates, including estimated date of starting any proposed work) SEE RULE 1103.

Spudded 15" hole at 11:00 AM, 8-25-73 & drilled to 404'.
Ran & cemented 389' 11-3/4", 42#, H-40 casing at 404' with 325 sacks. Cement circulated to surface. Waited on cement 18 hours. Tested casing to 1000 psi for 30 minutes. OK.

18. I hereby certify that the information above is true and complete to the best of my knowledge and belief.

SIGNED Joe D. Ramo TITLE District Drilling Supt. DATE August 31, 1973

APPROVED BY Joe D. Ramo TITLE District Drilling Supt. DATE August 31, 1973
CONDITIONS OF APPROVAL, IF ANY:



LTR

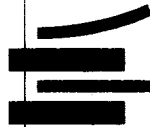

Job separation sheet

NO. OF COPIES RECEIVED	
DISTRIBUTION	
SANTA FE	
FILE	
U.S.G.S.	
LAND OFFICE	
OPERATOR	

NEW MEXICO OIL CONSERVATION COMMISSION

Form C-101
Revised 1-1-65

5A. Indicate Type of Lease	
STATE <input type="checkbox"/>	FEE <input checked="" type="checkbox"/>
5. State Oil & Gas Lease No.	

APPLICATION FOR PERMIT TO DRILL, DEEPEN, OR PLUG BACK

1a. Type of Work		7. Unit Agreement Name	
b. Type of Well OIL WELL <input checked="" type="checkbox"/> GAS WELL <input type="checkbox"/> OTHER <input type="checkbox"/>		8. Farm or Lease Name Tucker	
2. Name of Operator Union Oil Company of California		9. Well No. 1	
3. Address of Operator P.O. Box 671 - Midland, Texas 79701		10. Field and Pool, or Wildcat Wildcat	
4. Location of Well UNIT LETTER D LOCATED 660 FEET FROM THE north LINE AND 660 FEET FROM THE west LINE OF SEC. 8 TWP. 7-S RGE. 33-E NADPM		12. County Roosevelt	
18. Proposed Depth 9650'		19A. Formation Wolfcamp	
21A. Kind & Status Plug, Bond Blanket		20. Rotary or C.T. Rotary	
21. Elevations (Show whether DF, RT, etc.) 4416 GL		22. Approx. Date Work will start August 7, 1973	
21B. Drilling Contractor M-G-F Drilling Co., Inc			

23.

PROPOSED CASING AND CEMENT PROGRAM

SIZE OF HOLE	SIZE OF CASING	WEIGHT PER FOOT	SETTING DEPTH	SACKS OF CEMENT	EST. TOP
15"	11-3/4"	47#	400'	325 Circulated	
11"	8-5/8"	32#	4000'	500	1560'
7-7/8"	5 1/2"	17 & 15.5#	9650'	To be determined	from log

3000# manual & hydraulic B.O.P.

APPROVAL VALID
FOR 90 DAYS UNLESS
DRILLING COMMENCED,

EXPIRES 11-1-73

IN ABOVE SPACE DESCRIBE PROPOSED PROGRAM: IF PROPOSAL IS TO DEEPEN OR PLUG BACK, GIVE DATA ON PRESENT PRODUCTIVE ZONE AND PROPOSED NEW PRODUCTIVE ZONE. GIVE BLOWOUT PREVENTER PROGRAM, IF ANY.

I hereby certify that the information above is true and complete to the best of my knowledge and belief.

Signed T. G. Byron Title District Drilling Supt. Date July 30, 1973

(This space for State Use)

APPROVED BY [Signature] TITLE 573 DATE 11-1-73

CONDITIONS OF APPROVAL, IF ANY:

**NEW MEXICO OIL CONSERVATION COMMISSION
WELL LOCATION AND ACREAGE DEDICATION PL**

Form C-101
Supersedes C-128
Effective 1-1-65

All distances must be from the outer boundaries of the Section

Operator UNION OIL COMPANY OF CALIFORNIA			Lease Tucker		Well No. 1
Unit Letter D	Section 8	Township 7 South	Range 33 East	County Roosevelt	
Actual Footage Location of Well: 660 feet from the north line and 660 feet from the west line					
Ground Level Elev. 4416	Producing Formation Mississippian		Pool Wildcat	Dedicated Acreage: 40 Acres	

1. Outline the acreage dedicated to the subject well by colored pencil or hatchure marks on the plat below.
2. If more than one lease is dedicated to the well, outline each and identify the ownership thereof (both as to working interest and royalty).
3. If more than one lease of different ownership is dedicated to the well, have the interests of all owners been consolidated by communitization, unitization, force-pooling, etc?

☐ Yes ☐ No If answer is "yes," type of consolidation _____

If answer is "no," list the owners and tract descriptions which have actually been consolidated. (Use reverse side of this form if necessary.) _____

No allowable will be assigned to the well until all interests have been consolidated (by communitization, unitization, forced-pooling, or otherwise) or until a non-standard unit, eliminating such interests, has been approved by the Commission.

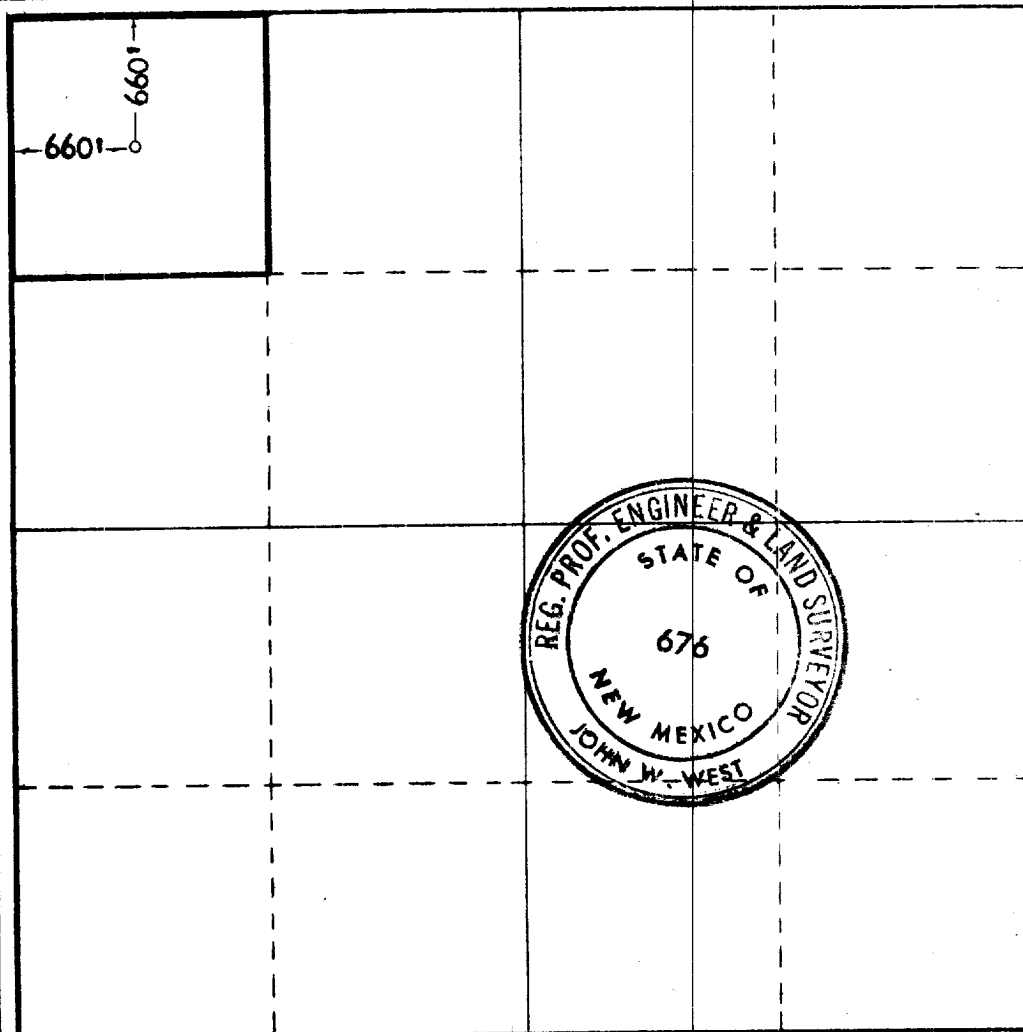

CERTIFICATION

I hereby certify that the information contained herein is true and complete to the best of my knowledge and belief.

Name *W.D. Byron*
 Position _____
District Drilling Supt.
 Company _____
Union Oil Co. of California
 Date _____
July 30, 1973

I hereby certify that the well location shown on this plat was plotted from field notes of actual surveys made by me or under my supervision, and that the same is true and correct to the best of my knowledge and belief.

Date Surveyed
July 25, 1973
 Registered Professional Engineer and/or Land Surveyor
John W. West
 Certificate No. **676**

0 330 660 990 1320 1650 1980 2310 2640 2970 3300 3630 3960 4290 4620 4950 5280 5610 5940 6270 6600

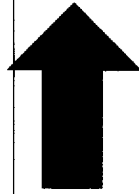

LTR

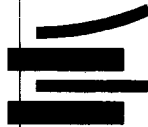

Job separation sheet

STATE NM

API 30-041-20379

SERIAL

MAP

CO-ORD

CLASS

ELEV.

L & S

FORMATION

DATUM

FORMATION

DATUM

TD 9680

PBD

TYPE RT

F.R. 8-13-73

(Wolfcamp)

Drlg 402'

Dr1g 1425'

TD 5074'; WOC

Dr lg 8' 79' 1m, sh & cht

Dr 1g 9251' 1m

TD 9680'; Prep DST

TD 9680¹; WOO

DST 9500-9680', open 4 hrs, rec 90' GCM +

407° 0 + 3950° G+MCS1tWtr, 30 min ISIP

3448#, FP 283-815#, 4 hr FSIP 3494#, HP NR

TD 9680⁹ : Prep Swb

Perf 9522-27', w/12 shots (overall)

TD 9680'; Prep PB to San Andres
Acid (9522-27') 2500 gals
Swbd 68 BF in 10 hrs (90% W + 10% O)
Perf 9320-30' w/22 shots (overall)
Acid (9320-30') 250 gals
Swbd 68 BW in 24 hrs (9320-30')
10-29-73 TD 9680'; PB 3967'; WOCU
PB to 3967' (San Andres)
11-5-73 TD 9680'; OB 3967'; Tstg
Perf 3885-3948' w/35 shots (overall)
Acid (3885-3948') 3250 gals
11-12-73 TD 9680'; PLUGGED & ABANDONED
LOG TOPS: San Andres 4428', Tubb 6181', Abo
6995', Waco 7918', Three Fingers 8210',

11-17-73 Canyon 8715', Strawn 9197', Mississippian
Lime 9602'
COMPLETION REPORTED