



Casing perms. \_\_\_\_\_ Bottom choke \_\_\_\_\_ Surf. temp. \_\_\_\_\_ °F Ticket No. **253257**  
 Gas gravity \_\_\_\_\_ Oil gravity \_\_\_\_\_ GOR \_\_\_\_\_  
 Spec. gravity \_\_\_\_\_ Chlorides \_\_\_\_\_ ppm Res. \_\_\_\_\_ @ \_\_\_\_\_ °F

INDICATE TYPE AND SIZE OF GAS MEASURING DEVICE USED \_\_\_\_\_

Date Time	a.m. p.m.	Choke Size	Surface Pressure psi	Gas Rate MCF	Liquid Rate BPD	Remarks
0115						Opened tool with a good blow.
0120						5 minutes into initial flow- strong blow.
0125			1#			10 minutes " " " 1# bubble hose
0130		3/8"	1/2			blow. 15 " " " "
0135			1/2			20 " " " "
0140			1/2			25 " " " "
0145			1/2			30 " " " "
0245			1/2			Closed tool. Tool reopened with gas to the surface.
0250			1			5 minutes into final flow.
0255			3			10 minutes.
0300			0			15 minutes.
0305			0			20 minutes.
0315			0			30 minutes.
0330			0			45 minutes.
0345			0			60 minutes.
0400			0			75 minutes.
0415			0			90 minutes
0430			0			105 minutes.
0445			0			Closed tool for the second closed in pressure.
0745						Bypassed tool.
						Pulled 23 stands -1426' - well unloaded
						drill pipe - dropped bar - put on Kelly
						and circulated..

Gauge No.		512		Depth		4097'		Clock No.		16710		24 hour		Ticket No.		253257	
First Flow Period		First Closed In Pressure		Second Flow Period		Second Closed In Pressure		Third Flow Period		Third Closed In Pressure		Third Flow Period		Third Closed In Pressure		Third Flow Period	
Time Defl. .000"	PSIG Temp. Corr.	Time Defl. .000"	Log $t \pm \theta$	PSIG Temp. Corr.	Time Defl. .000"	Log $t \pm \theta$	PSIG Temp. Corr.	Time Defl. .000"	Log $t \pm \theta$	PSIG Temp. Corr.	Time Defl. .000"	Log $t \pm \theta$	PSIG Temp. Corr.	Time Defl. .000"	Log $t \pm \theta$	PSIG Temp. Corr.	Time Defl. .000"
0	.000	83	.000	286	.000	.000	379	.000	.000	691	.000	.000	691	.000	.000		
1	.0175	150	.0198	552	.0635	.0400	374*	.0400	.0400	1164	.0400	.0400	1164	.0400	.0400		
2	.0350	238	.0396	856	.1304	.0800	443	.0800	.0800	1211	.0800	.0800	1211	.0800	.0800		
3	.0525	278	.0594	1102	.1973	.1200	513	.1200	.1200	1226	.1200	.1200	1226	.1200	.1200		
4	.0700	261	.0792	1177	.2642	.1600	576	.1600	.1600	1232	.1600	.1600	1232	.1600	.1600		
5	.0875	274	.0990	1207	.3311	.2000	636	.2000	.2000	1239	.2000	.2000	1239	.2000	.2000		
6	.1050	286	.1188	1224	.3980	.2400	691	.2400	.2400	1240	.2400	.2400	1240	.2400	.2400		
7			.1386	1231		.2800		.2800	.2800	1241		.2800	1241		.2800		
8			.1584	1239		.3200		.3200	.3200	1243		.3200	1243		.3200		
9			.1782	1244		.3600		.3600	.3600	1244		.3600	1244		.3600		
10			.1980	1245		.4000		.4000	.4000	1245		.4000	1245		.4000		
11						.4400		.4400	.4400	1245		.4400	1245		.4400		
12						.4800		.4800	.4800	1247		.4800	1247		.4800		
13						.5200		.5200	.5200	1247		.5200	1247		.5200		
14						.5600		.5600	.5600	1247		.5600	1247		.5600		
15						.6000		.6000	.6000	1247		.6000	1247		.6000		

Gauge No.		113		Depth		4201'		Clock No.		13736		hour		24	
Time Defl. .000"	PSIG Temp. Corr.	Time Defl. .000"	Log $t \pm \theta$	PSIG Temp. Corr.	Time Defl. .000"	Log $t \pm \theta$	PSIG Temp. Corr.	Time Defl. .000"	Log $t \pm \theta$	PSIG Temp. Corr.	Time Defl. .000"	Log $t \pm \theta$	PSIG Temp. Corr.	Time Defl. .000"	Log $t \pm \theta$
0	.000	141	.000	317	.000	.000	374	.000	.000	747	.000	.000	747	.000	.000
1	.0170	216	.0203	577	.0640	.0405	414*	.0405	.0405	1216	.0405	.0405	1216	.0405	.0405
2	.0340	292	.0406	891	.1314	.0801	493	.0801	.0801	1263	.0801	.0801	1263	.0801	.0801
3	.0510	313	.0609	1146	.1988	.1214	566	.1214	.1214	1279	.1214	.1214	1279	.1214	.1214
4	.0680	290	.0812	1224	.2662	.1619	630	.1619	.1619	1285	.1619	.1619	1285	.1619	.1619
5	.0850	305	.1015	1255	.3336	.2023	692	.2023	.2023	1289	.2023	.2023	1289	.2023	.2023
6	.1020	317	.1218	1268	.4010	.2428	747	.2428	.2428	1290	.2428	.2428	1290	.2428	.2428
7			.1421	1277		.2833		.2833	.2833	1293		.2833	1293		.2833
8			.1624	1285		.3237		.3237	.3237	1294		.3237	1294		.3237
9			.1827	1290		.3642		.3642	.3642	1297		.3642	1297		.3642
10			.2030	1292		.4047		.4047	.4047	1298		.4047	1298		.4047
11						.4451		.4451	.4451	1298		.4451	1298		.4451
12						.4856		.4856	.4856	1300		.4856	1300		.4856
13						.5261		.5261	.5261	1300		.5261	1300		.5261
14						.5665		.5665	.5665	1301		.5665	1301		.5665
15						.6070		.6070	.6070	1302		.6070	1302		.6070

Reading Interval 5      6      20      12      Minutes

REMARKS: \* INTERVAL = 19 MINUTES.

	O. D.	I. D.	LENGTH	DEPTH
Drill Pipe or Tubing				
Reversing Sub	6"	3.50"	1'	
Water Cushion Valve				
Drill Pipe 4 1/2" XH	4 1/2"	3.826"	3542'	
Drill Collars 4 1/2" XH	6"-6 1/2"	2.25"	538'	
Handling Sub & Choke Assembly				
Dual CIP Valve	5"	.87"	5'	4091'
Dual CIP Sampler				
Hydro-Spring Tester	5"	.75"	5'	4095'
Multiple CIP Sampler				
Extension Joint				
AP Running Case	5"	3.25"	5'	4097'
Hydraulic Jar	5"	1.75"	5'	
VR Safety Joint	5"	1.00"	3'	
Pressure Equalizing Crossover				
Packer Assembly				
Distributor				
Packer Assembly				
Flush Joint Anchor				
Pressure Equalizing Tube				
Blanked-Off B.T. Running Case				
Drill Collars				
Anchor Pipe Safety Joint				
Packer Assembly	6 3/4"	1.50"	6'	4109'
Distributor				
Packer Assembly	6 3/4"	1.50"	6'	4115'
Anchor Pipe Safety Joint				
Side Wall Anchor				
Drill Collars	6 1/2"	2.25"	58'	
Flush Joint Anchor	5 3/4"	2.25"	20'	
Blanked-Off B.T. Running Case	5 3/4"	-	5'	4201'
Total Depth				4205'

District I  
1625 N. French Dr., Hobbs, NM 88240

State of New Mexico  
Energy, Minerals & Natural Resources

Form C-104  
Revised March 25, 1999

District II  
811 South First, Artesia, NM 88210

OIL CONSERVATION DIVISION

Submit to Appropriate District Office

District III  
1000 Rio Brazos Rd., Aztec, NM 87410

2040 South Pacheco  
Santa Fe, NM 87505

5 Copies

District IV  
2040 South Pacheco, Santa Fe, NM 87505

☐ Amended Report

I. REQUEST FOR ALLOWABLE AND AUTHORIZATION TO TRANSPORT

1 Operator Name and Address UHC New Mexico Corporation P.O. Box 1956 Cleburne, Texas 76033		2 OGRID Number 183718
		3 Reason for Filing Code CH EFFECTIVE 06/01/99
4 API Number 30 - 0 41-20440	5 Pool Name Tomahawk San Andres	6 Pool Code 59469
7 Property Code 17857 24917	8 Property Name Cone Federal	9 Well Number 2

II. Surface Location

UI or Lot No. C	Section 31	Township 7S	Range 32E	Lot Id	Feet from the 660	North/South Line North	Feet from the 1980	East/West Line West	County Roosevelt
--------------------	---------------	----------------	--------------	--------	----------------------	---------------------------	-----------------------	------------------------	---------------------

11 Bottom Hole Location

UI or Lot No.	Section	Township	Range	Lot Id	Feet from the	North/South Line	Feet from the	East/West Line	County
12 Lse Code F	13 Producing Method Code P	14 Gas Connection Date	15 C-129 Permit Number	16 C-129 Effective Date	17 C-129 Expiration Date				

III. Oil and Gas Transporters

18 Transporter OGRID	19 Transporter Name and Address	20 POD	21 O/G	22 POD ULSTR Location and Desc
020445	Scurlock Permian Corporation P.O. Box 4648, Houston, Texas 77210	1954710 2807543	O	A-31-7S-32E
024850	Warren Petroleum Corporation P.O. Box 1589, Tulsa, Oklahoma 74102	2807544	G	A-31-7S-32E
024650	Dynegy Midstream LTD PIR 6100 E. Dr. Ste 3300 Midland, TX 79705	1954730	G	

IV. Produced Water

23 POD 1954750	24 POD ULSTR Location and Description P-30-7S-32E
-------------------	--

V. Well Completion Data

25 Spud Date	26 Ready Date	27 TD	28 PBTD	29 Perforations	30 DHC, MC
31 Hole Size	32 Casing & Tubing Size	33 Depth Set	34 Sacks Cement		

VI. Well Test Data

35 Date New Oil	36 Gas Delivery Date	37 Test Date	38 Test Length	39 Tbg Pressure	40 Csg Pressure
41 Choke Size	42 Oil	43 Water	44 Gas	45 AOF	46 Test Method

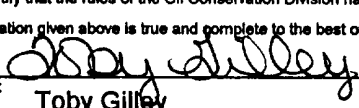
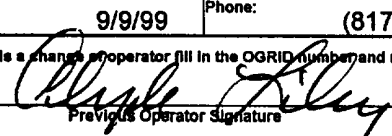
47 I hereby certify that the rules of the Oil Conservation Division have been complied with and that the information given above is true and complete to the best of my knowledge and belief. Signature:  Printed Name: Toby Gilley Title: Agent Date: 9/9/99 Phone: (817) 477-5324		<b>OIL CONSERVATION DIVISION</b> Approved By: ORIGINAL SIGNED BY CHRIS WILLIAMS DISTRICT I SUPERVISOR Title: Approval Date: OCT 14 1999	
48 If this is a change of operator fill in the OGRID number and name of the previous operator.  Previous Operator Signature 148869 Sierra Blanca Operating Company		Clyde Liley Printed Name President Title Date	



District I  
PO Box 1900, Hobbs, NM 88241-1900  
District II  
PO Drawer DD, Artesia, NM 88211-0719  
District III  
1000 Rio Brans Rd., Aztec, NM 87410  
District IV  
PO Box 2088, Santa Fe, NM 87504-2088

State of New Mexico  
Energy, Minerals & Natural Resources Department

OIL CONSERVATION DIVISION  
PO Box 2088  
Santa Fe, NM 87504-2088

Form C-104  
Revised February 10, 1994  
Instructions on back  
Submit to Appropriate District Office  
5 Copies

☐ AMENDED REPORT

I. REQUEST FOR ALLOWABLE AND AUTHORIZATION TO TRANSPORT

Operator name and Address		OGRID Number
SIERRA BLANCA OPERATING COMPANY 802 TURNER CLEBURNE, TEXAS 76031 (NAME CHANGE)		148869
		Reason for Filing Code
		CH EFFECTIVE 12-01-97
API Number	Pool Name	Pool Code
30 - 0 41-20440	Tomahawk San Andres	59469
Property Code	Property Name	Well Number
17857	Cone Federal	#2

II. Surface Location

UL or lot no.	Section	Township	Range	Lot Ida	Feet from the	North/South Line	Feet from the	East/West Line	County
C	31	7S	32E		660	North	1980	West	Roosevelt

Bottom Hole Location

UL or lot no.	Section	Township	Range	Lot Ida	Feet from the	North/South Line	Feet from the	East/West Line	County
Lee Code	Producing Method Code	Gas Connection Date	C-129 Permit Number	C-129 Effective Date	C-129 Expiration Date				
F	P								

III. Oil and Gas Transporters

Transporter OGRID	Transporter Name and Address	POD	O/G	POD ULSTR Location and Description
17407	PETRO SOURCE PTRS, LTD 129 S. Grimes, Hobbs, N	1954710	C	A-31-7S-32E
024650	WARREN PETROLEUM P.O. Box 598, Tulsa, OK	1954730	G	A-31-7S-32E

IV. Produced Water

POD	POD ULSTR Location and Description
1954750	P-30-7S-32E

V. Well Completion Data

Spud Date	Ready Date	TD	PBTD	Perforations
Hole Size	Casing & Tubing Size	Depth Set	Sacks Cement	

VI. Well Test Data

Date New Oil	Gas Delivery Date	Test Date	Test Length	Tbg. Pressure	Cog. Pressure
Choke Size	Oil	Water	Gas	AOF	Test Method

I hereby certify that the rules of the Oil Conservation Division have been complied with and that the information given above is true and complete to the best of my knowledge and belief.

Signature:

*Karol Rennels*

Printed name:

KAROL RENNELS

Title:

AGENT

Date:

03-28-98

Phone:

(817) 556-3973

Approved by:

OIL CONSERVATION DIVISION  
Original signed by  
*Charlie Perina*

Title:

Approval Date:

*03-28-98*

If this is a change of operator fill in the OGRID number and name of the previous operator

*Karol Rennels*

Previous Operator Signature

Printed Name

Title

Date

148869 Secondary Oil Corporation Karol Rennels, Agent 03-28-98

District I  
PO Box 1900, Hobbs, NM 88241-1900  
District II  
PO Drawer DD, Artesia, NM 88211-0719  
District III  
1000 Rio Brazos Rd., Aztec, NM 87410  
District IV  
PO Box 2088, Santa Fe, NM 87504-2088

State of New Mexico  
Energy, Minerals & Natural Resources Department

OIL CONSERVATION DIVISION  
PO Box 2088  
Santa Fe, NM 87504-2088

Form C-104  
Revised February 10, 1994  
Instructions on back  
Submit to Appropriate District Office  
5 Copies

☐ AMENDED REPORT

I. REQUEST FOR ALLOWABLE AND AUTHORIZATION TO TRANSPORT

Operator Name and Address SECONDARY OIL CORPORATION 1011 MEREDITH, SUITE B-2 AUSTIN, TEXAS 78748		OGRID Number 148869
Reason for Filing Code CO EFFECTIVE 02-01-97		
API Number 30 - 0 41-20440	Pool Name Tomahawk San Andres	Pool Code 59469
Property Code 17857	Property Name Cone Federal	Well Number #2

II. <sup>10</sup> Surface Location

UL or lot no.	Section	Township	Range	Lot Ida	Feet from the	North/South Line	Feet from the	East/West Line	County
C	31	7S	32E		660	North	1980	West	Roosevelt

<sup>11</sup> Bottom Hole Location

UL or lot no.	Section	Township	Range	Lot Ida	Feet from the	North/South Line	Feet from the	East/West Line	County
Lee Code F	Producing Method Code P	Gas Connection Date	C-129 Permit Number	C-129 Effective Date	C-129 Expiration Date				

III. Oil and Gas Transporters

Transporter OGRID	Transporter Name and Address	POD	O/G	POD ULSTR Location and Description
020445	Scurlock Permian Corp. P.O. Box 4648 Houston, Texas 77210	1954710	O	A-31-7S-32E
024650	WARREN PETROLEUM P.O. Box 598, Tulsa, OK	1954730	G	A-31-7S-32E

IV. Produced Water

POD	POD ULSTR Location and Description
1954750	P-30-7S-32E

V. Well Completion Data

Spud Date	Ready Date	TD	PBTD	Perforations
Hole Size	Casing & Tubing Size	Depth Set	Sacks Cement	

VI. Well Test Data

Date New Oil	Gas Delivery Date	Test Date	Test Length	Tbg. Pressure	Csg. Pressure
Choke Size	Oil	Water	Gas	AOF	Test Method

I hereby certify that the rules of the Oil Conservation Division have been complied with and that the information given above is true and complete to the best of my knowledge and belief.

Signature:

Printed name:

Title:

Date:

KAROL RENNELS

AGENT

02-07-97

(512) 292-1007

OIL CONSERVATION DIVISION

Approved by: ORIGINAL SIGNED BY JERRY SEXTON

Title:

Approval Date:

If this is a change of operator fill in the OGRID number and name of the previous operator

Previous Operator Signature

Printed Name

Title

Date

DISTRICT I  
PO Box 1980, Hobbs, NM 88241-1980  
DISTRICT II  
811 South First, Artesia, NM 88210  
DISTRICT III  
1000 Rio Brazos Rd, Aztec, NM 87410  
DISTRICT IV  
2040 South Pacheco, Santa Fe, NM 87505

STATE OF NEW MEXICO  
Energy, Minerals & Natural Resources Department  
OIL CONSERVATION DIVISION  
2040 South Pacheco  
Santa Fe, NM 87505

Form C-104  
Revised February 10, 1994  
Instructions on Back  
Submit to Appropriate District Office  
5 Copies  
\_\_\_ AMENDED REPORT

I. REQUEST FOR ALLOWABLE AND AUTHORIZATION TO TRANSPORT

1. Operator Name and Address Secondary Oil Corporation P. O. Box 708 Marble Falls, Texas 78654		2. OGRID Number 148869
		3. Reason for Filing Code CO Effective March 1, 1996
4. API Number 30-041-20440	5. Pool Name Tomahawk San Andres	6. Pool Code 59469
7. Property Code 017857	8. Property Name Cone Federal	9. Well Number #2

II. 10. Surface Location

UL or Lot No. C	Section 31	Township 7S	Range 32E	Lot Idn	Feet From The 660	North/South Line North	Feet From The 1980	East/West Line West	County Roosevelt
--------------------	---------------	----------------	--------------	---------	----------------------	---------------------------	-----------------------	------------------------	---------------------

11. Bottom Hole Location

UL or Lot No	Section	Township	Range	Lot Idn	Feet From The	North/South Line	Feet From The	East/West Line	County
12. Lse Code F	13. Producing Method Code P	14. Gas Connection Date		15. C-129 Permit Number		16. C-129 Effective Date		17. C-129 Exp Date	

III. Oil and Gas Transporters

18. Transporter OGRID 149410	19. Transporter Name and Address Ada Crude Oil Company P. O. Box 844 Houston, Texas 77001	20. POD 1954710	21. O/G O	22. POD ULSTR Location and Description A-31-7S-32E

IV. Produced Water

23. POD	24. POD ULSTR Location and Description
---------	--

V. Well Completion Data

25. Spud Date	26. Ready Date	27. TD	28. PBTB	29. Perforations
30. Hole Size	31. Casing & Tubing Size	32. Depth Set		33. Sacks Cement

VI. Well Test Data

34. Date New Oil	35. Gas Delivery Date	36. Test Date	37. Test Length	38. Tbg. Pressure	39. Csg. Pressure
40. Choke Size	41. Oil	42. Water	43. Gas	44. AOF	45. Test Method

46. I hereby certify that the rules of the Oil Conservation Division have been complied with and that the information given above is true and complete to the best of my knowledge and belief. Signature: <i>Carol J. Garcia</i> Printed name: Carol J. Garcia Title: Agent Date: 3/6/96 Phone: 210-693-7032		OIL CONSERVATION DIVISION ORIGINAL SIGNED BY DARY SEXTON EL PASO DISTRICT SUPERVISOR Approved By: _____ Title: _____ Approval Date: JUN 24 1996	
47. If this is a change of operator fill in the OGRID number and name of the previous operator			
Previous Operator Signature		Printed Name Title Date	



DISTRICT I  
PO Box 1980, Hobbs, NM 88241-1980  
DISTRICT II  
811 South First, Artesia, NM 88210  
DISTRICT III  
1000 Rio Brazos Rd, Aztec, NM 87410  
DISTRICT IV  
2040 South Pacheco, Santa Fe, NM 87505

STATE OF NEW MEXICO  
Energy, Minerals & Natural Resources Department

Form C-104  
Revised February 10, 1994  
Instructions on Back  
Submit to Appropriate District Office  
5 Copies

OIL CONSERVATION DIVISION  
2040 South Pacheco  
Santa Fe, NM 87505

AMENDED REPORT

I. REQUEST FOR ALLOWABLE AND AUTHORIZATION TO TRANSPORT

1. Operator Name and Address Secondary Oil Corporation P. O. Box 708 Marble Falls, Texas 78654		2. OGRID Number 148869
3. Reason for Filing Code CO Effective January 1, 1996		
4. API Number 30-041-20440	5. Pool Name Tomahawk San Andres	6. Pool Code 59469
7. Property Code 008165 17857	8. Property Name Cone Federal	9. Well Number #2

II. 10. Surface Location

UL or Lot No. C	Section 31	Township 7S	Range 32E	Lot Idn	Feet From The 660	North/South Line North	Feet From The 1980	East/West Line West	County Roosevelt
--------------------	---------------	----------------	--------------	---------	----------------------	---------------------------	-----------------------	------------------------	---------------------

11. Bottom Hole Location

UL or Lot No	Section	Township	Range	Lot Idn	Feet From The	North/South Line	Feet From The	East/West Line	County
12. Lse Code F	13. Producing Method Code P	14. Gas Connection Date	15. C-129 Permit Number	16. C-129 Effective Date	17. C-129 Exp Date				

III. Oil and Gas Transporters

18. Transporter OGRID 007440	19. Transporter Name and Address EOTT Energy Operating LP P. O. Box 4666 Houston, Texas 77210-4666	20. POD 1954710	21. O/G O	22. POD ULSTR Location and Description A-31-7S-32E

IV. Produced Water

23. POD	24. POD ULSTR Location and Description
---------	--

V. Well Completion Data

25. Spud Date	26. Ready Date	27. TD	28. PBTD	29. Perforations
30. Hole Size	31. Casing & Tubing Size	32. Depth Set	33. Sacks Cement	

VI. Well Test Data

34. Date New Oil	35. Gas Delivery Date	36. Test Date	37. Test Length	38. Tbg. Pressure	39. Csg. Pressure
40. Choke Size	41. Oil	42. Water	43. Gas	44. AOF	45. Test Method

46. I hereby certify that the rules of the Oil Conservation Division have been complied with and that the information given above is true and complete to the best of my knowledge and belief. Signature: <i>Karol Rennels</i> Printed name: KAROL RENNELS Title: AGENT Date: 1/12/96 Phone: 210-693-7032		OIL CONSERVATION DIVISION ORIGINAL SIGNED BY GARY WINK Title: FIELD REP. II Approval Date: JAN 29 1996	
---	--	--	--

47. If this is a change of operator fill in the OGRID number and name of the previous operator			
Previous Operator Signature	Printed Name	Title	Date

District I  
PO Box 1900, Hobbs, NM 88241-1900  
District II  
PO Drawer DD, Artesia, NM 88211-0719  
District III  
1000 Rio Branco Rd., Aztec, NM 87410  
District IV  
PO Box 2088, Santa Fe, NM 87504-2088

State of New Mexico  
Energy, Minerals & Natural Resources Department

OIL CONSERVATION DIVISION  
PO Box 2088  
Santa Fe, NM 87504-2088

Form C-104  
Revised February 10, 1994  
Instructions on back  
Submit to Appropriate District Office  
5 Copies

☐ AMENDED REPORT

I. REQUEST FOR ALLOWABLE AND AUTHORIZATION TO TRANSPORT

<sup>1</sup> Operator name and Address SECONDARY OIL CORPORATION P. O. BOX 708 MARBLE FALLS, TEXAS 78654		<sup>2</sup> OGRID Number 148869
		<sup>3</sup> Reason for Filing Code CG EFFECTIVE 10-01-95
<sup>4</sup> API Number 30 - 0 41-20440	<sup>5</sup> Pool Name Tomahawk San Andres	<sup>6</sup> Pool Code 59469
<sup>7</sup> Property Code 17857	<sup>8</sup> Property Name Cone Federal	<sup>9</sup> Well Number #2

II. <sup>10</sup> Surface Location

<sup>11</sup> UL or lot no. C	<sup>12</sup> Section 31	<sup>13</sup> Township 7S	<sup>14</sup> Range 32E	<sup>15</sup> Lot Ida	<sup>16</sup> Feet from the 660	<sup>17</sup> North/South Line North	<sup>18</sup> Feet from the 1980	<sup>19</sup> East/West line West	<sup>20</sup> County Roosevelt
----------------------------------	-----------------------------	------------------------------	----------------------------	-----------------------	------------------------------------	---	-------------------------------------	--------------------------------------	-----------------------------------

<sup>11</sup> Bottom Hole Location

<sup>21</sup> UL or lot no.	<sup>22</sup> Section	<sup>23</sup> Township	<sup>24</sup> Range	<sup>25</sup> Lot Ida	<sup>26</sup> Feet from the	<sup>27</sup> North/South line	<sup>28</sup> Feet from the	<sup>29</sup> East/West line	<sup>30</sup> County
<sup>31</sup> Lee Code F	<sup>32</sup> Producing Method Code P	<sup>33</sup> Gas Connection Date	<sup>34</sup> C-129 Permit Number	<sup>35</sup> C-129 Effective Date	<sup>36</sup> C-129 Expiration Date				

III. Oil and Gas Transporters

<sup>37</sup> Transporter OGRID	<sup>38</sup> Transporter Name and Address	<sup>39</sup> POD	<sup>40</sup> O/G	<sup>41</sup> POD ULSTR Location and Description
17407	PETRO SOURCE PTRS, LTD 129 S. Grimes, Hobbs, NM	1954710	O	A-31-7S-32E
024650	WARREN PETROLEUM P.O. Box 598, Tulsa, OK	1954730	G	A-31-7S-32E

IV. Produced Water

<sup>42</sup> POD 1954750	<sup>43</sup> POD ULSTR Location and Description P-30-7S-32E
------------------------------	---

V. Well Completion Data

<sup>44</sup> Spud Date	<sup>45</sup> Ready Date	<sup>46</sup> TD	<sup>47</sup> PBTD	<sup>48</sup> Perforations
<sup>49</sup> Hole Size	<sup>50</sup> Casing & Tubing Size	<sup>51</sup> Depth Set	<sup>52</sup> Sacks Cement	

VI. Well Test Data

<sup>53</sup> Date New Oil	<sup>54</sup> Gas Delivery Date	<sup>55</sup> Test Date	<sup>56</sup> Test Length	<sup>57</sup> Tbg. Pressure	<sup>58</sup> Csg. Pressure
<sup>59</sup> Choke Size	<sup>60</sup> Oil	<sup>61</sup> Water	<sup>62</sup> Gas	<sup>63</sup> AOF	<sup>64</sup> Test Method

"I hereby certify that the rules of the Oil Conservation Division have been complied with and that the information given above is true and complete to the best of my knowledge and belief.

Signature:

Printed name: KAROL RENNELS

Title: AGENT

Date: 11/28/95

Phone: (210) 693-7032

OIL CONSERVATION DIVISION

Approved by: ORIGINAL SIGNED BY JERRY SEXTON  
DISTRICT I SUPERVISOR

Title:

Approval Date:

" If this is a change of operator fill in the OGRID number and name of the previous operator

Previous Operator Signature

Printed Name

Title

Date

District I  
PO Box 1908, Hobbs, NM 88241-1908  
District II  
PO Drawer DD, Artesia, NM 88211-0719  
District III  
1000 Rio Brava Rd., Aztec, NM 87410  
District IV  
PO Box 2088, Santa Fe, NM 87504-2088

State of New Mexico  
Energy, Minerals & Natural Resources Department

OIL CONSERVATION DIVISION  
PO Box 2088  
Santa Fe, NM 87504-2088

Form C-104  
Revised February 10, 1994  
Instructions on back  
Submit to Appropriate District Office  
5 Copies

☐ AMENDED REPORT

I. REQUEST FOR ALLOWABLE AND AUTHORIZATION TO TRANSPORT

Operator name and Address SECONDARY OIL CORPORATION P. O. BOX 708 MARBLE FALLS, TEXAS 78654		OGRID Number 148864
Reason for Filing Code CH EFFECTIVE 10-01-95		
API Number 41-20440	Pool Name Tomahawk San Andres	Pool Code 59469
Property Code 17857	Property Name Cone Federal	Well Number #2

II. Surface Location

UL or lot no. C	Section 31	Township 7S	Range 32E	Lot Ida	Feet from the 660	North/South Line North	Feet from the 1980	East/West Line West	County Roosevelt
--------------------	---------------	----------------	--------------	---------	----------------------	---------------------------	-----------------------	------------------------	---------------------

Bottom Hole Location

UL or lot no.	Section	Township	Range	Lot Ida	Feet from the	North/South Line	Feet from the	East/West Line	County
Log Code F	Producing Method Code P	Gas Connection Date	C-129 Permit Number	C-129 Effective Date	C-129 Expiration Date				

III. Oil and Gas Transporters

Transporter OGRID	Transporter Name and Address	POD	O/G	POD ULSTR Location and Description
17407	PETRO SOURCE PTRS, LTD 129 S. Grimes, Hobbs, NM	1954710	O	A-31-7S-32E
824630	WARREN PETROLEUM P.O. Box 598, Tulsa, OK	1954530	G	A-31-7S-32E
23470	Trident NGL Inc	1954730	E	

IV. Produced Water

POD 1954750	POD ULSTR Location and Description P-30-7S-32E
----------------	---

V. Well Completion Data

Spud Date	Ready Date	TD	PBTD	Perforations
Hole Size	Casing & Tubing Size	Depth Set	Sacks Cement	

VI. Well Test Data

Date New Oil	Gas Delivery Date	Test Date	Test Length	Tbg. Pressure	Csg. Pressure
Choke Size	Oil	Water	Gas	AOF	Test Method

I hereby certify that the rules of the Oil Conservation Division have been complied with and that the information given above is true and complete to the best of my knowledge and belief.

Signature: KAROL RENNELS

Printed name:

Title: AGENT

Date: 10/17/95

Phone: (210) 693-7032

OIL CONSERVATION DIVISION

ORIGINAL SIGNED BY

GARY WINK

FIELD REP. II

Approved by:

Title:

Approval Date:

NOV 02 1995

If this is a change of operator fill in the OGRID number and name of the previous operator

015406

Previous Operator Signature

Murphy Operating Corp.

Printed Name

Carol J. Garcia, Prod. Mgr.

Title

Date

10/27/95

DISTRICT II  
P.O. Drawer DD, Artesia, NM 88210

OIL CONSERVATION DIVISION

P.O. Box 2088  
Santa Fe, New Mexico 87504-2088

DISTRICT III  
1000 Rio Brazos Rd., Aztec, NM 87410

REQUEST FOR ALLOWABLE AND AUTHORIZATION  
TO TRANSPORT OIL AND NATURAL GAS

Operator Murphy Operating Corporation		Well API No. 30-041-20440
Address P. O. Box 2545, Roswell, New Mexico 88202-2545		
Reason(s) for Filing (Check proper box) <input type="checkbox"/> Other (Please explain)		
New Well <input type="checkbox"/>	Change in Transporter of:	
Recompletion <input type="checkbox"/>	Oil <input checked="" type="checkbox"/> Dry Gas <input type="checkbox"/>	Change effective April 1, 1992
Change in Operator <input type="checkbox"/>	Casinghead Gas <input checked="" type="checkbox"/> Condensate <input type="checkbox"/>	
If change of operator give name and address of previous operator		

II. DESCRIPTION OF WELL AND LEASE

Lease Name Cone Federal	Well No. 2	Pool Name, Including Formation Tomahawk San Andres	Kind of Lease State, Federal or Private XXXX XXXX XXXX	Lease No. NM-15019
Location Unit Letter C : 660 Feet From The North Line and 1980 Feet From The West Line Section 31 Township 7 South Range 32 East, NMPM, Roosevelt County				

III. DESIGNATION OF TRANSPORTER OF OIL AND NATURAL GAS

Name of Authorized Transporter of Oil <input checked="" type="checkbox"/> or Condensate <input type="checkbox"/> Petro Source Partners, Ltd.	Address (Give address to which approved copy of this form is to be sent) P. O. Box 1356, Dumas, TX 79029					
Name of Authorized Transporter of Casinghead Gas <input checked="" type="checkbox"/> or Dry Gas <input type="checkbox"/> Trident NGL Inc	Address (Give address to which approved copy of this form is to be sent)					
If well produces oil or liquids, give location of tanks.	Unit A	Sec. 31	Tw. 7S	Rge. 32E	Is gas actually connected?	When ?

If this production is commingled with that from any other lease or pool, give commingling order number:

IV. COMPLETION DATA

Designate Type of Completion - (X)	Oil Well	Gas Well	New Well	Workover	Deepen	Plug Back	Same Res'v	Diff Res'v
Date Spudded	Date Compl. Ready to Prod.		Total Depth			P.B.T.D.		
Elevations (DF, RKB, RT, GR, etc.)	Name of Producing Formation		Top Oil/Gas Pay			Tubing Depth		
Perforations						Depth Casing Shoe		
TUBING, CASING AND CEMENTING RECORD								
HOLE SIZE	CASING & TUBING SIZE		DEPTH SET			SACKS CEMENT		

V. TEST DATA AND REQUEST FOR ALLOWABLE

OIL WELL (Test must be after recovery of total volume of load oil and must be equal to or exceed top allowable for this depth or be for full 24 hours.)

Date First New Oil Run To Tank	Date of Test	Producing Method (Flow, pump, gas lift, etc.)	
Length of Test	Tubing Pressure	Casing Pressure	Choke Size
Actual Prod. During Test	Oil - Bbls.	Water - Bbls.	Gas- MCF

GAS WELL

Actual Prod. Test - MCF/D	Length of Test	Bbls. Condensate/MMCF	Gravity of Condensate
Testing Method (pilot, back pr.)	Tubing Pressure (Shut-in)	Casing Pressure (Shut-in)	Choke Size

VI. OPERATOR CERTIFICATE OF COMPLIANCE

I hereby certify that the rules and regulations of the Oil Conservation Division have been complied with and that the information given above is true and complete to the best of my knowledge and belief.

Carol J. Garcia  
Signature  
Carol J. Garcia, Production Analyst  
Printed Name  
Date 4/8/92 Telephone No. 505-622-1127

OIL CONSERVATION DIVISION

Date Approved APR 21 '92  
By ORIGINAL SIGNED BY JERRY SEXTON  
DISTRICT I SUPERVISOR  
Title

INSTRUCTIONS: This form is to be filed in compliance with Rule 1104

- Request for allowable for newly drilled or deepened well must be accompanied by tabulation of deviation tests taken in accordance with Rule 111.
- All sections of this form must be filled out for allowable on new and recompleted wells.
- Fill out only Sections I, II, III, and VI for changes of operator, well name or number, transporter, or other such changes.
- Separate Form C-104 must be filed for each pool in multiply completed wells.

RECEIVED

APR 20 1992

OCD HOBBS OFFICE

OIL CONSERVATION DIVISION  
P. O. BOX 2008  
SANTA FE, NEW MEXICO 87501REQUEST FOR ALLOWABLE  
AND  
AUTHORIZATION TO TRANSPORT OIL AND NATURAL GAS

NO. OF COPIES RECEIVED	
DISTRIBUTION	
FILE	
U.S.O.B.	
LAND OFFICE	
TRANSPORTER	OIL
OPERATOR	
PRODUCTION OFFICE	

Operator **MURPHY OPERATING CORPORATION**Address **P. O. Drawer 2648, Roswell, New Mexico 88201**

Reason(s) for filing (Check proper box)

New Well	<input type="checkbox"/>	Change in Transporter of:	
Recompletion	<input type="checkbox"/>	Oil	<input type="checkbox"/>
Change in Ownership	<input checked="" type="checkbox"/>	Casinghead Gas	<input type="checkbox"/>
		Dry Gas	<input type="checkbox"/>
		Condensate	<input type="checkbox"/>

Other (Please explain)

Change of Ownership  
effective 12-1-84If change of ownership give name and address of previous owner **One Barclay Plaza, Suite 800  
SUNDANCE OIL EXPLORATION COMPANY, 1675 Larimer Street, Denver, CO 80202**

## DESCRIPTION OF WELL AND LEASE

Lease Name <b>Cone Federal</b>	Well No. <b>2</b>	Pool Name, Including Formation <b>Tomahawk San Andres</b>	Kind of Lease <b>Federal</b> State, Federal or Fee	Lease No. <b>15019</b>
Location Unit Letter <b>C</b> ; <b>660</b> Feet From The <b>North</b> Line and <b>1980</b> Feet From The <b>West</b> Line of Section <b>31</b> Township <b>7 South</b> Range <b>32 East</b> , NMPM, <b>Roosevelt</b> County				

## DESIGNATION OF TRANSPORTER OF OIL AND NATURAL GAS

Name of Authorized Transporter of Oil <input checked="" type="checkbox"/> or Condensate <input type="checkbox"/> <b>The Permian Corporation</b>	Address (Give address to which approved copy of this form is to be sent) <b>P. O. Box 1183, Houston, Texas 77001</b>	
Name of Authorized Transporter of Casinghead Gas <input checked="" type="checkbox"/> or Dry Gas <input type="checkbox"/> <b>Cities Service Company</b>	Address (Give address to which approved copy of this form is to be sent) <b>P. O. Box 300, Tulsa, Oklahoma 74102</b>	
If well produces oil or liquids, give location of tanks.	Unit <b>A</b>	Sec. <b>31</b>
	Twp. <b>7-S</b>	Rge. <b>32-E</b>
	Is gas actually connected? <b>no</b> When	

If this production is commingled with that from any other lease or pool, give commingling order number:

## COMPLETION DATA

Designate Type of Completion - (X)	Oil Well	Gas Well	New Well	Workover	Deepen	Plug Back	Same Res'v.	Diff. Res'v.
Date Spudded	Date Compl. Ready to Prod.		Total Depth			P.B.T.D.		
Elevations (DF, RKB, RT, GR, etc.)	Name of Producing Formation		Top Oil/Gas Pay			Tubing Depth		
Perforations						Depth Casing Shoe		

## TUBING, CASING, AND CEMENTING RECORD

HOLE SIZE	CASING & TUBING SIZE	DEPTH SET	SACKS CEMENT

## TEST DATA AND REQUEST FOR ALLOWABLE OIL WELL (Test must be after recovery of total volume of load oil and must be equal to or exceed top allowable for this depth or be for full 24 hours)

Date First New Oil Run To Tanks	Date of Test	Producing Method (Flow, pump, gas lift, etc.)	
Length of Test	Tubing Pressure	Casing Pressure	Choke Size
Actual Prod. During Test	Oil-Bbls.	Water-Bbls.	Gas-MCF

## GAS WELL

Actual Prod. Feet-MCF/D	Length of Test	Bbls. Condensate/MMCF	Gravity of Condensate
Testing Method (pilot, back pr.)	Tubing Pressure (shut-in)	Casing Pressure (shut-in)	Choke Size

## CERTIFICATE OF COMPLIANCE

I hereby certify that the rules and regulations of the Oil Conservation Division have been complied with and that the information given above is true and complete to the best of my knowledge and belief.

**MURPHY OPERATING CORPORATION****A. J. Murphy**

President

January 4, 1985

(Title)

(Date)

## OIL CONSERVATION DIVISION

JAN 14 1985

APPROVED **ORIGINAL SIGNED BY JERRY SEXTON**  
BY **DISTRICT I SUPERVISOR**

TITLE

This form is to be filed in compliance with RULE 1104.

If this is a request for allowable for a newly drilled or deepened well, this form must be accompanied by a tabulation of the deviated tests taken on the well in accordance with RULE 111.

All sections of this form must be filled out completely for allowable on new and recompleted wells.

Fill out only Sections I, II, III, and VI for changes of owner, well name or number, or transporter, or other such change of condition. Separate Form C-104 must be filled for each pool in multiple.

F.

RECEIVED

JAN 10 1985

HOBBY

## SUNDRY NOTICES AND REPORTS ON WELLS

(Do not use this form for proposals to drill or to deepen or plug back to a different reservoir.  
Use "APPLICATION FOR PERMIT—" for such proposals.)

1. OIL WELL <input checked="" type="checkbox"/> GAS WELL <input type="checkbox"/> OTHER <input type="checkbox"/>		5. LEASE DESIGNATION AND SERIAL NO. NM-15019	
2. NAME OF OPERATOR Murphy Operating Corporation		6. IF INDIAN, ALLOTTEE OR TRIBE NAME	
3. ADDRESS OF OPERATOR P. O. Drawer 2648, Roswell, New Mexico 88202-2648		7. UNIT AGREEMENT NAME	
4. LOCATION OF WELL (Report location clearly and in accordance with any State requirements. See also space 17 below.) At surface  660' FNL, 1980' FWL, Unit Ltr. C, Sec. 31, T7S, R32E		8. FARM OR LEASE NAME Cone Federal	
14. PERMIT NO.		9. WELL NO. 2	
15. ELEVATIONS (Show whether DF, RT, GR, etc.) 4438' KB, 4428' GR		10. FIELD AND POOL, OR WILDCAT Tomahawk San Andres	
		11. SEC., T., R., M., OR BLK. AND SURVEY OR AREA Sec. 31, T7S, R32E	
		12. COUNTY OR PARISH Roosevelt	
		13. STATE NM	

## 18. Check Appropriate Box To Indicate Nature of Notice, Report, or Other Data

## NOTICE OF INTENTION TO:

TEST WATER SHUT-OFF ☐FRACTURE TREAT ☐SHOOT OR ACIDIZE ☐REPAIR WELL ☐

(Other) Request for TA extension

PULL OR ALTER CASING ☐MULTIPLE COMPLETE ☐ABANDON\* ☐CHANGE PLANS ☐☒

## SUBSEQUENT REPORT OF:

WATER SHUT-OFF ☐FRACTURE TREATMENT ☐SHOOTING OR ACIDIZING ☐(Other) ☐REPAIRING WELL ☐ALTERING CASING ☐ABANDONMENT\* ☐

(Note: Report results of multiple completion on Well Completion or Recompletion Report and Log form.)

17. DESCRIBE PROPOSED OR COMPLETED OPERATIONS (Clearly state all pertinent details, and give pertinent dates, including estimated date of starting any proposed work. If well is directionally drilled, give subsurface locations and measured and true vertical depths for all markers and zones pertinent to this work.) \*

Cone Federal Well # 2 is a temporarily abandoned well. We hereby request that the TA status be extended.



18. I hereby certify that the foregoing is true and correct

SIGNED

Lori Brown

TITLE

Production Supervisor

DATE

4/27/90

(This space for Federal or State office use)

APPROVED BY

CONDITIONS OF APPROVAL, IF ANY:

TITLE

APPROVED FOR 12 MONTH PERIOD  
ENDING MAY 23 1991

\*See Instructions on Reverse Side

APPROVED  
PETER W. CHESTER

MAY 23 1990

BUREAU OF LAND MANAGEMENT  
ROSWELL RESOURCE AREA



UNITED STATES DEPARTMENT OF THE INTERIOR  
BUREAU OF LAND MANAGEMENT  
HOBBS, NEW MEXICO 88240

Budget Bureau No. 1004-0135  
Expires August 31, 1985

5. LEASE DESIGNATION AND SERIAL NO.

NM-15019

6. IF INDIAN, ALLOTTEE OR TRIBE NAME

7. UNIT AGREEMENT NAME

8. FARM OR LEASE NAME

CONE FEDERAL

9. WELL NO.

2

10. FIELD AND POOL, OR WILDCAT

Tomahawk San Andres

11. SEC., T., R., M., OR BLK. AND SURVEY OR AREA

Sec. 31, T-7S, R-32E

12. COUNTY OR PARISH

Roosevelt

13. STATE

New Mexico

1.

OIL WELL ☒ GAS WELL ☐ OTHER ☐

2. NAME OF OPERATOR

MURPHY OPERATING CORPORATION

3. ADDRESS OF OPERATOR

P. O. Box 2648, Roswell, New Mexico 88202-2648

4. LOCATION OF WELL (Report location clearly and in accordance with any State requirements. See also space 17 below.)  
At surface

660' FNL, 1980' FWL, Unit Ltr. C, Sec. 31, T-7S, R-32E

14. PERMIT NO.

15. ELEVATIONS (Show whether DF, RT, CR, etc.)

4438' KB, 4428' GR

16. Check Appropriate Box To Indicate Nature of Notice, Report, or Other Data

NOTICE OF INTENTION TO:

TEST WATER SHUT-OFF

<input type="checkbox"/>
<input type="checkbox"/>
<input checked="" type="checkbox"/>
<input type="checkbox"/>

PULL OR ALTER CASING

<input type="checkbox"/>
<input type="checkbox"/>
<input type="checkbox"/>
<input type="checkbox"/>

FRACTURE TREAT

MULTIPLE COMPLETION

SHOOT OR ACIDIZE

ABANDON\*

REPAIR WELL

CHANGE PLANS

(Other) pressure test casing

☒

SUBSEQUENT REPORT OF:

WATER SHUT-OFF

<input type="checkbox"/>
<input type="checkbox"/>
<input type="checkbox"/>
<input type="checkbox"/>

FRACTURE TREATMENT

SHOOTING OR ACIDIZING

(Other)

REPAIRING WELL

ALTERING CASING

ABANDONMENT\*

<input type="checkbox"/>
<input type="checkbox"/>
<input type="checkbox"/>
<input type="checkbox"/>

(NOTE: Report results of multiple completion on Well Completion or Recompletion Report and Log form.)

17. DESCRIBE PROPOSED OR COMPLETED OPERATIONS (Clearly state all pertinent details, and give pertinent dates, including estimated date of starting any proposed work. If well is directionally drilled, give subsurface locations and measured and true vertical depths for all markers and zones pertinent to this work.)

On or about September 15, 1988 commence work as follows:

- TOH rods, pump and tubing.
- TIH w/packer and tubing. Set packer within 100' of uppermost perforation.
- Load annulus and pressure test to 500 psi and hold for 30 minutes.
- Perforate 1 JSPF: P-2 zone (4101'-4115') and P-3 zone (4235'-4242'). TIH w/packer and tubing and acidize w/3000 gals. 15% NeFe.
- Set retrievable bridge plug and perforate 1 JSPF P-1 zone (4056'-4084'). Acidize w/5000 gals. 15% NeFe.
- TOH w/retrievable bridge plug and packer. TIH w/tubing, pump and rods. Return to production.
- MOC will notify BLM office Roswell, New Mexico 48 hours prior to casing test so that BLM representative may witness said test.

I hereby certify that the foregoing is true and correct

SIGNED

Melinda K. Hickman

TITLE Production Supervisor

DATE 7/15/88

This space for Federal or State office use)

APPROVED BY

TITLE

CONDITIONS OF APPROVAL, IF ANY:

\*See Instructions on Reverse Side

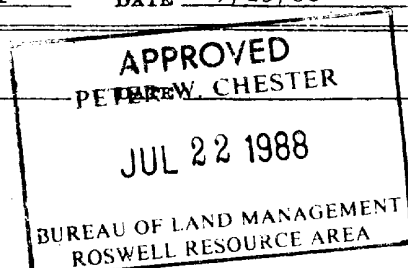

Form 3160-5  
November 1983)  
Formerly 9-331)

UNITED STATES  
DEPARTMENT OF THE INTERIOR  
BUREAU OF LAND MANAGEMENT

SUBMIT IN TRIPLICATE\*  
(Other instructions on re-  
verse side)

Form approved.  
Budget Bureau No. 1004-0135  
Expires August 31, 1985

SUNDRY NOTICES AND REPORTS ON WELLS

(Do not use this form for proposals to drill or to deepen or plug back to a different reservoir.  
Use "APPLICATION FOR PERMIT—" for such proposals.)

1. <input checked="" type="checkbox"/> OIL WELL <input type="checkbox"/> GAS WELL <input type="checkbox"/> OTHER		5. LEASE DESIGNATION AND SERIAL NO. NM-15019	
2. NAME OF OPERATOR MURPHY OPERATING CORPORATION		6. IF INDIAN, ALLOTTEE OR TRIBE NAME	
3. ADDRESS OF OPERATOR P. O. Drawer 2648, Roswell, New Mexico 88201		7. UNIT AGREEMENT NAME	
4. LOCATION OF WELL (Report location clearly and in accordance with any State requirements.* See also space 17 below.) At surface  660' FNL, 1980' FWL, (Unit Ltr. C) Sec. 31, T-7S, R-32E		8. FARM OR LEASE NAME CONE FEDERAL	
14. PERMIT NO.		9. WELL NO. 2	
15. ELEVATIONS (Show whether DF, RT, GR, etc.) 4438' KB, 4428' GR		10. FIELD AND POOL, OR WILDCAT Tomahawk San Andres	
		11. SEC., T., R., M., OR BLK. AND SUBVY OR AREA Sec. 31, T-7S, R-32E	
		12. COUNTY OR PARISH Roosevelt	13. STATE New Mexico

16. Check Appropriate Box To Indicate Nature of Notice, Report, or Other Data

NOTICE OF INTENTION TO:		SUBSEQUENT REPORT OF:	
TEST WATER SHUT-OFF <input type="checkbox"/>	PULL OR ALTER CASING <input type="checkbox"/>	WATER SHUT-OFF <input type="checkbox"/>	REPAIRING WELL <input type="checkbox"/>
FRACTURE TREAT <input type="checkbox"/>	MULTIPLE COMPLETE <input type="checkbox"/>	FRACTURE TREATMENT <input type="checkbox"/>	ALTERING CASING <input type="checkbox"/>
SHOOT OR ACIDIZE <input type="checkbox"/>	ABANDON* <input type="checkbox"/>	SHOOTING OR ACIDIZING <input type="checkbox"/>	ABANDONMENT* <input type="checkbox"/>
REPAIR WELL <input type="checkbox"/>	CHANGE PLANS <input type="checkbox"/>	(Other) <input type="checkbox"/>	

(Other) Request for TA Extension ☒ (Note: Report results of multiple completion on Well Completion or Recompletion Report and Log form.)

17. DESCRIBE PROPOSED OR COMPLETED OPERATIONS (Clearly state all pertinent details, and give pertinent dates, including estimated date of starting any proposed work. If well is directionally drilled, give subsurface locations and measured and true vertical depths for all markers and zones pertinent to this work.) \*

The Cone Federal Well #2 is a temporarily abandoned well. Plans for workover of this well are in the near future. We hereby request that temporarily abandoned status be continued for this well for one year, and that the casing test be delayed for one year.



I hereby certify that the foregoing is true and correct

SIGNED Lois N. Brown TITLE Production Clerk DATE March 13, 1986  
(This space for Federal or State office use)

PROVED BY \_\_\_\_\_  
CONDITIONS OF APPROVAL, IF ANY:

TITLE \_\_\_\_\_  
APPROVED FOR 12 MONTH PERIOD  
ENDING 3/14/87  
\*See Instructions on Reverse Side

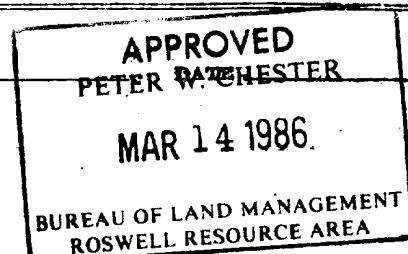

RECEIVED  
MAR 26 1986  
C. C. H.  
HOBBS OFFICE

NO. OF COPIES RECEIVED		
DISTRIBUTION		
SANTA FE		
FILE		
U.S.G.S.		
LAND OFFICE		
TRANSPORTER	OIL	
	GAS	
OPERATOR		
PRODUCTION OFFICE		

NEW MEXICO OIL CONSERVATION COMMISSION  
REQUEST FOR ALLOWABLE  
AND  
AUTHORIZATION TO TRANSPORT OIL AND NATURAL GAS

Form C-104  
Supersedes Old C-104 and C-111  
Effective 1-1-65

Operator <b>SUNDANCE OIL EXPLORATION COMPANY</b>		
Address <b>1675 Larimer St Suite 800 Denver Colorado 80202</b>		
Reason(s) for filing (Check proper box)		Other (Please explain)
New Well <input type="checkbox"/>	Change in Transporter of: Oil <input checked="" type="checkbox"/> Dry Gas <input type="checkbox"/>	Name change from Sundance Oil Company to Sundance Oil Exploration Company
Recompletion <input type="checkbox"/>	Casinghead Gas <input type="checkbox"/> Condensate <input type="checkbox"/>	
Change in Ownership <input type="checkbox"/>		

If change of ownership give name  
and address of previous owner \_\_\_\_\_

II. DESCRIPTION OF WELL AND LEASE

Lessee Name <b>CONE FEDERAL</b>	Well No. <b>2</b>	Pool Name, including Formation <b>Tomahawk, San Andres</b>	Kind of Lease State, Federal or Fee <b>Federal</b>	Lease No. <b>15019</b>
Location Unit Letter <b>C</b> ; <b>660</b> Feet From The <b>North</b> Line and <b>1980</b> Feet From The <b>West</b> Line of Section <b>31</b> Township <b>7S</b> Range <b>32E</b> , NMPM, <b>Roosevelt</b> County				

III. DESIGNATION OF TRANSPORTER OF OIL AND NATURAL GAS

Name of Authorized Transporter of Oil <input checked="" type="checkbox"/> or Condensate <input type="checkbox"/> <b>The Permian Corporation</b>	Address (Give address to which approved copy of this form is to be sent) <b>P.O. Box 1183 Houston Texas 77001</b>				
Name of Authorized Transporter of Casinghead Gas <input checked="" type="checkbox"/> or Dry Gas <input type="checkbox"/> <b>Cities Service Company</b>	Address (Give address to which approved copy of this form is to be sent) <b>P.O. Box 300 Tulsa Oklahoma 74102</b>				
If well produces oil or liquids, give location of tanks.	Unit <b>A</b>	Sec. <b>31</b>	Twp. <b>7S</b>	Rge. <b>32E</b>	Is gas actually connected? When <b>No</b>

If this production is commingled with that from any other lease or pool, give commingling order number: \_\_\_\_\_

IV. COMPLETION DATA

Designate Type of Completion - (X)		Oil Well	Gas Well	New Well	Workover	Deepen	Plug Back	Same Rest. Well	Diff. Rest.
Date Spudded	Date Compl. Ready to Prod.	Total Depth				P.B.T.D.			
Elevations (DF, RKB, RT, GR, etc.)	Name of Producing Formation	Top Oil/Gas Pay				Tubing Depth			
Perforations						Depth Casing Shoe			
TUBING, CASING, AND CEMENTING RECORD									
HOLE SIZE	CASING & TUBING SIZE		DEPTH SET		SACKS CEMENT				

V. TEST DATA AND REQUEST FOR ALLOWABLE OIL WELL (Test must be after recovery of total volume of load oil and must be equal to or exceed top allowable for this depth or be for full 24 hours)

Date First New Oil Run To Tanks	Date of Test	Producing Method (Flow, pump, gas lift, etc.)	
Length of Test	Tubing Pressure	Casing Pressure	Choke Size
Actual Prod. During Test	Oil-Bbls.	Water-Bbls.	Gas-MCF

GAS WELL

Actual Prod. Test-MCF/D	Length of Test	Bbls. Condensate/MMCF	Gravity of Condensate
Testing Method (pilot, back pr.)	Tubing Pressure ( Shut-in )	Casing Pressure ( Shut-in )	Choke Size

VI. CERTIFICATE OF COMPLIANCE

I hereby certify that the rules and regulations of the Oil Conservation Commission have been complied with and that the information given above is true and complete to the best of my knowledge and belief.

  
(Signature) **Amarilis C. Vilches**  
**Senior Production Assistant**  
(Title)  
**July 20, 1984**  
(Date)

OIL CONSERVATION COMMISSION  
**AUG - 8 1984**  
APPROVED \_\_\_\_\_, 19\_\_\_\_  
BY **Eddie W. Seay**  
TITLE **Oil & Gas Inspector**

This form is to be filed in compliance with RULE 1104.  
If this is a request for allowable for a newly drilled or reopened well, this form must be accompanied by a tabulation of the deviation tests taken on the well in accordance with RULE 111.  
All sections of this form must be filled out completely for allowable on new and recompleted wells.  
Fill out only Sections I, II, III, and VI for changes of owner, well name or number, or transporter, or other such change of condition.

RECEIVED  
AUG - 3 1984  
O.F.D.  
HOBBS OFFICE

NO. OF COPIES RECEIVED		
DISTRIBUTION		
SANTA FE		
FILE		
U.S.G.S.		
LAND OFFICE		
TRANSPORTER	OIL	
	GAS	
OPERATOR		
PRORATION OFFICE		

NEW MEXICO OIL CONSERVATION COMMISSION  
REQUEST FOR ALLOWABLE  
AND  
AUTHORIZATION TO TRANSPORT OIL AND NATURAL GAS

Form C-104  
Supersedes Old C-104 and C-1  
Effective 1-1-65

I.

Operator SUNDANCE OIL COMPANY		
Address Suite 510, 1776 Lincoln St., Denver, CO 80203		
Reason(s) for filing (Check proper box)		Other (Please explain)
New Well <input type="checkbox"/>	Change in Transporter of: Oil <input type="checkbox"/> Dry Gas <input type="checkbox"/>	Hooked up gas line to sell casinghead gas.
Recompletion <input type="checkbox"/>	Casinghead Gas <input type="checkbox"/> Condensate <input type="checkbox"/>	
Change in Ownership <input type="checkbox"/>		

If change of ownership give name  
and address of previous owner \_\_\_\_\_

II. DESCRIPTION OF WELL AND LEASE

Lease Name Cone Federal	Well No. 2	Pool Name, Including Formation Tomahawk, San Andres	Kind of Lease State, Federal or Fee Federal	Lease No. 15019
Location Unit Letter <u>C</u> ; <u>660</u> Feet From The <u>North</u> Line and <u>1980</u> Feet From The <u>West</u>				
Line of Section <u>31</u> Township <u>7S</u> Range <u>32E</u> , NMPM, <u>Roosevelt</u> County				

III. DESIGNATION OF TRANSPORTER OF OIL AND NATURAL GAS

Name of Authorized Transporter of Oil <input type="checkbox"/> or Condensate <input type="checkbox"/>	Address (Give address to which approved copy of this form is to be sent)					
Name of Authorized Transporter of Casinghead Gas <input checked="" type="checkbox"/> or Dry Gas <input type="checkbox"/>	Address (Give address to which approved copy of this form is to be sent)					
Cities Service Company	P.O. Box 300, Tulsa, OK 74102					
If well produces oil or liquids, give location of tanks.	Unit A	Sec. 31	Twp. 7S	Rge. 32E	Is gas actually connected? Yes	When 2/28/79

If this production is commingled with that from any other lease or pool, give commingling order number: \_\_\_\_\_

IV. COMPLETION DATA

Designate Type of Completion - (X)		Oil Well	Gas Well	New Well	Workover	Deepen	Plug Back	Same Res'v.	Diff. Res'v.
Date Spudded	Date Compl. Ready to Prod.	Total Depth			P.B.T.D.				
Elevations (DF, RKB, RT, GR, etc.)	Name of Producing Formation	Top Oil/Gas Pay			Tubing Depth				
Perforations							Depth Casing Shoe		
TUBING, CASING, AND CEMENTING RECORD									
HOLE SIZE		CASING & TUBING SIZE		DEPTH SET			SACKS CEMENT		

V. TEST DATA AND REQUEST FOR ALLOWABLE OIL WELL (Test must be after recovery of total volume of load oil and must be equal to or exceed top allowable for this depth or be for full 24 hours)

Date First New Oil Run To Tanks	Date of Test	Producing Method (Flow, pump, gas lift, etc.)	
Length of Test	Tubing Pressure	Casing Pressure	Choke Size
Actual Prod. During Test	Oil-Bbls.	Water-Bbls.	Gas-MCF

GAS WELL

Actual Prod. Test-MCF/D	Length of Test	Bbls. Condensate/MMCF	Gravity of Condensate
Testing Method (pilot, back pr.)	Tubing Pressure (shut-in)	Casing Pressure (shut-in)	Choke Size

VI. CERTIFICATE OF COMPLIANCE

I hereby certify that the rules and regulations of the Oil Conservation Commission have been complied with and that the information given above is true and complete to the best of my knowledge and belief.

Richard O. Dimit  
(Signature) R.O. Dimit  
Vice President, Production  
(Title)  
June 19, 1979  
(Date)

OIL CONSERVATION COMMISSION

APPROVED JUN 25 1979, 19\_\_\_\_\_  
BY Jerry S. [Signature]  
TITLE \_\_\_\_\_

This form is to be filed in compliance with RULE 1104.  
If this is a request for allowable for a newly drilled or deepened well, this form must be accompanied by a tabulation of the deviation tests taken on the well in accordance with RULE 111.  
All sections of this form must be filled out completely for allowable on new and recompleted wells.  
Fill out only Sections I, II, III, and VI for changes of owner, well name or number, or transporter, or other such change of condition.

**RECEIVED**

**JUN 22 1979**

**OIL CONSERVATION COMM.  
HOURS: 9. 4.**

NO. OF COPIES RECEIVED		
DISTRIBUTION		
SANTA FE		
FILE		
U.S.G.S.		
LAND OFFICE		
TRANSPORTER	OIL	
	GAS	
OPERATOR		
PRODUCTION OFFICE		

NEW MEXICO OIL CONSERVATION COMMISSION  
REQUEST FOR ALLOWABLE  
AND  
AUTHORIZATION TO TRANSPORT OIL AND NATURAL GAS

Form C-104  
Supersedes Old C-104 and C-1  
Effective 1-1-65

Operator SUNDANCE OIL COMPANY	
Address Suite 510, 1776 Lincoln St., Denver, CO 80203	
Reason(s) for filing (Check proper box)	
New Well <input type="checkbox"/>	Change in Transporter of:
Recompletion <input type="checkbox"/>	Oil <input checked="" type="checkbox"/> Dry Gas <input type="checkbox"/>
Change in Ownership <input type="checkbox"/>	Casinghead Gas <input type="checkbox"/> Condensate <input type="checkbox"/>
Other (Please explain)	

If change of ownership give name  
and address of previous owner

II. DESCRIPTION OF WELL AND LEASE

Lease Name Cone Federal	Well No. 2	Pool Name, Including Formation Tomahawk, San Andres	Kind of Lease State, Federal or Fee Federal	Lease No. 15019
Location Unit Letter C ; 660 Feet From The North Line and 1980 Feet From The West				
Line of Section 31 Township 7S Range 32E, NMPM, Roosevelt County				

III. DESIGNATION OF TRANSPORTER OF OIL AND NATURAL GAS

Name of Authorized Transporter of Oil <input checked="" type="checkbox"/> or Condensate <input type="checkbox"/> Koch Oil Company	Address (Give address to which approved copy of this form is to be sent) P.O. Box 1158, Breckenridge, TX 76024					
Name of Authorized Transporter of Casinghead Gas <input type="checkbox"/> or Dry Gas <input type="checkbox"/>	Address (Give address to which approved copy of this form is to be sent)					
If well produces oil or liquids, give location of tanks.	Unit A	Sec. 31	Twp. 7S	Rge. 32E	Is gas actually connected? No	When

If this production is commingled with that from any other lease or pool, give commingling order number:

IV. COMPLETION DATA

Designate Type of Completion - (X)		Oil Well	Gas Well	New Well	Workover	Deepen	Plug Back	Same Resrv.	Diff. Resrv.
Date Spudded	Date Compl. Ready to Prod.	Total Depth			P.B.T.D.				
Elevations (DF, RKB, RT, GR, etc.)	Name of Producing Formation	Top Oil/Gas Pay			Tubing Depth				
Perforations							Depth Casing Shoe		
TUBING, CASING, AND CEMENTING RECORD									
HOLE SIZE	CASING & TUBING SIZE		DEPTH SET			SACKS CEMENT			

V. TEST DATA AND REQUEST FOR ALLOWABLE OIL WELL (Test must be after recovery of total volume of load oil and must be equal to or exceed top allowable for this depth or be for full 24 hours)

Date First New Oil Run To Tanks	Date of Test	Producing Method (Flow, pump, gas lift, etc.)	
Length of Test	Tubing Pressure	Casing Pressure	Choke Size
Actual Prod. During Test	Oil-Bbls.	Water-Bbls.	Gas-MCF

GAS WELL

Actual Prod. Test-MCF/D	Length of Test	Bbls. Condensate/MMCF	Gravity of Condensate
Testing Method (pitot, back pr.)	Tubing Pressure (Shut-in)	Casing Pressure (Shut-in)	Choke Size

CERTIFICATE OF COMPLIANCE

I hereby certify that the rules and regulations of the Oil Conservation Commission have been complied with and that the information given above is true and complete to the best of my knowledge and belief.

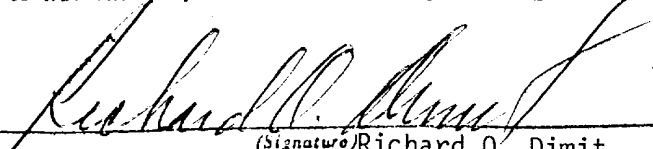
  
(Signature) Richard O. Dimit  
Vice-President, Production  
(Title)  
July 28, 1978  
(Date)

OIL CONSERVATION COMMISSION  
APPROVED AUG 1 1978, 19  
BY Jerry Weston  
TITLE Dist. I. Secy.

This form is to be filed in compliance with RULE 1104.  
If this is a request for allowable for a newly drilled or deepened well, this form must be accompanied by a tabulation of the deviation tests taken on the well in accordance with RULE 111.  
All sections of this form must be filled out completely for allowable on new and recompleted wells.  
Fill out only Sections I, II, III, and VI for changes of owner, well name or number, or transporter, or other such change of condition.



RECEIVED

JUL 1 1978

COMMUNICATION COMM.  
ROSS. H. M.

UNITED STATES  
DEPARTMENT OF THE INTERIOR  
GEOLOGICAL SURVEY

SUBMIT IN DUPLICATE

(See other instructions on reverse side)

Form approved.  
Budget Bureau No. 42-R355.5.

## WELL COMPLETION OR RECOMPLETION REPORT AND LOG \*

5. LEASE DESIGNATION AND SERIAL NO.

NM-15019

6. IF INDIAN, ALLOTTEE OR TRIBE NAME

7. UNIT AGREEMENT NAME

8. FARM OR LEASE NAME

Cone Federal

9. WELL NO.

2

10. FIELD AND POOL, OR WILDCAT

Tomahawk San Andres

11. SEC., T., R., M., OR BLOCK AND SURVEY OR AREA

Section 31, T. 7S., R. 32E.

12. COUNTY OR PARISH

Roosevelt

13. STATE

New Mexico

1a. TYPE OF WELL: OIL WELL ☒ GAS WELL ☐ DRY ☐ Other

b. TYPE OF COMPLETION:

NEW WELL ☒ WORK OVER ☐ DEEP-EN ☐ PLUG BACK ☐ DIFF. RESVR. ☐ Other

2. NAME OF OPERATOR

SUNDANCE OIL COMPANY

3. ADDRESS OF OPERATOR

Suite 510, 1776 Lincoln St., Denver, CO 80203

4. LOCATION OF WELL (Report location clearly and in accordance with any State requirements)\*

At surface 660' FNL and 1980' FWL

Unit C

At top prod. interval reported below

Same

At total depth

Same

14. PERMIT NO.

DATE ISSUED

9/29/77

15. DATE SPUDDED 12/21/77 16. DATE T.D. REACHED 1/1/78 17. DATE COMPL. (Ready to prod.) 1/16/78 18. ELEVATIONS (DF, RKB, RT, GR, ETC.)\* 4438' KB, 4428' GR 19. ELEV. CASINGHEAD Same

20. TOTAL DEPTH, MD &amp; TVD 4320 21. PLUG, BACK T.D., MD &amp; TVD 4286 22. IF MULTIPLE COMPL., HOW MANY\* N/A 23. INTERVALS DRILLED BY → A11 24. PRODUCING INTERVAL(S), OF THIS COMPLETION—TOP, BOTTOM, NAME (MD AND TVD)\* 4132-44' - P-2 zone of San Andres Formation 4152-72' - P-2 zone of San Andres Formation 25. WAS DIRECTIONAL SURVEY MADE Yes

26. TYPE ELECTRIC AND OTHER LOGS RUN

Schlumberger DLL/RX0, SNP-GL

27. WAS WELL CORED

No

28. CASING RECORD (Report all strings set in well)

CASING SIZE	WEIGHT, LB./FT.	DEPTH SET (MD)	HOLE SIZE	CEMENTING RECORD	AMOUNT PULLED
8 5/8"	24	1799'	12 1/4"	600 sx	None
4 1/2"	10.5, 11.6	4320'	7 7/8"	300 sx	None

29. LINER RECORD

SIZE	TOP (MD)	BOTTOM (MD)	SACKS CEMENT*	SCREEN (MD)	SIZE	DEPTH SET (MD)	PACKER SET (MD)
					2 3/8"	4025'	

31. PERFORATION RECORD (Interval, size and number)

4132-44' w/2 spf, 24 holes  
4152-72' w/2 spf, 40 holes

32. ACID, SHOT, FRACTURE, CEMENT SQUEEZE, ETC.

DEPTH INTERVAL (MD)	AMOUNT AND KIND OF MATERIAL USED
4132-72'	3500 gal. 20% acid w/ball sealers

33.\* PRODUCTION

DATE FIRST PRODUCTION		PRODUCTION METHOD (Flowing, gas lift, pumping—size and type of pump)				WELL STATUS (Producing or shut-in)	
1/16/78		Flowing				Producing	
DATE OF TEST	HOURS TESTED	CHOKE SIZE	PROD'N. FOR TEST PERIOD	OIL—BBL.	GAS—MCF.	WATER—BBL.	GAS-OIL RATIO
1/16/78	24	23/64	→	200	95	0	475:1
FLOW. TUBING PRESS.	CASING PRESSURE	CALCULATED 24-HOUR RATE	OIL—BBL.	GAS—MCF.	WATER—BBL.	OIL GRAVITY-API (CORR.)	
110	400	→	200	95	0		

34. DISPOSITION OF GAS (Sold, used for fuel, vented, etc.)

Used on lease for fuel

TEST WITNESSED BY

Jim Akin

35. LIST OF ATTACHMENTS

36. I hereby certify that the foregoing and attached information is complete and correct as determined from all available records

SIGNED

Richard O. Dinitz

TITLE

Chief Engineer

DATE

January 17, 1978

\*(See Instructions and Spaces for Additional Data on Reverse Side)

mp

# INSTRUCTIONS

**General:** This form is designed for submitting a complete and correct well completion report and log on all types of lands and leases to either a Federal agency or a State agency, or both, pursuant to applicable Federal and/or State laws and regulations. Any necessary special instructions concerning the use of this form and the number of copies to be submitted, particularly with regard to local, area, or regional procedures and practices, either are shown below or will be issued by, or may be obtained from, the local Federal and/or State office. See instructions on items 22 and 24, and 33, below regarding separate reports for separate completions.

If not filed prior to the time this summary record is submitted, copies of all currently available logs (drillers, geologists, sample and core analysis, all types electric, etc.), formation and pressure tests, and directional surveys, should be attached hereto, to the extent required by applicable Federal and/or State laws and regulations. All attachments should be listed on this form, see item 35.

**Item 4:** If there are no applicable State requirements, locations on Federal or Indian land should be described in accordance with Federal requirements. Consult local State or Federal office for specific instructions.

**Item 18:** Indicate which elevation is used as reference (where not otherwise shown) for depth measurements given in other spaces on this form and in any attachments.

**Items 22 and 24:** If this well is completed for separate production from more than one interval zone (multiple completion), so state in item 22, and in item 24 show the producing interval, or intervals, top(s), bottom(s) and name(s) (if any) for only the interval reported in item 33. Submit a separate report (page) on this form, adequately identified, for each additional interval to be separately produced, showing the additional data pertinent to such interval.

**Item 29:** "Sacks Cement": Attached supplemental records for this well should show the details of any multiple stage cementing and the location of the cementing tool.

**Item 33:** Submit a separate completion report on this form for each interval to be separately produced. (See instruction for items 22 and 24 above.)

37. SUMMARY OF POROUS ZONES: SHOW ALL IMPORTANT ZONES OF POROSITY AND CONTENTS THEREOF; CORED INTERVALS; AND ALL DRILL-STEM TESTS, INCLUDING DEPTH INTERVAL TESTED, CUSHION USED, TIME TOOL OPEN, FLOWING AND SHUT-IN PRESSURES, AND RECOVERIES			38. GEOLOGIC MARKERS				
FORMATION	TOP	BOTTOM	DESCRIPTION, CONTENTS, ETC.	NAME	MEAS. DEPTH	TOP	TRUE VERT. DEPTH
			DST #1: 4115-4205' 30/60/120/180  Rec. 2300' oil 40' VSOCMW  IHP: 2247 FHP: 2221 IFP: 119-292 FFP: 358-714 ISIP: 1281 FSIP: 1281  BHT: 102°F.	Rustler Salado Yates San Andres Pi Marker P-1 P-2 P-3	1774' 1822' 2176' 3331' 3884' 4037' 4118' 4230'		Same Same Same Same Same Same Same Same

NEW MEXICO OIL CONSERVATION COMMISSION  
REQUEST FOR ALLOWABLE  
AND  
AUTHORIZATION TO TRANSPORT OIL AND NATURAL GAS

Form C-104  
Supersedes Old C-104 and C-11.  
Effective 1-1-65

NO. OF COPIES RECEIVED		
DISTRIBUTION		
SANTA FE		
FILE		
U.S.G.S.		
LAND OFFICE		
TRANSPORTER	OIL	
	GAS	
OPERATOR		
PRORATION OFFICE		

I. Operator  
SUNDANCE OIL COMPANY  
Address  
Suite 510, 1776 Lincoln St., Denver, CO 80203  
Reason(s) for filing (Check proper box)  
New Well ☒ Change In Transporter of:  
Recompletion ☐ Oil ☒ Dry Gas ☐  
Change In Ownership ☐ Casinghead Gas ☐ Condensate ☐  
Other (Please explain) **CASINGHEAD GAS MUST NOT BE FLARED AFTER 3/2/78 UNLESS AN EXCEPTION TO R-4070 IS OBTAINED.**

If change of ownership give name and address of previous owner

THIS WELL HAS BEEN PLACED IN THE POOL  
DESIGNATED BELOW. IF YOU DO NOT CONCUR  
NOTIFY THIS OFFICE. R-5067

II. DESCRIPTION OF WELL AND LEASE

Lease Name Cone Federal	Well No. 2	Pool Name, including Formation Tomahawk San Andres	Kind of Lease State, Federal or Fee Federal	Lease No. 15019
Location Unit Letter C ; 660 Feet From The North Line and 1980 Feet From The West Line of Section 31 Township 7S Range 32E , NMPM, Roosevelt County				

III. DESIGNATION OF TRANSPORTER OF OIL AND NATURAL GAS

Name of Authorized Transporter of Oil <input checked="" type="checkbox"/> or Condensate <input type="checkbox"/> Navajo Crude Oil	Address (Give address to which approved copy of this form is to be sent) P.O. Drawer 175, Artesia, NM 88210	
Name of Authorized Transporter of Casinghead Gas <input type="checkbox"/> or Dry Gas <input type="checkbox"/> N/A	Address (Give address to which approved copy of this form is to be sent)	
If well produces oil or liquids, give location of tanks.	Unit A	Sec. 31
	Twp. 7S	Rge. 32E
	Is gas actually connected? No	
	When	

If this production is commingled with that from any other lease or pool, give commingling order number:

IV. COMPLETION DATA

Designate Type of Completion - (X)	Oil Well <input checked="" type="checkbox"/>	Gas Well	New Well <input checked="" type="checkbox"/>	Workover	Deepen	Plug Back	Same Res'v.	Diff. Res'v.
Date Spudded 12/21/77	Date Compl. Ready to Prod. 1/16/78	Total Depth 4320	P.B.T.D. 4286					
Elevations (DF, RKB, RT, GR, etc.) 4438' KB, 4428' GR	Name of Producing Formation San Andres	Top Oil/Gas Pay 4132	Tubing Depth 4025					
Perforations 4132-44', 4152-72'			Depth Casing Shoe 4320					
TUBING, CASING, AND CEMENTING RECORD								
HOLE SIZE	CASING & TUBING SIZE		DEPTH SET		SACKS CEMENT			
12 1/4"	8 5/8"		1799'		600 sx			
7 7/8"	4 1/2"		4320'		300 sx			

V. TEST DATA AND REQUEST FOR ALLOWABLE OIL WELL (Test must be after recovery of total volume of load oil and must be equal to or exceed top allowable for this depth or be for full 24 hours)

Date First New Oil Run To Tanks 1/7/78	Date of Test 1/15/78	Producing Method (Flow, pump, gas lift, etc.) Flowing	
Length of Test 24 hrs.	Tubing Pressure 110	Casing Pressure 400	Choke Size 23/64"
Actual Prod. During Test 200 BO	Oil-Bbls. 200	Water-Bbls. 0	Gas-MCF 95

GAS WELL

Actual Prod. Test-MCF/D	Length of Test	Bbls. Condensate/MMCF	Gravity of Condensate
Testing Method (pitot, back pr.)	Tubing Pressure (Shut-in)	Casing Pressure (Shut-in)	Choke Size

VI. CERTIFICATE OF COMPLIANCE

I hereby certify that the rules and regulations of the Oil Conservation Commission have been complied with and that the information given above is true and complete to the best of my knowledge and belief.

Richard O. Dimit  
Chief Engineer  
January 17, 1978  
(Signature)  
(Title)  
(Date)

OIL CONSERVATION COMMISSION

APPROVED JAN 20 1978  
BY [Signature]  
TITLE DISTRICT I

This form is to be filed in compliance with RULE 1104.

If this is a request for allowable for a newly drilled or deepened well, this form must be accompanied by a tabulation of the deviation tests taken on the well in accordance with RULE 111.

All sections of this form must be filled out completely for allowable on new and recompletion wells.

Fill out only Sections I, II, III, and VI for changes of owner, well name or number, or transporter, or other such change of condition.

RECEIVED

JAN 18 1978

OIL CONSERVATION COM.  
WORKS. N. M.

UNITED STATES  
DEPARTMENT OF THE INTERIOR  
GEOLOGICAL SURVEY

WPT 10 O.S.C.  
SUBMIT IN TRIPLICATE\*  
(Other instructions on re-  
verse side)

Form approved.  
Budget Bureau No. 42-R1424.

SUNDRY NOTICES AND REPORTS ON WELLS

(Do not use this form for proposals to drill or to deepen or plug back to a different reservoir.  
Use "APPLICATION FOR PERMIT—" for such proposals.)

1. OIL WELL ☒ GAS WELL ☐ OTHER ☐

2. NAME OF OPERATOR  
SUNDANCE OIL COMPANY

3. ADDRESS OF OPERATOR  
Suite 510, 1776 Lincoln St., Denver, CO 80203

4. LOCATION OF WELL (Report location clearly and in accordance with any State requirements.\*  
See also space 17 below.)  
At surface  
660' FNL and 1980' FWL Unit C

14. PERMIT NO.

15. ELEVATIONS (Show whether DF, RT, GR, etc.)  
4438' KB, 4428' GR

5. LEASE DESIGNATION AND SERIAL NO.  
NM-15019

6. IF INDIAN, ALLOTTEE OR TRIBE NAME

7. UNIT AGREEMENT NAME

8. FARM OR LEASE NAME  
Cone Federal

9. WELL NO.  
1 2

10. FIELD AND POOL, OR WILDCAT  
Tomahawk San Andres

11. SEC., T., R., M., OR BLK. AND SURVEY OR AREA  
Section 31, T. 7S., R. 32E.

12. COUNTY OR PARISH  
Roosevelt

13. STATE  
New Mexico

16. Check Appropriate Box To Indicate Nature of Notice, Report, or Other Data

NOTICE OF INTENTION TO:		SUBSEQUENT REPORT OF:	
TEST WATER SHUT-OFF <input type="checkbox"/>	PULL OR ALTER CASING <input type="checkbox"/>	WATER SHUT-OFF <input type="checkbox"/>	REPAIRING WELL <input type="checkbox"/>
FRACTURE TREAT <input type="checkbox"/>	MULTIPLE COMPLETE <input type="checkbox"/>	FRACTURE TREATMENT <input type="checkbox"/>	ALTERING CASING <input type="checkbox"/>
SHOOT OR ACIDIZE <input type="checkbox"/>	ABANDON* <input type="checkbox"/>	SHOOTING OR ACIDIZING <input type="checkbox"/>	ABANDONMENT* <input type="checkbox"/>
REPAIR WELL <input type="checkbox"/>	CHANGE PLANS <input type="checkbox"/>	(Other) SET PRODUCTION CASING <input checked="" type="checkbox"/>	

(Other) ☐

(NOTE: Report results of multiple completion on Well Completion or Recompletion Report and Log form.)

17. DESCRIBE PROPOSED OR COMPLETED OPERATIONS (Clearly state all pertinent details, and give pertinent dates, including estimated date of starting any proposed work. If well is directionally drilled, give subsurface locations and measured and true vertical depths for all markers and zones pertinent to this work.)\*

Drilled to TD of 4320'. Ran Sidewall Neutron and Dual Laterolog. Ran 136 jts. of 4 1/2" casing. Set at 4320'. Cemented w/300 sx Class C 50/50 Pozmix w/2% gel, 8# salt, 3/10th of 1% CFR-2. Plug down at 8:45 a.m. 1/2/78. PBD 4286'. WOCU.

18. I hereby certify that the foregoing is true and correct.

SIGNED Richard O. Dimit TITLE Chief Engineer

(This space for Federal or State office use)

APPROVED BY \_\_\_\_\_ TITLE \_\_\_\_\_

CONDITIONS OF APPROVAL, IF ANY:

\*See Instructions on Reverse Side

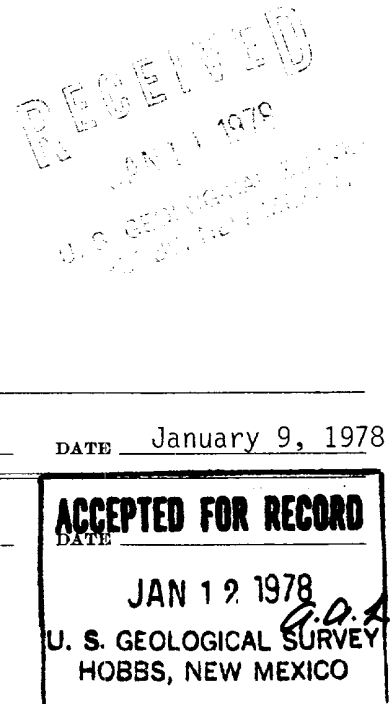

001337 571 210012

RECEIVED

JAN 17 1958  
OIL CONSERVATION COMM.  
HOBBS, N. M.



KENNETH D. REYNOLDS - ARTEBIA  
LESLIE K. EVERTSON - ROSWELL

**DRILLING CO., INC. - OIL WELL DRILLING CONTRACTORS**

P. O. Box 2055 ROSWELL, NEW MEXICO 88201  
TELEPHONES: ARTEBIA 505/746-6757  
ROSWELL 505/623-5070

January 4, 1978

Sundance Oil Co.  
1776 Lincoln Street  
Suite 510  
Denver, Colorado 80204

Re: Cone Federal #2

Gentlemen:

The following is a Deviation Survey of the above well:

475' - $1/4^{\circ}$	2700' - $3/4^{\circ}$
935' - $1/4^{\circ}$	3200' - $3/4^{\circ}$
1400' - $3/4^{\circ}$	3672' - $1/2^{\circ}$
1582' - $3/4^{\circ}$	4100' - $1/2^{\circ}$
1800' - $3/4^{\circ}$	4320' - $1/2^{\circ}$ T.D.
2260' - $1\ 1/4^{\circ}$	

Yours very truly,

WEK DRILLING CO., INC.

*Arnold Newkirk*  
Arnold Newkirk

STATE OF NEW MEXICO )  
COUNTY OF CHAVES )

The foregoing was acknowledged before me this 4<sup>th</sup> day  
of January, 1978 by Arnold Newkirk.

My Commission Expires:

April 9, 1980

*Glenda Bea Newton*  
Notary Public



RECEIVED

JAN 19 1978

OIL CONSERVATION COMM.  
HOBBS, N. M.

UNITED STATES  
DEPARTMENT OF THE INTERIOR  
GEOLOGICAL SURVEY

SUBMIT IN TRIPLICATE\*  
(Other instructions on re-  
verse side)

Form approved.  
Budget Bureau No. 42-R1424.

5. LEASE DESIGNATION AND SERIAL NO.

NM-15019

6. IF INDIAN, ALLOTTEE OR TRIBE NAME

SUNDRY NOTICES AND REPORTS ON WELLS

(Do not use this form for proposals to drill or to deepen or plug back to a different reservoir.  
Use "APPLICATION FOR PERMIT—" for such proposals.)

1. OIL WELL ☒ GAS WELL ☐ OTHER ☐

2. NAME OF OPERATOR

SUNDANCE OIL COMPANY

3. ADDRESS OF OPERATOR

Suite 510, 1776 Lincoln St., Denver, CO 80203 S. GEOLOGICAL SURVEY

4. LOCATION OF WELL (Report location clearly and in accordance with any State requirements. See also space 17 below.)  
At surface

660' FNL and 1980' FWL

Unit C

14. PERMIT NO.

15. ELEVATIONS (Show whether DF, RT, GR, etc.)

4438' KB, 4428' GR

UNIT AGREEMENT NAME

8. FARM OR LEASE NAME

Cone Federal

9. WELL NO.

10. FIELD AND POOL, OR WILDCAT

Tomahawk San Andres

11. SEC., T., R., M., OR BLK. AND  
SURVEY OR AREA

Section 31, T. 7S., R. 32E.

12. COUNTY OR PARISH

Roosevelt

13. STATE

New Mexico

16. Check Appropriate Box To Indicate Nature of Notice, Report, or Other Data

NOTICE OF INTENTION TO:

SUBSEQUENT REPORT OF:

TEST WATER SHUT-OFF ☐

PULL OR ALTER CASING ☐

WATER SHUT-OFF ☐

REPAIRING WELL ☐

FRACTURE TREAT ☐

MULTIPLE COMPLETE ☐

FRACTURE TREATMENT ☐

ALTERING CASING ☐

SHOOT OR ACIDIZE ☐

ABANDON\* ☐

SHOOTING OR ACIDIZING ☐

ABANDONMENT\* ☐

REPAIR WELL ☐

CHANGE PLANS ☐

(Other) ☐

SET SURFACE CASING

XXX

(NOTE: Report results of multiple completion on Well  
Completion or Recompletion Report and Log form.)

17. DESCRIBE PROPOSED OR COMPLETED OPERATIONS (Clearly state all pertinent details, and give pertinent dates, including estimated date of starting any proposed work. If well is directionally drilled, give subsurface locations and measured and true vertical depths for all markers and zones pertinent to this work.) \*

Spudded 12 1/4" hole at 2:30 p.m. 12/21/77. Drilled to 1800'. Ran 48 jts. of 8 5/8", 24#, surface casing. Set at 1799' KB. Cemented w/400 sx Halliburton Lite w/5#/sx Gilsonite, 1/4#/sx flowseal and 2% CaCl followed by 200 sx Class C and 2% CaCl. Circulated 25 sx cement. Plug down at 11:15 p.m. 12/23/77.

18. I hereby certify that the foregoing is true and correct

SIGNED

Richard O. Dimit

TITLE Chief Engineer

DATE December 27, 1977

(This space for Federal or State office use)

APPROVED BY

TITLE

CONDITIONS OF APPROVAL, IF ANY:

\*See Instructions on Reverse Side

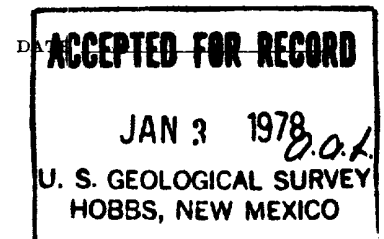

RECEIVED  
JAN 10 1978  
OIL CONSERVATION COMM.  
HOBBBS, N. M.

ORDER NOT SUSTAINED

UNITED STATES  
DEPARTMENT OF THE INTERIOR  
GEOLOGICAL SURVEY

## APPLICATION FOR PERMIT TO DRILL, DEEPEN, OR PLUG BACK

1a. TYPE OF WORK

DRILL ☒DEEPEN ☐PLUG BACK ☐

b. TYPE OF WELL

OIL  
WELL ☒GAS  
WELL ☐

OTHER

SINGLE  
ZONE ☐MULTIPLE  
ZONE ☐

2. NAME OF OPERATOR

SUNDANCE OIL COMPANY

3. ADDRESS OF OPERATOR

Suite 510, 1776 Lincoln St., Denver, CO 80203

4. LOCATION OF WELL (Report location clearly and in accordance with any State requirements\*)  
At surface

660 FNL and 1980 FWL

Unit C

At proposed prod. zone

San Andres

14. DISTANCE IN MILES AND DIRECTION FROM NEAREST TOWN OR POST OFFICE\*

15½ miles southeast of Kenna, New Mexico

15. DISTANCE FROM PROPOSED\*

LOCATION TO NEAREST  
PROPERTY OR LEASE LINE, FT.  
(Also to nearest drlg. unit line, if any)

660

18. DISTANCE FROM PROPOSED LOCATION\*

TO NEAREST WELL, DRILLING, COMPLETED,  
OR APPLIED FOR, ON THIS LEASE, FT.

1320

16. NO. OF ACRES IN LEASE

560

19. PROPOSED DEPTH

4350

17. NO. OF ACRES ASSIGNED  
TO THIS WELL

40

20. ROTARY OR CABLE TOOLS

Rotary Tools

21. ELEVATIONS (Show whether DF, RT, GR, etc.)

4428.5 GL

22. APPROX. DATE WORK WILL START\*

On Approval

23.

## PROPOSED CASING AND CEMENTING PROGRAM

SIZE OF HOLE	SIZE OF CASING	WEIGHT PER FOOT	SETTING DEPTH	QUANTITY OF CEMENT
11	8 5/8	28	1750	260 sx Econ & 100 sx Class C
7 7/8	4 1/2	11.60 & 10.5	4350	300 sx 50/50 Poz

Well will be drilled to TD and evaluated, if further evaluation is required, will log to determine if casing will be run.

Unless Drilling Operations have  
Commenced, this permit for approval  
Expires 12-29-77

SEE ATTACHED FOR  
CONDITIONS OF APPROVAL

IN ABOVE SPACE DESCRIBE PROPOSED PROGRAM: If proposal is to deepen or plug back, give data on present productive zone and proposed new productive zone. If proposal is to drill or deepen directionally, give pertinent data on subsurface locations and measured and true vertical depths. Give blowout preventer program, if any.

24.

SIGNED

Richard C. Dimit

TITLE Chief Engineer

DATE September 13, 1977

(This space for Federal or State office use)

PERMIT NO.

APPROVAL DATE

APPROVED BY

TITLE

CONDITIONS OF APPROVAL, IF ANY:

"APPROVAL TO FLARE GRANTED  
WHILE DRILLING AND TESTING."

\*See Instructions On Reverse Side

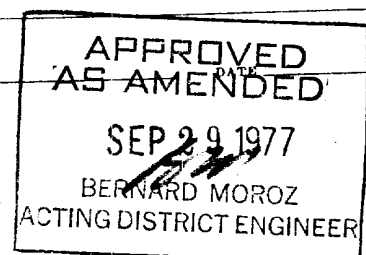

RECEIVED  
JUL 1977  
CAL. COAST GUARDIAN SOCIETY  
HONOLULU, HI

NEW MEXICO OIL CONSERVATION COMMISSION  
WELL LOCATION AND ACREAGE DEDICATION PLAT

Form C-102  
Supersedes C-128  
Effective 1-1-65

All distances must be from the outer boundaries of the Section.

Operator <b>SUNDANCE OIL COMPANY</b>		Lease <b>Cone-Federal</b>		Well No. <b>2</b>
Section Letter <b>C</b>	Section <b>31</b>	Township <b>7 South</b>	Range <b>32 East</b>	County <b>Roosevelt</b>
Actual Well Location of Well:				
<b>660</b>	feet from the	<b>north</b>	<b>1980</b>	feet from the
				<b>west</b>
Initial Level Elev. <b>4428.5</b>	Producing Formation <b>SAN ANDRES</b>		Designation <b>UNDESIGNATED</b>	Estimated Acreage <b>40</b>

1. Outline the acreage dedicated to the subject well by colored pencil or hatchure marks on the plat below.
2. If more than one lease is dedicated to the well, outline each and identify the ownership thereof (both as to working interest and royalty).
3. If more than one lease of different ownership is dedicated to the well, have the interests of all owners been consolidated by communitization, unitization, force-pooling, etc?

☒ Yes ☐ No If answer is "yes" type of consolidation \_\_\_\_\_

If answer is "no," list the owners and tract descriptions which have actually been consolidated. (Use reverse side of this form if necessary.) \_\_\_\_\_

No allowable will be assigned to the well until all interests have been consolidated (by communitization, unitization, forced-pooling, or otherwise) or until a non-standard unit, eliminating such interests, has been approved by the Commission.

CERTIFICATION

I hereby certify that the information contained herein is true and complete to the best of my knowledge and belief.

*Richard O. Dimit*  
**Richard O. Dimit**

**Chief Engineer**

**Sundance Oil Company**

**September 13, 1977**

I hereby certify that the well location shown on this plat was plotted from field notes of actual surveys made by me or under my supervision, and that the same is true and correct to the best of my knowledge and belief.

**Aug. 15, 1977**

*John W. West*  
**John W. West**

OIL CONSERVATION COMM.  
HOBBS, N. M.

OCT - 4 1977

RECEIVED

Attachment to Form 9-331 C  
Application for Permit to Drill

Sundance Oil Company, #2 Cone Federal  
660' FNL and 1980' FWL of Section 31, T. 7S., R. 32E.  
Roosevelt County, New Mexico

1. The geologic name of the surface information is Triassic red beds overlain by wind blown sands.
2. The estimated tops of important geologic markers are as follows:

Rustler	1750'
Salado	1790'
Yates	2180'
San Andres	3310'
P-1	4020'
P-2	4100'
T.D.	4220'

3. The estimated depths at which anticipated water, oil, gas or other mineral bearing formations will be encountered are as follows:

Ogalala	150' water
Salado	1790' salt
San Andres	3310' oil and gas
P-1	4020' oil and gas
P-2	4220' oil and gas

4. The proposed casing program is as follows:

Surface - New 8 5/8", 28 lb/ft., ST&C, Secondary 45 (J&L).  
Production - New 4 1/2", 10.5 lb/ft., ST&C, K-55 and 11.6 lb/ft.,  
ST&C, JCW-36 (J&L).

5. A sketch of an API Series 900 Blowout Preventer is attached. Pipe rams and blinds will be checked to 1,000 PSI for 30 minutes when BOP is installed. BOP will be checked when casing is set and operated daily for checks.
6. The proposed mud program is as follows:

0-1800' spud mud	8.5 - 9.0 lbs./gal.
1800-3800' native mud	9.0 - 9.5 lbs./gal.
3800' to TD salt gel	9.0 - 10.0 lbs./gal.



Attachment to Form 9-331 C  
Application for Permit to Drill  
#2 Cone Federal  
Page Two

7. The auxiliary equipment to be used is:

- (1) Kelly cocks.
- (2) Floats at the bit.
- (3) Stabbing valve on rig floor with sub to fit drill pipe.

8. It is proposed to run 2" and 5" GR, CNL, FDC, DLL/MLL Logs from TD to 1800'.

9. No abnormal pressures or temperatures are expected to be encountered in this well.

10. The anticipated starting date for this well is December 1, 1977. Estimated duration of drilling operations is 10 to 12 days.

SUNDANCE OIL CO.  
P.O. BOX 115  
Roswell, N.M. 88201  
September 19, 1977

USGS  
PO Box 1157  
205 N. Linam Street  
Hobbs, NM 88240

Re: Agreement with Surface  
Landowner - Sundance  
Oil Co. #2 Cone Fed.,  
Sec. 31-T7S-R32E,  
660' FN & 1980' FWL  
Roosevelt Co., NM

Dear Sir:

This is to certify that in regard to captioned well, Sundance Oil Co. has an agreement with the surface owner in regard to the surface restoration.

If this well is completed as a producing well, the pits are to be filled and covered and the location cleaned of all trash and junk in order to leave the wellsite in an aesthetically pleasing condition. Prior to the filling of the pits any unguarded pit containing fluid will be fenced.

If the well is completed as a dry hole and plugged and abandoned, pits will be covered, location cleaned of all trash and junk. The road will remain in place. The drilling pad will either remain or be ripped at the landowner's option.

Sincerely,

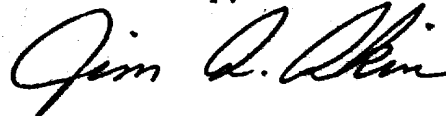

Jim A. Akin  
Field Superintendent  
Permian Basin Area

JAA:ss



## SURFACE USE PLAN

Sundance Oil Company: Cone Federal #2  
660' FNL and 1980' FWL of Section 31, T. 7S., R. 32E.  
Roosevelt County, New Mexico

This plan is to accompany "Application for Permit to Drill" the subject well which is located approximately 15½ miles SSE of Kenna, New Mexico. The following is a discussion of pertinent information concerning possible effect which the proposed drilling of the well may have on the environment of the well and road sites and surrounding acreage.

### 1. Existing Roads

- A. The proposed well site is 660' FNL and 1980' FWL of Section 31, T. 7S., R. 32E., Roosevelt County, New Mexico.
- B. Exhibit "A" is portion of a map showing existing roads with directions to the location from Kenna, New Mexico. The route to the location is marked in red along side of roads to be used. The well location is approximately 15½ miles SSE of Kenna, New Mexico.
- C., D., & E. Access roads are shown on Exhibit "A".
- F. No improvement or maintenance is anticipated for the existing roads.

### 2. Planned Access Roads

- A. A road will be required. It will be approximately 1300' due south from Chambers Federal #2 and 1300' due west to the location.
- B. Turnouts: None.
- C. Drainage Design: New road will have a drop of 6 inches from center line on each side.
- D. Culverts, Cuts and Fills: Culverts - none. The location and pits will be constructed as shown on Exhibit C. Maximum cut will be 3' on the east and maximum fill will be 3' on the west of the location, other than leveling sand dunes.
- E. Surfacing Material: Six inches of caliche, bladed, watered and compacted.
- F. Gates, Cattleguards, Fences: None.
- G. The proposed road is existing.

### 3. Location of Existing Wells

- A. See Exhibit B.

4. Location of Existing and/or Proposed Facilities

- A. There is an existing tank battery with production facilities and lines owned by the lessee/operator on this lease.
- B. If commercial production is established, facilities and lines will be connected to the existing battery. Pads for equipment will be made with caliche. Facilities will be fenced and/or covered to protect livestock and wildlife.
- C. All unused areas disturbed by construction will be restored to natural terrain profile after construction is completed.

5. Location and Type of Water Supply

- A. Water will be obtained from well at Kenna and/or Crossroads.
- B. Water will be transported by truck.

6. Source of Construction Materials

- A. Caliche will be obtained from a pit in Section 7, T. 7S., R. 32E. Fee minerals owned by F. P. Southard.

7. Methods for Handling Waste Disposal

- A. Waste Disposal - well cuttings will be disposed in reserve pit. Barrel trash containers to be in accessible locations within drill site area during drilling and completion procedures. All detrimental waste will be hauled away, burned or buried with a minimum cover of 24" of dirt. See Exhibit C for location of pits. If well is productive, maintenance waste will be placed in special trash cans and hauled away periodically. Any produced water will be collected in tanks until hauled to an approved disposal system, or separate disposal applications will be submitted to the survey for appropriate approval.

8. Ancillary Facilities

None.

9. Well Site Layout

- A. Exhibit C shows the relative location and dimensions of the well pad, mud pit, reserve pit, trash barrel, etc. The reserve pit will be lined with plastic. The pad and pits are staked.

10. Plans for Restoration of Surface

- A. Pits will be backfilled and leveled as soon as practical to original condition. Commencement of rehabilitation operations will immediately follow removal of drilling and completion

equipment from location and rehabilitation of the surface is planned to be completed within 45 days from commencement.

11. Other Information

- A. Terrain: Low rolling sand hills.
- B. Soil: Sandy.
- C. Vegetation: Scrub oak, bear grass and very sparse vegetation.
- D. Surface Use: Grazing.
- E. Ponds and Streams: None within one mile.
- F. Water Wells: One mile northwest of location.
- G. Residences and Buildings: Three miles northwest of location.
- H. Arroyos, Canyons, Etc.: Caprock escarpment approximately one mile west of location.
- I. Well Sign: Sign identifying and locating well will be maintained at drill site with the spudding of the well.
- J. Open Pits: All pits containing mud or other liquids will be fenced.
- K. Archaeological Resources: None observed.

12. Lessee's or Operator's Representative

Richard O. Dimit  
Sundance Oil Company  
Suite 510, 1776 Lincoln St.  
Denver, CO 80203

Business phone: (303) 825-7657

Home phone: (303) 841-4592

13. Certification

I hereby certify that I, or persons under my direct supervision, have inspected the proposed drill site and access route; that I am familiar with the conditions which presently exist; that the statements made in this plan are, to the best of my knowledge, true and correct; and, that the work associated with the operations proposed herein will be performed by SUNDANCE OIL COMPANY and its contractors and sub-contractors in conformity with this plan and the terms and conditions under which it is approved.

Date

9/13/77

  
Richard O. Dimit  
Chief Engineer

April 21, 1977

AGREEMENT

Sundance Oil Co. agrees to pay \$100.00 each time they cut and set a cattle guard in the fence line.

Sundance Oil Co. agrees to pay \$4.00 a rod for new roads and \$750.00 for each well site location, \$250.00 for a tank battery pad built between locations and \$1.00 a rod for pipeline not laid beside road right-of-ways. \$3.00 a rod for pipeline right-of-way that have to be built or made by a tractor or motor grader.

This agreement is payable only to Sec. 30 & 31, Twn. 7S, Rge. 32E, which is Fee surface.

Caliche to be hauled from pit in Sec. 7, Twn. 7S, Rge. 32E. Price on yardage will be paid directly from Sundance Oil Co.

William N. Morgan  
William N. Morgan  
Representative of  
Sundance Oil Co.

Frank P. Southard  
Frank P. Southard  
Land Owner

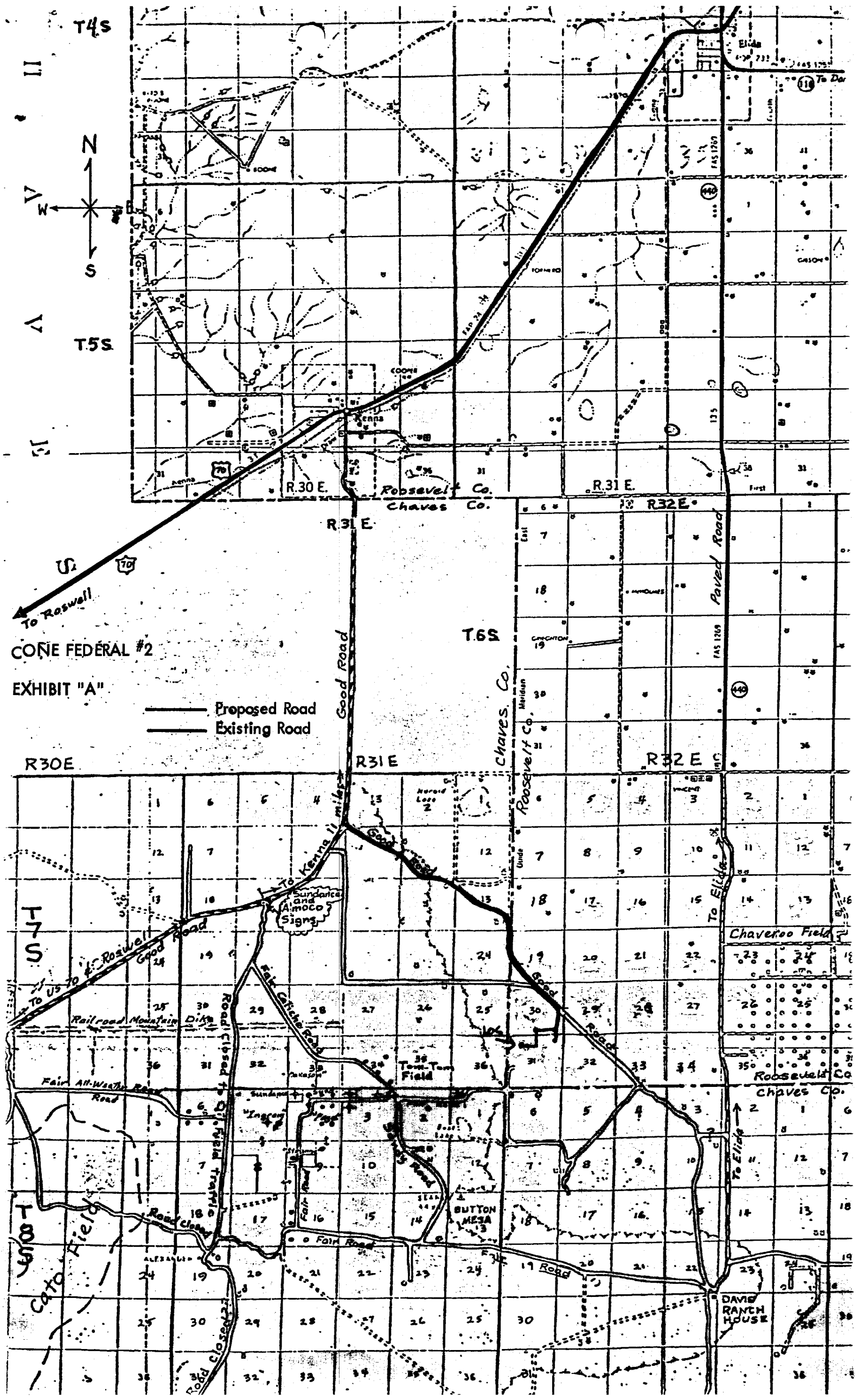

T4S

T5S

T6S

T7S

R30E

R31E

R32E

R33E

R34E

R35E

R36E

R37E

R38E

R39E

R40E

R41E

R42E

R43E

R44E

R45E

R46E

R47E

R48E

R49E

R50E

R51E

R52E

R53E

R54E

R55E

R56E

R57E

R58E

R59E

R60E

R61E

R62E

R63E

R64E

R65E

R66E

R67E

R68E

R69E

R70E

R71E

R72E

R73E

R74E

R75E

R76E

R77E

R78E

R79E

R80E

R81E

R82E

R83E

R84E

R85E

R86E

R87E

R88E

R89E

R90E

R91E

R92E

R93E

R94E

R95E

R96E

R97E

R98E

R99E

R100E

R101E

R102E

R103E

R104E

R105E

R106E

R107E

R108E

R109E

R110E

R111E

R112E

R113E

R114E

R115E

R116E

R117E

R118E

R119E

R120E

R121E

R122E

R123E

R124E

R125E

R126E

R127E

R128E

R129E

R130E

R131E

R132E

R133E

R134E

R135E

R136E

R137E

R138E

R139E

R140E

R141E

R142E

R143E

R144E

R145E

R146E

R147E

R148E

R149E

R150E

R151E

R152E

R153E

R154E

R155E

R156E

R157E

R158E

R159E

R160E

R161E

R162E

R163E

R164E

R165E

R166E

R167E

R168E

R169E

R170E

R171E

R172E

R173E

R174E

R175E

R176E

R177E

R178E

R179E

R180E

R181E

R182E

R183E

R184E

R185E

R186E

R187E

R188E

R189E

R190E

R191E

R192E

R193E

R194E

R195E

R196E

R197E

R198E

R199E

R200E

R201E

R202E

R203E

R204E

R205E

R206E

R207E

R208E

R209E

R210E

R211E

R212E

R213E

R214E

R215E

R216E

R217E

R218E

R219E

R220E

R221E

R222E

R223E

R224E

R225E

R226E

R227E

R228E

R229E

R230E

R231E

R232E

R233E

R234E

R235E

R236E

R237E

R238E

R239E

R240E

R241E

R242E

R243E

R244E

R245E

R246E

R247E

R248E

R249E

R250E

R251E

R252E

R253E

R254E

R255E

R256E

R257E

R258E

R259E

R260E

R261E

R262E

R263E

R264E

R265E

R266E

R267E

R268E

R269E

R270E

R271E

R272E

R273E

R274E

R275E

R276E

R277E

R278E

R279E

R280E

R281E

R282E

R283E

R284E

R285E

R286E

R287E

R288E

R289E

R290E

R291E

R292E

R293E

R294E

R295E

R296E

R297E

R298E

R299E

R300E

R301E

R302E

R303E

R304E

R305E

R306E

R307E

R308E

R309E

R310E

R311E

R312E

R313E

R314E

R315E

R316E

R317E

R318E

R319E

R320E

R321E

R322E

R323E

R324E

R325E

R326E

R327E

R328E

R329E

R330E

R331E

R332E

R333E

R334E

R335E

R336E

R337E

R338E

R339E

R340E

R341E

R342E

R343E

R344E

R345E

R346E

R347E

R348E

R349E

R350E

R351E

R352E

R353E

R354E





LOCATION, MUD PIT AND  
PROPOSED TANK BATTERY  
AREA SPECIFICATIONS

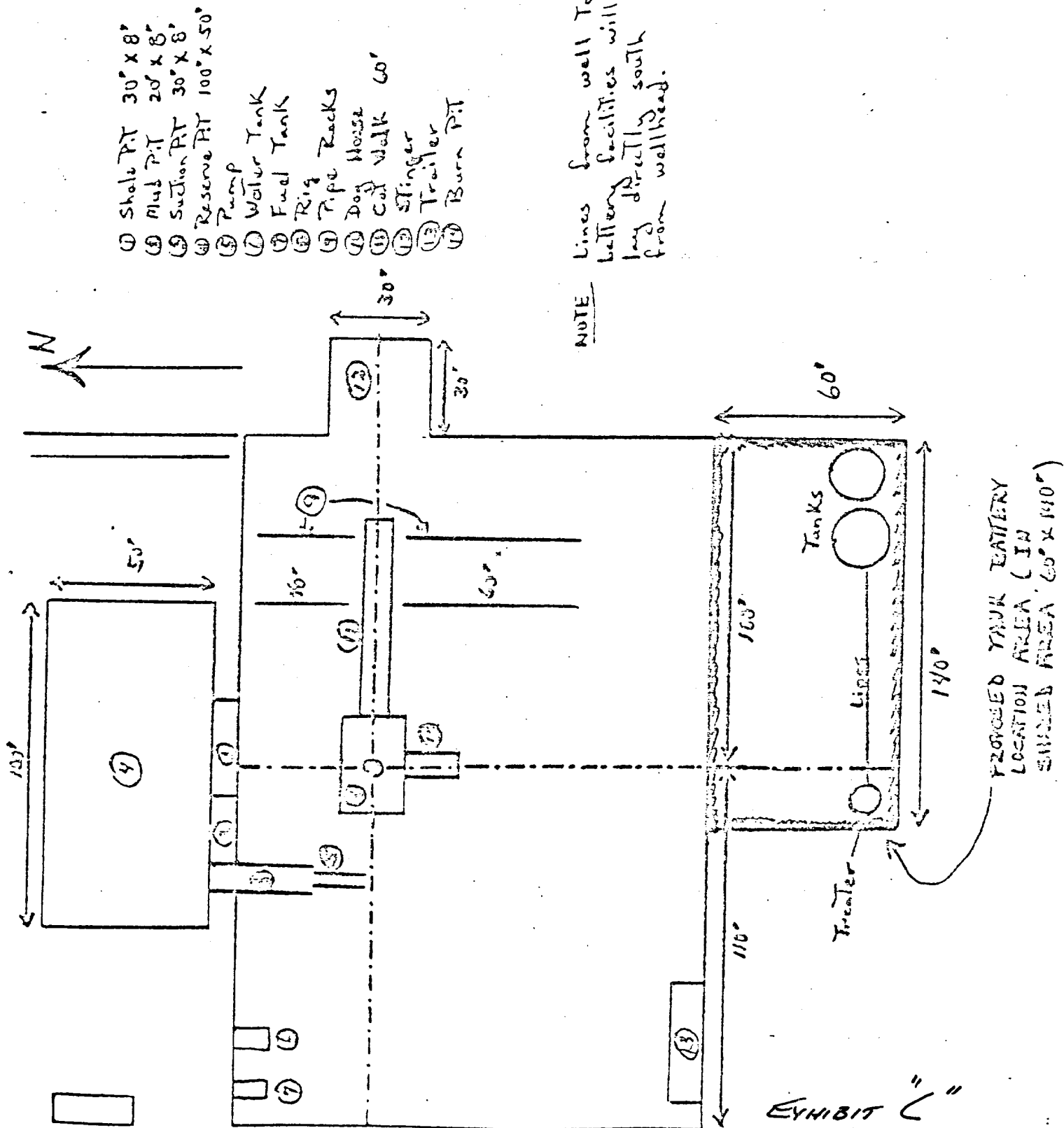

# BLOWOUT PREVENTER & CHOKE MANIFOLD

API 3M-8410-RdS

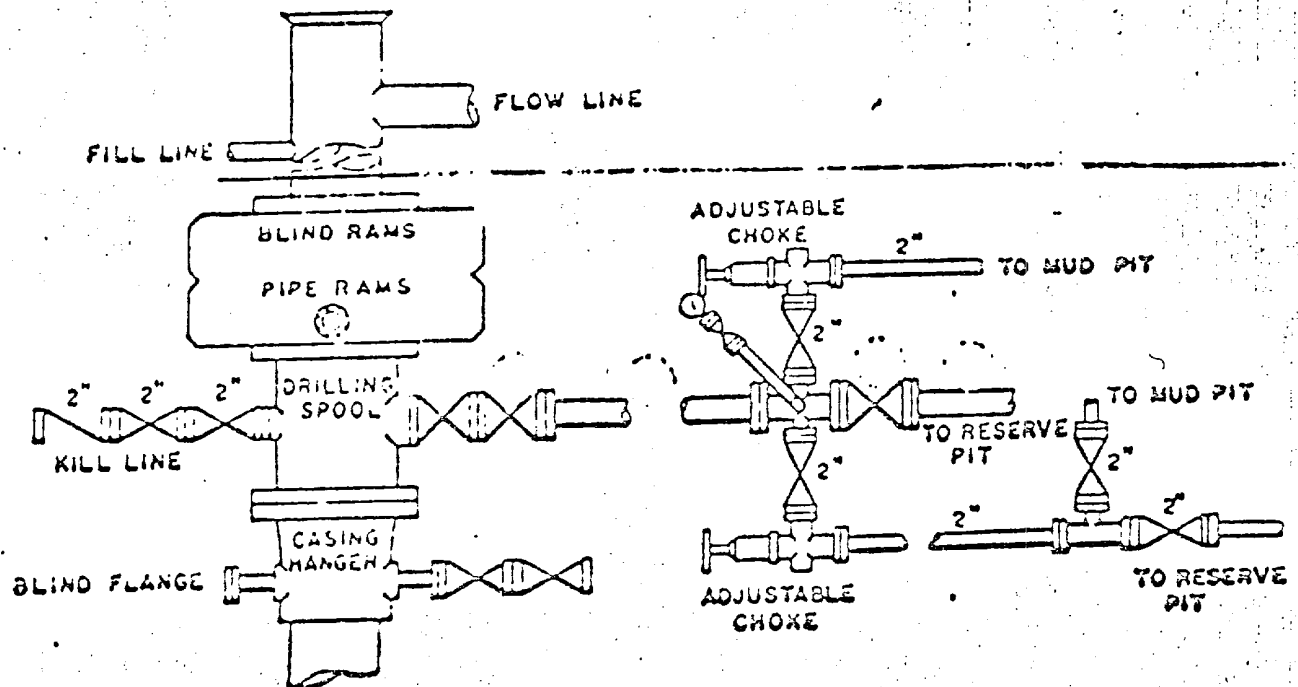

SUNDANCE OIL CO.  
P.O. BOX 115  
Roswell, N.M. 88201  
September 19, 1977

USGS  
PO Box 1157  
205 N. Linam Street  
Hobbs, NM 88240

Re: Agreement with Surface  
Landowner - Sundance  
Oil Co. #2 Cone Fed.,  
Sec. 31-T7S-R32E,  
660' FN & 1980' FWL  
Roosevelt Co., NM

Dear Sir:

This is to certify that in regard to captioned well, Sundance Oil Co. has an agreement with the surface owner in regard to the surface restoration.

If this well is completed as a producing well, the pits are to be filled and covered and the location cleaned of all trash and junk in order to leave the wellsite in an aesthetically pleasing condition. Prior to the filling of the pits any unguarded pit containing fluid will be fenced.

If the well is completed as a dry hole and plugged and abandoned, pits will be covered, location cleaned of all trash and junk. The road will remain in place. The drilling pad will either remain or be ripped at the landowner's option.

Sincerely,

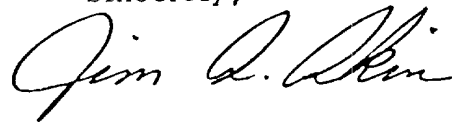

Jim A. Akin  
Field Superintendent  
Permian Basin Area

JAA:ss

U. S. Geological Survey

HOBBS DISTRICT

Sundance Oil Company  
No. 2 Cone Federal  
NE $\frac{1}{4}$ NW $\frac{1}{4}$  sec. 31-7S-32E  
Lea County, N. M.

Above Data Required on Well Sign

CONDITIONS OF APPROVAL

1. Drilling operations authorized are subject to compliance with the attached General Requirements for Drilling Operations on Federal Oil and Gas Leases, dated January 1, 1977.
2. Notify this office (telephone (505) 393-3612) when the well is to be spudded and in sufficient time for a representative to witness all cementing operations. Attached are names and telephone numbers of Geological Survey and Bureau of Land Management personnel who are available for consultation during construction, drilling, completion, and rehabilitation activities.
3. Immediate notice is required of all blowouts, fires, spills, and accidents involving life-threatening injuries or loss of life.
4. Secure prior approval of the District Engineer for variance from the approved drilling program and before commencing plugging operations, plug-back work, casing repair work, corrective cementing operations, or suspending drilling operations indefinitely.
5. Blowout prevention equipment is to be installed, tested, and in working order before drilling below the surface casing and shall be maintained ready for use until drilling operations are completed.
6. Operations must be in compliance with the provisions of the landowner agreement concerning surface disturbance and surface restoration.
7. 8-5/8" surface casing should be set in the Rustler Anhydrite formation and cement circulated to the surface. If surface casing is set at a lesser depth, the 4 $\frac{1}{2}$ " casing must be cemented from the casing shoe to the surface or cemented to the surface through a stage tool set at least 50 feet below the top of the Rustler, after cementing around the shoe with sufficient cement to fill to the base of the salt section.
8. For the protection of livestock and wildlife all pits containing toxic liquids will be fenced and covered with a fine mesh netting (i.e., Hardware Cloth) with openings being 1/2 inch or less.



Petroleum Information.

## RE-ISSUED COMPLETION

COUNTY **ROOSEVELT** FIELD **Tomahawk** STATE **NM**  
 OPR **SUNDANCE OIL CO.** API **30-041-20440**  
 NO **2** LEASE **Cone Federal** MAP  
**Sec 31, T7S, R32E** RECORD  
**660' FNL, 1980' FWL of Sec** **2-1-7 NM**  
**18 mi SW/Elida** SPD **12-21-77** CMP **1-15-78**

CSC

**8 5/8" at 1799' w/600 sx**  
**4 1/2" at 4320' w/300 sx**

WELL CLASS: INIT D FINDO ELEV L & S			
FORMATION	DATUM	FORMATION	DATUM
ID <b>4320' (SADR)</b>		PBD <b>4286'</b>	

IP (San Andres) Perfs 4132-72' F 200 BOPD. Pot based on  
 24 hr test thru 23/64" chk. GOR 475; gty (NR); CP 400#;  
 TP 110#

CONTR **WEK** OPRSELEV **4429' GL** PD **4350' RT**

F.R. 10-3-77  
 (San Andres)  
 2-4-78 AMEND FIELD: Formerly reported as Undesignated  
 1-17-78 TD 4320'; WOC  
 1-30-78 TD 4320'; PBD 4286'; Complete  
 Perf (San Andres) 4132-44', 4152-72'  
 Natural  
 LOG TOPS: Rustler 1774', Salado 1822',  
 Yates 2176', San Andres 3331', Pi Marker  
 3884'  
 2-4-78 COMPLETION ISSUED  
 7-29-78 RE-ISSUE TO CORRECT GOR & TO ADD LOG TOPS:  
 Formerly reported as (NR)

2-1-7 NM  
 IC 30-041-70014-77

COUNTY ROOSEVELT FIELD Tomahawk STATE NM  
 OPR SUNDANCE OIL CO. API 30-041-20440  
 2 LEASE Cone Federal MAP  
 Sec 31, T7S, R32E COORD  
 660' FNL, 1980' FWL of Sec 2-1-7 NM  
 18 mi SW/Elida SPD 12-21-77 CMP 1-15-78

8 5/8" at 1799' w/400 sx  
 4 1/2" at 4320' w/300 sx

WELL CLASS: INIT D LINDO ELEV L & S			
FORMATION	DATUM	FORMATION	DATUM
ID 4320' (SADR)		PBD 4286'	

IP (San Andres) Perfs 4132-72' F 200 BOPD. Pot based on  
 24 hr test thru 23/64" chk. GOR (NR); gty (NR); CP 400#;  
 TP 110#

CONTR WEK OPRSTLEV 4429' GL PD 4350' RT

2-4-78 F.R. 10-3-77  
 1-17-78 (San Andres)  
 1-30-78 AMEND FIELD: Formerly reported as Undesignated  
 TD 4320'; WOC  
 TD 4320'; PBD 4286'; Complete  
 Perf (SADR) 4132-44', 4152-72'  
 Natural  
 2-4-78 COMPLETION ISSUED

2-1-7 NM  
 IC 30-041-70014-77