

UNITED STATES  
DEPARTMENT OF THE INTERIOR  
GEOLOGICAL SURVEY

APPLICATION FOR PERMIT TO DRILL, DEEPEN, OR PLUG BACK

1a. TYPE OF WORK  
DRILL ☒ DEEPEN ☐ PLUG BACK ☐

b. TYPE OF WELL  
OIL WELL ☒ GAS WELL ☐ OTHER ☐  
SINGLE ZONE ☒ MULTIPLE ZONE ☐

2. NAME OF OPERATOR

El Ran, Inc.

3. ADDRESS OF OPERATOR

1603 Broadway, Lubbock, Texas 79401

4. LOCATION OF WELL (Report location clearly and in accordance with any State requirements.)  
At surface

660' FSL and 1980' FWL

At proposed prod. zone

Same

14. DISTANCE IN MILES AND DIRECTION FROM NEAREST TOWN OR POST OFFICE\*

Approximately 20.8 miles south of Elida, New Mexico

15. DISTANCE FROM PROPOSED\* LOCATION TO NEAREST PROPERTY OR LEASE LINE, FT.  
(Also to nearest drilg. unit line, if any)

660'

16. NO. OF ACRES IN LEASE

280

17. NO. OF ACRES ASSIGNED TO THIS WELL

40

18. DISTANCE FROM PROPOSED LOCATION\* TO NEAREST WELL, DRILLING, COMPLETED, OR APPLIED FOR, ON THIS LEASE, FT.

None

19. PROPOSED DEPTH

4325'

20. ROTARY OR CABLE TOOL

Rotary

21. ELEVATIONS (Show whether DF, RT, GR, etc.)

4487.0'

22. APPROX. DATE WORK WILL START\*

As soon as possible

23. PROPOSED CASING AND CEMENTING PROGRAM

SIZE OF HOLE	SIZE OF CASING	WEIGHT PER FOOT	SETTING DEPTH	QUANTITY OF CEMENT
12-7/8"	8-5/8"	24# K-55	1700'	Sufficient to circulate to surface
7-7/8"	4-1/2"	9.5# J-55	4325'	175 bbl.

Mud program: 10# mud, 35 viscosity, from 4000' to TD.

BCP program: See Exhibits C, D, and E.

IN ABOVE SPACE DESCRIBE PROPOSED PROGRAM: If proposal is to deepen or plug back, give data on present productive zone and proposed zone productive zone. If proposal is to drill or deepen directionally, give pertinent data on subsurface locations and measured and true vertical depths. Give blowout preventer program, if any.

24.

SIGNED Edward N. Lucking TITLE Agent for El Ran, Inc.  
Edward N. Lucking  
(This space for Federal or State office use)

PERMIT NO.

APPROVAL DATE

APPROVED BY  
CONDITIONS OF APPROVAL, IF ANY:

TITLE

APPROVED  
AS AMENDED  
JAN 23 1979  
DISTRICT ENGINEER

\*See Instructions On Reverse Side

RECEIVED  
DEC 21 1968  
U.S. GEOLOGICAL SURVEY  
HOBBS, NEW MEXICO

**NEW MEXICO OIL CONSERVATION COMMISSION**  
**WELL LOCATION AND ACREAGE DEDICATION FORM**

Form C-102  
 Supersedes C-128  
 Effective 1-1-65

All distances must be from the outer boundaries of the Section.

Operator <b>El Ran, Inc.</b>			Lease <b>U.S.</b>		Well No. <b>1</b>
Tract Letter <b>N</b>	Section <b>34</b>	Township <b>7 South</b>	Range <b>32 East</b>	County <b>Roosevelt</b>	
Actual Footage Location of Well: <b>660</b> feet from the <b>South</b> line and <b>1980</b> feet from the <b>West</b> line					
Ground Level Elev <b>4487.0</b>	Producing Formation <b>San Andres</b>		Pool <b>Chaveroo San Andres</b> <b>Undesignated</b>		Dedicated Acreage: <b>40</b> Acres

1. Outline the acreage dedicated to the subject well by colored pencil or hatchure marks on the plat below.
2. If more than one lease is dedicated to the well, outline each and identify the ownership thereof (both as to working interest and royalty).
3. If more than one lease of different ownership is dedicated to the well, have the interests of all owners been consolidated by communitization, unitization, force-pooling, etc?

☐ Yes ☐ No If answer is "yes," type of consolidation \_\_\_\_\_

If answer is "no," list the owners and tract descriptions which have actually been consolidated. (Use reverse side of this form if necessary.) \_\_\_\_\_

No allowable will be assigned to the well until all interests have been consolidated (by communitization, unitization, forced-pooling, or otherwise) or until a non-standard unit, eliminating such interests, has been approved by the Commission.

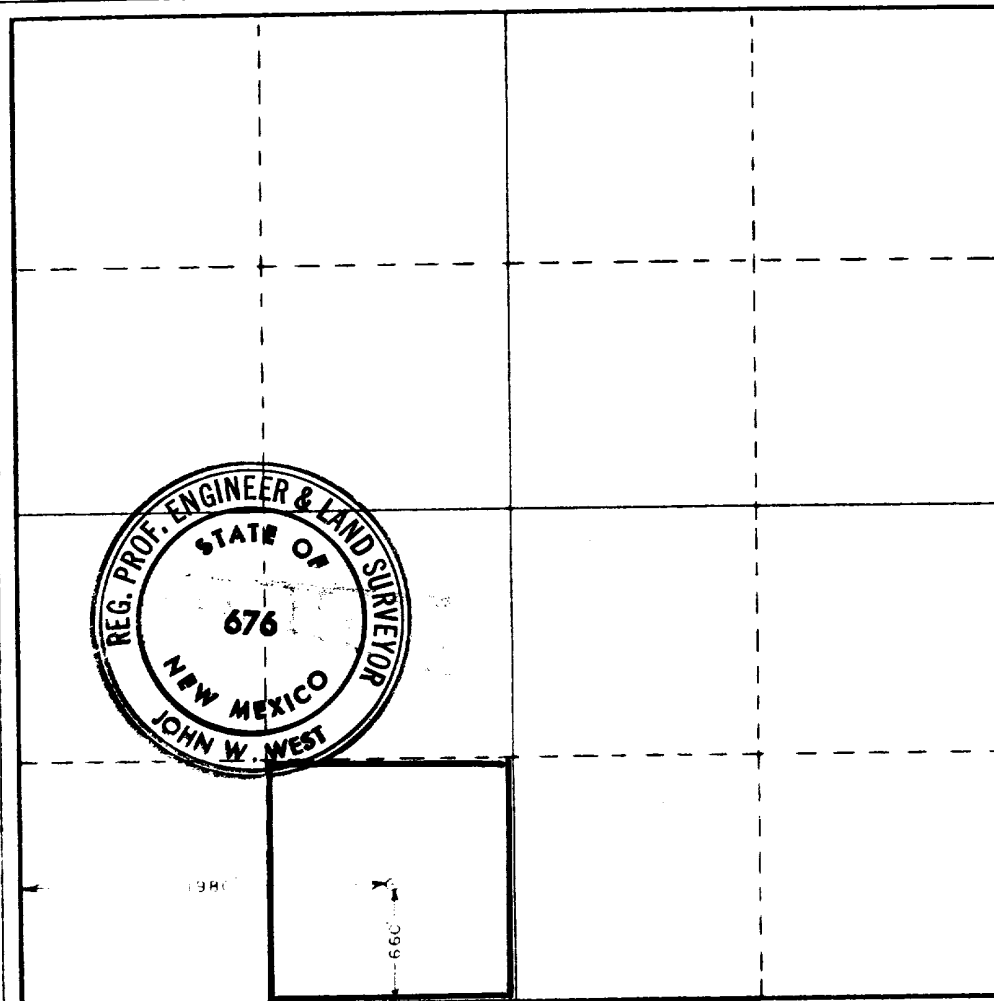

**CERTIFICATION**

I hereby certify that the information contained herein is true and complete to the best of my knowledge and belief.

*Edward N. Lucking*  
 Name

**Edward N. Lucking**

Position

**Agent for**

Company

**El Ran, Inc.**

Date

**12/20/78**

I hereby certify that the well location shown on this plat was plotted from field notes of actual surveys made by me or under my supervision, and that the same is true and correct to the best of my knowledge and belief.

Date Surveyed

**December 15, 1978**

Registered Professional Engineer  
 and/or Land Surveyor

*John W. West*

Certificate No. **John W. West 676**

**Ronald J. Eidson 3239**

0 320 640 960 1280 1600 1920 2240 2560 2880 3200 3520 3840 4160 4480 4800 5120 5440 5760 6080 6400 6720 7040 7360 7680 8000 8320 8640 8960 9280 9600 9920 10240 10560 10880 11200 11520 11840 12160 12480 12800 13120 13440 13760 14080 14400 14720 15040 15360 15680 16000 16320 16640 16960 17280 17600 17920 18240 18560 18880 19200 19520 19840 20160 20480 20800 21120 21440 21760 22080 22400 22720 23040 23360 23680 24000 24320 24640 24960 25280 25600 25920 26240 26560 26880 27200 27520 27840 28160 28480 28800 29120 29440 29760 30080 30400 30720 31040 31360 31680 32000 32320 32640 32960 33280 33600 33920 34240 34560 34880 35200 35520 35840 36160 36480 36800 37120 37440 37760 38080 38400 38720 39040 39360 39680 40000 40320 40640 40960 41280 41600 41920 42240 42560 42880 43200 43520 43840 44160 44480 44800 45120 45440 45760 46080 46400 46720 47040 47360 47680 48000 48320 48640 48960 49280 49600 49920 50240 50560 50880 51200 51520 51840 52160 52480 52800 53120 53440 53760 54080 54400 54720 55040 55360 55680 56000 56320 56640 56960 57280 57600 57920 58240 58560 58880 59200 59520 59840 60160 60480 60800 61120 61440 61760 62080 62400 62720 63040 63360 63680 64000 64320 64640 64960 65280 65600 65920 66240 66560 66880 67200 67520 67840 68160 68480 68800 69120 69440 69760 70080 70400 70720 71040 71360 71680 72000 72320 72640 72960 73280 73600 73920 74240 74560 74880 75200 75520 75840 76160 76480 76800 77120 77440 77760 78080 78400 78720 79040 79360 79680 80000 80320 80640 80960 81280 81600 81920 82240 82560 82880 83200 83520 83840 84160 84480 84800 85120 85440 85760 86080 86400 86720 87040 87360 87680 88000 88320 88640 88960 89280 89600 89920 90240 90560 90880 91200 91520 91840 92160 92480 92800 93120 93440 93760 94080 94400 94720 95040 95360 95680 96000 96320 96640 96960 97280 97600 97920 98240 98560 98880 99200 99520 99840 100160 100480 100800 101120 101440 101760 102080 102400 102720 103040 103360 103680 104000 104320 104640 104960 105280 105600 105920 106240 106560 106880 107200 107520 107840 108160 108480 108800 109120 109440 109760 110080 110400 110720 111040 111360 111680 112000 112320 112640 112960 113280 113600 113920 114240 114560 114880 115200 115520 115840 116160 116480 116800 117120 117440 117760 118080 118400 118720 119040 119360 119680 120000 120320 120640 120960 121280 121600 121920 122240 122560 122880 123200 123520 123840 124160 124480 124800 125120 125440 125760 126080 126400 126720 127040 127360 127680 128000 128320 128640 128960 129280 129600 129920 130240 130560 130880 131200 131520 131840 132160 132480 132800 133120 133440 133760 134080 134400 134720 135040 135360 135680 136000 136320 136640 136960 137280 137600 137920 138240 138560 138880 139200 139520 139840 140160 140480 140800 141120 141440 141760 142080 142400 142720 143040 143360 143680 144000 144320 144640 144960 145280 145600 145920 146240 146560 146880 147200 147520 147840 148160 148480 148800 149120 149440 149760 150080 150400 150720 151040 151360 151680 152000 152320 152640 152960 153280 153600 153920 154240 154560 154880 155200 155520 155840 156160 156480 156800 157120 157440 157760 158080 158400 158720 159040 159360 159680 160000 160320 160640 160960 161280 161600 161920 162240 162560 162880 163200 163520 163840 164160 164480 164800 165120 165440 165760 166080 166400 166720 167040 167360 167680 168000 168320 168640 168960 169280 169600 169920 170240 170560 170880 171200 171520 171840 172160 172480 172800 173120 173440 173760 174080 174400 174720 175040 175360 175680 176000 176320 176640 176960 177280 177600 177920 178240 178560 178880 179200 179520 179840 180160 180480 180800 181120 181440 181760 182080 182400 182720 183040 183360 183680 184000 184320 184640 184960 185280 185600 185920 186240 186560 186880 187200 187520 187840 188160 188480 188800 189120 189440 189760 190080 190400 190720 191040 191360 191680 192000 192320 192640 192960 193280 193600 193920 194240 194560 194880 195200 195520 195840 196160 196480 196800 197120 197440 197760 198080 198400 198720 199040 199360 199680 200000

## APPLICATION FOR DRILLING

El Ran, Inc.  
T. S. Well No. 1  
Section 34-T7S-R32E  
Roosevelt County, New Mexico

In conjunction with Form 9-331C, Application for Permit to Drill subject well, El Ran, Inc. submits the following ten items of pertinent information:

1. The geologic surface formation is the Ogallala formation.
2. The estimated tops of geologic markers are as follows:  
Yates 2385'  
San Andres 3458'
3. The depths at which anticipated water, oil or gas formations are expected to be encountered:  
Water: No data available. Probably from Triassic formation at approximately 500 to 600 feet.  
Oil or Gas: San Andres at approximately 3458 to 4325 feet.
4. Proposed casing program: See Form 9-331C.
5. Pressure control equipment: See Exhibits C, D, and E.
6. Mud program: See Form 9-331C.
7. Auxiliary equipment: See Exhibit D.
8. Testing, logging and coring programs: None.
9. No abnormal temperatures or pressures are anticipated.
10. Anticipated starting date: As soon as possible.  
Anticipated completion of drilling operations: Approximately 7 days after starting date.

# MULTI-POINT SURFACE USE AND OPERATIONS PLAN

El Ran, Inc.  
U. S. Well No. 1  
660' FSL and 1930' FWL  
Section 34-T7S-R32E  
Roosevelt County, New Mexico  
(Development Well)

This plan is submitted with Form 9-331C, Application for Permit to Drill, covering the above described well. The purpose of this plan is to describe the location of the proposed well, the proposed construction activities and operations plan, the magnitude of necessary surface disturbance involved, and the procedures to be followed in rehabilitating the surface after completion of the operations, so that a complete appraisal can be made of the environmental effects associated with the operation.

## 1. EXISTING ROADS.

A. Exhibit A is a portion of BLM quad-color map no. SE-9, showing the area surrounding the proposed wellsite on a scale of 1/2 inch to a mile. The proposed location is situated at a driving distance of approximately 20.8 miles (excluding the proposed new access road) south of Elida, New Mexico, and the existing roads leading to the wellsite are indicated in red in Exhibit A.

- (1) Proceed south from Elida on highway 114 for approximately 0.6 miles. At this point, take the right fork onto highway 440.
- (2) Continue in a southward direction for an additional 19.8 miles (20.4 miles from highway 70 in Elida). The road surface will change from blacktop to a dirt surface about 14.5 miles from Elida. You will pass over a number of cattleguards, including five cattleguards on the dirt road. Approximately 0.4 miles after crossing the fifth cattleguard, turn right (west).
- (3) Approximately 0.1 miles after this turn, you will pass a tank battery and a caliche pit on your left. Approximately 0.1 miles beyond this point, a well (Byron #1Y) is currently being drilled. Approximately 0.2 miles beyond this well, you will reach the well pad of Byron #2. The new access road to the proposed location will originate from the southwestern corner of the well pad of Byron #2.

## 2. PLANNED ACCESS ROAD.

- A. The proposed new access road will be constructed in an east-to-west direction, from the southwestern corner of the drill pad at Byron #2 to the southeastern corner of the drill pad at the proposed location.
- B. The route of the proposed road passes over a relatively level area and only very minor leveling will be required.
- C. The length of the proposed road will be approximately 1120 feet. It will have a driving surface width of 12 feet and the surface will be

topped with six inches of compacted caliche. The center of the road will be crowned, with drainage on both sides.

- D. No turnouts will be required, and no fences, cattleguards, or culverts are involved.
- E. The starting point of the new road is clearly marked with surveyor's ribbons and the route of the road is staked and flagged.
- F. The first half of the route of the proposed road is on privately owned fee surface and the second half, adjacent to the drillsite, is on fee surface owned by the New Mexico State Department of Game and Fish. An agreement exists between El Ran, Inc. and the private fee surface owner, Harry Carroll, concerning El Ran's use of this surface as a portion of the access route, and an application has been submitted to the New Mexico State Department of Game and Fish for use of that department's surface, both as part of the access route and as a drillsite.

3. LOCATION OF EXISTING WELLS.

- A. As indicated in Exhibit D, there has been considerable drilling activity in the area of the proposed well. The nearest producing well is Byron #2, located 1/4 mile east of the proposed well, and drilling activity is currently being conducted on Byron #1Y, located 990 feet east of Byron #2.

4. LOCATION OF EXISTING AND/OR PROPOSED FACILITIES.

- A. There are no production facilities on this lease at the present time.
- B. In the event that the well is productive of oil, a tank battery and heater will be installed on the well pad. Electric power for production is available from an east-west high line about 500 feet south of the proposed location.

5. LOCATION AND TYPE OF WATER SUPPLY.

- A. It is planned to drill the proposed well with a fresh water system. The water will be obtained from privately owned or commercial sources and will be hauled to the location by truck over the existing and proposed roads described in paragraphs 1 and 2, above.

6. SOURCE OF CONSTRUCTION MATERIALS.

- A. Caliche required for road and drilling pad surfaces will be obtained from a privately owned pit approximately 2/3 of a mile east of the proposed drillsite. This is the caliche pit referred to, in paragraph 1A(3), above.

7. METHODS OF HANDLING WASTE DISPOSAL.

- A. Drill cuttings will be disposed of, in the reserve pits, which will be plastic-lined.

- B. Drilling fluids will be allowed to evaporate in the reserve pits until the pits are dry.
- C. All pits will be fenced with normal fencing material to prevent the entry of livestock into the pits.
- D. Water produced during operations will be collected in tanks until hauled to an approved disposal system, or a separate disposal application will be submitted to the USGS for approval.
- E. Oil produced during operations will be stored in tanks until sold.
- F. Current laws and regulations pertaining to the disposal of human waste will be complied with.
- G. Trash, waste paper, garbage and junk will be buried in a separate pit and covered with a minimum of 24 inches of dirt. All waste materials will be contained to prevent scattering by the wind.
- H. All trash and debris will be buried or removed from the wellsite within 90 days after drilling and/or completion operations have been finished.

8. ANCILLARY FACILITIES.

- A. None required.

9. WELLSITE LAYOUT.

- A. Exhibit C shows the relative location and dimensions of the well pad and reserve pits.
- B. The ground surface at the wellsite is comparatively flat, and very little cut or fill will be required to construct either the drilling pad or the reserve pits. The drilling surface will be covered with six inches of compacted caliche.
- C. The reserve pits will be plastic-lined.
- D. The pad and pit area has been staked and flagged.

10. PLANS FOR RESTORATION OF THE SURFACE.

- A. After drilling and/or completion operations have been finished, all equipment and other material not needed for further operations will be removed. Pits will be filled and the location cleaned of all trash and junk, so as to leave the wellsite in as aesthetically pleasing a condition as possible.
- B. Any unguarded pits containing fluids will be fenced until they have been filled.

- C. If the proposed well is non-productive, all applicable rehabilitation and/or vegetation requirements of the BLM, the USGS, and the New Mexico State Department of Game and Fish will be complied with, and will be accomplished as expeditiously as possible. All pits will be filled and leveled within 90 days after abandonment.

11. OTHER INFORMATION.

- A. The proposed wellsite is located in an essentially level area. The proposed new access road crosses a generally level area, also, with only minor surface anomalies.
- B. The topsoil at the wellsite consists of moderately soft sand.
- C. Flora and Fauna: The vegetation cover at the proposed location is moderately sparse, consisting of miscellaneous weeds and grass, bear grass yucca, and a few cactus plants. No wildlife was observed, but it is likely that typical semi-arid desert wildlife inhabit the area, which is used for cattle grazing.
- D. There are no ponds, lakes, or flowing streams or rivers in the vicinity of the wellsite.
- E. There are no occupied dwellings within several miles of the wellsite. The nearest windmill is about a half-mile northeast of the location.
- F. The wellsite is on surface owned by the New Mexico State Department of Game and Fish, with federal ownership of minerals.
- G. There is no evidence of any significant archaeological, historical or cultural sites in the area of the proposed location. An archaeological survey has been conducted by the Agency for Conservation Archaeology, Eastern New Mexico University, Portales, New Mexico, and their report has been distributed to the appropriate government agencies.

12. OPERATOR'S REPRESENTATIVES.

- A. The field representatives of the operator responsible for assuring compliance with the approved surface use plan are:

W. W. Ranck  
El Ran, Inc.  
1603 Broadway  
Lubbock, Texas 79401  
Telephone: 806-763-4091

Robert R. Ranck  
El Ran, Inc.  
1603 Broadway  
Lubbock, Texas 79401  
Telephone: 806-763-4091

13. CERTIFICATION.

See attachment on next page.

El Ran, Inc.  
U. S. Well #1  
Page 5

CERTIFICATION

I hereby certify that I, or persons under my direct supervision, have inspected the proposed drillsite and access route; that I am familiar with the conditions which presently exist; that the statements made in this plan are to the best of my knowledge true and correct; and that the work associated with the operations proposed herein will be performed by El Ran, Inc. and its contractors and subcontractors in conformity with this plan and the terms and conditions under which it is approved.

12/20/78

Date

Edward N. Lucking  
Edward N. Lucking  
Agent for El Ran, Inc.



**ED LUCKING & ASSOCIATES**

~~216 BOOKER BUILDING~~ P. O. Box 1203  
~~100 SOUTH FOURTH STREET~~  
ARTESIA, NEW MEXICO 88210

505-746-~~9444~~ 2605

December 20, 1978

U. S. Geological Survey  
Hobbs, New Mexico

Re: El Ran, Inc.  
U. S. Well No. 1  
260' FSL and 1200' FWL  
Section 34-T7S-R32E  
Roosevelt County, New Mexico

Gentlemen:

This is to advise that an agreement exists between El Ran, Inc. and Harry D. Carroll, in connection with access road construction activities related to the above referenced well, as well as to other wells being drilled or contemplated on fee surface belonging to Mr. Carroll.

The access road to be built to the referenced well, as well as all other roads previously constructed on Mr. Carroll's fee surface, will remain intact for as long a period as drilling activity or well production requires their continued use. If this proposed access road should cease to be required, it will be ripped or left intact, at Mr. Carroll's discretion.

An application is currently being processed covering access road and drilling pad construction, related to the referenced well, on fee surface belonging to the New Mexico State Department of Game and Fish.

Sincerely,

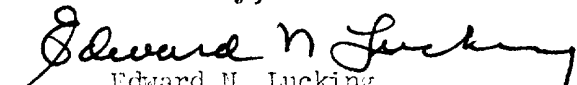
  
Edward N. Lucking  
Agent for El Ran, Inc.

R. 32 E.

# ELIDA

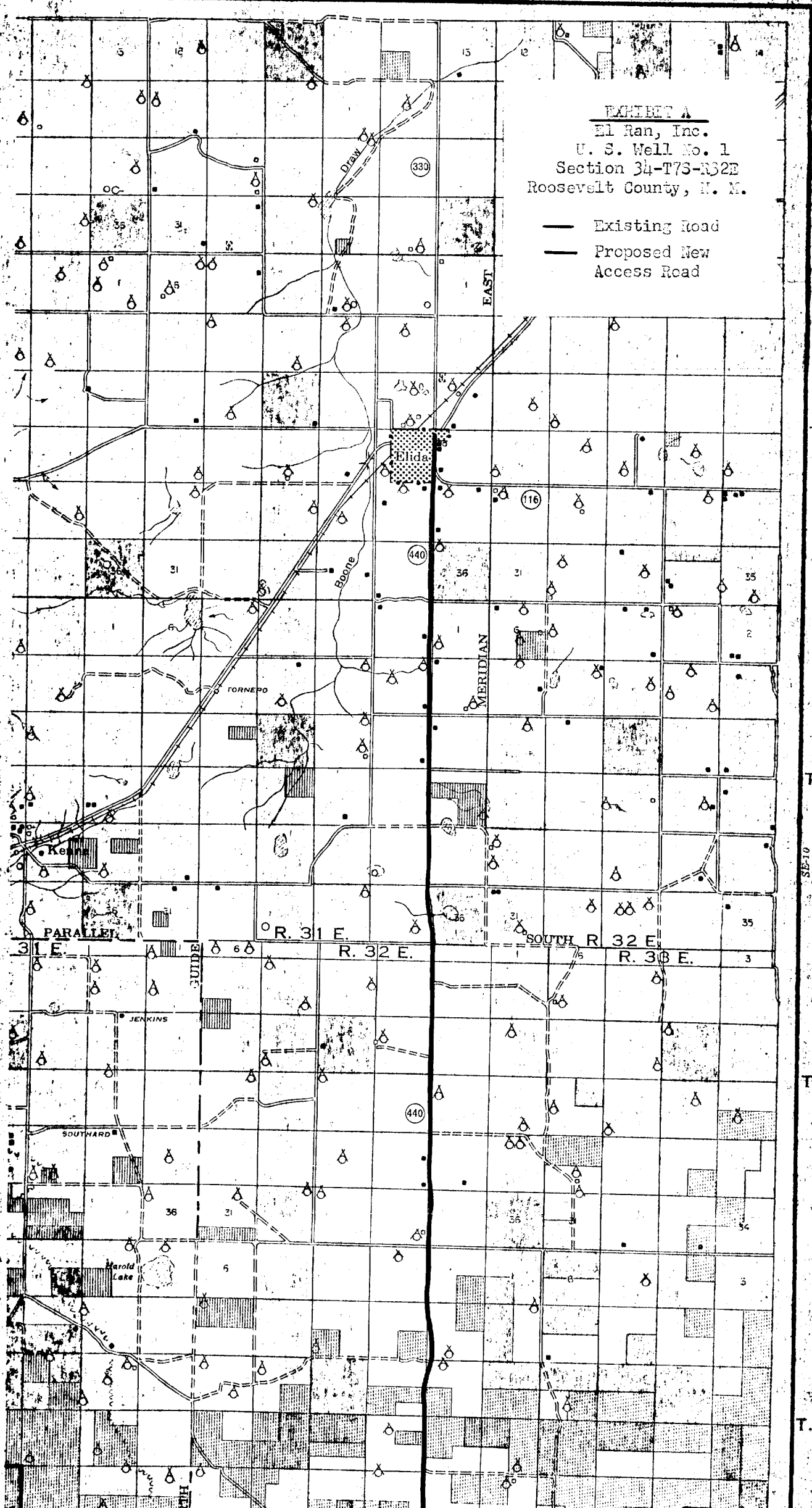

REF ID: A66029

NM 0392502 NM 12693

27 -

1998, 1999, 2000, 2001, 2002, 2003, 2004, 2005, 2006, 2007, 2008, 2009, 2010, 2011, 2012, 2013, 2014, 2015, 2016, 2017, 2018, 2019, 2020, 2021, 2022, 2023, 2024, 2025, 2026, 2027, 2028, 2029, 2030, 2031, 2032, 2033, 2034, 2035, 2036, 2037, 2038, 2039, 2040, 2041, 2042, 2043, 2044, 2045, 2046, 2047, 2048, 2049, 2050, 2051, 2052, 2053, 2054, 2055, 2056, 2057, 2058, 2059, 2060, 2061, 2062, 2063, 2064, 2065, 2066, 2067, 2068, 2069, 2070, 2071, 2072, 2073, 2074, 2075, 2076, 2077, 2078, 2079, 2080, 2081, 2082, 2083, 2084, 2085, 2086, 2087, 2088, 2089, 2090, 2091, 2092, 2093, 2094, 2095, 2096, 2097, 2098, 2099, 2100, 2101, 2102, 2103, 2104, 2105, 2106, 2107, 2108, 2109, 2110, 2111, 2112, 2113, 2114, 2115, 2116, 2117, 2118, 2119, 2120, 2121, 2122, 2123, 2124, 2125, 2126, 2127, 2128, 2129, 2130, 2131, 2132, 2133, 2134, 2135, 2136, 2137, 2138, 2139, 2140, 2141, 2142, 2143, 2144, 2145, 2146, 2147, 2148, 2149, 2150, 2151, 2152, 2153, 2154, 2155, 2156, 2157, 2158, 2159, 2160, 2161, 2162, 2163, 2164, 2165, 2166, 2167, 2168, 2169, 2170, 2171, 2172, 2173, 2174, 2175, 2176, 2177, 2178, 2179, 2180, 2181, 2182, 2183, 2184, 2185, 2186, 2187, 2188, 2189, 2190, 2191, 2192, 2193, 2194, 2195, 2196, 2197, 2198, 2199, 2200, 2201, 2202, 2203, 2204, 2205, 2206, 2207, 2208, 2209, 2210, 2211, 2212, 2213, 2214, 2215, 2216, 2217, 2218, 2219, 2220, 2221, 2222, 2223, 2224, 2225, 2226, 2227, 2228, 2229, 2230, 2231, 2232, 2233, 2234, 2235, 2236, 2237, 2238, 2239, 2240, 2241, 2242, 2243, 2244, 2245, 2246, 2247, 2248, 2249, 2250, 2251, 2252, 2253, 2254, 2255, 2256, 2257, 2258, 2259, 2260, 2261, 2262, 2263, 2264, 2265, 2266, 2267, 2268, 2269, 2270, 2271, 2272, 2273, 2274, 2275, 2276, 2277, 2278, 2279, 2280, 2281, 2282, 2283, 2284, 2285, 2286, 2287, 2288, 2289, 2290, 2291, 2292, 2293, 2294, 2295, 2296, 2297, 2298, 2299, 2300, 2301, 2302, 2303, 2304, 2305, 2306, 2307, 2308, 2309, 2310, 2311, 2312, 2313, 2314, 2315, 2316, 2317, 2318, 2319, 2320, 2321, 2322, 2323, 2324, 2325, 2326, 2327, 2328, 2329, 2330, 2331, 2332, 2333, 2334, 2335, 2336, 2337, 2338, 2339, 2340, 2341, 2342, 2343, 2344, 2345, 2346, 2347, 2348, 2349, 2350, 2351, 2352, 2353, 2354, 2355, 2356, 2357, 2358, 2359, 2360, 2361, 2362, 2363, 2364, 2365, 2366, 2367, 2368, 2369, 2370, 2371, 2372, 2373, 2374, 2375, 2376, 2377, 2378, 2379, 2380, 2381, 2382, 2383, 2384, 2385, 2386, 2387, 2388, 2389, 2390, 2391, 2392, 2393, 2394, 2395, 2396, 2397, 2398, 2399, 2400, 2401, 2402, 2403, 2404, 2405, 2406, 2407, 2408, 2409, 2410, 2411, 2412, 2413, 2414, 2415, 2416, 2417, 2418, 2419, 2420, 2421, 2422, 2423, 2424, 2425, 2426, 2427, 2428, 2429, 2430, 2431, 2432, 2433, 2434, 2435, 2436, 2437, 2438, 2439, 2440, 2441, 2442, 2443, 2444, 2445, 2446, 2447, 2448, 2449, 2450, 2451, 2452, 2453, 2454, 2455, 2456, 2457, 2458, 2459, 2460, 2461, 2462, 2463, 2464, 2465, 2466, 2467, 2468, 2469, 2470, 2471, 2472, 2473, 2474, 2475, 2476, 2477, 2478, 2479, 2480, 2481, 2482, 2483, 2484, 2485, 2486, 2487, 2488, 2489, 2490, 2491, 2492, 2493, 2494, 2495, 2496, 2497, 2498, 2499, 2500, 2501, 2502, 2503, 2504, 2505, 2506, 2507, 2508, 2509, 2510, 2511, 2512, 2513, 2514, 2515, 2516, 2517, 2518, 2519, 2520, 2521, 2522, 2523, 2524, 2525, 2526, 2527, 2528, 2529, 2530, 2531, 2532, 2533, 2534, 2535, 2536, 2537, 2538, 2539, 2540, 2541, 2542, 2543, 2544, 2545, 2546, 2547, 2548, 2549, 2550, 2551, 2552, 2553, 2554, 2555, 2556, 2557, 2558, 2559, 2560, 2561, 2562, 2563, 2564, 2565, 2566, 2567, 2568, 2569, 2570, 2571, 2572, 2573, 2574, 2575, 2576, 2577, 2578, 2579, 2580, 2581, 2582, 2583, 2584, 2585, 2586, 2587, 2588, 2589, 2590, 2591, 2592, 2593, 2594, 2595, 2596, 2597, 2598, 2599, 2600, 2601, 2602, 2603, 2604, 2605, 2606, 2607, 2608, 2609, 2610, 2611, 2612, 2613, 2614, 2615, 2616, 2617, 2618, 2619, 2620, 2621, 2622, 2623, 2624, 2625, 2626, 2627, 2628, 2629, 2630, 2631, 2632, 2633, 2634, 2635, 2636, 2637, 2638, 2639, 2640, 2641, 2642, 2643, 2644, 2645, 2646, 2647, 2648, 2649, 2650, 2651, 2652, 2653, 2654, 2655, 2656, 2657, 2658, 2659, 2660, 2661, 2662, 2663, 2664, 2665, 2666, 2667, 2668, 2669, 2670, 2671, 2672, 2673, 2674, 2675, 2676, 2677, 2678, 2679, 26

NAF 12240

R O

C H

## ENDS

WEST N. ST.

## TABLE V

1

PROPERTY

36

44-13999

NR 13999

Figure 1

10

!!

2.

with blanks, 4", 4 1/2" and side connections.

EXHIBIT C

ElRan, Inc.  
U. S. Well No. 1  
660' FSL and 1980' FWL  
Section 34-T7S-R32E  
Roosevelt County, New Mexico

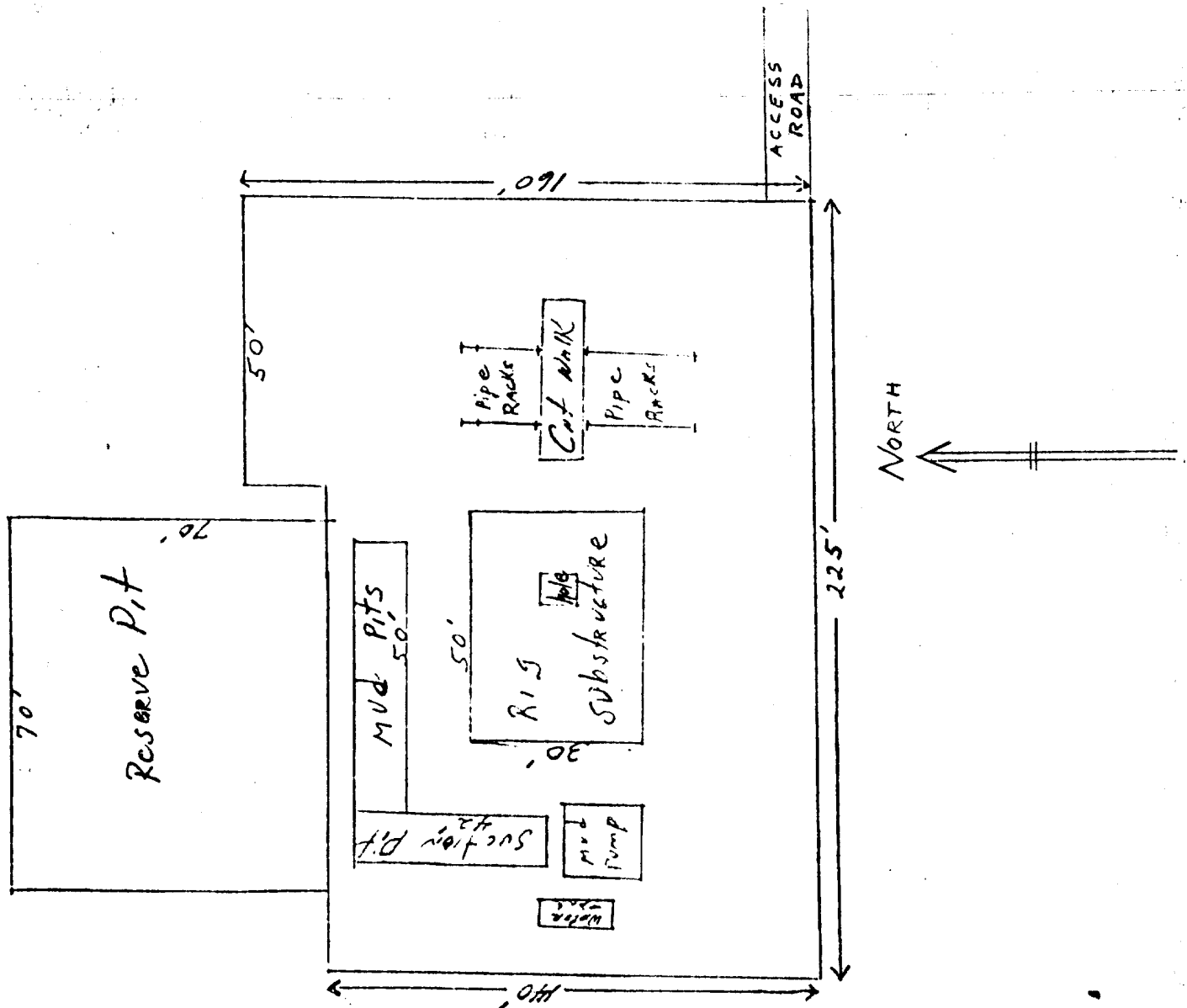

This rig is equipped with a Shaffer LWS Series 900 Double BOP Hydraulic operated. With blanks, 4", 4 1/4" and side connections.

All equipment should be at least 3,000 psi WP or higher unless otherwise specified.

- . Bell nipple.
- . Hydril bag type preventer
- . Ram type pressure operated blowout preventer with blind rams.
- . Flanged spool with one 3-inch and one 2-inch (minimum) outlet.
- . 2-inch (minimum) flanged plug or gate valve.
- . 2-inch by 2-inch by 2-inch (minimum) flanged tee.
- . 3-inch gate valve.
- . Ram type pressure operated blowout preventer with pipe rams.
- . Flanged type casing head with one side outlet.
- . 2-inch threaded (or flanged) plug or gate valve.
- . Flanged on 5000# WP, threaded on 3000# WP or less.
- . 3-inch flanged spacer spool.
- . 3-inch by 2-inch by 2-inch by 2-inch flanged cross.
- . 2-inch flanged plug or gate valve.
- . 2-inch flanged adjustable choke.
- . 2-inch threaded flange.
- . 2-inch XXH nipple.
- . 2-inch forged steel 90° Ell.
- . Cameron (or equal.) threaded pressure gage.
- . Threaded flange.
- . 2-inch flanged tee.
- . 2-inch flanged plug or gate valve.
- . 2½-inch pipe, 300' to pit, anchored.
- . 2½-inch SE valve.
- . 2½-inch line to steel pit or separator.

NOTES:

- . Items 3, 4 and 8 may be replaced with double ram type preventer with side outlets between the rams.
- . The two valves next to the stack on the fill and kill line to be closed unless drill string is being pulled.
- . Kill line is for emergency use only. This connection shall not be used for filling.
- . Replacement pipe rams and blind rams shall be on location at all times.
- . Only type U, LSW and QRC ram type preventers with secondary seals are acceptable for 5000 psi WP and higher BOP stacks.
- . Type E ram-type BOP's with factory modified side outlets may be used on 3000 psi or lower WP BOP stacks.

EXHIBIT D  
El Ran, Inc.  
U. S. Well No. 1  
Section 34-T7S-R32E  
Roosevelt County, N. M.

# WEK DRILLING CO., INC. - Rig 2 BLOWOUT PREVENTER SPECIFICATION

EXHIBIT E  
El Pan, Inc.  
U. S. Well No. 1  
Section 34-T7S-R32E  
Roosevelt County, N. M.

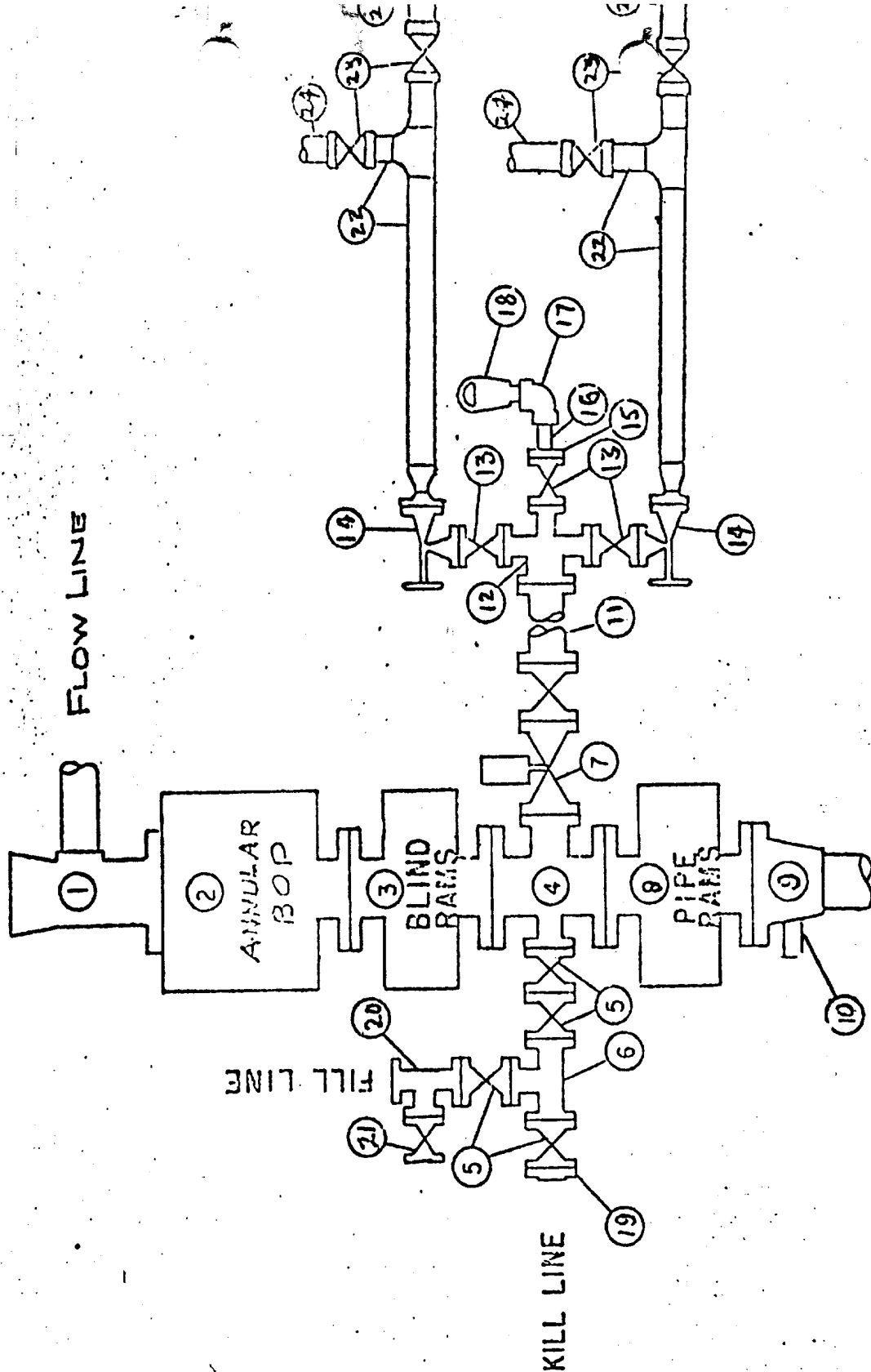

10/15/74

RECEIVED

1944

RECEIVED  
1944  
JAN 10 1944  
U.S. DEPT. OF JUSTICE  
FEDERAL BUREAU OF INVESTIGATION

RECEIVED

1944

RECEIVED  
JAN 10 1944  
U.S. DEPT. OF JUSTICE  
FEDERAL BUREAU OF INVESTIGATION