

NEW MEXICO OIL CONSERVATION COMMISSION
WELL LOCATION AND ACREAGE DEDICATION AT

Form C-102
 Supersedes C-128
 Effective 1-1-65

All distances must be from the outer boundaries of the Section.

Operator LAWBAR PETROLEUM, INC.			Lease TUCKER-FEDERAL		Well No. 1
Unit Letter "J"	Section 9	Township 7-S	Range 33-E	County ROOSEVELT	
Actual Footage Location of Well: 1980 feet from the SOUTH line and 1980 feet from the EAST line					
Ground Level Elev. 4401	Producing Formation MISSISSIPPIAN	Pool CHAVEROO, NORTH	Dedicated Acreage: 320 Acres		

1. Outline the acreage dedicated to the subject well by colored pencil or hachure marks on the plat below.
2. If more than one lease is dedicated to the well, outline each and identify the ownership thereof (both as to working interest and royalty).
3. If more than one lease of different ownership is dedicated to the well, have the interests of all owners been consolidated by communitization, unitization, force-pooling, etc?

☐ Yes ☒ No

If answer is "yes," type of consolidation See Reverse Side

If answer is "no," list the owners and tract descriptions which have actually been consolidated. (Use reverse side of this form if necessary.) _____

No allowable will be assigned to the well until all interests have been consolidated (by communitization, unitization, forced-pooling, or otherwise) or until a non-standard unit, eliminating such interests, has been approved by the Commission.

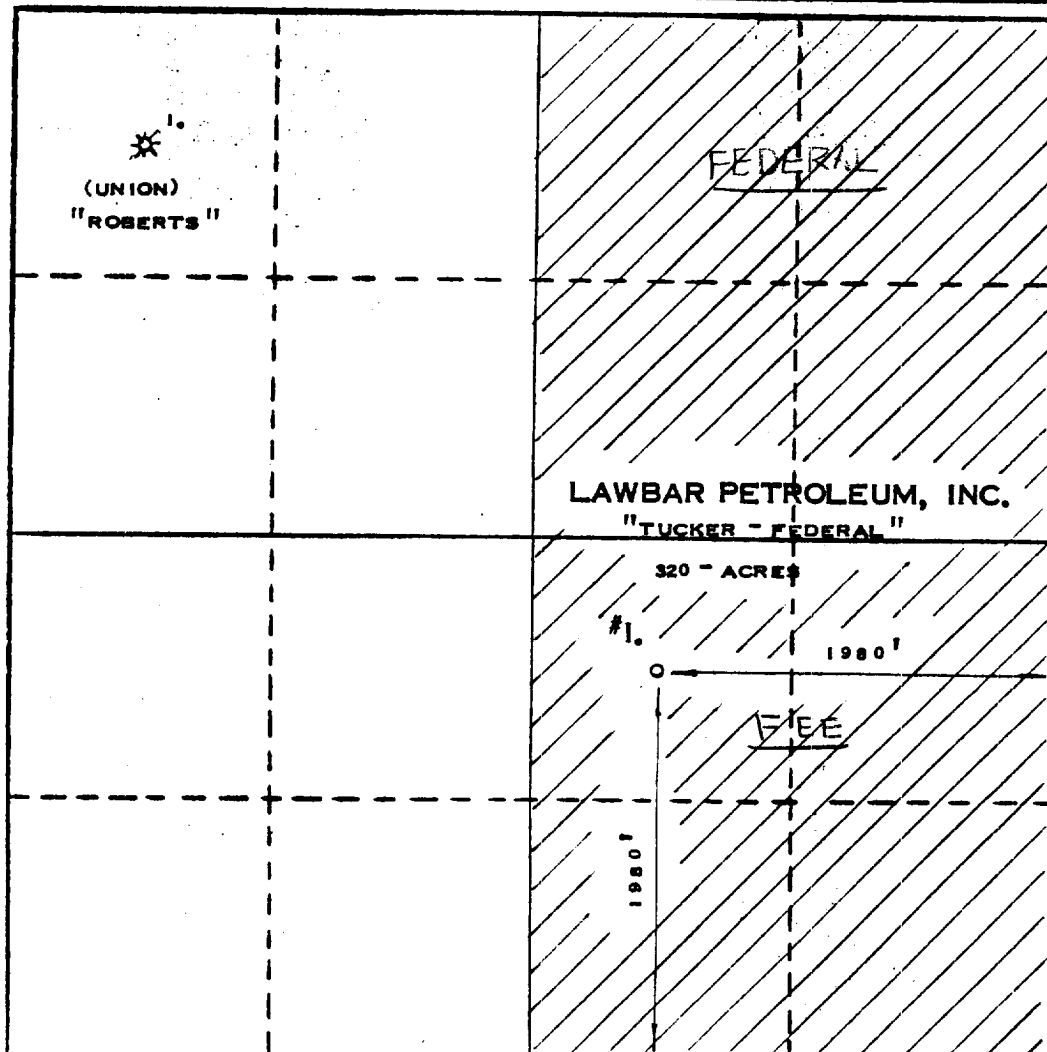

CERTIFICATION

I hereby certify that the information contained herein is true and complete to the best of my knowledge and belief.

Name
E. G. Durrett

Position
Agent

Company
Lawbar Petroleum, Inc.

Date
May 31, 1979

I hereby certify that the well location shown on this plat was plotted from field notes of actual surveys made by me or under my supervision, and that the same is true and correct to the best of my knowledge and belief.

Date Surveyed
MAY 3, 1979

Registered Professional Engineer and/or Land Surveyor

Max A. Schumann
MAX A. SCHUMANN

Certificate No.
1510

PLAN

Lawbar Petroleum, Inc. has obtained Farmouts on both the SE/4 and NE/4 Section 9, TWP 7-S, RGE 33-E, Roosevelt County, New Mexico.

The SE/4 is FEE land and is one lease and the NE/4 is Federal land and is a separate lease, with both leases farmed to Lawbar.

Lawbar will earn both leases upon reaching and testing to objective depth of 9600±.

In the event of production, Lawbar will appropriately communitize the subject lands.

RECEIVED

JUN 11 1979

OIL COMMISSION
LEASING