

NO. OF COPIES RECEIVED	
DISTRIBUTION	
SANTA FE	
FILE	
U.S.G.S.	
LAND OFFICE	
OPERATOR	

# NEW MEXICO OIL CONSERVATION COMMISSION

Form C-103  
Supersedes Old  
C-102 and C-103  
Effective 1-1-65

5a. Indicate Type of Lease State <input checked="" type="checkbox"/> Fee <input type="checkbox"/>	
5. State Oil & Gas Lease No. 30-041-20534	
7. Unit Agreement Name	
8. Farm or Lease Name Roosevelt 6 State	
9. Well No. 1	
10. Field and Pool, or Wildcat Todd, N.W.	
12. County Roosevelt	

## SUNDRY NOTICES AND REPORTS ON WELLS

(DO NOT USE THIS FORM FOR PROPOSALS TO DRILL OR TO DEEPEN OR PLUG BACK TO A DIFFERENT RESERVOIR.  
USE "APPLICATION FOR PERMIT -" (FORM C-101) FOR SUCH PROPOSALS.)

1. OIL WELL <input checked="" type="checkbox"/> GAS WELL <input type="checkbox"/> OTHER- <input type="checkbox"/>
2. Name of Operator Pennzoil Company
3. Address of Operator P.O. Drawer 1828, Midland, Texas 79702
4. Location of Well UNIT LETTER <u>G</u> , <u>1980</u> FEET FROM THE <u>North</u> LINE AND <u>1980</u> FEET FROM THE <u>East</u> LINE, SECTION <u>6</u> TOWNSHIP <u>7-S</u> RANGE <u>35-E</u> N.M.P.M.
15. Elevation (Show whether DF, RT, GR, etc.) 4265.9

Check Appropriate Box To Indicate Nature of Notice, Report or Other Data  
NOTICE OF INTENTION TO:

PERFORM REMEDIAL WORK <input type="checkbox"/>	PLUG AND ABANDON <input type="checkbox"/>
TEMPORARILY ABANDON <input type="checkbox"/>	CHANGE PLANS <input type="checkbox"/>
PULL OR ALTER CASING <input type="checkbox"/>	OTHER <input type="checkbox"/>

SUBSEQUENT REPORT OF:

REMEDIAL WORK <input type="checkbox"/>	ALTERING CASING <input type="checkbox"/>
COMMENCE DRILLING OPNS. <input type="checkbox"/>	PLUG AND ABANDONMENT <input type="checkbox"/>
CASING TEST AND CEMENT JOBS <input type="checkbox"/>	OTHER <u>Attempted Completion</u> <input checked="" type="checkbox"/>

17. Describe Proposed or Completed Operations (Clearly state all pertinent details, and give pertinent dates, including estimated date of starting any proposed work) SEE RULE 1103.

6-2-80 RU completion unit  
6-3-80 Perforated 1 JSPF @ 4270, 71, 73, 82, 93, 4303, 05,06,07,11, 12, 17,18,24,26,28,29,31  
35,47,48  
6-4-80 Treated perms 4270-4348 w/2000 gals 15% HCL acid.  
6-5-80- Swabbing  
6-10-80  
6-11-80 Fraced perms 4270-4348 w/7000 gals gelled wtr, 10,000 gals gelled 15% acid and 8000#  
sand.  
6-12-80- Swabbing  
6-24-80  
6-25-80 Set CIBP at 4245. Perforated 1 JSPF @ 4176, 78, 84, 90, 92, 95, 97, 99, 4204, 05, 08,  
10, 12, 26, 28, 31. Treated w/5000 gals 15% HCL acid.  
6-26-80- Swabbing water  
6-30-80  
7-1-80 Drove retainer from 4245-4367  
7-2-80 Set new retainer at 4252. Squeezed lower San Andres perms 4270-4348 w/50 sks.  
7-3-80- Swabbing water  
7-8-80  
7-9-80 Drilled out retainer.

(cont'd)

18. I hereby certify that the information above is true and complete to the best of my knowledge and belief.

SIGNED <u>J. V. Dullung</u>	TITLE <u>Operations Engineer</u>	DATE <u>7-21-80</u>
Orig. Signed by <u>John Runyan</u> Geologist	TITLE _____	DATE _____
APPROVED BY _____	TITLE _____	DATE _____
CONDITIONS OF APPROVAL, IF ANY:		

NO. OF COPIES RECEIVED	
DISTRIBUTION	
SANTA FE	
FILE	
U.S.G.S.	
LAND OFFICE	
OPERATOR	

NEW MEXICO OIL CONSERVATION COMMISSION

Form C-103  
Supersedes Old  
C-102 and C-103  
Effective 1-1-65

5a. Indicate Type of Lease State <input checked="" type="checkbox"/> Fee <input type="checkbox"/>
5. State Oil & Gas Lease No. 30-041-20534

<b>SUNDRY NOTICES AND REPORTS ON WELLS</b> <small>(DO NOT USE THIS FORM FOR PROPOSALS TO DRILL OR TO DEEPEN OR PLUG BACK TO A DIFFERENT RESERVOIR. USE "APPLICATION FOR PERMIT" (FORM C-101) FOR SUCH PROPOSALS.)</small>	
1. <input checked="" type="checkbox"/> OIL WELL <input type="checkbox"/> GAS WELL <input type="checkbox"/> OTHER-	7. Unit Agreement Name
2. Name of Operator Pennzoil Company	8. Farm or Lease Name Roosevelt 6 State
3. Address of Operator P.O. Drawer 1828, Midland, Texas 79702	9. Well No. 1
4. Location of Well UNIT LETTER <u>G</u> <u>1980</u> FEET FROM THE <u>North</u> LINE AND <u>1980</u> FEET FROM THE <u>East</u> LINE, SECTION <u>6</u> TOWNSHIP <u>7-S</u> RANGE <u>35-E</u> NMPM.	10. Field and Pool, or Wildcat Todd, N.W.
15. Elevation (Show whether DF, RT, GR, etc.) 4265.9	12. County Roosevelt

16. Check Appropriate Box To Indicate Nature of Notice, Report or Other Data	
NOTICE OF INTENTION TO:	SUBSEQUENT REPORT OF:
PERFORM REMEDIAL WORK <input type="checkbox"/>	REMEDIAL WORK <input type="checkbox"/>
TEMPORARILY ABANDON <input type="checkbox"/>	COMMENCE DRILLING OPNS. <input type="checkbox"/>
PULL OR ALTER CASING <input type="checkbox"/>	CASING TEST AND CEMENT JOBS <input type="checkbox"/>
OTHER <input type="checkbox"/>	OTHER <u>Attempted Completion</u> <input checked="" type="checkbox"/>
PLUG AND ABANDON <input type="checkbox"/>	ALTERING CASING <input type="checkbox"/>
CHANGE PLANS <input type="checkbox"/>	PLUG AND ABANDONMENT <input type="checkbox"/>

17. Describe Proposed or Completed Operations (Clearly state all pertinent details, and give pertinent dates, including estimated date of starting any proposed work) SEE RULE 1703.

(cont'd)

- 7-10-80 Set new retainer at 4253. Re-squeezed lower San Andres perms 4270-4348 w/150 sks.
- 7-11-80 Drilled out CMT.
- 7-12-80
- 7-13-80 Found leak in TBG. Tested TBG.
- 7-15-80
- 7-16-80 Treated upper San Andres 4176-4212 w/1000 gals 15% HCL.
- 7-17-80 Swabbing
- 7-18-80 Swabbing water.
- 7-20-80

18. I hereby certify that the information above is true and complete to the best of my knowledge and belief.		
SIGNED <u>J. V. Dunning</u>	TITLE <u>Operations Engineer</u>	DATE <u>7-21-80</u>
APPROVED BY <u>John Dunning</u>	TITLE	DATE <u>JUL 23 1980</u>
CONDITIONS OF APPROVAL:		

NO. OF COPIES RECEIVED		
DISTRIBUTION		
SANTA FE		
FILE		
U.S.G.S.		
LAND OFFICE		
OPERATOR		

# NEW MEXICO OIL CONSERVATION COMMISSION

Form C-103  
Supersedes Old  
C-102 and C-103  
Effective 1-1-65

5a. Indicate Type of Lease
State <input checked="" type="checkbox"/> Fee <input type="checkbox"/>
5. State Oil & Gas Lease No.
30-041-20534

<p align="center"><b>SUNDRY NOTICES AND REPORTS ON WELLS</b></p> <p align="center"><small>(DO NOT USE THIS FORM FOR PROPOSALS TO DRILL OR TO DEEPEN OR PLUG BACK TO A DIFFERENT RESERVOIR. USE "APPLICATION FOR PERMIT -" (FORM C-101) FOR SUCH PROPOSALS.)</small></p>		
1. OIL WELL <input checked="" type="checkbox"/> GAS WELL <input type="checkbox"/> OTHER- <input type="checkbox"/>	7. Unit Agreement Name	
2. Name of Operator	8. Farm or Lease Name	
PENNZOIL COMPANY	Roosevelt 6 State	
3. Address of Operator	9. Well No.	
P.O. Drawer 1828, Midland, Texas 79702	1	
4. Location of Well	10. Field and Pool, or Wildcat	
UNIT LETTER <u>G</u> 1980 North 1980	Todd, NW <i>See</i>	
FEET FROM THE LINE AND FEET FROM		
East 6 7-S 35-E		
THE LINE, SECTION TOWNSHIP RANGE NMPM.		
15. Elevation (Show whether DF, RT, GR, etc.)	12. County	
4265.9	Roosevelt	

16. Check Appropriate Box To Indicate Nature of Notice, Report or Other Data			
NOTICE OF INTENTION TO:		SUBSEQUENT REPORT OF:	
PERFORM REMEDIAL WORK <input type="checkbox"/>	PLUG AND ABANDON <input type="checkbox"/>	REMEDIAL WORK <input type="checkbox"/>	ALTERING CASING <input type="checkbox"/>
TEMPORARILY ABANDON <input type="checkbox"/>	CHANGE PLANS <input type="checkbox"/>	COMMENCE DRILLING OPNS. <input checked="" type="checkbox"/>	PLUG AND ABANDONMENT <input type="checkbox"/>
PULL OR ALTER CASING <input type="checkbox"/>	OTHER <input type="checkbox"/>	CASING TEST AND CEMENT JOBS <input checked="" type="checkbox"/>	OTHER <input type="checkbox"/>

17. Describe Proposed or Completed Operations (Clearly state all pertinent details, and give pertinent dates, including estimated date of starting any proposed work) SEE RULE 1103.

5/19/80 Spudded 12-1/4" hole at 10:45 PM. Drilled to 364'. Ran 11 jts 8-5/8" 24# K-55 csg to 356'. Cmt w/250 sx Class C cmt w/2% CaCl<sub>2</sub>. Plug down at 6 AM 5/20/80. Circulated 30 sx to pit. WOC 13-1/2 hrs. Tested casing to 850# for 30 minutes. Held ok.

*Min WOC - 13415*

5/28/80 Drilled to 4400'. Ran logs. Ran 4-1/2" 9.5 K-55 csg to 4400'. Cmt w/1300 sx Halliburton light plus 200 sx Class C w/2% CaCl<sub>2</sub>. Plug down at 12 noon 5/28/80. Circulated 200 sx to pit. Released drilling rig at 1:30 PM.

18. I hereby certify that the information above is true and complete to the best of my knowledge and belief.

SIGNED J. V. Dilling TITLE Operations Engineer DATE 6/6/80

APPROVED BY Orig. Signed By Jerry Sexton Dist. 1. Supv TITLE \_\_\_\_\_ DATE JUN 9 1980

CONDITIONS OF APPROVAL, IF ANY:

NO. OF COPIES RECEIVED	
DISTRIBUTION	
SANTA FE	
FILE	
U.S.G.S.	
LAND OFFICE	
OPERATOR	

# NEW MEXICO OIL CONSERVATION COMMISSION

Form C-101  
Revised 1-1-65

30-041-203 34

*Amended*

5A. Indicate Type of Lease  
STATE ☒ FEE ☐

5. State Oil & Gas Lease No.

7. Unit Agreement Name

8. Farm or Lease Name  
Roosevelt 6 State

9. Well No.  
1

10. Field and Pool, or Wildcat  
Todd, NW

12. County  
Roosevelt

19. Proposed Depth  
4500'

19A. Formation  
San Andres

20. Rotary or C.T.  
Rotary

21. Elevations (Show whether DF, RT, etc.)  
4205.9 GL

21A. Kind & Status Plug. Bond  
Blanket

21B. Drilling Contractor  
Unknown

22. Approx. Date Work will start  
June 1, 1980

## APPLICATION FOR PERMIT TO DRILL, DEEPEN, OR PLUG BACK

1a. Type of Work

b. Type of Well  
DRILL ☒ DEEPEN ☐ PLUG BACK ☐  
OIL WELL ☒ GAS WELL ☐ OTHER ☐ SINGLE ZONE ☐ MULTIPLE ZONE ☐

2. Name of Operator  
PENNZOIL COMPANY

3. Address of Operator  
P.O. Drawer 1828, Midland, Texas 79702

4. Location of Well  
UNIT LETTER G LOCATED 1980 FEET FROM THE -North- LINE  
AND 1980 FEET FROM THE East LINE OF SEC. 6 TWP. 7 RGE. 35-E NMPM

23. PROPOSED CASING AND CEMENT PROGRAM

SIZE OF HOLE	SIZE OF CASING	WEIGHT PER FOOT	SETTING DEPTH	SACKS OF CEMENT	EST. TOP
12-1/4"	8-5/8	24	360'	200 sx	Surface
7-7/8"	4-1/2	11.6	4500'	150 sx	3700'

\*\*\*Cement on the production casing must be brought from the top of the salt or anhydrite to the surface casing. This can be done by either circulating the production casing with cement, or a DV tool at the top of the salt.

T/Salt. 1000'  
B/Salt. 1800'

ABOVE SPACE DESCRIBE PROPOSED PROGRAM: IF PROPOSAL IS TO DEEPEN OR PLUG BACK, GIVE DATA ON PRESENT PRODUCTIVE ZONE AND PROPOSED NEW PRODUCTIVE ZONE. GIVE BLOWOUT PREVENTER PROGRAM, IF ANY.

hereby certify that the information above is true and complete to the best of my knowledge and belief.

Signed *[Signature]* Title District Production Manager Date March 12, 1980

(This space for State Use)

APPROVED BY *[Signature]* TITLE SUPERVISOR DISTRICT 1 DATE MAY 5 1980

CONDITIONS OF APPROVAL, IF ANY:

\*\*\*SEE ABOVE

**MEXICO OIL CONSERVATION COM**  
**WELL LOCATION AND ACREAGE DEDICATION PLAT**

Form O-122  
 Supersedes C-12R  
 Effective 10-65

All distances must be from the outer boundaries of the Section

Operator <b>Penn Oil Company</b>			Lease <b>Roosevelt State 6</b>		Well No. <b>1</b>
Tract Letter <b>G</b>	Section <b>6</b>	Township <b>7 South</b>	Range <b>35 East</b>	County <b>Roosevelt</b>	
Actual Footage Location of Well:					
1980 feet from the North		line and		1980 feet from the East	
Ground Level Elev. <b>4265.9</b>	Producing Formation <b>San Andres</b>	Pool <b>N.W. Todd San Andres (Extention)</b>		Dedicated Acreage <b>80</b> Acres	

1. Outline the acreage dedicated to the subject well by colored pencil or hachure marks on the plat below.
2. If more than one lease is dedicated to the well, outline each and identify the ownership thereof (both as to working interest and royalty).
3. If more than one lease of different ownership is dedicated to the well, have the interests of all owners been consolidated by communitization, unitization, force-pooling, etc?

☐ Yes    ☐ No    If answer is "yes," type of consolidation \_\_\_\_\_

If answer is "no," list the owners and tract descriptions which have actually been consolidated. (Use reverse side of this form if necessary.) \_\_\_\_\_

No allowable will be assigned to the well until all interests have been consolidated (by communitization, unitization, forced-pooling, or otherwise) or until a non-standard unit, eliminating such interests, has been approved by the Commission.

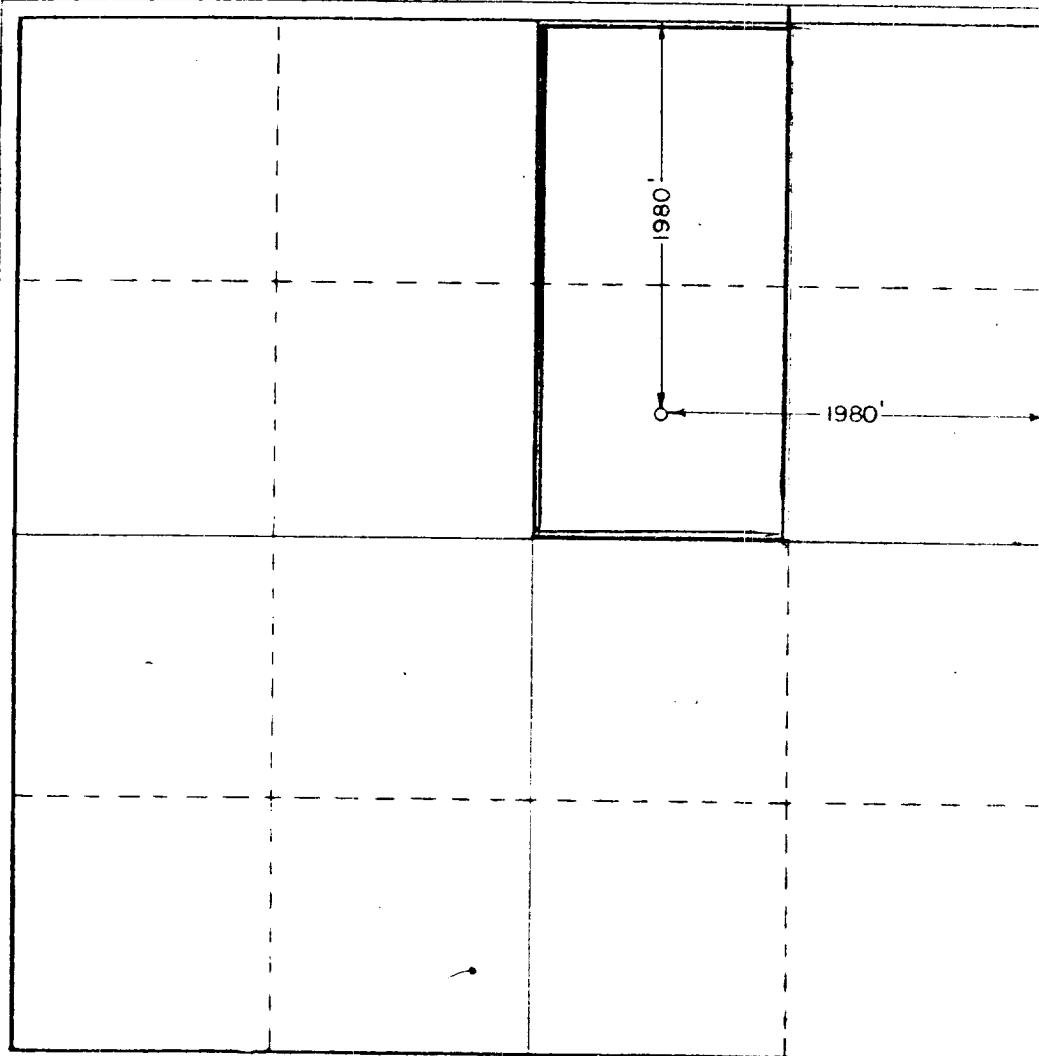

**CERTIFICATION**

I hereby certify that the information contained herein is true and complete to the best of my knowledge and belief

*L. Charles Marquart*  
 Name

**L. Charles Marquart**

District Production Manager

**PENNZOIL EXPL & PROD. CO.**

Date  
**2/29/80**

I hereby certify that the well location shown on this plat was plotted from field notes of actual surveys made by me or under my supervision and that the same is true and correct to the best of my knowledge and belief

Date Surveyed  
**February 28, 1980**

Registered Professional Engineer  
 and a Licensed Surveyor

*John W. West*  
 Certificate No. **JOHN W. WEST 676**  
**PATRICK A. ROMERO 6663**  
**Ronald J. Eidson 3239**

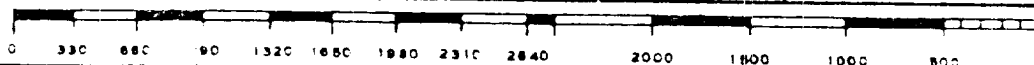

NO. OF COPIES RECEIVED		
DISTRIBUTION		
SANTA FE		
FILE		
U.S.G.S.		
LAND OFFICE		
OPERATOR		

# NEW MEXICO OIL CONSERVATION COMMISSION

Form C-103  
Supersedes Old  
C-102 and C-103  
Effective 1-1-65

<p align="center"><b>SUNDRY NOTICES AND REPORTS ON WELLS</b> (DO NOT USE THIS FORM FOR PROPOSALS TO DRILL OR TO DEEPEN OR PLUG BACK TO A DIFFERENT RESERVOIR. USE "APPLICATION FOR PERMIT -" (FORM C-101) FOR SUCH PROPOSALS.)</p>		<p>5a. Indicate Type of Lease State <input checked="" type="checkbox"/> Fee <input type="checkbox"/></p> <p>5. State Oil &amp; Gas Lease No. <b>30-041-20534</b></p>
<p>1. <input checked="" type="checkbox"/> OIL WELL <input type="checkbox"/> GAS WELL <input type="checkbox"/> OTHER-</p>	<p>7. Unit Agreement Name</p>	
<p>2. Name of Operator <b>PENNZOIL COMPANY</b></p>	<p>8. Farm or Lease Name <b>Roosevelt 6 State</b></p>	
<p>3. Address of Operator <b>P.O. Drawer 1828, Midland, Texas 79702</b></p>	<p>9. Well No. <b>1</b></p>	
<p>4. Location of Well UNIT LETTER <b>N</b> <b>660</b> FEET FROM THE <b>South</b> LINE AND <b>1980</b> FEET FROM THE <b>East</b> LINE, SECTION <b>6</b> TOWNSHIP <b>7-S</b> RANGE <b>35-E</b> NMPM.</p>	<p>10. Field and Pool, or Wildcat <b>Todd, N.W.</b></p>	
<p>15. Elevation (Show whether DF, RT, GR, etc.) <b>4269.1'</b></p>		<p>12. County <b>Roosevelt</b></p>

<p>16. Check Appropriate Box To Indicate Nature of Notice, Report or Other Data</p>	
<p>NOTICE OF INTENTION TO:</p> <p>PERFORM REMEDIAL WORK <input type="checkbox"/> PLUG AND ABANDON <input type="checkbox"/></p> <p>TEMPORARILY ABANDON <input type="checkbox"/> CHANGE PLANS <input type="checkbox"/></p> <p>PULL OR ALTER CASING <input type="checkbox"/> OTHER <input type="checkbox"/></p>	<p>SUBSEQUENT REPORT OF:</p> <p>REMEDIAL WORK <input type="checkbox"/> ALTERING CASING <input type="checkbox"/></p> <p>COMMENCE DRILLING OPNS. <input type="checkbox"/> PLUG AND ABANDONMENT <input type="checkbox"/></p> <p>CASING TEST AND CEMENT JOBS <input type="checkbox"/></p> <p>OTHER <b>Change amended location back to original location.</b> <input checked="" type="checkbox"/></p>

17. Describe Proposed or Completed Operations (Clearly state all pertinent details, and give pertinent dates, including estimated date of starting any proposed work) SEE RULE 1103.

1. This Form C-103 is filed to change the above (amended) location back to the original location of:

Unit Letter G, 1980' FNL & 1980' FEL, Sec. 6, T-7-S, R-35-E,  
GL 4265.9'

NOTE: No work has been done on either location.

<p>18. I hereby certify that the information above is true and complete to the best of my knowledge and belief.</p>		
<p>SIGNED <i>[Signature]</i></p>	<p>TITLE <b>District Production Manager</b></p>	<p>DATE <b>April 30, 1980</b></p>
<p>APPROVED BY <b>Orig. Signed by Jerry Sexton</b></p>	<p>TITLE <b>District Supervisor</b></p>	<p>DATE <b>MAY 5 1980</b></p>
<p>CONDITIONS OF APPROVAL, I</p>		

NO. OF COPIES RECEIVED	
DISTRIBUTION	
SANTA FE	
FILE	
U.S.G.S.	
LAND OFFICE	
OPERATOR	

# NEW MEXICO OIL CONSERVATION COMMISSION

30-041-20534

Form C-101  
Revised 1-1-65

## A M E N D E D   L O C A T I O N

5A. Indicate Type of Lease STATE <input checked="" type="checkbox"/> FEE <input type="checkbox"/>
5. State Oil & Gas Lease No. 30--41-20534
7. Unit Agreement Name
8. Farm or Lease Name Roosevelt 6 State
9. Well No. 1
10. Field and Name of Wildcat Todd, NW <b>UNDESIGNATED</b>
12. County Roosevelt
19. Proposed Depth 4500'
19A. Formation San Andres
20. Rotary or C.T. Rotary
21. Elevations (Show whether DF, RT, etc.) 4269.1 GL
21A. Kind & Status Plug. Bond Blanket
21B. Drilling Contractor Unknown
22. Approx. Date Work will start April 26, 1980

### APPLICATION FOR PERMIT TO DRILL, DEEPEN, OR PLUG BACK

1a. Type of Work b. Type of Well OIL WELL <input type="checkbox"/> GAS WELL <input type="checkbox"/> OTHER <input type="checkbox"/> DRILL <input checked="" type="checkbox"/> DEEPEN <input type="checkbox"/> PLUG BACK <input type="checkbox"/>	2. Name of Operator PENNZOIL COMPANY	3. Address of Operator P.O. Drawer 1828, Midland, Texas 79702	4. Location of Well UNIT LETTER <u>N</u> LOCATED <u>660</u> FEET FROM THE <u>South</u> LINE AND <u>1980</u> FEET FROM THE <u>West</u> LINE OF SEC. <u>6</u> TWP. <u>7</u> RGE. <u>35-E</u> NMPM
23. PROPOSED CASING AND CEMENT PROGRAM			

SIZE OF HOLE	SIZE OF CASING	WEIGHT PER FOOT	SETTING DEPTH	SACKS OF CEMENT	EST. TOP
12-1/4"	8-5/8"	24	360'	200 sx	Surface
7-7/8"	4-1/2"	11.6	4500'	1800 sx	Surface

## A M E N D E D   L O C A T I O N

APPROVED  
FOR THE STATE OF NEW MEXICO  
BY THE COMMISSIONER OF LANDS  
AND MINES  
EXPIRES July 21, 1980

IN ABOVE SPACE DESCRIBE PROPOSED PROGRAM: IF PROPOSAL IS TO DEEPEN OR PLUG BACK, GIVE DATA ON PRESENT PRODUCTIVE ZONE AND PROPOSED NEW PRODUCTIVE ZONE. GIVE BLOWOUT PREVENTER PROGRAM, IF ANY.

I hereby certify that the information above is true and complete to the best of my knowledge and belief.

Signed L. Charles Marquardt Title District Production Manager Date April 14, 1980

(This space for State Use)

APPROVED BY John W. Remyer TITLE Geologist DATE APR 21 1980

CONDITIONS OF APPROVAL, IF ANY:

NEW MEXICO OIL CONSERVATION COMMISSION  
WELL LOCATION AND ACREAGE DEDICATION PLAT

Form C-102  
Supersedes C-128  
Effective 1-1-65

All distances must be from the outer boundaries of the Section.

Operator <b>Pennzoil Company</b>			Lease <b>Roosevelt 6</b>		Well No. <b>1</b>
Unit Letter <b>N</b>	Section <b>6</b>	Township <b>7 South</b>	Range <b>35 East</b>	County <b>Roosevelt</b>	
Actual Footage Location of Well: <b>660</b> feet from the <b>South</b> line and <b>1980</b> feet from the <b>West</b> line					
Ground Level Elev. <b>4269.1</b>	Producing Formation <b>San Andres</b>		Pool <b>Todd N.W.</b>	Dedicated Acreage: <b>80</b>	

1. Outline the acreage dedicated to the subject well by colored pencil or hatchure marks on the plat below.
2. If more than one lease is dedicated to the well, outline each and identify the ownership thereof (both as to working interest and royalty).
3. If more than one lease of different ownership is dedicated to the well, have the interests of all owners been consolidated by communitization, unitization, force-pooling, etc?

☐ Yes ☐ No If answer is "yes," type of consolidation \_\_\_\_\_

If answer is "no," list the owners and tract descriptions which have actually been consolidated. (Use reverse side of this form if necessary.) \_\_\_\_\_

No allowable will be assigned to the well until all interests have been consolidated (by communitization, unitization, forced-pooling, or otherwise) or until a non-standard unit, eliminating such interests, has been approved by the Commission.

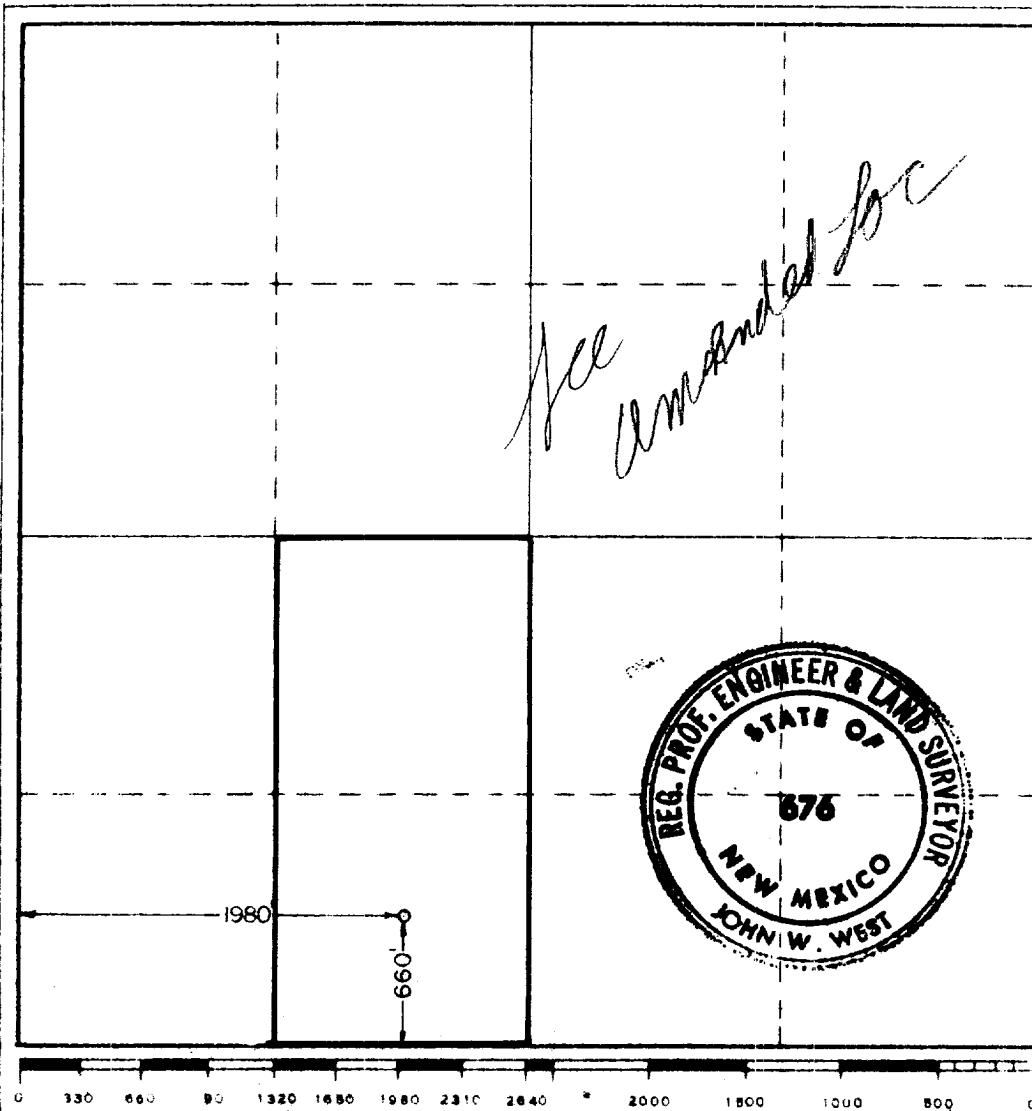

CERTIFICATION

I hereby certify that the information contained herein is true and complete to the best of my knowledge and belief.

*L. Charles Marquart*  
Name

**L. CHARLES MARQUART**

Position  
**DISTRICT PRODUCTION MANAGER**

Company  
**PENNZOIL COMPANY**

Date  
**4/19/80**

I hereby certify that the well location shown on this plat was plotted from field notes of actual surveys made by me or under my supervision, and that the same is true and correct to the best of my knowledge and belief.

Date Surveyed  
**April 14, 1980**

Registered Professional Engineer and/or Land Surveyor

*John W. West*  
Certificate No. **JOHN W. WEST 676**  
**PATRICK A. ROMERO 6868**  
**Ronald J. Eidson 3239**



RECEIVED  
APR 01 1980  
OIL CONSERVATION DIV

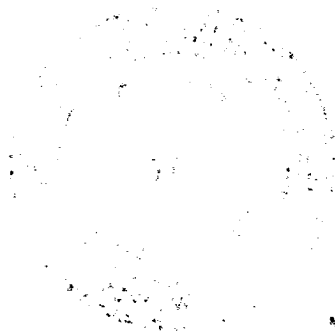

J73