

N MEXICO OIL CONSERVATION COMMISS
WELL LOCATION AND ACREAGE DEDICATION PLAT

Form C-102
 Supersedes C-128
 Effective 1-1-65

All distances must be from the outer boundaries of the Section

Operator EL RAN, INC.		Lease U.S.		Well No. 4
Unit Letter "J."	Section 34	Township 7 South	Range 32 East	County Roosevelt
Actual Footage Location of Well: 1650 feet from the South line and 990 feet from the West line				
Ground Level Elev. 4501.4	Producing Formation San Andres	Pool Chaveroo	Dedicated Acreage: 40 Acres	

1. Outline the acreage dedicated to the subject well by colored pencil or hachure marks on the plat below.
2. If more than one lease is dedicated to the well, outline each and identify the ownership thereof (both as to working interest and royalty).
3. If more than one lease of different ownership is dedicated to the well, have the interests of all owners been consolidated by communitization, unitization, force-pooling, etc?

☐ Yes ☐ No If answer is "yes," type of consolidation _____

If answer is "no," list the owners and tract descriptions which have actually been consolidated. (Use reverse side of this form if necessary.) _____

No allowable will be assigned to the well until all interests have been consolidated (by communitization, unitization, forced-pooling, or otherwise) or until a non-standard unit, eliminating such interests, has been approved by the Commission.

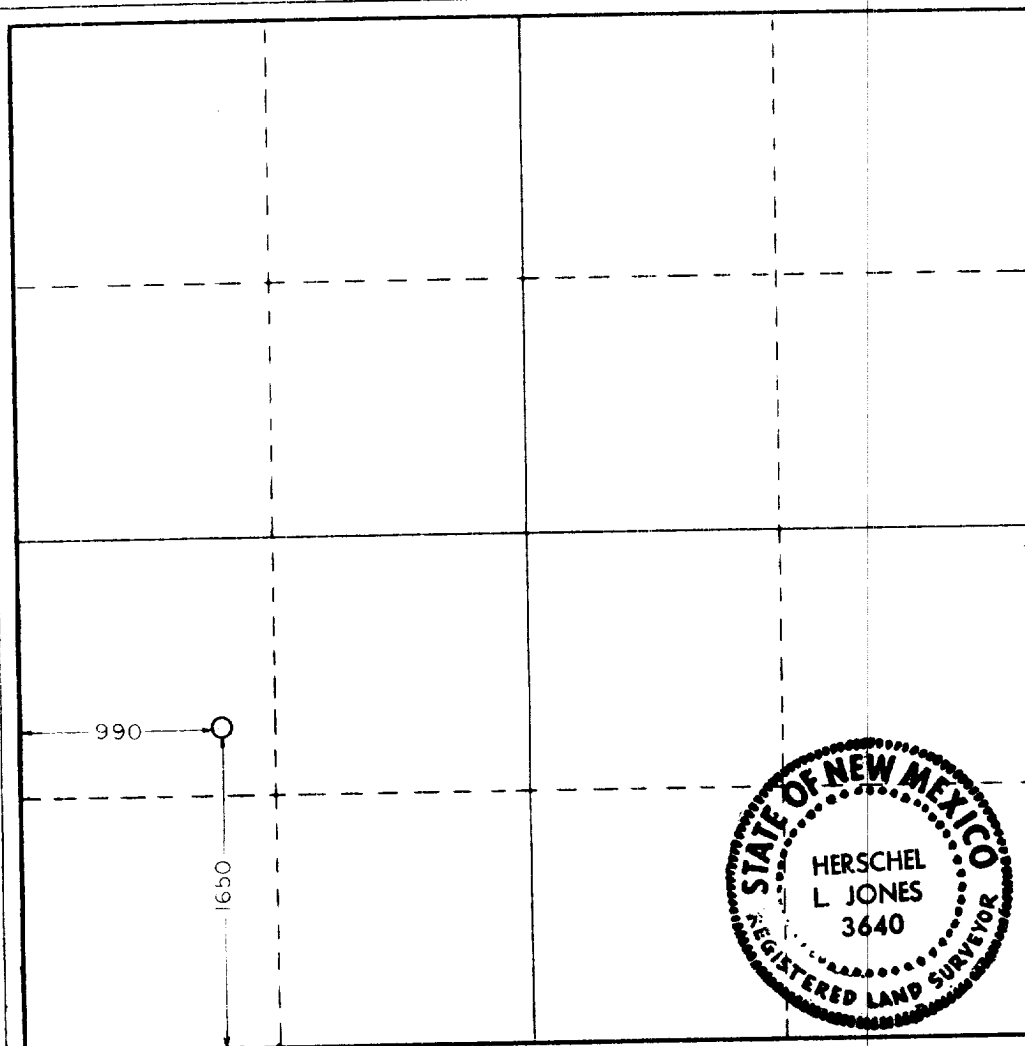

CERTIFICATION

I hereby certify that the information contained herein is true and complete to the best of my knowledge and belief.

Robert R. Ranck

Name
Robert R. Ranck

Position
Vice-President

Company
El Ran, Inc.

Date
July 18, 1980

I hereby certify that the well location shown on this plat was plotted from field notes of actual surveys made by me or under my supervision, and that the same is true and correct to the best of my knowledge and belief.

Date Surveyed
July 10, 1980

Registered Professional Engineer and/or Land Surveyor

Herschel L. Jones

Certificate No.
3640

0 330 660 990 1320 1650 1980 2310 2640 2000 1800 1000 800 0