

NO. OF EXPLORATION PERMITS	
CONSTRUCTION	
SANTA FE	
FILE	
U.S. S.	
LAND OFFICE	
OPERATION	

DATE	FILE
STATE	FILE
S. STATE OF NEW MEXICO	
11-1870	

APPLICATION FOR PERMIT TO DRILL, DEEPEN OR PLUG BACK

TYPE OF WORK

Type of Well: DRILL ☒ REENTRY ☒ DEEPEN ☐ PLUG BACK ☐  
 CIL ☒ GAS WELL ☐ OTHER ☐ SINGLE ☐ MULTIPLE ☐

NAME OF COMPANY

Gulf Petroleum Corporation

ADDRESS OF COMPANY

2700 4th, Artesia, New Mexico 84210

UNIT LETTER C LOCATED 660 FEET FROM THE North LINE

1100 FEET FROM THE East LINE OF SEC. 2 TWP. 7S R. 35E

DATE OF APPLICATION

DATE OF PERMIT

Gulf "X" State

Well No.

11-1870  
Undesignated Todd

Roosevelt

4300'	San Andres	Recessa Unit
Blanket	55 Pulling Unit	ASAP

PROPOSED CASING AND CEMENT PROGRAM

SIZE OF CASING	WEIGHT PER FOOT	DEPTH	SACKS OF CEMENT	EST. TOP
10 5/8"		432'	400 sk	
8 5/8"		445'	1700 sk	

We propose to drill plugs and clean out hole to 4300'. Then test the San Andres formation. If commercial, production tubing will be run, perforated and stimulated as needed for production. This well drilled by BW Exploration, Inc. in November of 1981 as the Gulf State #1. API No. 30-041-20598, D/A 7-14-81.

LOG PROGRAM: Active mud to 4300'.

LOG PROGRAM: BOP will be installed at the start.

ABOVE SIGNER DESCRIBE PROPOSED PROGRAM: IF PROPOSAL IS TO DEEPEN OR PLUG BACK, GIVE DATA ON PRESENT PRODUCTIVE ZONE AND PROPOSED NEW PRODUCTION ZONE, AND PLUGOUT PREVENTER PROGRAM, IF ANY.

I hereby certify that the information above is true and complete to the best of my knowledge and belief.

Signed [Signature] Title Regulatory Agent Date 5/16/83

ORIGINAL SIGNED BY EDDIE SEAY

OIL & GAS INSPECTOR

PROVED BY \_\_\_\_\_ TITLE \_\_\_\_\_ DATE \_\_\_\_\_

EDITIONS OF APPROVAL, IF ANY:

MAY 16 1983

RECEIVED  
MAY 18 1983  
O.C.D.  
HOBBS OFFICE

## OIL CONSERVATION DIVISION

STATE OF NEW MEXICO  
ENERGY AND MINERALS DEPARTMENTP. O. BOX 2088  
SANTA FE, NEW MEXICO 87501Form C-102  
Revised 10-1-78

All distances must be from the outer boundaries of the Section.

Operator <i>Yates Petroleum Corp.</i>			Lease <i>Gulf "XE" State</i>		Well No. <i>1</i>
Unit Letter <i>C</i>	Section <i>20</i>	Township <i>7S</i>	Range <i>35E</i>	County <i>Roosevelt</i>	
Actual Footage Location of Well: <i>660</i> feet from the <i>North</i> line and <i>1980</i> feet from the <i>West</i> line					
Ground Level Elev. <i>1236</i>	Producing Formation <i>San Andres</i>	Pool <i>Under Fold Sr</i>		Dedicated Acreage <i>40</i> <i>80</i> Acres	

1. Outline the acreage dedicated to the subject well by colored pencil or hatchure marks on the plat below.
2. If more than one lease is dedicated to the well, outline each and identify the ownership thereof (both as to working interest and royalty).
3. If more than one lease of different ownership is dedicated to the well, have the interests of all owners been consolidated by communitization, unitization, force-pooling, etc?

☐ Yes ☒ No If answer is "yes," type of consolidation \_\_\_\_\_

If answer is "no," list the owners and tract descriptions which have actually been consolidated. (Use reverse side of this form if necessary.) \_\_\_\_\_

No allowable will be assigned to the well until all interests have been consolidated (by communitization, unitization, forced-pooling, or otherwise) or until a non-standard unit, eliminating such interests, has been approved by the Division.

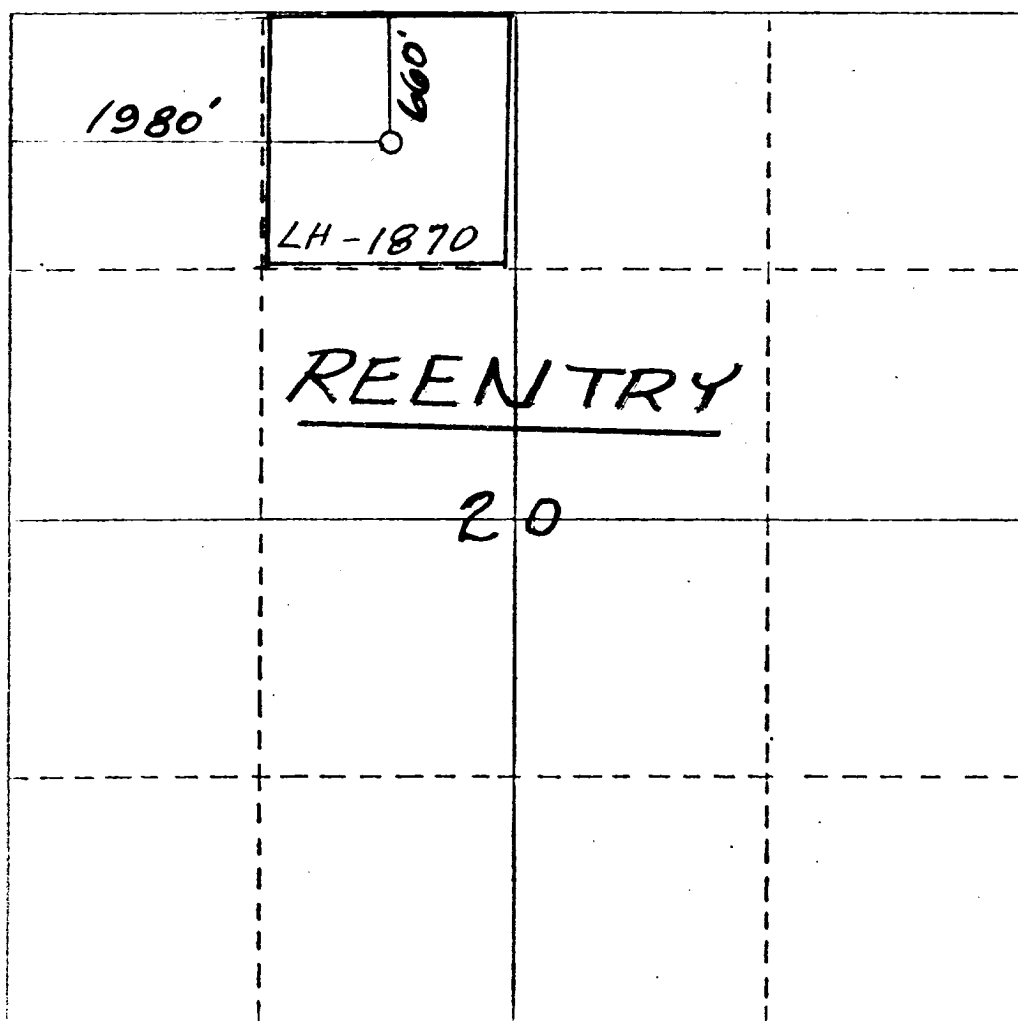

## CERTIFICATION

I hereby certify that the information contained herein is true and complete to the best of my knowledge and belief.

*Shirley P. King*  
Name  
*Agent*  
Position

Company  
*Yates Pet. Corp.*  
Date  
*5-16-83*

I hereby certify that the well location shown on this plat was plotted from field notes of actual surveys made by me or under my supervision, and that the same is true and correct to the best of my knowledge and belief.

*Repts to Original*  
Date Surveyed  
*Plat*

Registered Professional Engineer  
and/or Land Surveyor

Certificate No.

330 660 990 1320 1650 1980 2310 2640 2970 3300 3630 3960 4290 4620 4950 5280 5610 5940 6270 6600